



Ultrasport

Ultrasport Class A • By Damon Corporation





Ultrasport. The ultimate in Class A livability.

Go ahead. Indulge yourself. You've earned it. The Ultrasport Class A Motorhome from Damon Corporation. Loaded with amenities and luxurious styling. Truly a feast for the senses. But without the high price tag of comparable units from other manufacturers.

Quality must begin with a solid foundation. The Ultrasport is no exception, beginning with a superior chassis. Sidewalls are constructed of aluminum-framed laminated fiberglass and a vacuum-bonding process that provides greater structural stability and adhesion.

Inside, you'll discover deluxe furniture throughout. And in the galley, exquisitely crafted solid oak cabinet doors and a padded dinette. Add a microwave oven; three-burner, high-output cooker; flush-mounted double-door refrigerator; and large double-bowl porcelain kitchen sink, and you'll be set to tackle everything from a simple snack to a five-course dinner.

A queen-size bed accentuated with decorative-colored bedspread, headboard and drapes creates a restful master bedroom. Plus, a skylight in the bathroom gets everyone off to a fresh morning start.

Soft designer fabrics reflect sea splashes and earthen tones, starting with the deep comfort of the upholstered chairs. In addition, the water heater and furnace are stored under the floor, thereby lessening noise and freeing up storage in the kitchen cabinets.

Complimenting the rich interior are deluxe exterior graphics. Black-trimmed entrance doors, radius

corner windows, and full front and rear fiberglass caps all contribute to the aerodynamic qualities of the vehicle.

There are four new Ultrasport floor plans for 1996: 30 ft., 34 ft., 38 ft. with tag and a 36-ft. rear diesel with 22 inch tire-and-air suspension. Innovative designing accommodates a 100-gallon fresh-water tank, and approximately 140 cubic feet of storage for all models.

The coach's wide body, coupled with a full base-ment, will give you the confidence that you've picked a winner. So hurry down to your nearest dealer for unsurpassed value. Ultrasport: your passport to unparalleled luxury.





(Left) Cooking seems more like a pleasure than a chore in the Ultrasport galley, with oak-edge countertops and solid oak cabinets doors, plus bright white sink and accents.

(Lower left) With all this storage, you and your family can really stock up for those long trips. (Right) Plush captain's chairs and sleek, stylish dash make you never want to give up the driving detail. (Above) You won't think it can get any better than this. Whatever your pleasure – from relaxing to driving – you'll enjoy it best in the Ultrasport.







(Left) The “L” sofa arrangement in this floor plan, model 3520 with Botanical decor, is great for playing games, watching TV or relaxing with family and friends. (Above) Whichever Ultrasport floor plan you choose, you’ll be assured of comfort and convenience. This floor plan was just made for entertaining. (Below) Wind down in this cozy, comfortable master bedroom, with coordinating bespread, valances and curtains. Soft lighting casts a nice glow on the warm cabinets which provide convenient storage for all of your belongings.



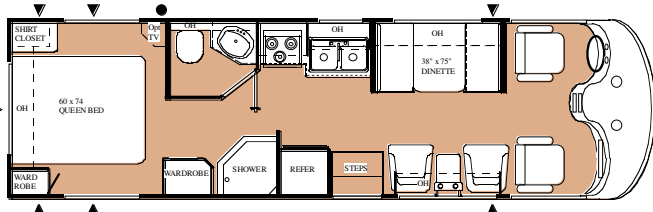

3010B

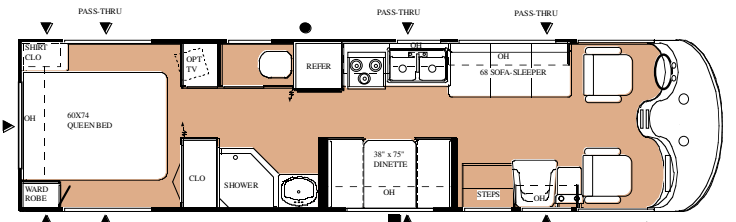

3250B

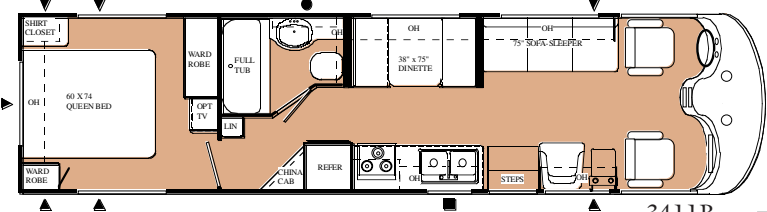

3411B

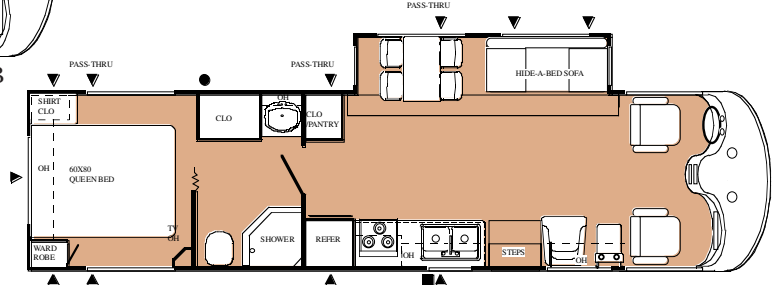

3470B

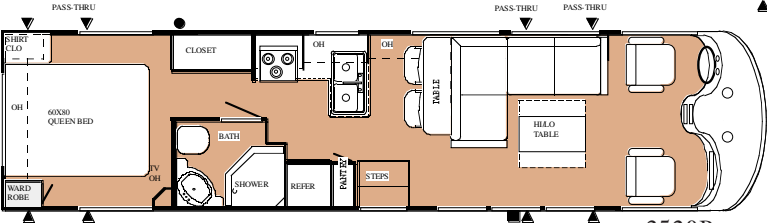

3520B

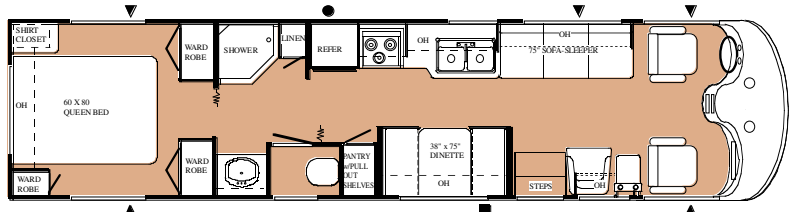

3611B Pusher

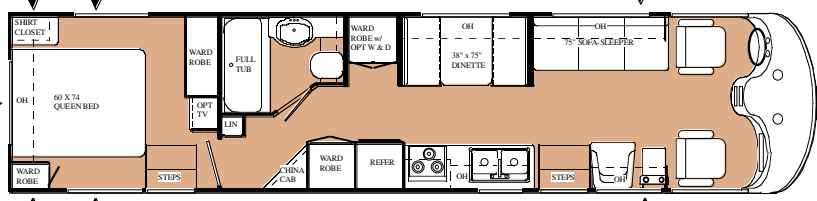

3830B

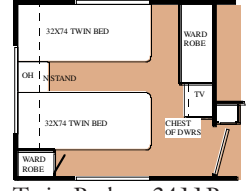

Twin Beds 3411B

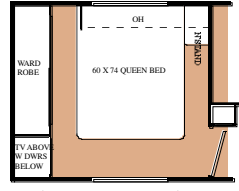

Side Queen Bed 3411B

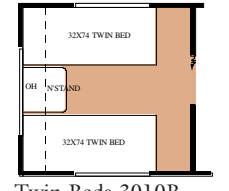

Twin Beds 3010B, 3250B, 3470B, 3830B

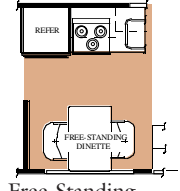

Free-Standing Dinette Option 3250B, 3611B

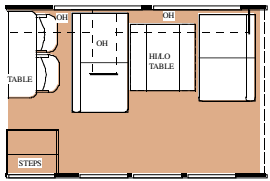

Option 1: 3520B

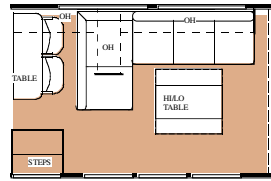

Option 2: 3520B

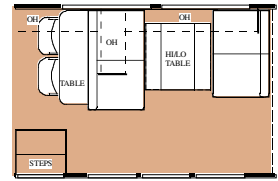

Option 3: 3520B

LEGEND

- ▲ UNDERFLOOR STORAGE
- OPT EXT WASH DOWN KIT
- OPT EXT ENT CENTER

The space-efficient Ultrasport bathroom comes with your choice of tub or shower and a soft, soother decor.

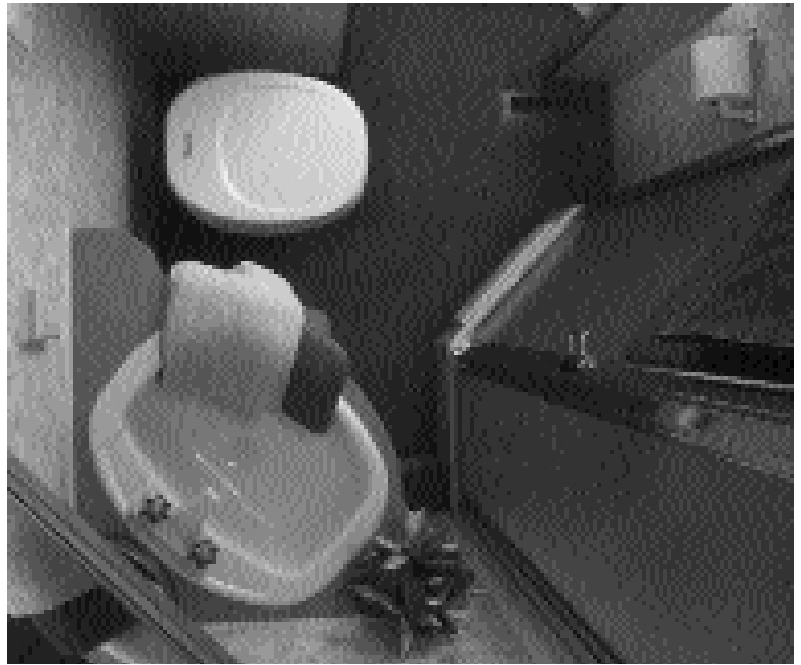

Standard Features

Chassis and Driver: Aerodynamic contoured front fiberglass cap with integrated bumper • Tinted wrap-around windshield • Full fiberglass rear cap w/trunk storage or diesel access • Remote power mirrors • 4-Speed auto transmission with overdrive • Power steering • Cruise control • Tilt steering wheel • Reclining swivel captain's chairs • Soft touch molded vinyl dash • Dash air conditioning • Full instrumentation • AM/FM cassette stereo • Map lights • Sun visors • Automatic emergency start circuit with central control • Battery disconnect • Under-hood light • Four wheel disc brakes • Radial tires • Stainless steel wheel covers • Mud flaps (4) • Spare tire, wheel and carrier

Exterior Features: Smooth colonial white fiberglass exterior w/filon lowers • Deluxe graphics • Black-trimmed, radius-top entrance door • Deadbolt door lock • Integrated electric entrance step • Exterior entry-assist lighted grab handle • Radius corner slider windows (jalousie in bedroom) • Rubber roof • Radius corner domed roof • Roof vents • Roof ladder • Lined & lighted storage compartments • Full basement pass through storage • Radius locking exterior storage doors • City water hook-up • Enclosed and heated holding tanks with pads • Heated fresh water tank • Trailer hitch • Exterior paint package

Electrical Systems: 19" color TV w/full function remote in front O.H. w/antenna, booster & jack • Aisle lights (1 at entrance step, 1 in kitchen area, 1 in bedroom) • Wardrobe lights • Porch lights (2) • Exterior GFCI receptacle • Dual RV batteries • Battery disconnect • 45-amp, 12-volt power converter • 30-amp, 120-volt power assembly • 30 amp, 120-volt marine power cord • Cable TV hook up • TV cabinet with jack in bedroom • Power vent in bath • Water heater by-pass kit

Appliances and Plumbing: 13,500 BTU central air conditioning • Electronic ignition, floor-ducted furnace (31M BTU - 3010B; 35M BTU - all others) • Microwave oven w/turn table • 3-burner, high-output cooktop w/piezo ignition • Lighted power range hood w/monitor panel (including LPG readout) • Double-door refrigerator with black glass doors • Large double-bowl porcelain kitchen sink • Hardwood sink cover • Full height fiberglass tub or shower • Shower door • 6-gallon gas water heater w/electric ignition • 12-volt demand water pump • Folding range cover • Foot-flush toilet • Outside shower

Interior Features: Fabric ceiling • Padded dinette ends & tops • Barrel chair(s) (where available) • 100% continuous filament nylon carpeting w/Scotchgard treatment & residential padding • Solid

oak cabinet doors throughout • Decorator glass in living room overhead cabinet • Windshield privacy drape • Mini blinds in kitchen and bath • Oak-edged countertops • Oak lounge table • Slide-out pantry (available only on 3520B) • Medicine cabinet w/hardwood-framed door • Hardwood-framed mirror in bath • Queen-size bed • Bedspread and headboard • Cedar-lined bed base • Cutlery drawer (where available) • Clock & mirror • Carbon monoxide detector • Smoke detector • Fire extinguisher • Interior entry-assist hand rail • Skylight in bathroom • Carpet lined wardrobe w/mirrored doors • Hardwood drink tray • Roller shades in bedroom • Day/night shades in living room • Chair rail in bedroom • Floor mats

Popular Options

Driver's door w/power window • Dash fans • AM/FM cassette stereo upgrade w/LCD readout, clock, electronic tuning, station presets • Rearview backup monitor w/push button controls and auto iris • Electric air horns • Fog lights • Generator w/auto change-over • 50-amp electric service • Leveling jacks • Stainless steel wheel liners • 3-burner, high-output range w/oven including piezo ignition, black top & black glass front • Ceramic countertop • Large flush-mount double-door refrigerator also available w/icemaker • Hardwood panel refrigerator front • Twin beds (where available) • LP gas detector • Oak plank flooring in kitchen • Telephone jack hook-up • Color TV (2nd in bedroom) • Exterior entertainment center with pullout table • 6-way power seats • Day/night shades in bedroom • Innerspring mattress upgrade • Prep for back-up monitor • Upgrade gel-coat wall • Video cassette player with remote • Video control center • See your dealer for additional options.



Your nearest dealer:



P.O. Box 1107 • Elkhart, IN 46515 (219) 262-2624

Due to constant product improvements, the equipment, specifications, component parts and standard/optional equipment are subject to change without notice or obligation. Product photography or diagrams may show equipment that is optional. Damon Corporation reserves the right to make changes in prices, and models, and to discontinue models without notice or obligation. Components, parts, or chassis may have been manufactured at times other than the model year indicated. All capacities are approximate and dimensions are nominal. See your Damon dealer for full details. DC 6/95. © Damon Corporation - 1995 Printed in the USA.



UltraSport Mini Motorhomes • By Damon Corporation

UltraSport





Ultraspport Mini Motorhome. Ready to Go When You Are.



(Above) Ultraspport Mini Motorhome model 3001. There's more to do than eat at our big, comfortable table with coordinating chairs and sofa. Convenience kitchen is perfect for simple meals and snacks. (Right) The optional overhead entertainment center provides extra storage and keeps living area tidy and decor keeps it beautiful with coordinating day/night shades and valances. The Mardi Gras decor is featured in both of these interiors.



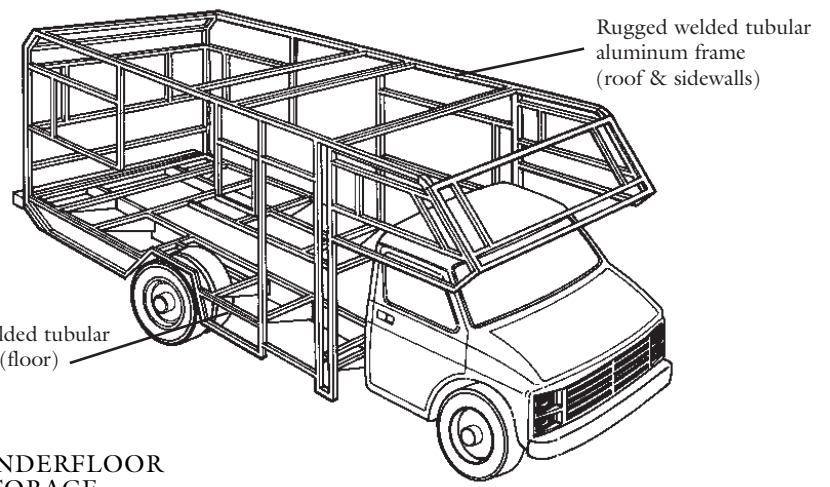
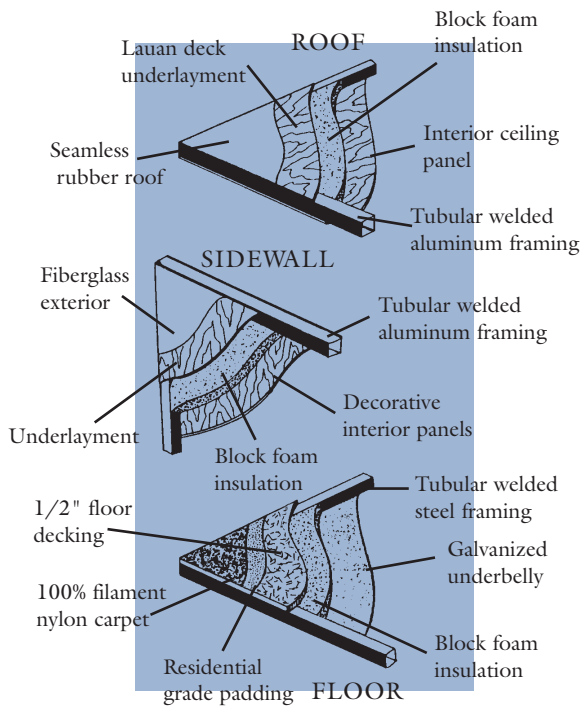

UNDERFLOOR STORAGE

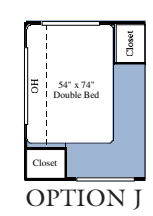
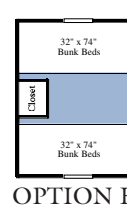
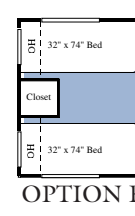
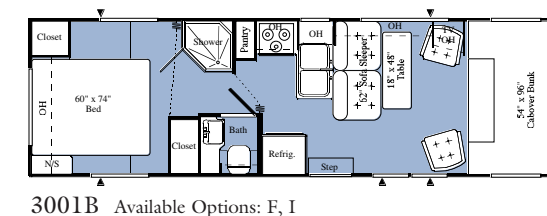
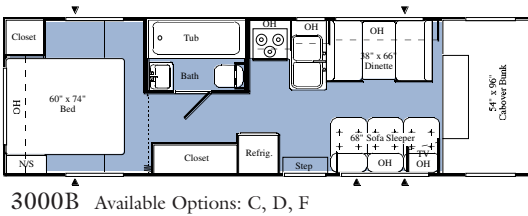
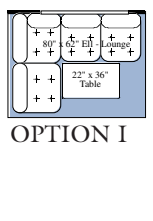
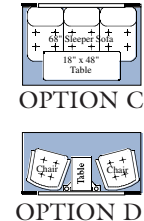
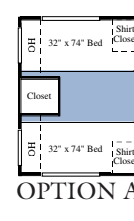
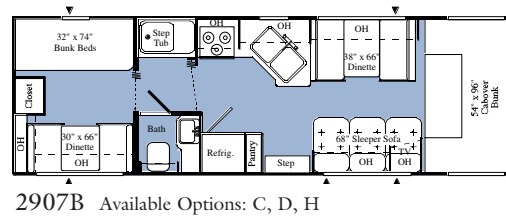
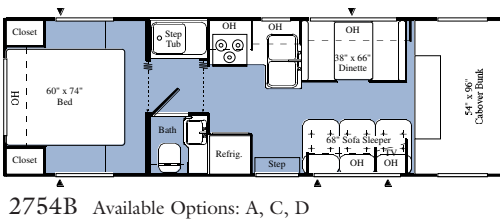
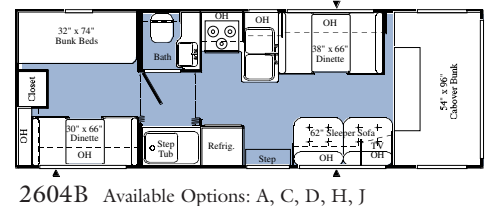
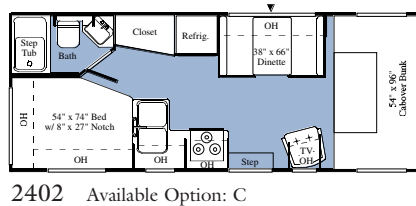
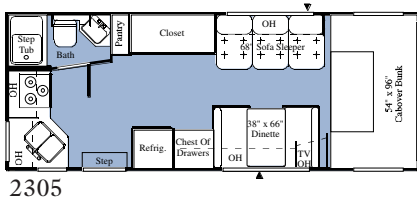
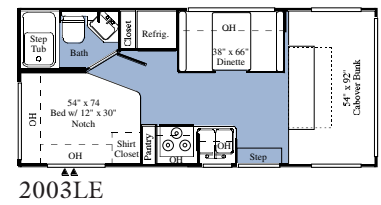
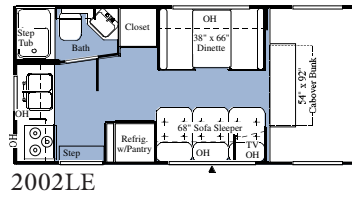

W e i g h t s a n d D i m e n s i o n s

Model	2002LE	2003LE	2305	2402	2604B	2754B	2907B	3000B	3001B
Chassis	Chevy/Ford	Chevy/Ford	Chevy	Chevy	Ford	Ford	Ford	Ford	Ford
Wheelbase (inches)	125"/138"	125"/138"	146"	146"	176"	188"	188"	218"	218"
GVWR	10200/10500	10200/10500	10500	10500	11500	12200	12200	12200	12200
EFI Engine (cu.in.)	350/460	350/460	454	454	460	460	460	460	460
Fuel Capacity (gal.)	33/35	33/35	33	33	55	55	55	55	55
Overall Length	20'11"/21'8"	22'2"/22'11"	24'6"	24'6"	27'8"	29'3"	29'3"	31'1"	31'1"
Overall Width	8'2"	8'2"	8'6"	8'6"	8'6"	8'6"	8'6"	8'6"	8'6"
Overall Height w/roof A/C	10'10"/11'1"	10'10"/11'1"	11'1"	11'1"	11'1"	11'1"	11'1"	11'1"	11'1"
Base Weight (lbs.)	NA	NA	NA	NA	NA	NA	NA	NA	NA
Fresh Water System (approx. gal.)	33	33	26	33	33	33	33	33	33
Grey/Black Water (approx. gal.)	25/27	25/27	35/39	35/39	32/32	32/32	32/32	32/32	32/32
Sleeping Capacity	4	4	4	5	5	5	5	5	4

Botanical

RainForest

Masquerade

Sandpiper

Mardi Gras

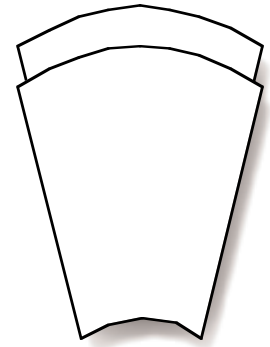
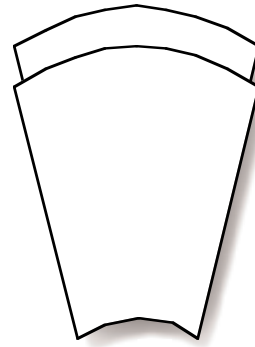
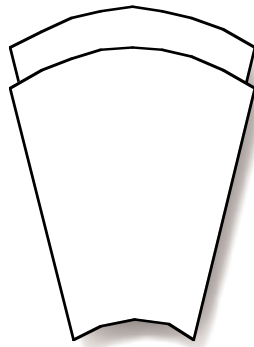
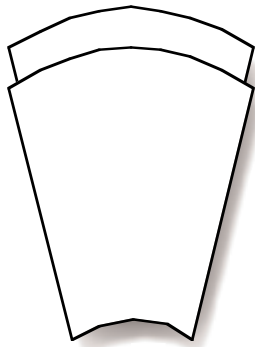
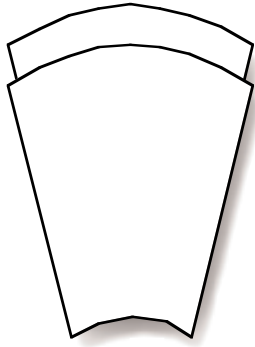

Standard Features

Chassis Features: Anti-sway bar (N/A 2202LE, 2203LE) • Auto transmission • Power steering • Dash air conditioner • Cruise control • Tilt steering wheel • AM/FM cassette stereo • Reclining captain's chairs • Chevy: Power hydraulic front disc/rear drum with 4-wheel anti-lock brakes, electronic fuel injected engine with HD cooling system • Ford: Power and rear wheel anti-lock brakes, electronic fuel injected engine, gas engines include HD auxiliary transmission cooler • Upgrade mirrors including convex mirror • Drink tray

Exterior Features: ABS 3-piece rear trim (N/A 2002LE, 2203LE) • Entrance door with screen door and dead bolt lock • Radius corner slider windows • Radius corner baggage doors • Spare tire (rear wall mount w/vinyl cover: 2002LE, 2003LE, 2305 and 2402. Undercarriage mount: 2604B, 2754B, 2907B, 3000B and 3001B) • Entry-assist handle • Rugged, smooth, colonial white, fiberglass exterior • Running boards • Bumper cover • Luggage ladder • Stainless steel wheel covers (opt. on LE) • Awning rail

Construction: Rugged, welded aluminum-framed and laminated sidewalls and roof • Steel-framed and laminated floor • One piece E.P.D.M. rubber roof • Rugged steel undercarriage • Undercoating

Electrical: Systems monitor panel (including LPG readout) • Generator prep: fuel line, start cable, 120-volt pre-wire • 45 amp, 12-volt power converter w/generator auto change over switch • Roof air conditioner (opt. on LE) • 12-volt demand water pump • TV antenna w/booster (opt. on LE) • Power vent in bath

Heating and Appliances: 60# LP gas tank • 3-burner high-output cooktop • Microwave oven • Lighted power-range hood • Flush-mount double-door refrigerator (opt. on LE) • 6-gallon gas water heater w/electronic ignition (electronic ignition opt. on LE) • Electronic-ignition ducted furnace (20M BTU-2002LE, 2003LE; 25M BTU-2305, 2402; 30M BTU-2604B, 2754B, 2907B, 3000B, 3001W) • Water by-pass kit

Interior Features: Self-edged countertops • Double-bowl porcelain kitchen sink • Cab-over privacy curtain • 100% continuous filament nylon carpeting w/Scotchgard treatment and residential padding • Hardwood-framed cabinet doors • Bedspread and headboard (N/A 2002LE, 2305) • Fabric/upholstery-trimmed valances in living room • Roller shades in bedroom • Day/night shades in living room • Mini-blinds in kitchen • Innerspring mattress (N/A in 2002LE and 2305) • Carbon monoxide detector • Fire extinguisher • Smoke detector • Skylight in shower (where available) • Clock and mirror • Interior entry-assist hand rail

It's easy to relax in our comfortable, coordinated bedroom. Space is maximized for queen-size bed, armoire and bath with shower – all coordinated to be as pretty as it is functional.



Popular Options:

Air cushioned suspension • Solid oak cabinet doors • Oak plank kitchen flooring (N/A in 2202LE and 2305) • Day/night shades throughout • Upgrade innerspring mattress (N/A 2002LE, 2003LE and 2305) • Bi-fold shower door • Generator • Microwave oven w/convection oven • 3-burner high-output range and oven w/piezo ignition, black top and black glass front • Stainless steel folding range cover • Sink cover • LP gas detector • Cable TV hook-up • AM/FM cassette stereo upgrade w/LCD readout, clock, electronic tuning and station presets • Foot-flush toilet • For additional options see your dealer



Your nearest dealer:



P.O. Box 1107 • Elkhart, IN 46515 (219) 262-2624

Due to constant product improvements, the equipment, specifications, component parts and standard/optional equipment are subject to change without notice or obligation. Product photography or diagrams may show equipment that is optional. Damon Corporation reserves the right to make changes in prices, and models, and to discontinue models without notice or obligation. Components, parts, or chassis may have been manufactured at times other than the model year indicated. All capacities are approximate and dimensions are nominal. See your Damon dealer for full details. DC 6/95. © Damon Corporation - 1995 Printed in the USA.