

2002 QWEST™, EAGLE™ & HERITAGE™ CAMPING TRAILERS BY JAYCO

YOU'RE IN JAYCO COUNTRY



WELCOME HOME



1. Color-coordinated SoftShade™ window shades and valances are easy to operate and easy to clean.
2. Simply unplug the two-burner range and plug it in outside for an outdoor dinner.
3. Choose attractive, matching bunk privacy curtains when you want a little time alone.

*You love to get back to nature. To feel the warmth of a campfire, smell the pine-scented mountain air, watch the sun set over the still waters of a peaceful lake. What you don't love is squeezing your family into a cramped tent, trying to keep dry and sleeping on the cold, hard ground. With Jayco camping trailers, you can still experience all of nature's joys without putting up with nature's hassles.*

## *Qwest™ camping trailers*

If you want to enjoy the outdoors without emptying your savings, look no further than Qwest™ camping trailer. Qwest puts affordability back into family camping by giving you just what you need for your adventures.

Even at an affordable price, Qwest is full of home-like features that comfort you in the wilderness. **SoftShade™ window shades and valances** and optional **bunk privacy curtains** decorate the interior with style while the **wall-to-wall, color-coordinated vinyl flooring** matches the décor. **Tinted windows** cut down the sun's glare during the day. At night, continue your activities under the uniform, ample lighting from **12V interior lights** equipped with an **automatic cutoff switch**. And the **carryout range** not only makes cooking easier, but it also gives you the option of cooking outdoors.



12 A Interior



1. The single-piece Structurwood® floor is undercoated and edge-sealed to keep out moisture and stand strong for years.
2. The easy-to-use crank-down stabilizer jacks mean you won't have to crouch down as far and reach underneath the camper. (Standard on rear. Front and rear standard on Qwest 12 A).
3. Qwest's vacuum-bond laminated, double-wall construction, made from thick .024" aluminum with wood backers, makes sidewalls strong so they won't bow or dent as easily. Unlike other manufacturers, we also make sidewalls strong by screwing them through both the floor and the frame.
4. The optional self-storing step makes climbing in and out of your Qwest safe and easy.

## Qwest™ camping trailers

You won't have to worry about your Qwest camping trailer holding up through years of travel. The **vacuum-bond laminated, double-wall sidewalls** stand strong against dents, and the **undercoated, edge-sealed Structurwood® floor** is tough enough to last for years. The **welded steel bumper** protects the rear while the **true-domed aluminum roof** turns away the elements so you stay dry and comfortable.

You also won't have to worry about having enough conveniences to make your vacation easier. Jayco is the only company to give you the option of **hydraulic** (12 A) or **electric brakes** to provide superior stopping. The **crank-down stabilizer jacks** keep you stable at your campsite and set up quickly. And the optional self-store step extends easily to give you secure footing when climbing in or out.





1.



2.



3.

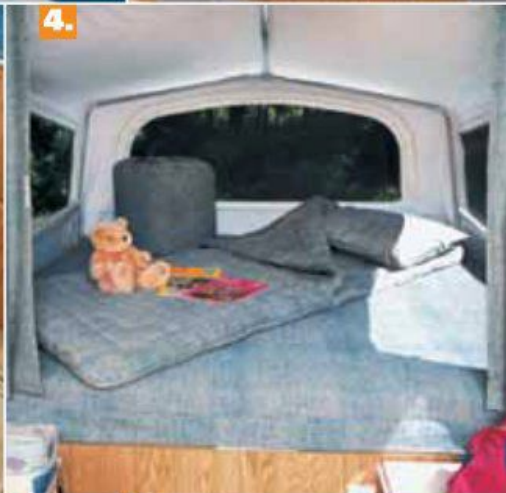

4.



5.



6.

1. Choose attractive, optional matching bunk privacy curtains to gain some solitude.
2. Enjoy one of the things you miss most while camping with the optional bath/shower (12 UDST, 12 FSO and 14 SO).
3. Our beautiful new lighter Fairfield Oak cabinets have the strength to last. We build cabinet doors using traditional, strong mortise-and-tenon joints. And we use real-wood drawers, not plastic tubs.
4. You can choose a comfortable NapSak™ with pillowcase that matches your interior.
5. Color-coordinated SoftShade™ window shades and valances add an attractive touch.
6. The reversible, non-slide dinette cushions with vinyl backs clean up easily. Simply wipe off or unzip to remove for thorough cleaning.

## *Eagle™ camping trailers*

Whether you're headed to the Great Smoky Mountains or the Great Basin, you want great value from your vacations. That's why we loaded Eagle™ camping trailer with plenty of family-friendly features for a reasonable price, making it the best buy in camping.

You'll notice many of these features when you sit down to your first meal. **Dinette slideouts** on some models give you more space in the galley. Our new lighter **Fairfield Oak cabinets** add a touch of residential style. The **stainless steel sink** looks great, with water provided by a **city water hookup** or the **fresh water tank** beneath the floor (12' and 14' models only). Cleaning up the galley is easy with **reversible, non-slide dinette cushions with vinyl backs** and **mildew-resistant aluminum ceiling**.

At bedtime, more of Eagle's amenities show what a great value it is. Pull down the **SoftShade™ window shades and valances** for some privacy. Clean up in the **shower**, which includes the Deluxe Plumbing Package (**water heater, demand pump** and **outside shower**). Then climb into your bunk with optional **bunk privacy curtain** and optional, color-coordinated **NapSak™** and settle in for a great stay.



12 F50 Interior



1. Simply unplug the three-burner range (or two-burner range depending on model) and plug it in outside for an outdoor dinner.
2. With more than 20 cu. ft. of storage space, Eagle's front trunk gives you plenty of space so you won't have to leave your gear out in the weather or take up valuable inside space. The angled lid lets you easily access your stuff even when the bunks are set up (Eagle 12 LSO, 12 FSO and 12 UDST).
3. Eagle's vacuum-bond laminated, double-wall construction, made from thick .040" aluminum with wood backers, makes sidewalls strong so they won't bow or dent as easily. Unlike other manufacturers, we also make the sidewalls strong by screwing them through both the floor and the frame. And the TruForm™ surface makes them scratch-resistant.
4. **Eagle Summit Package Option:** Make your Eagle special with a more streamlined look. Eagle Summit models have an automotive-style bottom radius wrap, front and rear ABS caps and enhanced ABS fender skirt.

## Eagle™ camping trailers

One of the best parts of camping is relaxing during the evening, talking about the day's discoveries and enjoying the night air. While you're outside, take a walk around the Eagle and see some of the features we've included to set it apart from other campers. The **vacuum-bond laminated, double-wall construction** shrugs off dents, while the **TruForm™ surface** resists scratches to keep your Eagle looking good for years. The **metal wheel wells** resist cracks and leaks from rust, corrosion, weather and rocks. **Crank-down stabilizer jacks** provide stable footing. **Electric brakes** (standard on 12' and 14' Eagle, optional on 10' models), or optional **hydraulic surge brakes** give you a choice in stopping power. If you add the **Eagle Summit Package**, your Eagle will stand out even more because of its striking good looks.

After admiring Eagle's solid construction, sit down to a great dinner with your family. Turn on the outside **porch light with awning light adapter** and you won't have to mess with a lantern. Grab some pans out of the spacious **front trunk**, which is equipped with a **light** so you can see what you're doing. Then cook the trout you caught on the **carryout range**. This is why you love to get away.

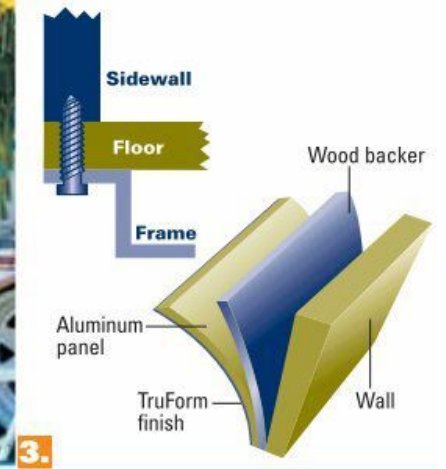

### Eagle Summit Package Option



1. 2.



4.



3.

1. Our beautiful new lighter Fairfield Oak cabinets have the strength to last. We build cabinet doors using traditional, strong mortise-and-tenon joints. And we use real-wood drawers, not plastic tubs.
2. The sofa slideout on the Rainier model, with its convertible sofa bed, gives you extra space for overnight guests.
3. Enjoy one of the things you miss most while camping with the Laurel bath/shower. The deluxe plumbing package, standard on all Heritage models, also includes a water heater, demand pump and outside shower.
4. To give you more living space, we offer dinette slideouts in the Laurel, Potomac and Manistee models. And our end bunks add even more space for sleeping.

## *Heritage™ camping trailers*

Family camping trips have changed a lot over the years. But your desire to get close to nature hasn't. To satisfy that desire, and to take advantage of the newest technologies, we created Heritage™ camping trailer to be the most advanced and most comfortable ever built. Heritage gives families like yours all the features you need to experience the fun of the great outdoors.

Starting in the galley, Heritage shows just how home-like a stay in the wilderness can be. Our exclusive **Fairfield Oak cabinets** are warm and inviting. **Dinette slideouts** give you plenty of elbow room for everyone during meals. When it's time to leave, cleanup is easy with new **Armstrong ToughGuard™ no-wax vinyl flooring** and the **mildew-resistant fiberglass ceiling**. When you're ready for bed, you can use the Laurel's **bath/shower** to clean up. Then sleep easy on the soft, **quilted bunk mattresses**. The Rainier's **J-Flex sofa slideout** gives room for your guests to enjoy the same comfortable night's rest.



*Laurel Interior*



**1.** The front trunk gives you plenty of storage space so you won't have to leave your gear out in the weather or take up valuable inside space. The patented gull-wing doors and interior hatch door (most models) give you easy access from any location, even when the bunks are set up. **2.** The carryout dinette table gives you the choice of meals inside or outside. (Standard on all campers.) **3.** Simply unplug the three-burner range and plug it in outside for an outdoor dinner. **4.** Jayco sidewalls are a major factor in Heritage's popularity with campers. Fastened directly to the frame, the sidewalls are a thick .040" aluminum exterior laminated to a foam backer for extra strength. The exterior surface does not ripple or dent as easily as "single" layer walls, and, with the standard TruForm, scratch-resistant finish, they stay good-looking year in and year out. **5.** We build the Heritage roof from tough fiberglass. The seamless roof is domed to shed water and strong enough to support bikes, cargo or even a roof-mounted air conditioner without the need for extra reinforcement.

## Heritage™ camping trailers

All around Heritage, you'll see more features aimed at making your stay easier than you'll find on most campers. Cranking down the **stabilizer jacks** once you reach your site takes little effort. Whether you like eating inside or outside, you can do either with the **carryout range** that easily moves from galley to the outside so you can cook outdoors. Then you can do the same with the **carryout dinette table**. When you're done with dinner, store your gear in the **front trunk** and you'll be able to retrieve it quickly through wide patented gull-wing doors or interior hatch.

You'll also see a number of reasons why Heritage will continue to make camping fun, season after season. The thick **.040" aluminum exterior laminated sidewalls** with **TruForm® scratch-resistant finish** will keep looking good for years. At each end, the **fiberglass front and rear body panels** guard against bumps and dings. The **powder-coated steel bumper** adds another layer of protection to the rear. And the **one-piece, domed fiberglass roof** is so strong you can haul extra cargo without needing reinforcement.



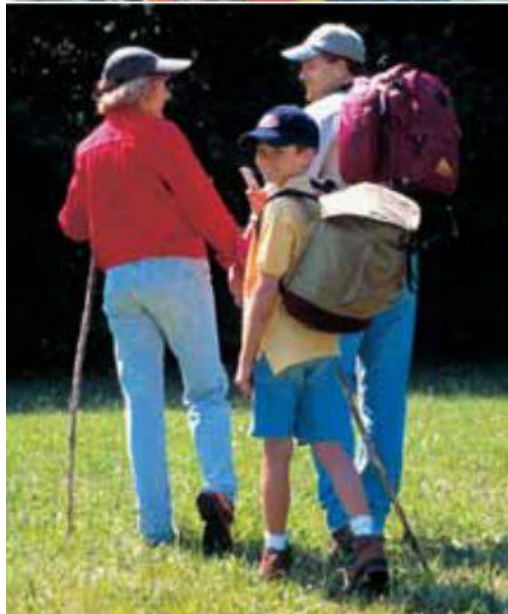

**1.** The optional matching NapSak™ with pillowcase lets you curl up in comfort. **2.** Part of Jayco's optional SofStor™ storage system, the Heritage Clothes Hanger, gives you a place to keep clothes so they stay looking nice and out of the way. **3.** Keep track of the status of all your systems with the optional monitor panel.

## *Heritage™ camping trailers*

Even though Heritage™ comes loaded with a variety of camper-friendly features, it gives you plenty of other choices to make your camper fit your unique needs. Get more places to keep your things with the optional **SofStor™ storage system**. One component, the **Heritage Clothes Hanger**, lets you hang items instead of stuffing them in a bag. Choose an optional color-coordinated **NapSak™** and you won't have to search for a sleeping bag. The optional **monitor panel** lets you keep tabs on your systems so you'll know if there's a problem.

**1.** A handy pass-through refrigerator is available on the Rainier model only. This optional 12V, 4-cu.-ft. refrigerator gives you convenient access to your food from both inside and outside the camper. A 2.5-cu.-ft., 3-way (12V/110V/LP gas) refrigerator comes standard. **2.** Get an optional molded fiberglass wheel cover to protect your spare. **3.** An optional spare tire can come to the rescue so you're not left stranded. **4.** An optional aerodynamic fiberglass gas bottle cover protects and enhances your camper's good looks.

Other choices make your Heritage™ camping trailer even better on the outside. An optional **spare tire** helps in emergencies, and the optional **molded fiberglass wheel cover** keeps it safe. Choose **twin 20-lb. LP gas bottles with automatic gas regulator** and you'll get enough fuel for cooking your food and keeping it fresh. The optional **bottle cover** makes for a more streamlined appearance. And you can even reach food from outside in the optional **12V, 4-cu.-ft. pass-through refrigerator** on Rainier. A **2.5-cu.-ft. 3-way refrigerator** is standard.



1.



2.



3.

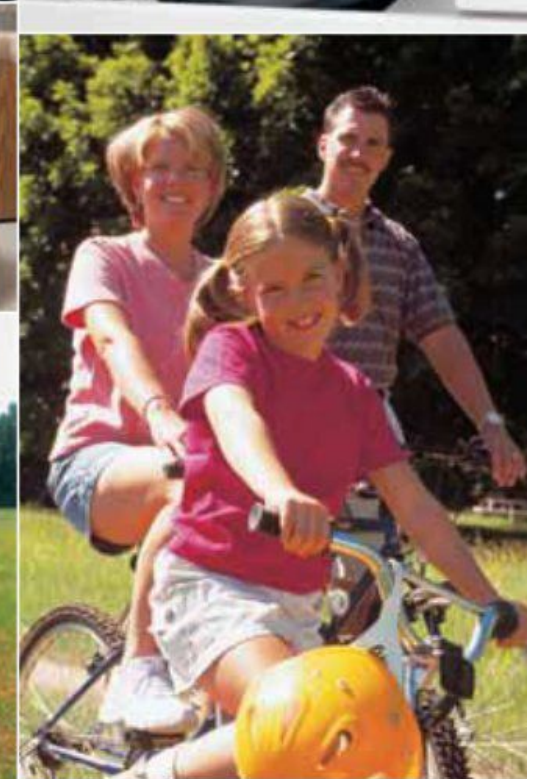

4.





1.



2.



3.

1. Enjoy the outside air in your optional deluxe screen room. Roll-down tent panels give you extra privacy or protection against bad weather. ● ■ ▲ 2. Our optional portable gas barbecue grill lets you get that great grilled flavor. And it comes with a handy carrying case. ● ■ ▲ 3. Store camping items such as folding lawn chairs, garden hoses, barbecue utensils or other dirty items in the optional OutStor™ organizers to keep the inside of your camper clean. Also, protect additional stored items with removable vinyl bunk skirting. ● ■ ▲

## *Qwest™, Eagle™ and Heritage™ camping trailers*

No matter which Jayco camping trailer you choose, you'll enjoy everything the outdoors has to offer. The optional **deluxe screen room** lets you breathe the fresh breeze blowing in from the lake without having to fight mosquitoes. At dinnertime, grill outside on the optional **portable gas barbecue grill**, which comes with a handy **carrying case**. When you're done, put your dirty camping items in the optional **OutStor™ organizers** or behind the optional **removable vinyl bunk skirting** so you don't have to find space for them inside.

You'll also enjoy the other conveniences we build into every Jayco camping trailer. For example, you can get inside the camper any time because the **entrance door opens even when the roof is down**. The

● Qwest ■ Eagle ▲ Heritage

1. An optional color-coordinated wheel cover protects your spare. ● ■
2. The deluxe plumbing package (not available on Eagle 10 SG) includes a water heater, demand pump and this outside shower with hot and cold faucets, rugged ABS plastic hose and shower head. (Optional on Eagle; standard on Heritage Laurel). ■ ▲
3. The optional spare can come to the rescue so you're not left stranded. ● ■ ▲
4. Read, play a game or just talk into the night using the patio or porch light. ● ■ ▲
5. An optional color-coordinated gas bottle cover protects and enhances your camper's good looks. ● ■



**wide-body construction** gives you more interior space. And we give you the choice of **electric** or **hydraulic surge brakes**. Electric brakes are standard on Eagle (optional on 10 UD, 10 FS and 10 SG) and Heritage and optional on Qwest; hydraulic surge brakes are optional for all models. (Hydraulic brakes are optional on Qwest 12 A.)

Other amenities to make your life easier include the **exterior shower**, so you can clean off and leave dirt outside. Each camper offers a **patio** or **porch light** so nightfall won't end your activities. An optional **spare tire** means you won't be sitting on the roadside instead of at the campsite. Add a color-coordinated **vinyl wheel cover** to your spare, and a **vinyl gas bottle cover**, for some attractive accents.

● Qwest ■ Eagle ▲ Heritage



1.



2a



2b



2c



3.



1. Choose the optional KidStuf™ bunk organizers to give kids a place for their toys, books and other items. ● ■ ▲ 2. Jayco's optional SofStor™ storage system keeps you from tripping over all of your personal necessities by keeping them out of the way but within easy reach. Choose from the Overhead galley cabinet (a) for food and other essentials, the Organizer for shoes (b) and other small items and the SofStor Wardrobe (c) with removable shelves for clothing. ■ ▲ 3. A 14" x 14" roof vent gives you more fresh air (optional on Qwest and Eagle, standard on Heritage). ● ■ ▲

## *Qwest™, Eagle™ and Heritage™ camping trailers*

Every Jayco camping trailer works hard to make your stay as comfortable as possible. With our optional **SofStor™ storage system** (Eagle and Heritage), you'll have a convenient place for all your family's things so you can enjoy more interior space. The **Wardrobe** holds your clothes, the **Organizer** handles smaller items and the **Overhead galley cabinet** gives a place to store food. Get even more storage with optional **KidStuf™ bunk organizers** that provide room for your kids' stuff. An optional **AM/FM stereo with cassette or CD** in Eagle and Heritage surrounds you with sound through **ceiling-mounted speakers**. After dark, relax and enjoy a good book under the soft glow of the optional **end bunk lights**.

You can get comfortable in the galley, too. Have a cold snack from the

● Qwest ■ Eagle ▲ Heritage

- 1.** Enjoy your favorite music anywhere you go with the optional AM/FM stereo with cassette or CD player and two ceiling-mounted speakers. ■ ▲ **2.** No more huddling next to a lantern. One or two end bunk lights give you ample light for reading, playing games, or whatever night activity you choose. ■ ▲ **3.** Choose the convenient 2-cu.-ft., 3-way (12V/110V/LP gas) Norcold® refrigerator. ● ■ A 12V-only refrigerator is also available. ■ ▲ **4.** A large-capacity, self-draining ice box lets you keep food without needing a bulky cooler. ● ■

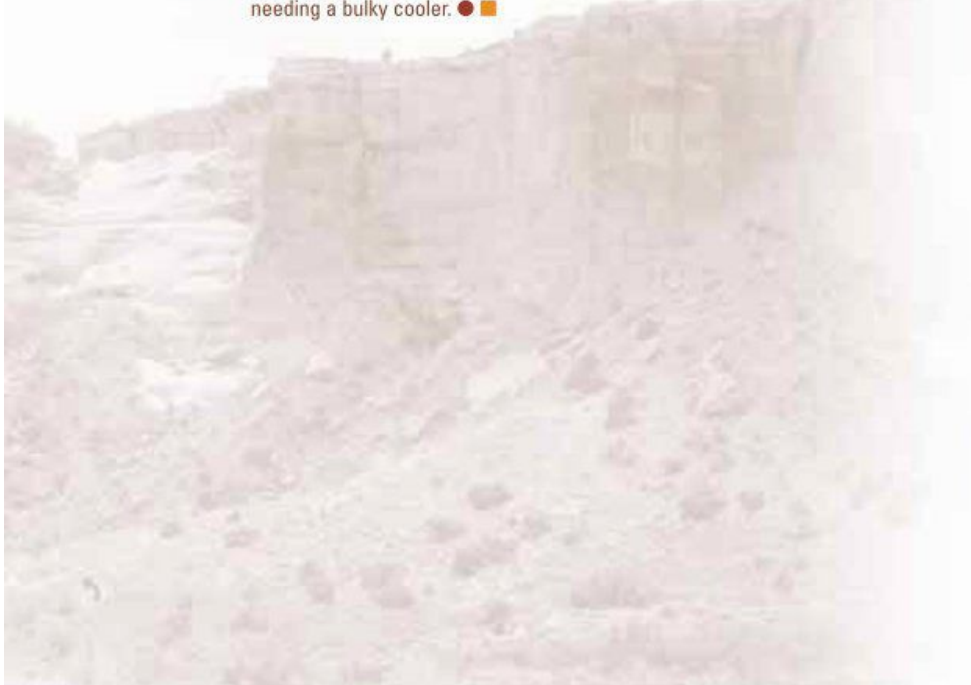

optional **2-cu.-ft., 3-way Norcold® refrigerator** or standard **ice box** (Qwest and Eagle). And rest assured your utensils and other galley items will stay put because the new **high-tension roller cabinet catches** hold the doors closed more securely during travel.

You'll also stay comfortable no matter what season you travel. The **roof vent** creates better air circulation, and the optional **16,000-BTU furnace** lets you extend your travel season and keep warm even if the temperature drops at night. The optional **prep for air conditioning** allows you to install a unit to stay cool during hot summer months. Jayco is the only company that offers a roof strong enough to support an air conditioner without needing any extra support, so you won't need to modify your camper.

● Qwest ■ Eagle ▲ Heritage





1.



2.

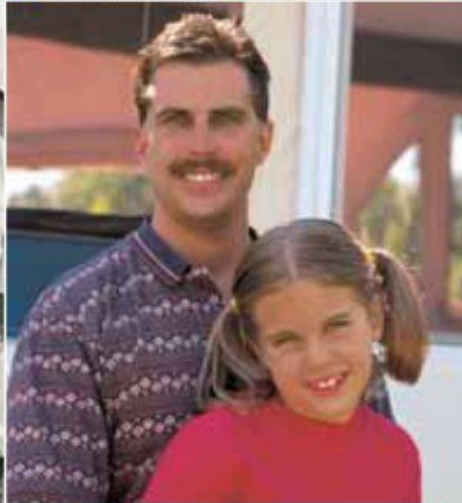

3.

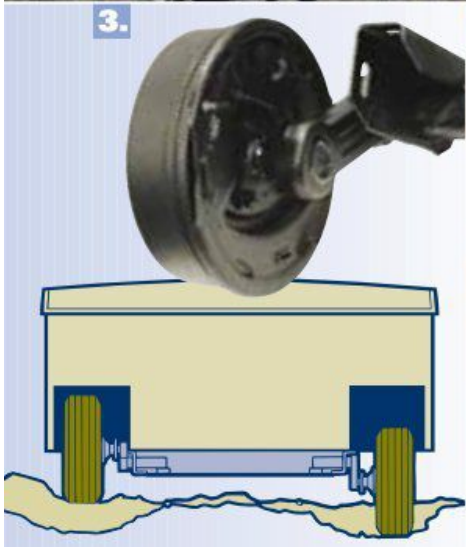

4.

**1.** We construct the end bunks so well that they're able to handle loads of weight. Made from 5-ply exterior grade, weather-treated plywood, the bunks are mounted on a steel slide with smooth rollers to make setup easy. You'll be able to set up your camper in minutes without wearing yourself out, and with the confidence that it will hold up like it should. ● ■ ▲

**2.** In the heart of the Midwest, old-world craftsmen have handed down tried-and-true construction methods from generation to generation. At our headquarters in Middlebury, Indiana, Jayco continues this tradition when building all of our recreational vehicles. Our rugged designs, solid construction and commitment to quality add up to a well-built vehicle you can depend on for years. **3.** TorFlex® independent torsion-axle suspension gives a smooth ride and makes towing easier by absorbing bumps better than standard springs. And with more ground clearance than leaf springs, you can take your camper over terrain that's less than ideal. A smoother ride and fewer hard bumps mean less wear and tear on the whole camper. ■ ▲ **4.** We build a rugged frame using a 12-stage E-Coat finishing system to give it resistance against corrosion, and use a Z-shaped perimeter to give it unibody strength and stability and prevent floor sag. With a solid foundation, your Jayco camper is built to withstand years of use. ● ■ ▲

## *Qwest™, Eagle™ and Heritage™ camping trailers*

We build Jayco camping trailers to be the toughest, longest-lasting on the road to give you years of trouble-free family camping fun. Camper bunks can support plenty of weight without straining and slide out easily so you won't have to struggle setting them up. Our **one-piece, double-stitched, water-repellent BoltaFlex CT™ tent closures** repel the worst weather and the most annoying insects, vacation after vacation.

When you reach your site, our **patented lifter system** (Eagle and Heritage) makes roof raising simple. The conveniently positioned

**1. (A.)** We put our lifter-system crank at a comfortable height. You don't have to bend way over or scrape your knuckles on the ground to use it. We also made it easier to turn, so setup is easy. **(B.)** It's OK to stop cranking. The automatic brake on our lifter-system winch helps prevent the roof from falling before it's all the way up. **(C.)** For years of trouble-free operation, we use nylon bushings in our lifter posts. This reduces friction, wear and tear. **(D.)** Jayco uses tubular lifter posts instead of C-channels. Tubular posts are stronger. They have smooth walls and no edges to chafe or soil the tent. They also have no openings. Fingers can't get inside! **(E.)** Stop worrying about cables or pulleys getting caught in lifter posts. It won't happen in a Jayco camping trailer. Strong, flexible push-rods guide the roof up as you crank. **■▲2.** Strong push rods raise the roof and won't jam, unlike cables or pulleys. ●■▲**3.** Our one-piece, double-stitched, water-repellent BoltaFlex CT™ tent closures employ Jayco's unique Velcro® system. As a result, they keep out bugs and drafts and stand up to the elements for years. ●■▲

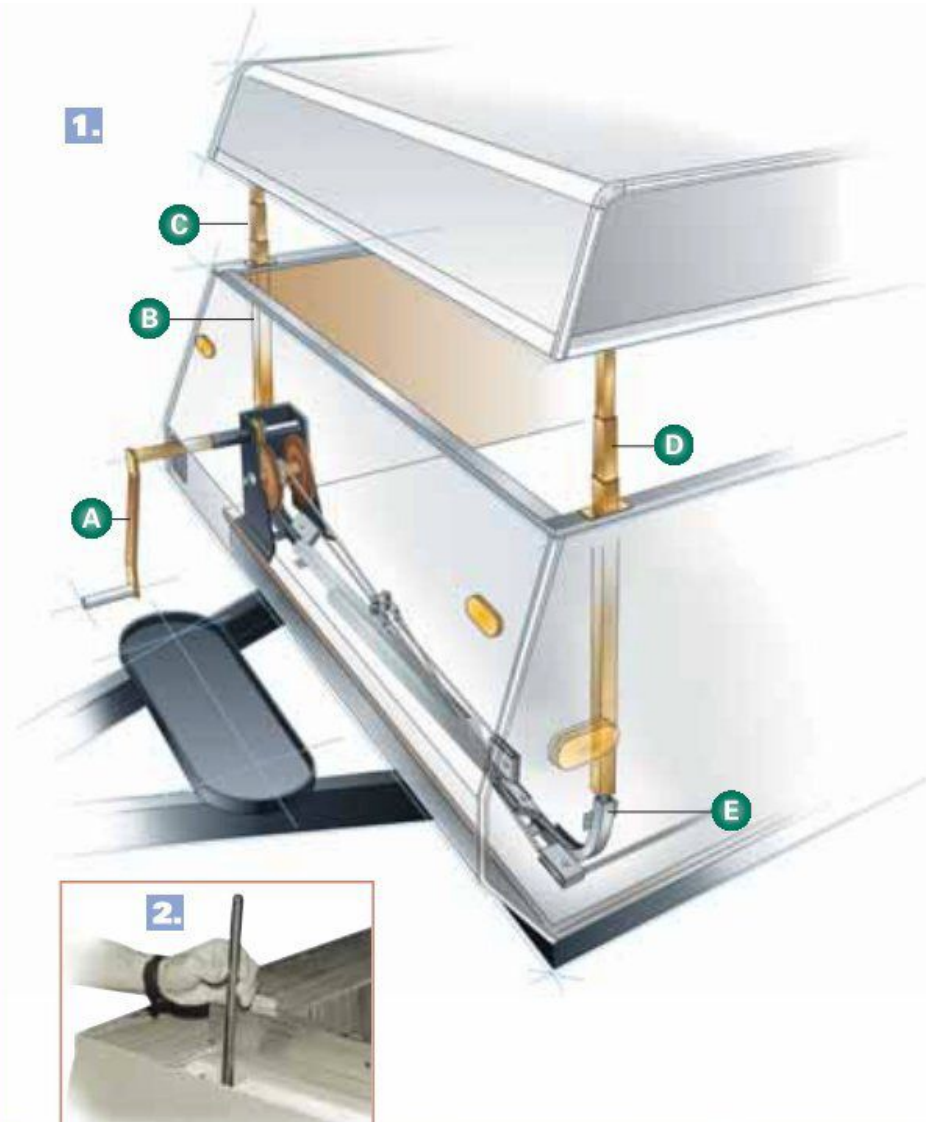

crank extends the tubular lifter posts, which won't chafe or soil the tent or catch your fingers like C-channels can. And the strong **push rods** work better than cables or pulleys because they can't jam.

We mount everything atop a frame protected by a special **E-coat finishing system** that guards against rust. The **Z-shaped perimeter** makes the body and floor more rigid. The **Tor-Flex® independent torsion-axle suspension** (Eagle and Heritage) softens your ride over rough roads and terrain so your camper holds up better over all those miles.

● Qwest ■ Eagle ▲ Heritage



# 2002 Eagle™ Camping Trailer Floorplans

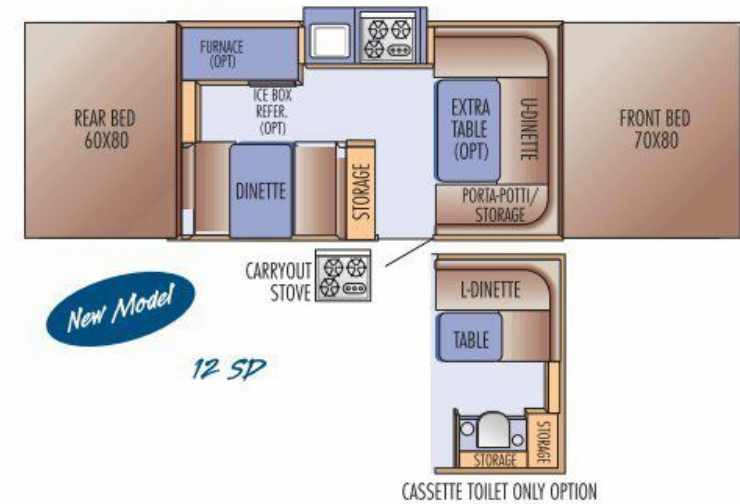
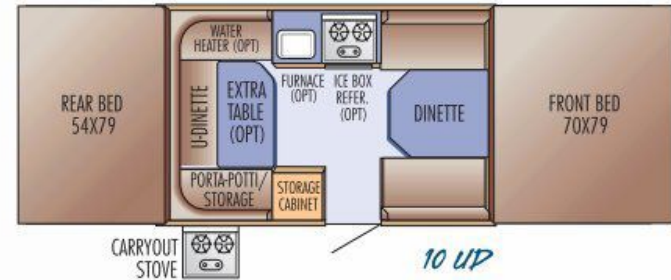
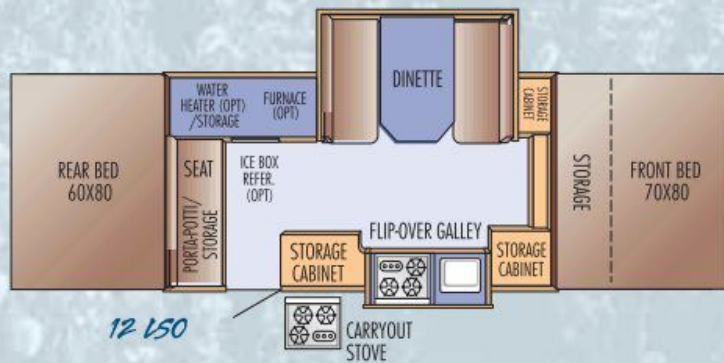
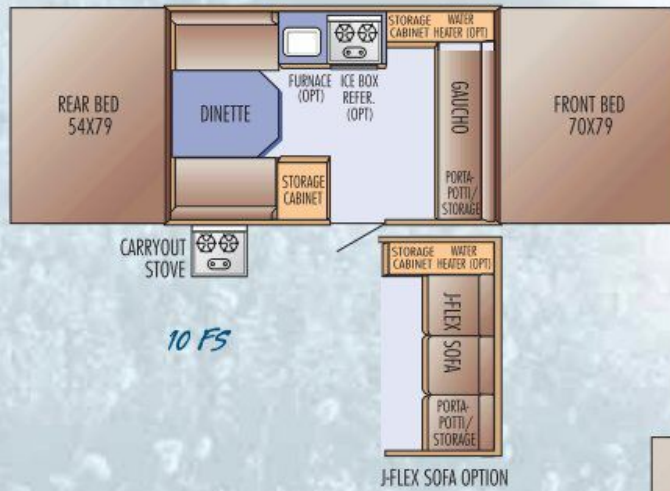

## 2002 Eagle™ Camping Trailer Floorplans Continued

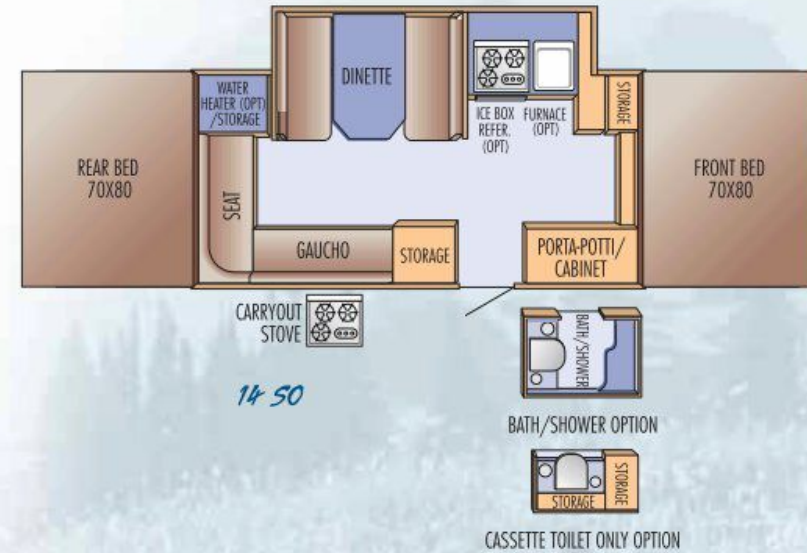
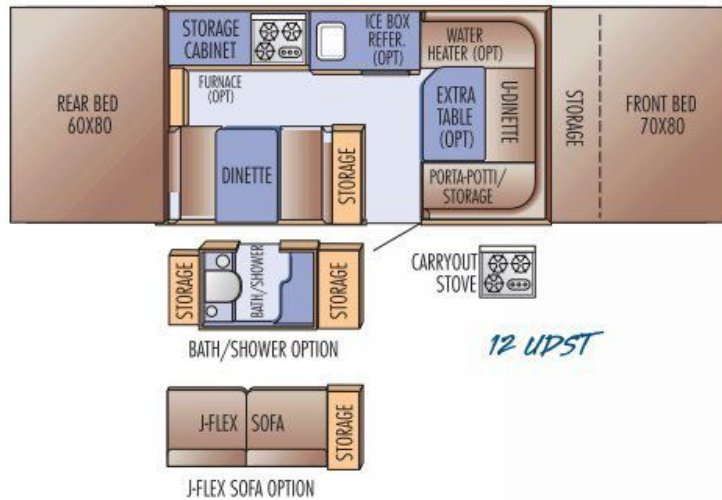

### Eagle™ Specifications

Model	Travel Length	Campsite Length	Approx. Travel Height	Fresh Water Capacity (gals.)	Unloaded Vehicle Weight (w/std. equip.) (lbs.)	Approx. Hitch Weight (lbs.)	Gross Vehicle Weight Rating (lbs.)	Cargo Carrying Capacity (w/out options) (lbs.)	Sleeping Capacity
10 SG	14'10"	21'6"	50 1/4"	5	1480	150	2210	730	7
10 UD	14'10"	21'6"	50 1/4"	5	1475	170	2210	735	7
10 FS	14'10"	21'6"	50 1/4"	5	1610	160	2210	600	7
12 SD	16'10"	24'	57"	17	2035	225	2800	765	6
12 LSO	18'10"	24'	57"	17	2280	330	3000	720	6
12 FSO	18'10"	24'	57"	17	2315	320	3000	850	7
12 UDST	18'10"	24'	57"	17	1925	260	2800	875	7
14 50	18'10"	26'	57"	17	2605	280	3330	725	7

**Unloaded Vehicle Weight (UWV):** Sometimes referred to as "Dry Weight," UWV means the typical weight of this trailer as built at the factory. The UWV, as used in product literature and other promotional materials, does not include cargo, fresh water, LP gas, options or dealer-installed accessories.

**Gross Vehicle Weight Rating (GVWR):** GVWR means the maximum permissible weight of the trailer, including the UWV plus passengers, personal items, all cargo, fluids, options and dealer-installed accessories. The GVWR is equal to or greater than the sum of the UWV and the CCC.

**Cargo Carrying Capacity (CCC):** CCC means the maximum weight of all passengers, personal items, food, fresh water, LP gas, tools, other cargo and dealer-installed accessories that can be carried by the trailer. CCC is equal to or less than GVWR minus UWV.

\*The addition of options will decrease the CCC.

It is important for your safety and enjoyment that your tow vehicle be adequately sized and equipped to tow and handle the GVWR of the RV you select. Review weights and rating of your tow vehicle and consult a competent advisor for questions

or advice. Whether you are new to RVing or a veteran, get a feel for the performance of your tow vehicle and the RV together before heading out on the roadways. **When you tow an RV, you must drive differently than you do when driving a single vehicle.** Practice hooking up, driving, backing up and braking in a safe environment or seek out professional instruction.

See specification chart above. Jayco affixes a weight label to each new RV which lists weight information for that vehicle.

# 2002 Heritage™ Camping Trailer Floorplans

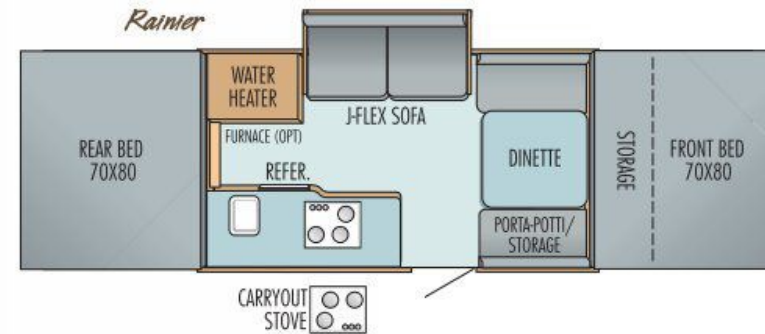
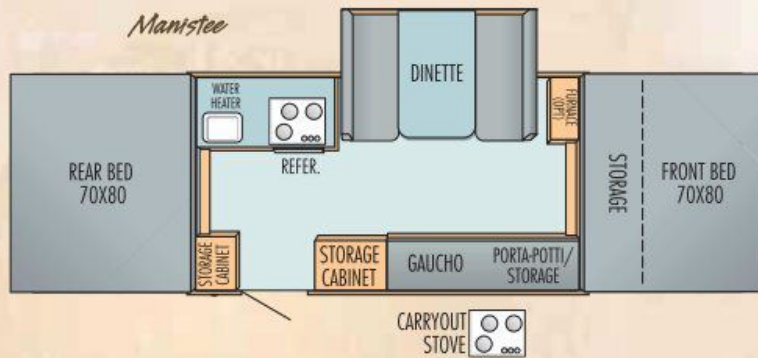
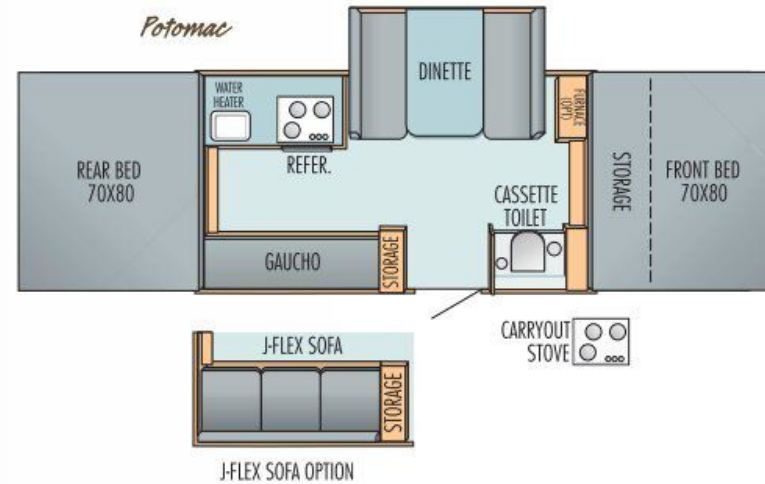
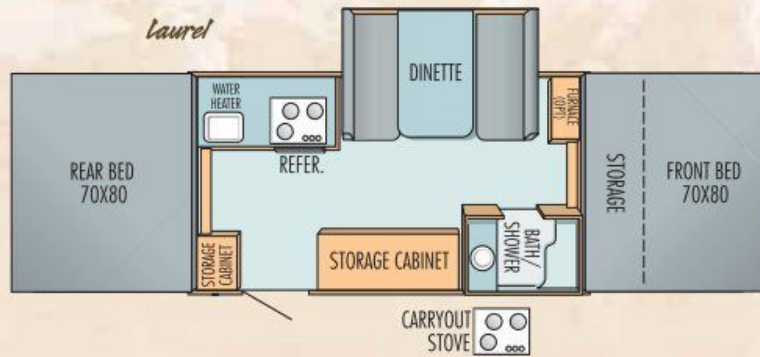

## Heritage™ Specifications

Model	Travel Length	Campsite Length	Approx. Travel Height	Fresh Water Capacity (gals.)	Unloaded Vehicle Weight (w/std. equip.) (lbs.)	Approx. Hitch Weight (lbs.)	Gross Vehicle Weight Rating (lbs.)	Cargo Carrying Capacity (w/out options) (lbs.)	Sleeping Capacity
Laurel	18'11"	24'	61"	23	2660	345	3375	715	6
Manistee	18'11"	24'	61"	23	2595	410	3375	780	7
Potomac	18'11"	24'	61"	23	2690	380	3375	685	7
Rainier	18'11"	24'	61"	23	2475	365	3175	700	7

**Unloaded Vehicle Weight (UVW):** Sometimes referred to as "Dry Weight," UVW means the typical weight of this trailer as built at the factory. The UVW, as used in product literature and other promotional materials, does not include cargo, fresh water, LP gas, options or dealer-installed accessories.

**Gross Vehicle Weight Rating (GVWR):** GVWR means the maximum permissible weight of the trailer, including the UVW plus passengers, personal items, all cargo, fluids, options and dealer-installed accessories. The GVWR is equal to or greater than the sum of the UVW and the CCC.

**Cargo Carrying Capacity (CCC):** CCC means the maximum weight of all passengers, personal items, food, fresh water, LP gas, tools, other cargo and dealer-installed accessories that can be carried by the trailer. CCC is equal to or less than GVWR minus UVW.

\*The addition of options will decrease the CCC.

It is important for your safety and enjoyment that your tow vehicle be adequately sized and equipped to tow and handle the GVWR of the RV you select. Review weights and rating of your tow vehicle and consult a competent advisor for questions

or advice. Whether you are new to RVing or a veteran, get a feel for the performance of your tow vehicle and the RV together before heading out on the roadways. **When you tow an RV, you must drive differently than you do when driving a single vehicle.** Practice hooking up, driving, backing up and braking in a safe environment or seek out professional instruction.

See specification chart above. Jayco affixes a weight label to each new RV which lists weight information for that vehicle.

# 2002 Qwest™ Camping Trailer Floorplans

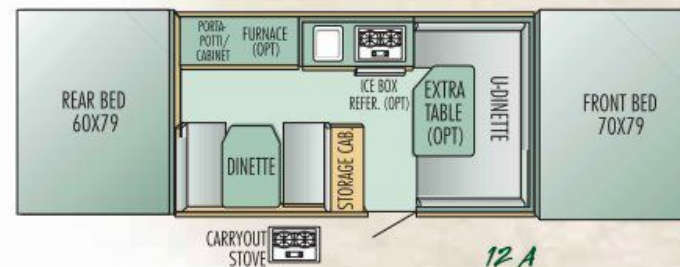
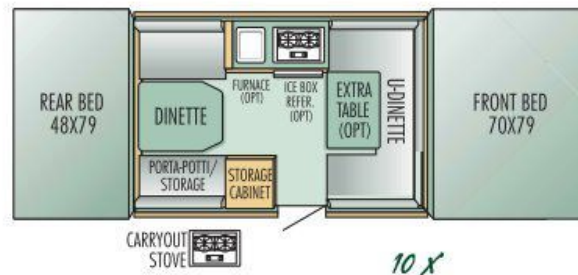
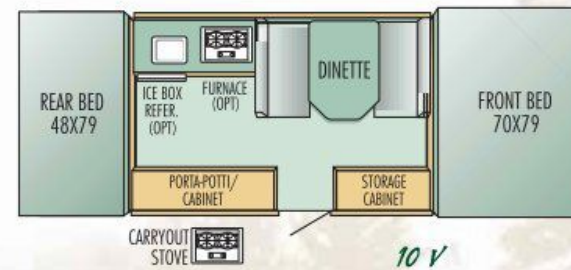
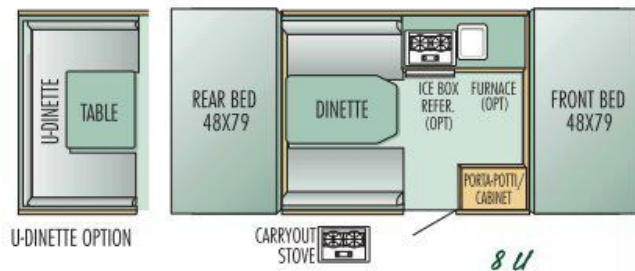

## Qwest™ Specifications

Model	Travel Length	Campsite Length	Approx. Travel Height	Fresh Water Capacity (gals.)	Unloaded Vehicle Weight (w/std. equip.) (lbs.)	Approx. Hitch Weight (lbs.)	Gross Vehicle Weight Rating (lbs.)	Cargo Carrying Capacity (w/out options) (lbs.)	Sleeping Capacity
8 U	12'	16'3"	52 <sup>1</sup> / <sub>4</sub> "	5	1160	165	1875	715	6
10 V	13'10"	20'1"	52 <sup>1</sup> / <sub>4</sub> "	5	1235	215	2160	925	6
10 X	13'10"	20'1"	52 <sup>1</sup> / <sub>4</sub> "	5	1220	175	2160	940	7
12 A	15'10"	24'	52 <sup>1</sup> / <sub>4</sub> "	10	1635	260	2700	1065	7

**Unloaded Vehicle Weight (UVW):** Sometimes referred to as "Dry Weight," UVW means the typical weight of this trailer as built at the factory. The UVW, as used in product literature and other promotional materials, does not include cargo, fresh water, LP gas, options or dealer-installed accessories.

**Gross Vehicle Weight Rating (GVWR):** GVWR means the maximum permissible weight of the trailer, including the UVW plus passengers, personal items, all cargo, fluids, options and dealer-installed accessories. The GVWR is equal to or greater than the sum of the UVW and the CCC.

**Cargo Carrying Capacity (CCC):** CCC means the maximum weight of all passengers, personal items, food, fresh water, LP gas, tools, other cargo and dealer-installed accessories that can be carried by the trailer. CCC is equal to or less than GVWR minus UVW.

\*The addition of options will decrease the CCC.

It is important for your safety and enjoyment that your tow vehicle be adequately sized and equipped to tow and handle the GVWR of the RV you select. Review weights and rating of your tow vehicle and consult a competent advisor for questions

or advice. Whether you are new to RVing or a veteran, get a feel for the performance of your tow vehicle and the RV together before heading out on the roadways. **When you tow an RV, you must drive differently than you do when driving a single vehicle.** Practice hooking up, driving, backing up and braking in a safe environment or seek out professional instruction.

See specification chart above. Jayco affixes a weight label to each new RV which lists weight information for that vehicle.



## 2002 QWEST™, EAGLE™, & HERITAGE™ CAMPING TRAILER OPTIONAL FEATURES

OPTIONAL FEATURES	QWEST™ CAMPING TRAILER	EAGLE™ CAMPING TRAILER	HERITAGE™ CAMPING TRAILER	OPTIONAL FEATURES	QWEST™ CAMPING TRAILER	EAGLE™ CAMPING TRAILER	HERITAGE™ CAMPING TRAILER
Spare Tire	■ ✓	■ *	■ ○	J-Flex™ Sofa in lieu of dinette (12 UDST)		■	
Vinyl spare tire cover	■	■		J-Flex™ Sofa in lieu of gauchó (10 FS, Potomac)		■	■
Fiberglass spare tire cover			■ ○	Extra dinette table w/pedestal leg (10 UD, 12 UDST, 12 SD, 10 X, 12 A)	■	■	
Outside portable gas barbecue grill w/carrying case	■	■	■	U-dinette in lieu of standard dinette (8 U)	■		
Hydraulic surge brakes (12 A Qwest™, all Eagle™ & Heritage™)	■	■	■	SofStor™ Overhead storage (1 or 2)		■	■
Electric brakes (Qwest™ 10 UD, 10 SG, 10 FS)	■	■		SofStor™ Wardrobe storage		■	■
Canopy/screen room/deluxe screen room	■	■	■	SofStor™ Organizer		■	■
Self-storing step (Qwest™ 10 UD, 10 SG, 10 FS)	■ ✓	■		OutStor™ Storage Package	■	■	■
Prep for air conditioning	■	■ *	■ ○	Removable vinyl bunk skirt	■	■	■
2-cu.-ft. 110V/12V/LP gas refrigerator	■	■		End-bunk privacy curtains	■ ✓	■ *	
12V refrigerator		■	■	14" x 14" roof vent	■ ✓	■ *	
12V pass-through refrigerator (Rainier)			■	10-gal. fresh water tank (10 UD, 10 SG)		■	
Twin 20-lb LP gas bottles with automatic gas regulator			■	Front stabilizer jacks (8' & 10' models)	■	■	
Fiberglass gas bottle cover			■ ○	Bath/shower package (includes privacy curtain and Deluxe Plumbing Package/12 FSO, 12 UDST, 14 SO)		■	
Vinyl gas bottle cover	■ ✓	■ *		Deluxe plumbing package (includes water heater, demand pump and outside shower; n/a on 10 SG)		■	
16,000-BTU furnace with auto-ignition	■	■	■	Summit package (bottom radius wrap, front & rear ABS caps, ABS fender skirt)		■	
Monitor panel			■ ○	AM/FM cassette or CD stereo		■	■
End-bunk lights (2)		■ *	■ ○	Cassette toilet (14 SO, 12 FSO, 12 SD)		■	
NapSak™ w/pillowcase (1, 2, 3 or 4)		■	■				
KidStuf™ bunk organizer	■	■	■				

✓ These options are part of the Convenience Group for Qwest™

\* These options are part of the Convenience Group for Eagle™

○ These options are part of the Convenience Group for Heritage™

### Jayco delivers responsive, reliable after-market customer service

When you purchase a Jayco Recreational Vehicle, you'll also get a support staff dedicated to meeting the needs of you and your dealer. To deliver on this promise, we built a 91,000-square-foot, state-of-the-art facility that seamlessly integrates our Warranty, Customer Service and Jay Parr parts divisions (After Market Services — AMS). Staff from each division can now work more closely together to better provide prompt, accurate service.

For example, the AMS staff can quickly access information on the computer and service representatives can better serve the needs of Jayco dealers and retail customers. Our service area contains 15 bays that feed into a spacious work area for customers who need assistance during their travels through Indiana.



The Parts and Warranty divisions take advantage of our Jayco Xpress online computer network that links Jayco Customer Service to dealers across the country and allows them to place parts orders, check the status of an order

and check pricing and availability. Dealers participating in the online system can also register new Jayco owners 24 hours a day, seven days a week. That way, when you pull off the dealer's lot, your new unit is already registered with the factory.

Our parts warehouse, equipped with automated carousels and stocked with a large inventory of parts, can provide our dealers with the parts you need so you can get back on the road to enjoying your vacation.

You won't find a more caring after-market service group in the recreational vehicle industry. That's our goal and commitment to you.



## *We back what we build*

The Jayco **2+3 Warranty** is a manufacturer's warranty. It doesn't come from your dealer, and it's not an extended warranty! It comes from the people who build Jayco recreational vehicles to the people who buy them. Each Jayco is warranted to the original purchaser for twenty-four (24) months from the date of purchase against defects in materials and workmanship. This is full hitch-to-bumper coverage on towables and bumper-to-bumper on motorized RVs. The Jayco warranty includes a three-year (3) structural guarantee. In addition, our warranty is transferable within the first two (2) years for a \$100 processing fee. Go ahead and compare the Jayco warranty with other manufacturers' warranties. You'll find it's the best in the business! For a copy of the warranty with full terms and conditions, ask your local Jayco dealer or visit our Web site.

**Lifetime Coverage** On all camping trailers, Jayco offers to the original purchaser additional industry-leading lifetime parts and labor coverage on our lifter system, roof, floor and frame. We also offer three-year (3) coverage on our tent with parts, labor and freight covered the first year; parts, factory labor and return freight the second and third year.

See above dealer for further information and prices.

**You're in Jayco Country**



Jayco, Inc. P.O. Box 460 Middlebury, IN 46540  
[www.jayco.com](http://www.jayco.com)



As a Jayco owner, you can be part of the Jayco Jafari International Travel Club. Ask your dealer about the Jafari "flight" in your area, write Jayco direct or visit our Web site.

**Please Note:** All information in this brochure is the latest available at the time of publication approval. Jayco reserves the right to make changes and to discontinue models without notice or obligation.

Pictures in this brochure may show optional equipment. RVs built for sale in Canada may differ to conform to Canadian codes.

Printed on recycled paper.



©2001 Jayco, Inc. 0901-125M Litho in U.S.A.