

# MARQUIS 2003



Beaver





## LIVE LARGE.

We've equipped the Marquis with standards like the 42-inch ceiling-mounted plasma television, plush carpeting with hand-set inlays, wainscoting and fabric-padded walls

and ceiling. Seating is abundant but a favorite spot is likely to be the UltraLeather™ Euro recliner with ottoman. The fabric sleeper sofa makes it easy to have extra guests or

travelers, and a hidden drawer stows extra blankets and games.

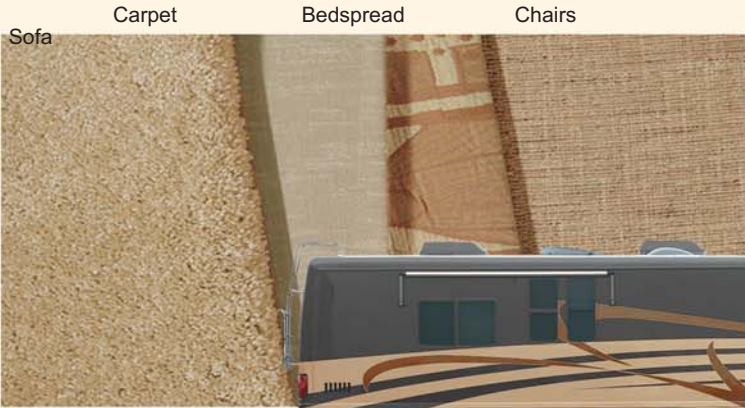

AZTEC COPPER



GRAND ESTATE

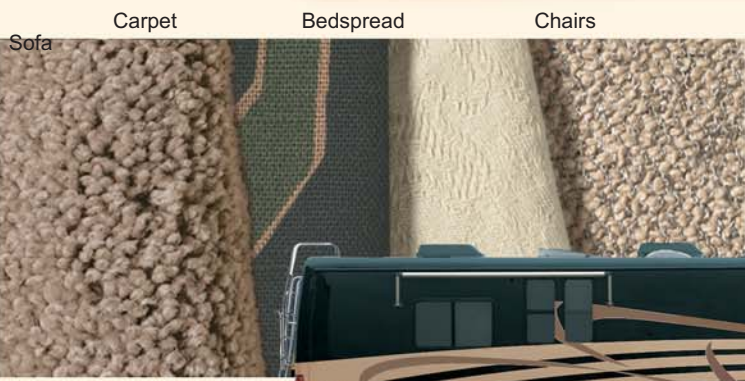

PALOMA PICASSO  
CARAVAN



**MARQUIS  
COLORS**

*A Beaver coach can include as many as 60 doors, 45 cabinets, 40 drawer faces and literally hundreds of wood elements and finished wood accessories.*

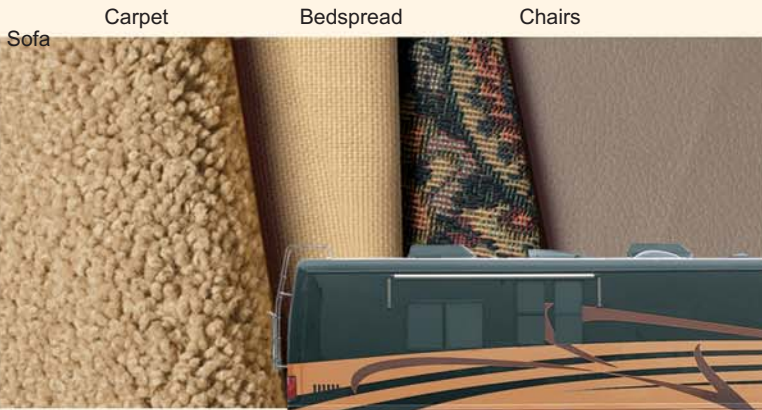

PROVINCETOWN

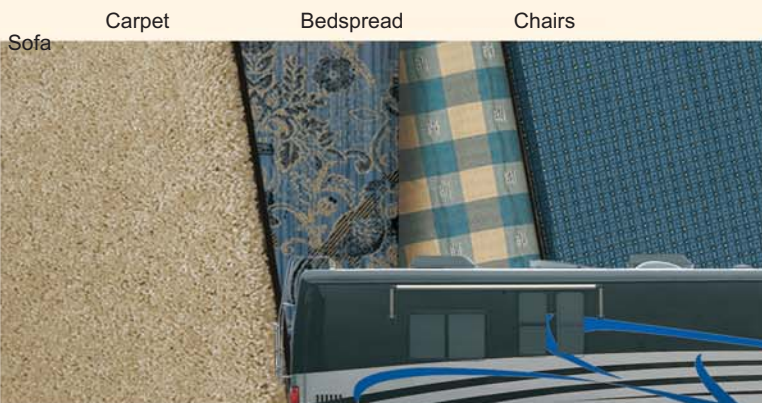

TOURMALINE



PALOMA PICASSO  
COSMOPOLITAN



- Walnut with Walnut Burl (Option)
- Cherry with Makori (Option)
- Walnut with Mappa Burl (Option)
- Cherry with Mappa Burl (Option)
- White Maple with Mappa Burl (Option)



# MARQUIS FLOORPLANS

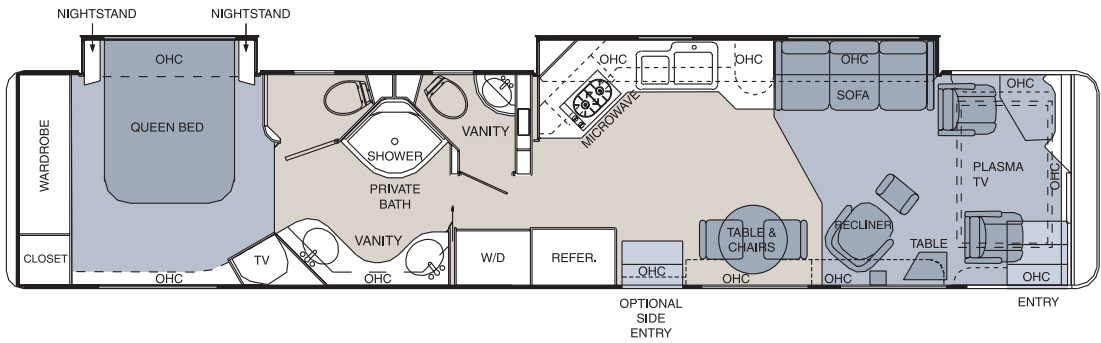
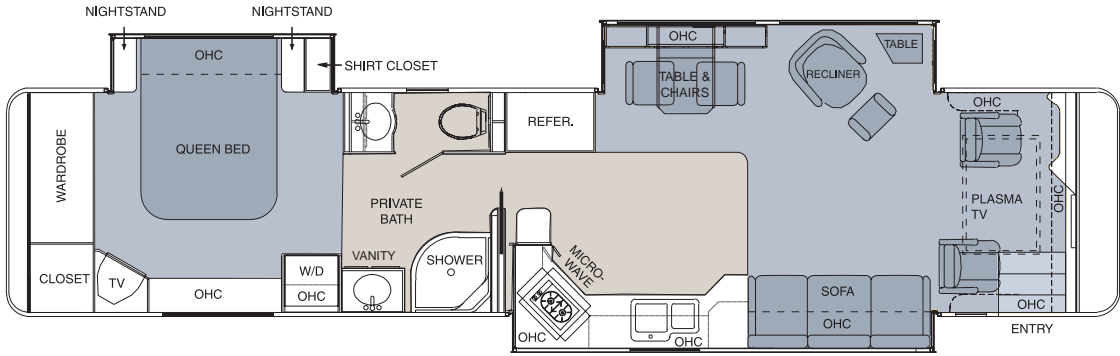
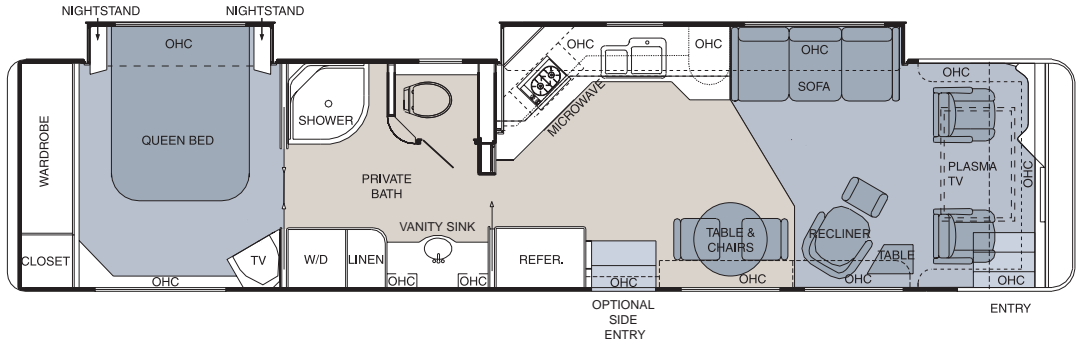

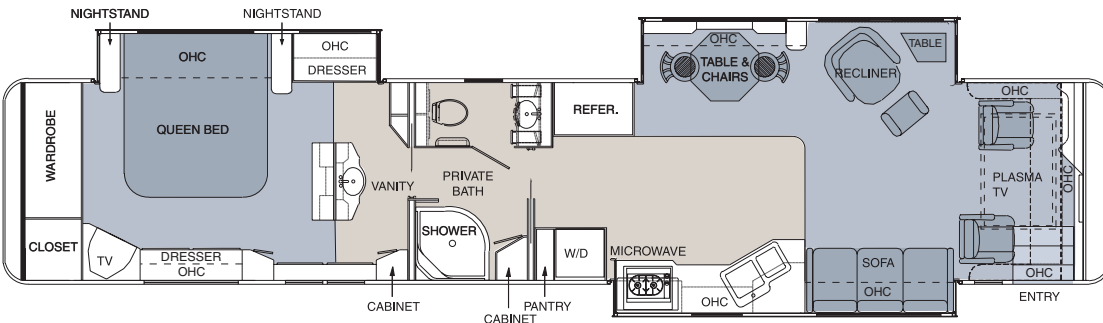
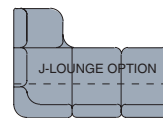
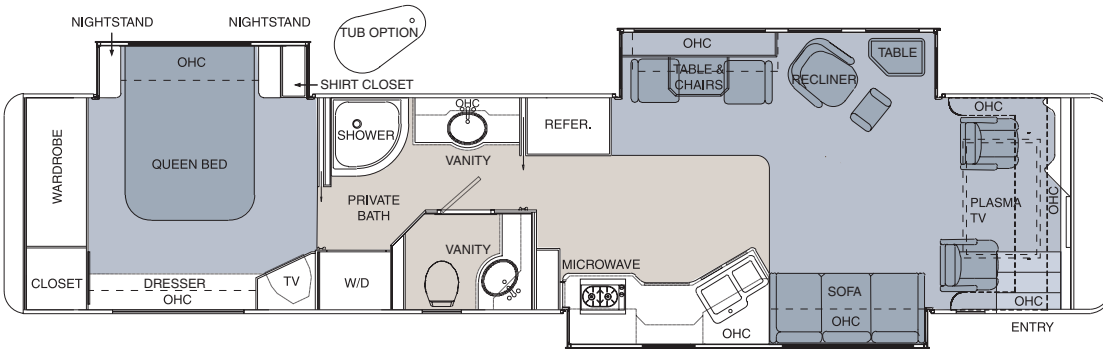
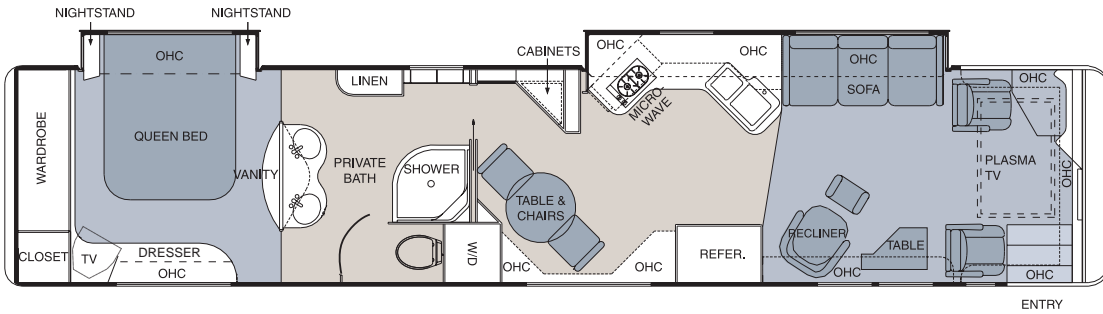
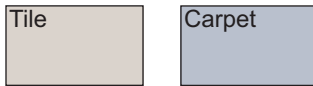

**S**ix Marquis floorplans provide options for every space need. Choose from 40-foot, 42-foot or 45-foot lengths, double or triple

models. Whether the extended length and triple slide-outs of the Sapphire give you the room you

double slide-out, you'll be surrounded by Marquis's countless luxuries.

# MARQUIS SPECIFICATIONS

## BODY CONSTRUCTION

Aluminum-Framed Superstructure  
Seamless One-Piece Molded,  
Crowned  
Fiberglass Roof  
Laminated Gel Coat Fiberglass  
Sidewalls  
One-Piece Front and Rear  
Molded Fiberglass Caps  
Triple-Head, Power-Controlled,  
Heated Exterior Mirrors with  
Turn Indicator Lights  
Aluminum-Framed Laminated  
Floor on Steel Trusses  
Foam Insulated Underbelly  
Fog Lamps  
Roof-Mounted Dual Trumpet Air  
Horns  
Insulated Aluminum Pantographic  
Baggage Doors with Power  
Locks  
Carpet-Lined Storage  
Compartments Slide-Out  
with Room  
Full-Length Beaver Mud Flap  
Deluxe Full Body Paint  
Chrome Rocker Trim  
Rear Ladder

## OPTIONS

3M® Film Front Mask

## COCKPIT

Fiberglass Automotive Dash with  
Burl Instrumentation Panel  
White Gauges with Flat Black  
Bezels  
Power Sunvisors  
In-Dash Rear Vision System and  
Color Monitor with AM/FM  
Stereo and CD Changer  
Aladdin Electronic Control  
System (Chassis and House  
Systems Monitor)

Adjustable Accelerator and Brake  
Pedals  
110V, 12V, and Phone Outlets  
Cup Holders  
Lighted VIP Smartwheel® with  
Controls for Windshield Wipers,  
ICC, and Cruise Control  
Power Steering  
UltraLeather™ 6-Way Power Pilot  
and Co-Pilot Seats both with  
Lumbar, and Power Footrest on  
Co-Pilot Seat  
Air-Activated Power Step Well  
Cover  
(On Front Door Models)  
Carpet Pilot and Co-Pilot Floor

## Mats OPTIONS

UltraLeather™ Extra-Wide Co-  
Pilot Seat with Power Footrest  
on Co-Pilot Seat

## APPLIANCES AND ACCESSORIES

Four-Door Refrigerator with Ice  
Maker  
High-Output Two-Burner  
Recessed Cooktop  
Convection Microwave with Touch  
Control  
42-inch Plasma TV Mounted in  
Ceiling  
20-inch Flat-Screen Color Stereo  
TV in Bedroom  
(24" in 45' Sapphire)  
Home Theater System  
DVD Player  
Bose® Bedroom Radio  
Stereo VCR with Video Switching  
Box  
Stereo TV and VCR Wired  
through Ceiling Speakers  
TV Antenna and Booster  
Fully Automatic Digital Satellite  
System  
Cable TV Hook-Up and

Telephone Jacks  
Combination Washer/Dryer

## OPTIONS

In-Motion Digital Satellite System  
Bedroom Entertainment Package:  
VCR, Bose® 321 System with  
DVD Player and Satellite  
Receiver  
GPS Navigational System with  
DVD  
Dishwashing Drawer  
Separate Ice Maker in Cabinet  
Freezer on Basement Roll-Out  
Tray

## INTERIOR

High-Gloss Solid Wood Cabinetry  
with Exotic  
Wood Inlays  
Hidden Cabinetry Hinges  
Carpet-Lined Cabinet Shelves  
Low-Friction Roller Drawer  
Guides  
Solid Surface Kitchen Countertop  
with Integrated Solid Surface  
Sink  
Tip-Out Tray below Kitchen Sink  
Appliance Garage on Kitchen  
Countertop  
(40' Jasper, 42' Amethyst)  
Round Dinette Table with 2 Free-  
Standing Chairs (N/A: 45'  
Sapphire, 40' Ruby)  
Octagon Dinette Table with 2  
Free-Standing Chairs (45'  
Sapphire)  
Rectangular Dinette Table with 2  
Folding Chairs  
(40' Ruby)  
Ceramic Tile in Kitchen & Bath  
Padded Ceiling Treatment  
Full-Length Mirror in Dinette Area  
Over-Sized Rear Wardrobe  
Closet with Mirrors

Solid Surface Bathroom  
Countertop with  
Integrated Sink  
Solid Surface Shower  
Decorative Shower Door with  
Brass Frame  
Medicine Cabinet with Shelves  
Bathroom Mirror  
Magazine Rack in Private Bath  
Towel Bars in Bathroom  
Queen Bed with Shirt Closet and  
Nightstands  
(N/A: 45' Sapphire)  
King Bed (45' Sapphire)  
Bedsprad with Pillows  
Padded Fabric Wall Treatment  
Sculptured Carpeting in Living  
Area  
Roman Shades in Living Area  
and Bedroom  
Black Out Shades in Bedroom  
Mini-Blinds in Kitchen and  
Bathroom  
UltraLeather™ Euro Recliner with  
Ottoman  
Fabric Sleeper Sofa with Drawer

**OPTIONS**  
Décors: Grand Estate, Aztec  
Copper, Provincetown,  
Tourmaline Blue, Paloma  
Picasso's Caravan  
and Cosmopolitan  
Walnut with Walnut Burl  
Cabinetry  
Walnut with Mappa Burl Cabinetry  
Natural Cherry with Makori Burl  
Cabinetry  
Natural Cherry with Mappa Burl  
Cabinetry  
White Maple with Mappa Burl  
Cabinetry  
Square Dinette Table (N/A: 42'  
Emerald,

45' Sapphire)  
UltraLeather™ Loveseat with  
Drawer  
UltraLeather™ L-Sofa with Drawer  
UltraLeather™ Sofa with Drawer  
UltraLeather™ Recliner  
King Bed

## **ELECTRICAL SYSTEMS AND LIGHTS**

50-Amp 120V Distribution Panel  
Power Cord Reel  
Coax Cable Reel  
Onan® 12.5 kW QD Diesel  
Generator with  
Auto-Start on Power Slide-Out  
2500-Watt Pure Sine Inverter  
Two Solar Panels  
Two 31MHD Chassis Batteries  
Four 6V Deep-Cycle Coach  
Batteries  
Battery Disconnect Switches  
Porch Light  
  
Pilot and Co-Pilot Map Lights  
Lights in Outside Storage  
Compartment  
120V Receptacles inside Storage  
Compartment  
Computer Hook-Up with Phone  
Jack in Dinette Area  
Decorative Dining Light  
Cosmetic Vanity Lights in  
Bathroom  
Halogen Lights under Overhead  
Cabinets  
Halogen Lights Mounted in Living  
Room Ceiling  
Decorative Lighting in Living  
Room and Bedroom

## **PLUMBING AND LP SYSTEMS**

Manifold Water Control System  
One-Touch Pull-Out Faucet  
Insta-Hot® Water System  
Water Pump Switch in Bath Area  
China Opus Toilet  
No-Fuss Flush Black Holding  
Tank Rinsing System  
Insulated Systems Compartment  
with Easy Access  
to Hook-Up  
Outside Shower with Hot and  
Cold Water  
Pressurized Water Fill

## **OPTIONS**

Garden Tub (N/A: 40' Ruby & 42'  
Models)

## **HEATING, VENTS, AND AIR CONDITIONING**

Two Low-Profile Ducted 13.5M  
BTU Roof Air Conditioners with  
Electronic Ignition and  
Heat Pumps  
Aqua-Hot® Heating System  
Electronic AC/Heat Climate  
Control System  
In-Floor Ducted Heating System  
12V Attic Fan in Bath  
12V Attic Fan in Kitchen

## **OPTIONS**

Two Low-Profile 110V Baseboard  
Heaters



|  |   |  |
|--|---|--|
| Radius® Dual-Pane Safety Glass,<br>Dark-Tinted<br>Slider Windows | (Lap and Shoulder)<br>Third Safety Brake Light<br>Egress Window   | Full Air Brakes (Disc)<br>Anti-Lock Braking System on Tag<br>Axle (Drum) |
| Front Entry Door with Removable<br>Screen<br>and Awning          |   | Jacobs® Engine Brake<br>Auto Slack Adjusters<br>Fuel/Water Separator     |
| Keyless Remote Entry System<br>with Pocket Remote                | Roadmaster M10S-Series<br>Chassis   | Air Cleaner Restriction Indicator<br>Hydraulic Leveling System           |
| Interior and Exterior Grab<br>Handles                            | Caterpillar® 505 HP C-12 Engine<br>with<br>Allison® 4000 MH World<br>Transmission<br>and Electronic Shifter | 10,000 lb. Hitch Receiver* with 6-<br>Point Connector                    |
| Tinted Skylight in Bathroom                                      |   | Undercoating   |
| Girard® Automatic Patio Awning                                   |   |  |
| Slide-Out Topper Awnings   |   |  |
| Window Awning  | Torque: 1550 lbs./ft. Max. Net at<br>1,200 RPM  |  |
| Fire Extinguisher  | Rear Axle Ratio: 4.30:1   |  |
| Deadbolt Lock on Entrance Door                                   | Cubic Inch Displacement:<br>729/12L   |  |
| 120V GFI Protected Circuit<br>(Kitchen, Bathroom, Exterior)      | 160-Amp Alternator  |  |
| LP Gas Detector  | Dual Fuel Fill  |  |
| Smoke Detector   | Polished Aluminum Wheels  |  |
| Carbon Monoxide Detector   | Tires: 295/80R  |  |
| Integrated Pilot and Co-Pilot 3-<br>Point Seat Belts             | Cushion Air Glide Suspension<br>with 10 Air Bags<br>and 10 Shock Absorbers                                  |  |
|  | Anti-Lock Braking System with   |  |

## OPTIONS

Dual Leveling System  
(Air/Hydraulic)

\*Your towed vehicle should be equipped with auxiliary brakes if the weight of the towed load exceeds 1,000 lbs.

| WEIGHT RATINGS (LBS.) | 40' JASPER | 40' RUBY | 42' AMETHYST | 42' EMERALD | 42' GARNET | 45' SAPPHIRE |
|-----------------------|------------|----------|--------------|-------------|------------|--------------|
| Gross Vehicle         | 44,400     | 44,400   | 44,400       | 44,400      | 44,400     | 44,400       |
| Gross Combined        | 54,400     | 54,400   | 54,400       | 54,400      | 54,400     | 54,400       |
| Front Gross Axle      | 14,400     | 14,400   | 14,400       | 14,400      | 14,400     | 14,400       |
| Rear Gross Axle       | 23,000     | 23,000   | 23,000       | 23,000      | 23,000     | 23,000       |
| Tag Axle              | 10,000     | 10,000   | 10,000       | 10,000      | 10,000     | 10,000       |

## MEASUREMENTS

|                           |         |         |        |        |         |         |
|---------------------------|---------|---------|--------|--------|---------|---------|
| Wheelbase                 | 263"    | 263"    | 287"   | 287"   | 286"    | 310"    |
| Overall Length            | 40' 11" | 40' 11" | 43' 5" | 43' 5" | 42' 10" | 44' 10" |
| Overall Height (with A/C) | 11' 9"  | 11' 9"  | 11' 9" | 11' 9" | 11' 9"  | 11' 9"  |
| Interior Height           | 78"     | 78"     | 78"    | 78"    | 78"     | 78"     |
| Interior Width            | 94.5"   | 94.5"   | 94.5"  | 94.5"  | 94.5"   | 94.5"   |
| Exterior Width            | 102"    | 102"    | 102"   | 102"   | 102"    | 102"    |

## TANK CAPACITY (GAL.)

All tank capacities are approximate. Actual "usable capacity" may vary as a result of variances in installation and fabrication.

|              |     |     |     |     |     |     |
|--------------|-----|-----|-----|-----|-----|-----|
| Water Heater | 10  | 10  | 10  | 10  | 10  | 10  |
| Gray Tank    | 75  | 75  | 75  | 75  | 75  | 75  |
| Black Tank   | 75  | 75  | 75  | 75  | 75  | 75  |
| Fresh Tank   | 100 | 100 | 100 | 100 | 100 | 100 |
| LP Tank*     | 40  | 40  | 40  | 40  | 40  | 40  |
| Fuel Tank    | 148 | 148 | 148 | 148 | 148 | 148 |

\*Actual filled LP capacity is 80% of listing due to safety shut-off required on tank.

Due to the large variety of options and floorplan arrangements available to our customers, actual weights for each unit may differ. Beaver Motor Coaches provides a weight sticker on each unit we produce, which includes that unit's tank capacities and approximate weight. Consult your local Beaver Motor Coaches dealer for unit availability and further information. The information printed in this brochure reflects product design, fabrication, and component parts at the date of printing. The manufacturer reserves the right, at any time, to make changes in product design, material or component specifications as its sole option, without notice. This includes the substitution of components of a different brand or trade name, which will result in comparable performance. All information printed in this brochure is subject to change after the date of printing. Some features shown or mentioned in this brochure are optional and may only be available in selected floor plans. Photographs may show props or decorations that are not standard equip-