

40 QDP

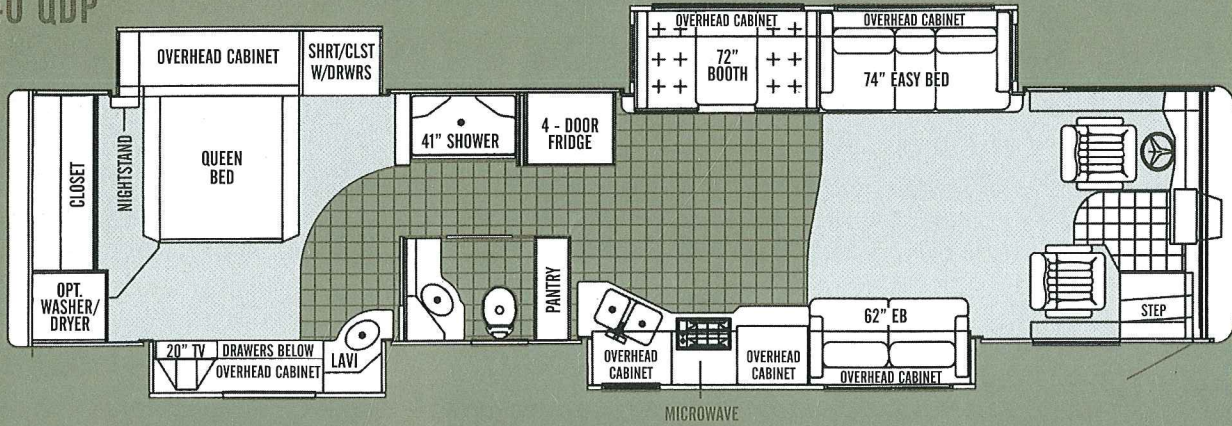

AUTOMOTIVE

MODEL: 40 QDP

GVWR	31,000
GAWR - Front	12,000
GAWR - Rear	19,000
GCWR	41,000
UVW - Full Tank Fuel & One Half Tank Fresh Water - Approximate	27,800
Caterpillar 330 Engine / Side Radiator	NA
Cummins 350 Engine / Side Radiator	S
Cummins 400 Engine / Side Radiator	0
Allison 3000MH 6-Speed Auto w/ Lock-up (Torque Converter)	S
Alternator Amps	160
Wheel Base	276"
Tire Size	275/80R 22.5
Tire Manufacturer	Michelin
Cast Aluminum Wheels	S
Air Ride (4 Bags)	S
Trailer Hitch Capacity	10,000
Air Brakes w/ Automatic Slack Adjusters	S
ABS Brakes	S
Leveling Jacks - Fully Automatic	S
Cruise Control	S
Emergency Start Switch	S
Exhaust Brake (C-Brake on 400 ISL Only)	S
Fuel Tank (Gallons)	150

OVERALL

MODEL: 40 QDP

Overall Length - Approximately	40' 6"
Overall Height w/ Roof Air	12' 3"
Interior Height	80"
Overall Width	101"
Interior Width	96"
Fresh Water (Gallons)	90
Black Water (Gallons)	35
Grey Water (Gallons)	70
LPG Tank (Gallons; can only be filled to 80% capacity)	35
Truck Delivery	0

STRUCTURAL

MODEL: 40 QDP

Laminated Floor, Sidewall & Roof	S
Steel / Aluminum Reinforced Structure	S

EXTERIOR

MODEL: 40 QDP

Fiberglass Front & Rear Caps	S
Dual Fuel Fills	S
Full Body Paint	S
Large One-piece Tinted Windshield	S
Acrylic Front Cap Shield	0
7.5 Kw Onan Generator w/ Manual Slideout	S
Heated Power Mirrors w/ Remote Adjustment (Chrome)	S
Single Motor Intermittent Wiper	S
Gel-Coat Fiberglass Walls	S
Fog Lights	S
Keyless Entry Door System	0
Deadbolt Front Entrance Door	S
Double Electric Step	S
Dual Pane Tinted Windows	S
Exterior Patio Light	S
Electric Door Awning	S
Electric Patio Awning	S
Window Awning Package	0
Slideout Awnings	S
Slideout Rooms	4
Pass-thru Basement Storage	S
Exterior Flip-up Storage Doors w/ Gas Shocks	S
Single Handle, Lockable Storage Door Latches	S
Luggage Compartment Lights	S
Storage Compartment Slideout Tray	0
Docking Lights	S
Heated Water and Holding-Tank Compartments	S
Four - 6 Volt House Batteries	S
2000 Watt Inverter w/ 100 Amp Converter & TXFSW	S
Custom Full-width Mud Flap	S
50 Amp Service	S
Park Telephone Ready	S
Cable Ready TV	S
Black Holding Tank Flush System	S
Exterior Rinse Hose w/ Soap Dispenser & Paper Towel Holder	S
110v Exterior Receptacle	S
Undercoating	S
Fiberglass Roof	S
Spot Light w/ Remote	S

All options may not be available in all models. Because of progressive improvements, specifications, standard and optional equipment are subject to change without notice or obligation.

EXTERIOR (Continued)

MODEL: 40 QDP

Air Horns	S
Power Cord Reel - 50 amp	O
Automatic Satellite Dish	O
In-motion Satellite Dish	O
Exterior Entertainment Center w/ 20" TV, AM/FM/CD Player & Speakers	NA
Exterior Entertainment Center w/ 13" TV, AM/FM/CD Player & Speakers	O
TV Antenna	S
CB Antenna	S
Power Fantastic Roof Vent w/ 3 Speed Fan	S
Extra Fantastic Fan	O
2 - 15,000 BTU High Profile Roof A/C w/ Heat Pump	S
2 - 15,000 BTU Low Profile Roof A/C w/ Heat Pump	O
Roof Ladder	S
Backup Camera and Monitor	S
Water Filter	S

DRIVER'S COMPARTMENT

MODEL: 40 QDP

Entry Floor Light	S
Step Switch & 12 Volt Disconnect Switch	S
Passenger Seat Console Box w/ Built-in Magazine Rack	S
Beverage Tray	S
Power Ultra Leather Driver Seat (Flexsteel)	S
Ultra Leather Passenger Seat w/ Power Footrest (Flexsteel)	S
Automotive Padded Dash	S
Lighted Instrument Panel	S
Handheld CB Radio	O
6 Disc In-dash CD Changer	O
Single In-dash CD Player AM/FM Stereo	S
12 Volt Dash Receptacle	S
Tilt/Telescoping Steering Wheel	S
Dual Dash Fans	S
Windshield Privacy Curtain	S
Power Sun Visors	S
Large Flat Screen Color TV	S
Panasonic VCR	S
Fire Extinguisher	S

LIVING ROOM / DINETTE

MODEL: 40 QDP

Cloth Recliner (Flexsteel)	NA
Ultra Leather Euro-Recliner	NA
Ultra Leather Recliner (Flexsteel)	NA
Cloth Easy Bed (Flexsteel)	S
Cloth Magic Bed	O
Ultra Leather Magic Bed	O
Cloth Automatic Versaflex Sofa (Flexsteel)	O
Ultra Leather Automatic Versaflex Sofa (Flexsteel)	O
Ultra Leather Love Seat w/ 62" EZ Bed Sleeper (Flexsteel)	S
Ultra Leather Love Seat w/ 56" EZ Bed Sleeper (Flexsteel)	NA
Ultra Leather J-Lounge Sofa	NA
Free Standing Legless Dinette w/ Solid Surface Table Top w/ Built-in Cabinets	O
Booth Dinette w/ Solid Surface Table Top	S
Computer Desk	NA

KITCHEN

MODEL: 40 QDP

Polished Solid Surface Countertops	S
Solid Surface Sink Covers	S
Single Lever Sink Faucet w/ Built-in Sprayer	S
Double Bowl Stainless Steel Sink	S
Stainless Steel Convection Microwave	S
2-Burner Glass Cooktop	S
Drop-in Oven w/ 3-Burner Cooktop	O
4-Door Stainless Steel Refrigerator w/ Ice Maker	S
Side-by-side Stainless Steel Refrigerator w/ Ice Maker	NA

BATH

MODEL: 40 QDP

Medicine Cabinet w/ Vanity Light	S
Solid Surface Vanity Top & Bowl	S
Fiberglass Molded Tub or Shower	S
Skylight in Shower	S
Electric Flush Toilet	S

BEDROOM

MODEL: 40 QDP

Cedar-lined Wardrobe	S
Decorative Mirrored Headboard	S
Bed Comforter w/ Throw Pillows	S
Inner Spring Mattress	S
Pillow-top Mattress	O
Large Flat Screen Color TV	S
Carbon Monoxide Detector	S
LPG Leak Detector	S

GENERAL INTERIOR

MODEL: 40 QDP

Soft Touch Vinyl Ceiling	S
Raised Panel Cabinet Doors	S
Oak Cabinetry	O
Natural Maple Cabinetry	O
Walnut Cabinetry	O
Cherry Cabinetry	O
Soft Cloth Covered Cabinet Shelves	S
Porcelain Tile Flooring in Kitchen, Bath & Entrance Landing	S
Wall-to-wall Carpeting in Bedroom & Living Room	S
Black-out Day / Night Shades in Bedroom and Living Room	S
12 Volt Fluorescent Lights	S
Power Roof Vent w/ 3-speed Fan	S
Deluxe Surround Sound	S
Washer / Dryer	O
Plumbed for Washer / Dryer w/ Cabinet	O
Central Vacuum Cleaner	S
Tank Level Monitor System	S
Smoke Detector	S
Hydraulic Heating System	O
10-Gal. DSI Gas / Electric Water Heater	S
One 35,000 BTU & One 20,000 BTU Ducted Furnace	NA
One 42,000 BTU & One 20,000 BTU Ducted Furnace	S
Air Driven Step Well Cover	S
Fireplace	NA

rev. 2/04

TIFFINMOTORHOMES



WHEREVER YOU GO, WE GO.

TIFFIN MOTORHOMES, Inc. 105 2nd Street NW Red Bay, Alabama 35582 (256) 356-8661 FAX: (256) 356-8219 www.tiffinmotorhomes.com

The following names are registered trademarks of Tiffin Motor Homes: Open Road®, Phaeton®, Allegro®, Allegro Bay®, Allegro Bus®, Zephyr®, Roughing It Smoothly®, and Pusher®.