

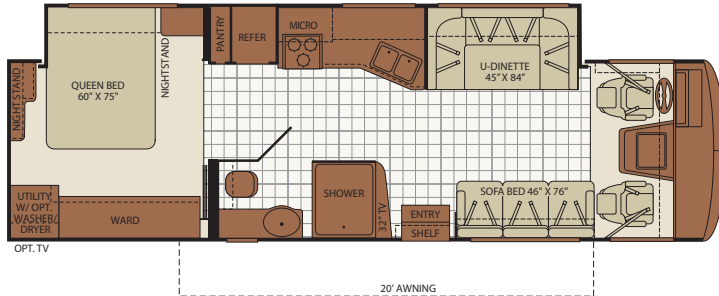

2010 BOUNDER. CONNECT WITH THE OPEN ROAD.

FLOOR PLANS

33U



Interior Storage Capacity: 138 cu. ft.
Exterior Storage Capacity: 80 cu. ft.

• Available Options: 122, 126, 852

35H

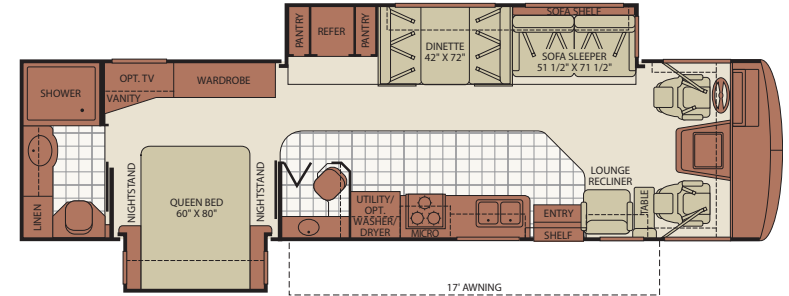

Interior Storage Capacity: 169 cu. ft.
Exterior Storage Capacity: 144 cu. ft.

• Available Options: 122, 126, 491, 833

35E

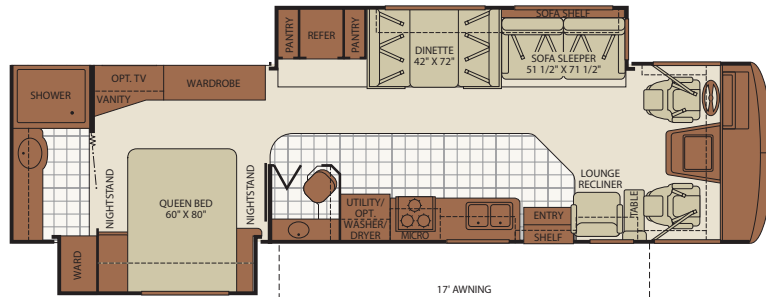

Interior Storage Capacity: 190 cu. ft.
Exterior Storage Capacity: 144 cu. ft.

• Available Options: 122, 126, 491, 833

35J

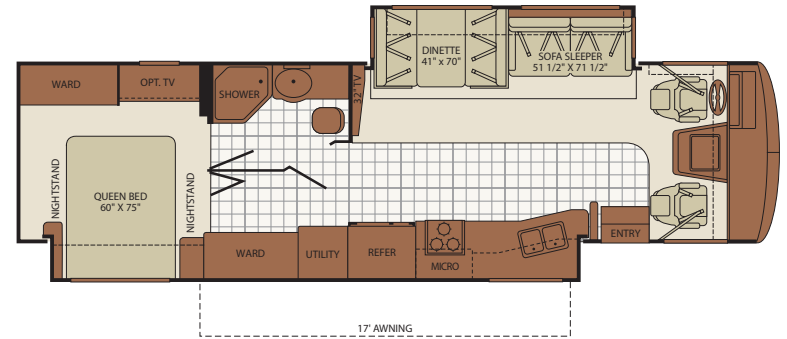

Interior Storage Capacity: 183 cu. ft.
Exterior Storage Capacity: 84 cu. ft.

• Available Options: 122, 126, 631, 833, 852

OPTIONS

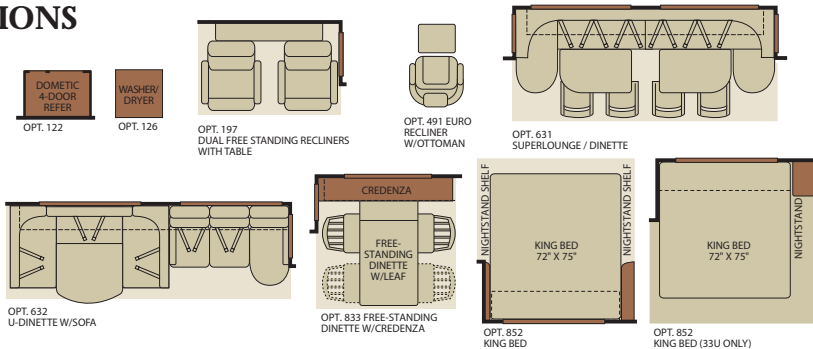

38P

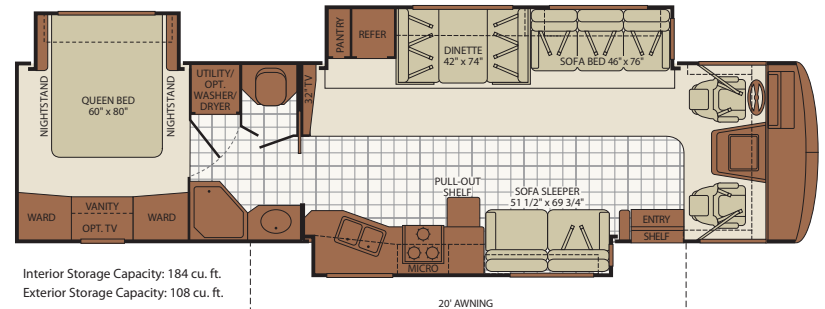

Interior Storage Capacity: 184 cu. ft.
Exterior Storage Capacity: 108 cu. ft.

• Available Options: 122, 126, 197, 632, 833, 852

Seatbelt configuration may vary depending on options chosen.

WEIGHTS AND MEASUREMENTS

FORD® CHASSIS / WORKHORSE™ CHASSIS

MODELS	33U	35E	35H	35J	38P
Engine Displacement (Liters)	6.8/8.1	6.8/8.1	6.8/8.1	6.8/8.1	6.8/8.1
Wheelbase (Inches)	208"	228"	228"	228"	242"
GVWR (lbs) ¹	22,000	22,000	22,000	22,000	24,000
Front GAWR (lbs) ²	7,500	7,500	7,500	7,500	9,000
Rear GAWR (lbs) ²	14,500	14,500	14,500	14,500	15,500
GCWR (lbs) ³	26,000	26,000	26,000	26,000	30,000
Hitch Rating Weight (lbs) [†]	5,000	5,000	5,000	5,000	6,000
Tongue Weight (lbs) [†]	500	500	500	500	600
Fuel Capacity (gal)	75	75	75	75	75

Liquid Weight Reference:

Water (gal) = (8.3 lbs/3.8 kgs) Fuel (gal) = (6.1 lbs/2.8 kgs) Propane (gal) = (4.2 lbs/1.9 kgs)

Metric Conversion:

Multiply pounds x 0.453 to obtain kilograms. Multiply gallons x 3.785 to obtain liters.

Multiply liters x 61 to obtain cubic inches.

DIMENSIONS & CAPACITIES

MODELS	33U	35E	35H	35J	38P
Overall Length ⁴	34' 3"	36' 3"	36' 3"	36' 3"	38' 3"
Overall Height (with A/C)	12' 10"	12' 10"	12' 10"	12' 10"	12' 10"
Overall Width (maximum) ^{5,6}	102"	102"	102"	102"	102"
Interior Height (maximum)	84"	84"	84"	84"	84"
Interior Width (maximum)	96"	96"	96"	96"	96"
Fresh Water Holding Tank (gal)	85	85	85	85	85
Grey Water Holding Tank (gal)	58	58	58	58	58
Black Water Holding Tank (gal)	42	42	42	42	42
Appliance Propane Tank (gal) (WC) ⁷	25	25	25	25	25
Water Heater Tank (gal)	10	10	10	10	10

Model: Ford®/Workhorse™

Engine: 6.8L Triton V10/8.1L Vortec™ V8

Transmission: Ford®, 5-Spd. Automatic w/Overdrive
Workhorse™, 6-Speed Automatic w/Overdrive

Alternator: 130 Amp/145 Amp

Torque: 457 lb-ft @ 3250 RPM/455 lb-ft @ 3200 RPM

Horsepower: 362HP/340HP

- GVWR (Gross Vehicle Weight Rating) is the maximum permissible weight of this fully loaded motor home. The GVWR is equal to or greater than the sum of the (UVW) unloaded vehicle weight plus the (OCCC) occupant cargo carrying capacity*.
 - GAWR (Gross Axle Weight Rating) is the maximum permissible loaded weight a specific axle is designed to carry.
 - GCWR (Gross Combined Weight Rating) is the value specified by the motor home manufacturer as the maximum allowable loaded weight of this motor home with its towed vehicle. Towing and braking capacities may be different. Refer to Fleetwood and chassis manufacturer's manuals for complete information.
 - Length measured from front bumper to rear bumper (excludes accessories).
 - Excludes safety equipment and awnings.
 - Motor homes feature a body-width over 96" which will restrict your access to certain roads. Before purchasing, you should research any state and/or province road laws which may affect your usage.
 - Tank manufacturer's listed water capacity (WC). Actual propane capacity is 80% of water listing as required by the safety code.
- † The chassis manufacturer recommends the installation of a supplemental brake control system to activate the brakes on the vehicle or trailer you are towing. Hitch receiver ratings expressed are maximum for the hitch receiver installed and may require the purchase of additional equipment that is dependent on the weight of the towed load. Consult with hitch receiver manufacturer for further information.
- * UVW and OCCC are found on the label containing the federal certification tag in each RV.

IMPORTANT — PLEASE READ: Product information, photography and illustrations included in this publication were as accurate as possible at the time of printing. For further product information and changes, please visit our website at www.fleetwoodrv.com or contact your local Fleetwood dealer. Prices, materials, design and specifications are subject to change without notice. All weights, fuel, liquid capacities and dimensions are approximate. Fleetwood has designed its recreational vehicles to provide a variety of uses for its customers. Each vehicle features optimal seating, sleeping, storage and fluid capacities. The user is responsible for selecting the proper combination of loads (i.e. occupants, equipment, fluids, cargo, etc.) to ensure that the vehicle's capacities are not exceeded.