

SPORTSMEN[®]

Travel Trailers

2018 Décor



French Roast



Linen

Standards

- New Aerodynamic Front Profile
- Diamond Plate Rock Guard on Front of Travel Trailers
- Enclosed Pin Box on FW's
- 3/8" Fully Walk-On Roof Decking
- 1-Piece Seamless Roof w/ SuperFlex[®] Roofing Material
- Awning w/Drip Rail & Spouts
- Tinted Windows
- Super-Sized Panoramic Slideroom Window
- Radius Entry Door
- Smooth Screwless Baggage Doors
- LED Pass-Through Storage Light
- Cable Hookup
- Digital TV Antenna w/Booster
- Self-Adjusting Electric Brakes
- Radial Tires
- Rear Bumper w/Sewer Hose Storage
- Winter Bypass Kit
- 2 or 4 Stabilizer Jacks (model specific)
- Outside Shower (N/A w/outside kitchen)
- (2) 20# Gas Bottles w/Bottle Cover (Travel Trailers)
- (2) 30# Gas Bottles w/Bottle Cover (362BH, 363FL, 364BH)
- 30 AMP Service
- 13,500 BTU A/C
- 3-Burner Cooktop
- Range Hood w/12V Light & Exhaust Fan
- Microwave w/Turntable
- Oven
- Acrylic Sink w/High-Rise Faucet
- Roller Ball Bearing Drawer Guides
- Large Overhead Cabinets
- LED Interior Lighting

- Linoleum Throughout
- Monitor Panel
- Built-In Medicine Cabinet w/Mirror in Bath
- Shower Surround
- Power Vent in Bath
- Skylight over Shower
- Queen Mattress
- Reversible Quilted Comforter
- Main Bedroom Roof Vent

Options

- Color-Infused Ivory Exterior Fiberglass
- 15,000 BTU A/C IPO 13,500 BTU A/C
- 50 AMP Service w/2nd A/C Prep
- 2nd A/C (13,500 BTU)
- 39" LED TV (N/A 281RL)
- 32" LED TV (281RL)
- Bedroom LED TV w/Inside/Outside Bracket
- Radiant Technology PKG (foil in floor, roof, front, rear)
- F/S Dinette Table & (4) Chairs IPO Dinette (required on 363FL, 364BH)
- Tri-Fold HAB Sofa IPO Jackknife (required on 363FL, 364BH)
- Plumb for W/D w/50 AMP (STD on 362BH, 363FL)
- Theater Seating IPO Jackknife (333BHK)
- Front & Rear Electric Stabilizer Jacks (TTs)
- Fireplace (N/A 281RL)
- Aluminum Wheels TT
- 10 CU FT Residential Refrigerator IPO 8 CU FT Gas/Electric Refrigerator
- MaxxAir[®] Vent Fan in LR or Bath
- Trundle Bed IPO Dinette in Bunk Slide (312BHK, 323BHK, 333BHK)

- Wireless Backup Camera System – Observation
- Bumper-Mount Grill
- Roof Ladder
- Motion Security Sensor for Smart Arm Awning
- Wind Sensor for Smart Arm Awning

K-Z Advantage Package

(mandatory option)

Exterior

- 2-Toned Exterior Metal (TTs)
- Power Awning w/LED Light
- Key-Alike for Baggage & Entry Doors
- Friction Hinge Entry Door
- Large Folding Grab Handle
- Alumitread[®] Entry Steps
- Amber Step Light
- Power Front Jack
- Spare Tire
- EquaFlex[®] Suspension
- Nitrogen-Filled Tires
- Flip-Down 71" Storage Rack (N/A 362BH, 363BH)
- Exterior Speakers
- Battery Disconnect
- Black Tank Flush
- ToyLock
- Backup Camera Prep
- Solar Prep
- Climate Package (heated, enclosed & insulated underbelly)

Interior

- Seamless Countertops w/Under-Mount Kitchen Sink
- Sink Cover
- Drop-In Cooktop w/Glass Cover
- Kitchen Skylight
- Storage Bins in Booth Dinette

- Blue LED Light Strip above Main Slideroom(s)
- Jackknife w/Middle Console & Bolster Arms
- (2) Motion Sensor Lights
- Multiple Media Stereo w/ DVD/Bluetooth/NFC Wireless Connectivity
- (2) 6 1/2" Interior Speakers
- 12V Dual USB Port
- Pleated Shades
- Foot Flush Toilet
- Bed Storage System
- Plywood Bed Base w/Gas Struts
- Upper Bunk Windows (select models)
- Pillowtop Mattress
- Push-Back Recliners (select models)

K-Z Convenience Package

(mandatory option)

Exterior

- Smart Arm Awning w/Exterior Controls
- Magnetic Baggage Door Catches
- Omnidirectional HDTV Antenna
- LED Lights in Exterior Speakers

Interior

- Armstrong[®] ToughGuard[®] Linoleum
- 8 CU FT Gas/Electric Refrigerator (N/A 362BH, 363FL, 364BH)
- Stainless Steel Residential Kitchen Faucet w/Pulldown Sprayer
- Interior Control Switches on OH End Cabinet
- Dark Accent Trim on Corners/Entry Doors
- Electric Outlet in Bunk Area

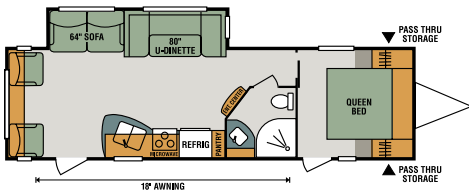

281RL

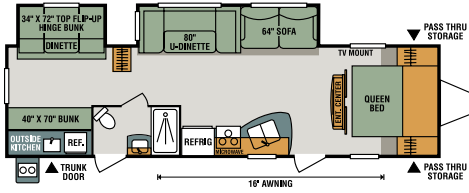

312BHK

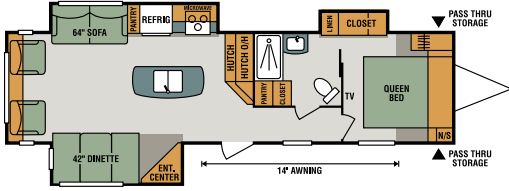

323IK

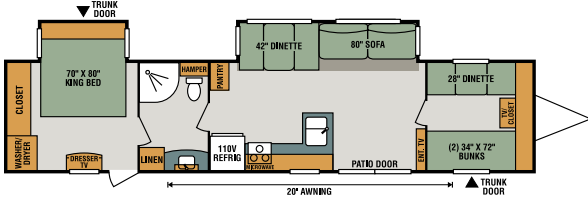

362BH

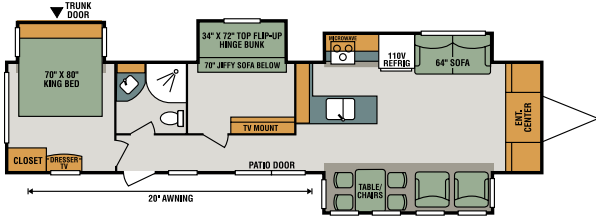

364BH NEW

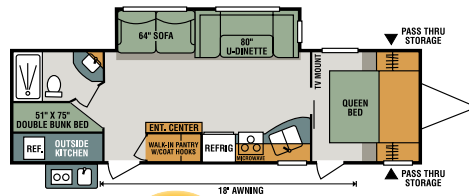

291BHK NEW

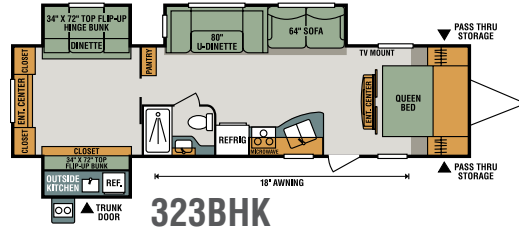

323BHK

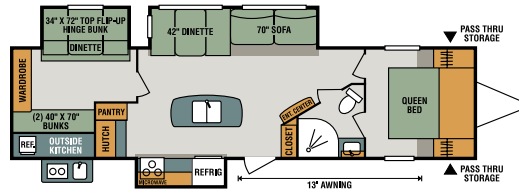

333BHK

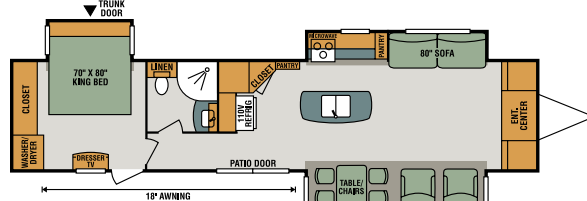

363FL



312BHK
Trundle Bed
Option



323BHK
Trundle Bed
Option

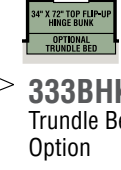

333BHK
Trundle Bed
Option

Travel Trailers	281RL	291BHK	312BHK	323BHK	323IK	333BHK	362BH	363FL	364BH
UVW (Unloaded Vehicle Weight)*	6,260	TBD	7,060	7,680	7,690	8,520	8,150	8,910	9,580
Dry Hitch Weight*	790	TBD	600	700	890	950	1,150	1,460	1,830
Dry Axle Weight*	5,470	TBD	6,460	6,980	6,800	7,570	7,000	7,450	7,750
NCC (Net Carrying Capacity)	1,740	TBD	1,740	1,120	1,110	980	2,310	1,550	880
GVWR	8,000	TBD	8,800	8,800	8,800	9,995	10,460	10,460	10,460
Interior Height	82"	TBD	82"	82"	82"	82"	82"	82"	82"
Exterior Height w/ A/C	11' 3"	TBD	11' 2"	11' 4"	11' 2"	11' 2"	11' 4"	11' 4"	11' 4"
Exterior Width	96"	TBD	96"	96"	96"	96"	96"	96"	96"
Exterior Length	32' 1"	TBD	34' 4"	35' 11"	35' 4"	36' 8"	40' 9"	40' 9"	40' 9"
Refrigerator (cu. feet)	8	TBD	8	8	8	8	18	18	18
Water Heater Cap. (gal. G/E w/DSI)	6	TBD	6	6	6	6	6	6	6
Fresh Water Cap. (gal.)	38	TBD	38	38	38	38	38	38	38
Waste Water Cap. (gal.)	32	TBD	32	32	32	32	32	32	32
Gray Water Cap. (gal.)	32	TBD	32	32	32	64	64	64	64
LP Gas Cap. (lbs.)	40	TBD	40	40	40	40	60	60	60
Furnace BTUs (1,000s)	20	TBD	30	30	30	30	30	30	30
Tire Size	15"	TBD	15"	15"	15"	15"	15"	15"	15"
Awning	18'	18'	16'	18'	14'	13'	20'	18'	20'

*This weight reflects the rolling average unit weight for each model. Your trailer weight will vary according to optional equipment.



985 N 900 W • Shipshewana, IN 46565
E-mail kz@kz-rv.com • www.kz-rv.com

Due to continual research and advances, manufacturer reserves the right to change specifications, design, price and equipment without notice, and assumes no responsibility for any error in this literature. Some items shown are not included as standard or optional equipment. ©2017KZ | 8/30/17 | 15M