

# AVALANCHE

FULL-PROFILE FIFTH WHEELS



LIVE IT OUT.



# STUNNING ASPEN OAK INTERIOR MAKEOVER

This is the big story for fall. Literally everything in Avalanche's interior has been transformed. Dark walnut cabinetry has been replaced with a gorgeously-grained Aspen Oak in a soft gray finish. A darker accent wood used in the fascia, molding and island creates interest and adds a richness.

## New & Noteworthy:

- Airy Aspen Oak woodgrain cabinetry with contrasting Renewed Oak accents and vintage wire mesh glass inserts
- High-contrast linear tile backsplash adds interest in the kitchen
- Modern geometric tile fireplace surround
- Polished natural stone solid surface countertops
- Carpeting has been eliminated, coaches feature varied plank width resilient flooring throughout
- Wine racks added to most models
- Island, valance and bedding design all updated

## High-Fidelity Video and Audio

---

Premium Jensen® video and audio components engineered specifically to withstand road vibration are now available in all Avalanche models. This includes three, separately controlled sound zones that can be operated via Jensen's smartphone app and a single speaker system designed specifically for the master suite.

## Avalanche's Introduces First Rear Kitchen and True Two Bedroom Models

---

Avalanche's new 295RK offers a massive rear kitchen in a compact 33'6" floor plan to cater to a new generation of culinary-minded RVers. Buyers looking for a true split two-bedroom floorplan can now find it in Avalanche's 390DS, the brand's first two bedroom fifth wheel.



## WINEGARD AIR 360+ OMNIDIRECTIONAL ANTENNA

With 360° VHF/UHF/FM signal reception and signal amplification, the combination of the Air 360+ and KeyTV provides Keystone RV owners with the most reliable, easiest to operate over-the-air entertainment package in the industry.

## NEW 3RD AIR CONDITIONER OPTION

Avalanche introduces maximum cooling power with the addition of an optional, third Quiet Cool air conditioner on most models.

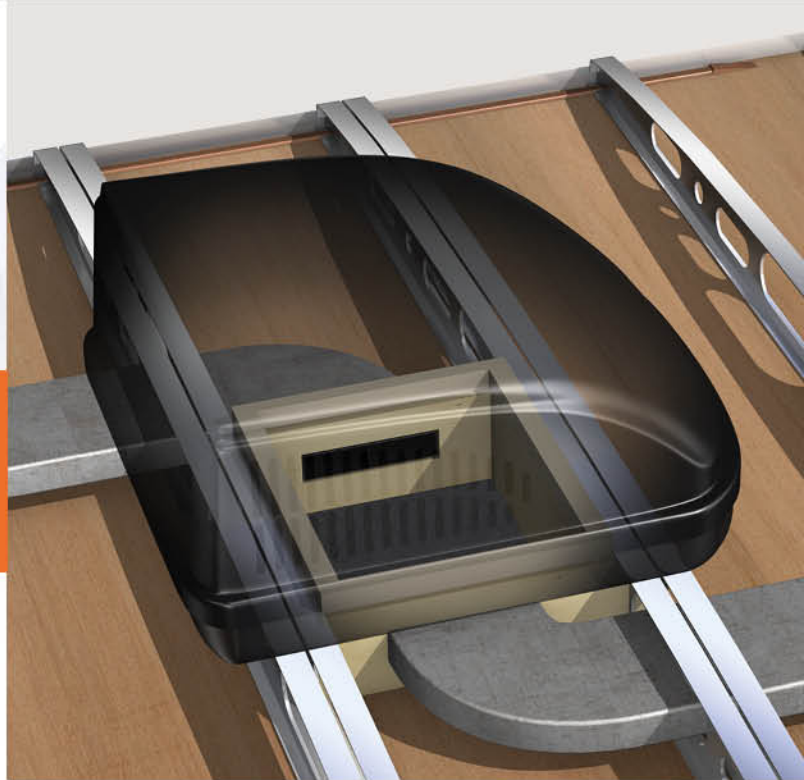



# AVALANCHE | FULL-PROFILE FIFTH WHEEL FLOORPLANS

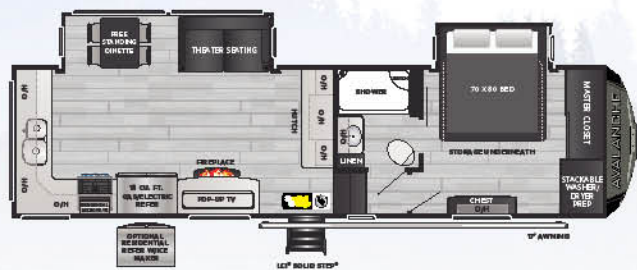

**NEW!** 295RK | Rear kitchen, two slides, king bed

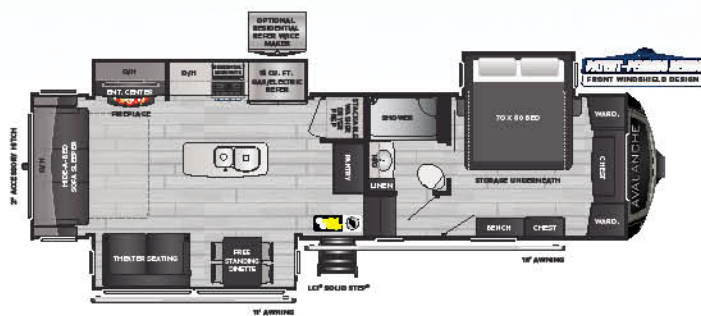

312RS | Rear sofa, three slides, king bed

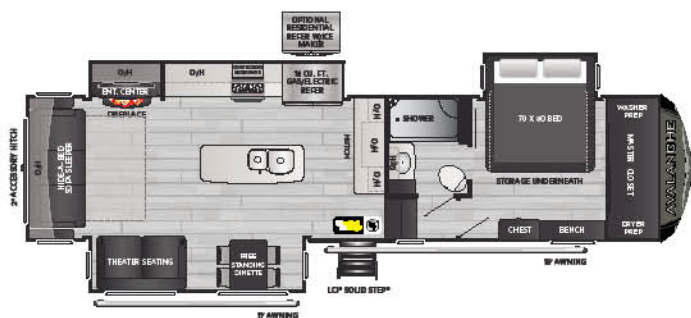

**NEW!** 322RL | Rear living, mid-kitchen, master closet

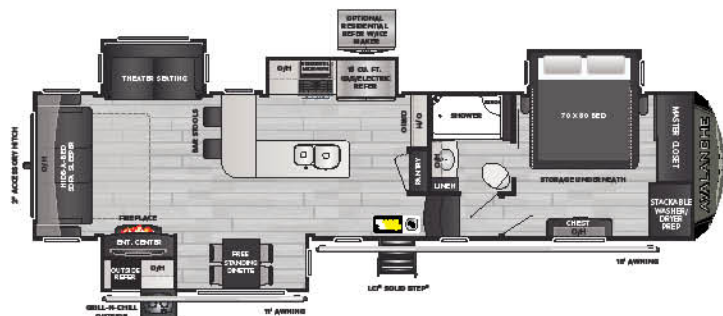

338GK | Grand kitchen, barstools, outside kitchen

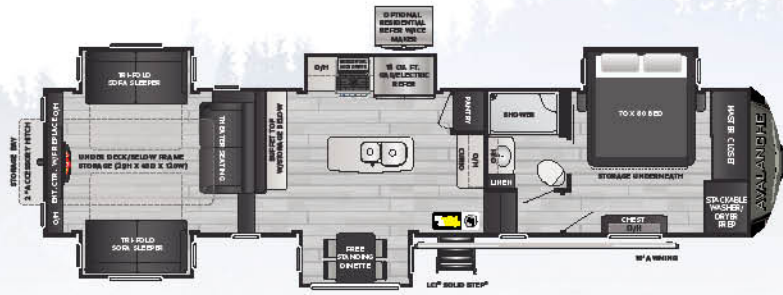

**375RD** | Rear den, five slides, oversized storage tray

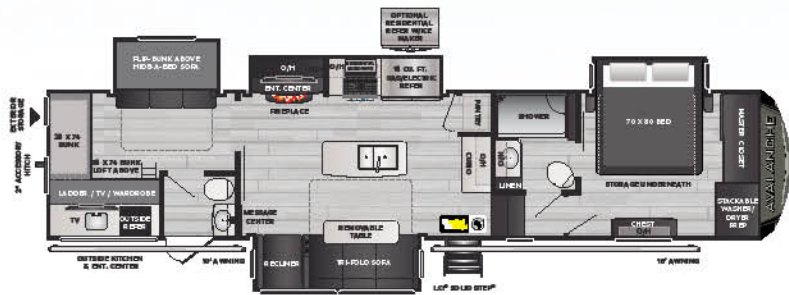

**378BH** | 1 1/2 bath, bunkhouse w/ outside kitchen

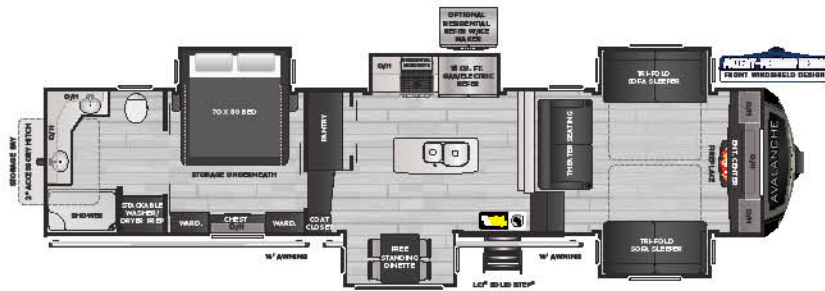

**382FL** | Front living, rear master retreat

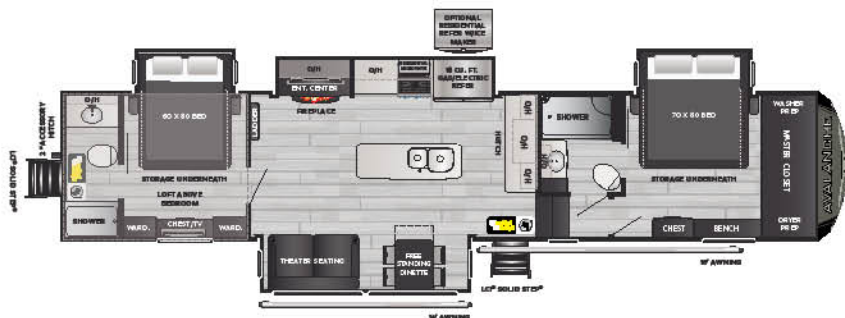

**NEW!** **390DS** | Double suite, 2 bath, lofted bunk

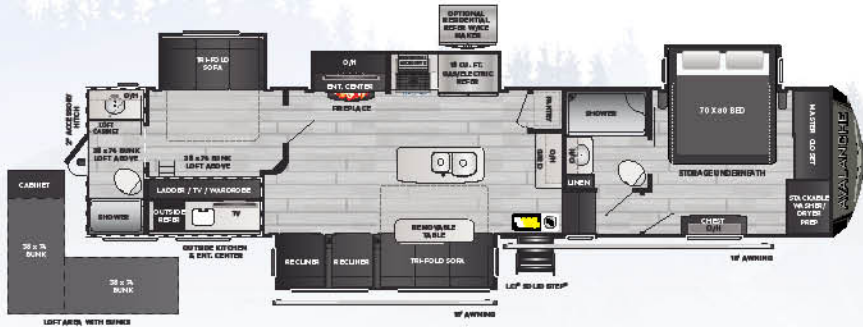

**395BH** | Rear bunkhouse, 2 bath, four slides

## AVALANCHE | MODEL SPECIFICATIONS

MODEL	WEIGHT	CARRYING CAPACITY	HITCH WEIGHT	FRESH WATER	WASTE WATER	GRAY WATER	LPG	LENGTH*	WIDTH	HEIGHT	AWNING
295RK	10610	4390	2285	66	49	93	60	33' 6"	8' 4"	13' 2"	17'
312RS	11520	3480	2575	66	49	83	60	34' 11"	8' 4"	13' 2"	16'/11'
322RL	12005	3495	2435	66	49	83	60	36' 10"	8' 4"	13' 3"	17' 11"
338GK	12350	3150	2700	66	49	83	60	38' 0"	8' 4"	13' 2"	19'/11'
375RD	13424	2576	2475	66	49	83	60	40' 8"	8' 4"	13' 4"	16'
378BH	13616	2884	2820	66	83	117	60	40' 8"	8' 4"	13' 4"	16'/10'
382FL	13487	3013	2815	66	44	78	60	41' 6"	8' 4"	13' 4"	14'/14'
390DS	TBD	TBD	TBD	66	98	132	60	43' 0"	8' 4"	13' 3"	17'/11'
395BH	13878	2622	2760	66	93	127	60	41' 7"	8' 4"	13' 4"	16'/11'

DISCLAIMER: Product information is as accurate as possible as of the date of publication of this brochure. All features, floor plans, and specifications in this brochure are subject to change without notice. Please also consult Keystone's web site at [www.keystoneerv.com](http://www.keystoneerv.com) for more current product information and specifications. Tow Vehicle Disclaimer. CAUTION: Owners of Keystone recreational vehicles are solely responsible for the selection and proper use of tow vehicles. All customers should consult with a motor vehicle manufacturer or their dealer concerning the purchase and use of suitable tow vehicles for Keystone products. Keystone disclaims any liability or damages suffered as a result of the selection, operation, use or misuse of a tow vehicle. KEYSTONE'S LIMITED WARRANTY DOES NOT COVER DAMAGE TO THE RECREATIONAL VEHICLE OR THE TOW VEHICLE AS A RESULT OF THE SELECTION, OPERATION, USE OR MISUSE OF THE TOW VEHICLE. \*Length is defined as the distance from the centerline of hitch pin/coupler to rear bumper of trailer. Please review owner's manual prior to purchase for more information on service warranties, extended use, towing and maintenance. Owner's manuals can be found at [keystoneerv.com](http://keystoneerv.com).