



AMERICAN TRADITION

CLASS A DIESEL | MODEL YEAR 2023

37S | 42Q | 42V | 45T



COMPREHENSIVE FEATURES

- Liberty Bridge® paired with Freightliner's custom XCM chassis with BrakeSync
- ZF Independent front suspension
- Cummins L9 Diesel Engine (450HP/1,250 ft. lb.)
- Select Drive™ premium steering system
- Tire pressure monitoring system
- 10kW Onan QD generator with AGS
- 2,800 watt pure sine wave inverter
- Emergency exit door
- Aqua-Hot 450D for unlimited hot water and comfortable even interior heat. NEW FOR MY23!
- FCCC RoadWatch state-of-the-art driving and safety system includes automatic traction control, electronic stability control with roll stability support, adaptive cruise control and collision mitigation with forward warning and active braking
- Sani Con Turbo 600S waste management system
- (6) lead-acid house batteries standard, with AGM or Lithium option
- Platinum Experience Warranty includes -2yr / 24k mile coach, 5yr / 50k structural, 3 years REV assist roadside assistance, dedicated customer service team and now includes the PX owners mobile app

AVAILABLE OPTIONS

- 8" Exterior Stainless Package
- Exterior Freezer
- Winegard In-Motion Satellite Dish
- Winegard Trav'ler w/DISH Network
- Winegard Trav'ler w/DIRECT Network
- Roof Mounted Awning (2nd Door Side)
- 43" Front Overhead LED TV
- Standard Cabinet w/o Dishwasher
- Co-Pilot Monitor with 7" Screen
- AGM Battery Package
- Lithium Battery Package
- First Full Bay 36"/54" Slide-out Tray (37S)
- Second Full Bay 36"/54" Slide-out Tray (42Q, 42V, 45T)
- 90" Slide-Out Tray -1st Full Bay
- 90" Slide-Out Tray -2nd Full Bay (42Q, 42V)
- Sofa Bed w/Mattress (42Q Twin Mattress)
- Motion Power Lounge (37S, 42Q)
- Technology Package: Wifi Ranger™ Denali-LTE w/router, Cell Booster, 300W Solar Panel and Blind Spot Detection, JBL Premium Audio Sound System
- VIP Delivery

TRADITION

Shown in Gettysburg Graphics



37S

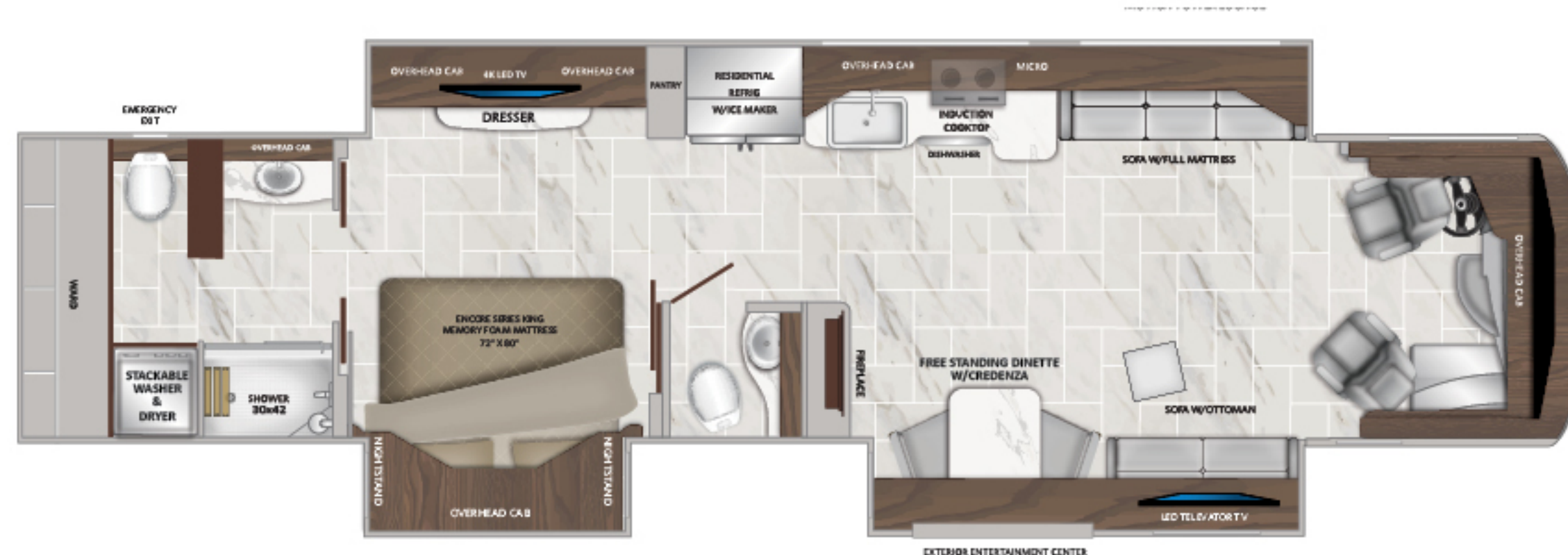

42Q

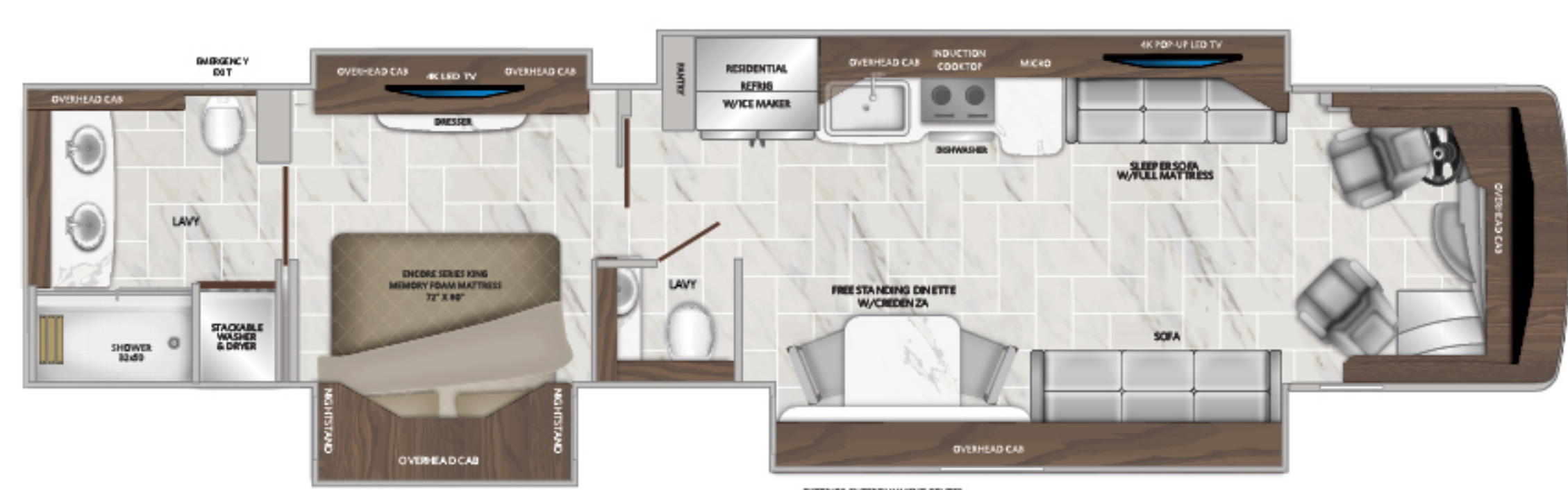

42V



45T

37S | 42Q | 42V | 45T



AMERICAN TRADITION

CLASS A DIESEL | MODEL YEAR 2023

CHARDONNAY DÉCOR

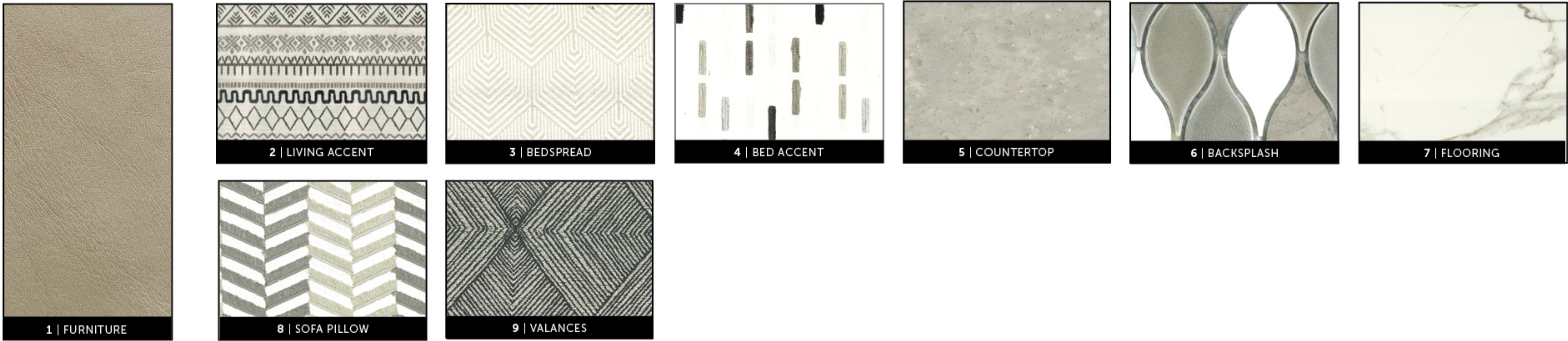

GRAVITY DÉCOR

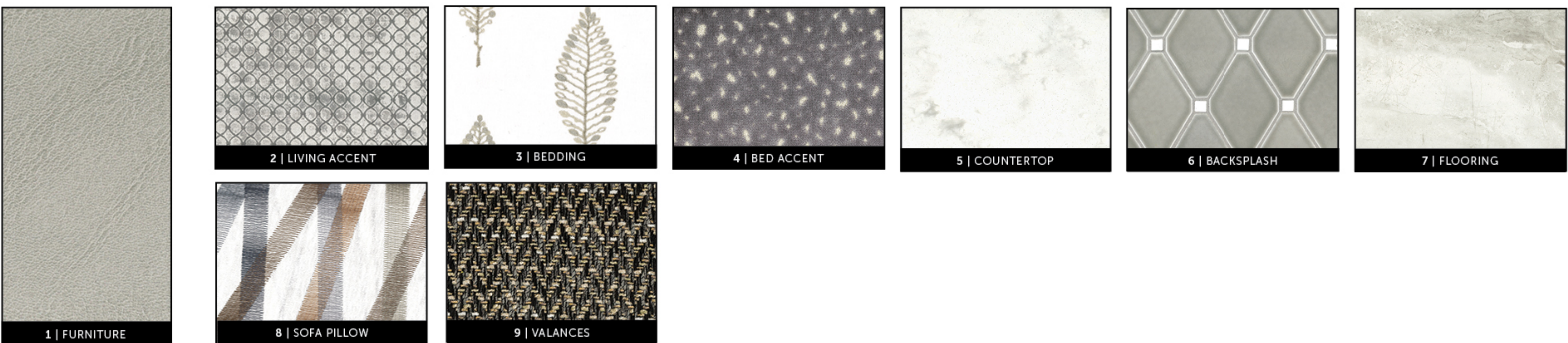

INTUITION DÉCOR

NEW DÉCOR FOR MY23

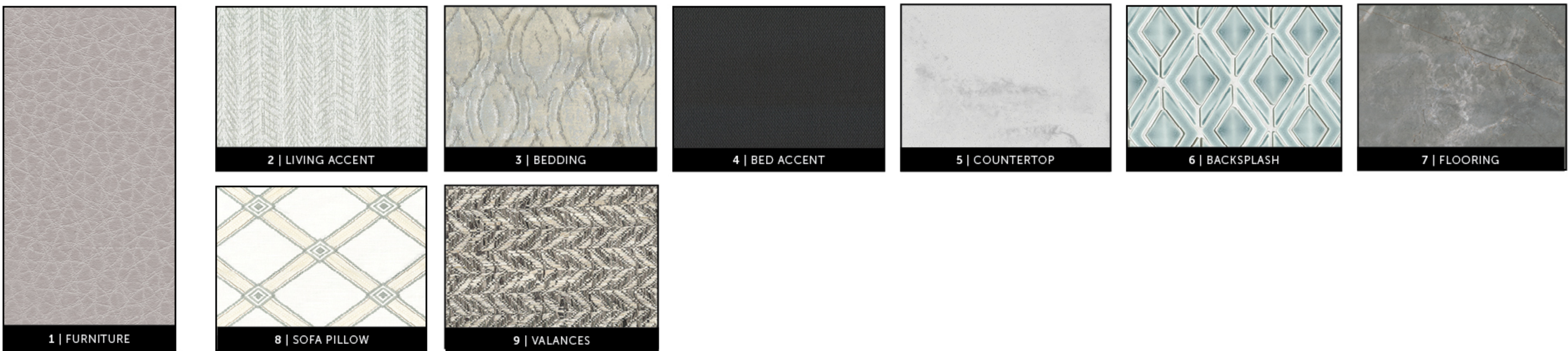

HARDWOOD CABINETRY



AMERICAN CHESTNUT

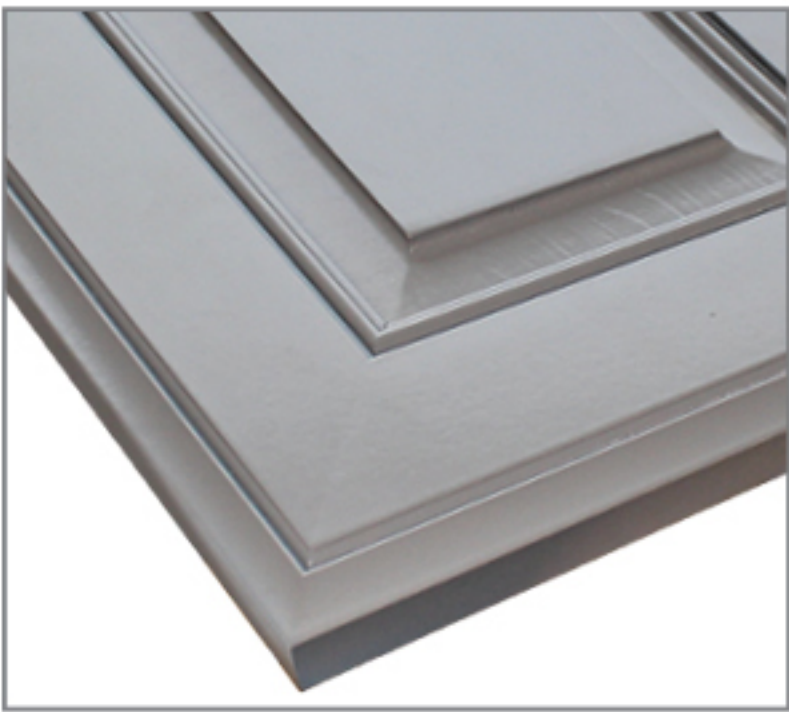

CATHEDRAL PAINTED CABINETRY



CHILL-OUT SEAL



RUSHMORE PAINTED CABINETRY

TRADITIONAL DOOR PROFILE

CHASSIS

MODEL	37S	42Q	42V	45T
Wheelbase	243"	302"	302"	319"
Front GAWR (lbs)	17,000	17,000	17,000	17,000
Rear GAWR (lbs)	24,000	20,000	20,000	20,000
GCWR (lbs)	51,000	62,000	62,000	62,000
Hitch Rating Weight (lbs)	10,000	15,000	15,000	15,000
Tongue Weight (lbs)	1,000	1,500	1,500	1,500
Fuel Capacity (gal)	150	150	150	150



LIBERTY BRIDGE® CHASSIS
Cummins® L9, 450HP
1250 lb/ft Torque
Hitch Rating: 15,000#
Allison 3000 Series Transmission, 6-Speed

DIMENSIONS & CAPACITIES

MODEL	37S	42Q	42V	45T
Overall Length	38' 2"	42' 11"	42' 11"	44' 11"
Overall Height	13' 1"	13' 1"	13' 1"	13' 1"
Overall Width (Maximum)	102"	102"	102"	102"
Interior Height (Maximum)	84"	84"	84"	84"
Interior Width (Maximum)	96"	96"	96"	96"
Patio Awning Width	16' 0"	18' 0"	18' 0"	19' 8"
Interior Storage (cu. ft.)	205.5	233	235	212
Exterior Storage (cu. ft.)	72	131	131	131
Fresh Water Capacity (gal)	105	100	100	105
Grey Water Capacity (gal)	75	60	60	75
Black Water Capacity (gal)	50	40	40	50

EXTERIORS

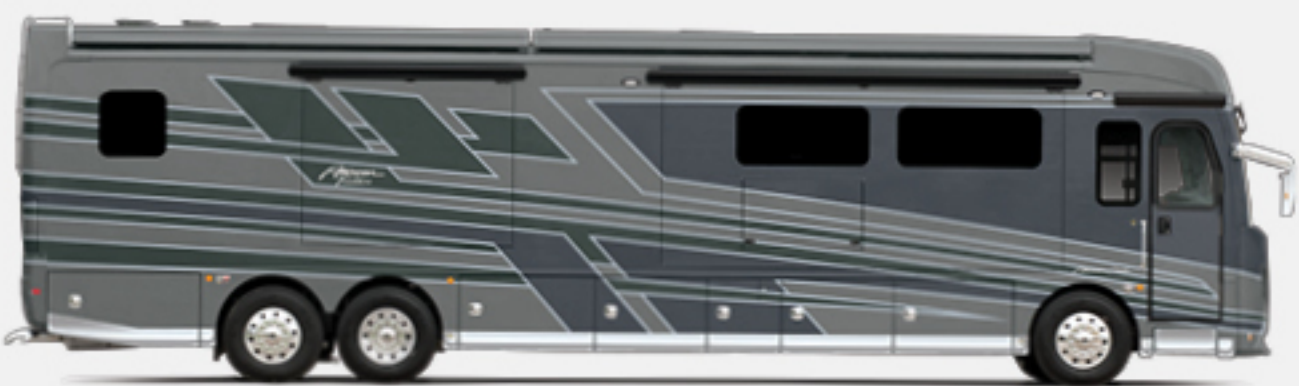

ARLINGTON



BILTMORE



GETTYSBURG



MONTICELLO