

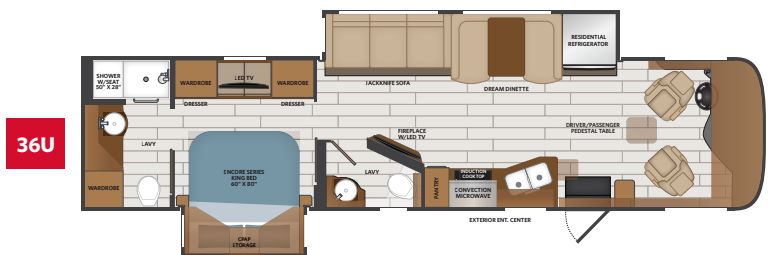

TOP FEATURES

- Freightliner® Custom Chassis - XCS
- Freightliner® BrakeSync standard
- Freightliner® Tire Pressure Monitoring standard
- Cummins 6.7L diesel (340HP, 700 ft.lb on 36U and 300HP, 660 ft.lb on 33D)
- V-Ride technology from Freightliner® Custom Chassis (enhanced stability).
- Freedom Sport foundation
- Low and sporty stance with an overall height of 12'2".
- 10,000 pound hitch weight rating.
- Military grade rotocast composite luggage compartments with no wood to rot and need replaced.
- 6000 watt Onan quiet diesel generator and 2000 watt pure sine wave inverter.
- Optional Hide-A-Loft™ electric drop down bed.
- Residential refrigerator, induction cooktop, and convection microwave come as standard equipment.
- Available Tech. package includes - WiFiRanger W/LTE, Cell Booster, 300 watt solar, Mobile Eye collision

PACE ARROW
Shown in Covelite Graphics

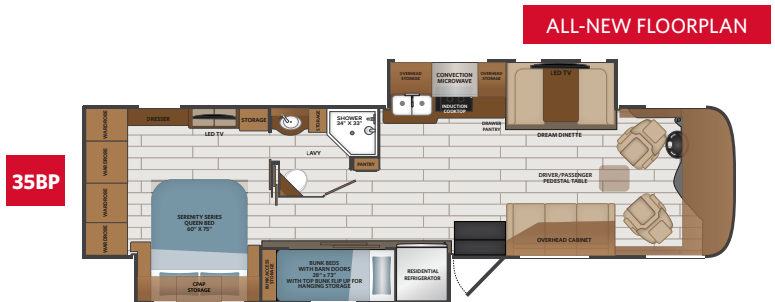
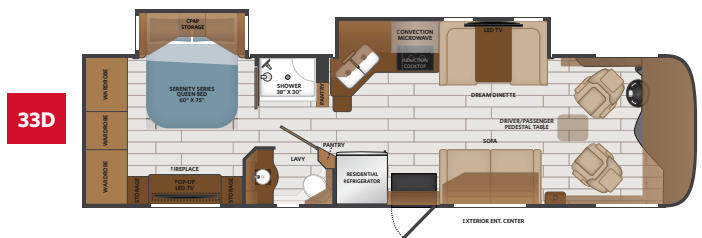

AVAILABLE OPTIONS

- Washer and Dryer (36U)
- Premium Stereo Upgrade: Kenwood® Touch Screen Stereo w/AM/FM/CD/DVD/Bluetooth®/Apple CarPlay®/Android Auto
- Motion Power Lounge
- Hide-A-Loft™ Electric Drop Down Bed
- Central Vacuum System
- Rest EZ Dinette
- Power Passenger Seat w/Power Footrest
- Technology Package:
WiFiRanger™ Sky4 Pro Pack w/LTE and GPS, Cell Booster, 300W Solar Panel, Upgraded Kenwood® Radio, and MobileEye® Collision Mitigation



NEW DECOR MY2023

CHARLESTON

NEW DECOR MY2023

NEW CASTLE

NEW DECOR MY2023

SOLITUDE

ENGLISH CHESTNUT

GREYSTONE

HERITAGE
(PAINTED CABINETRY)

WINTER FOG
(PAINTED W/GLAZED ACCENTS CABINETRY)

1 SOFA
2 LIVING ACCENT
3 BEDDING
4 COUNTERTOP
5 FLOORING
6 BACKSPLASH
7 VALANCE

CHASSIS

MODEL	33D	35BP	36U
Wheelbase	208"	252"	252"
Front GAWR (lbs)	10,500	10,500	10,500
Rear GAWR (lbs)	17,500	19,000	19,000
GCWR (lbs)	30,000	33,000	33,000
Hitch Rating Weight (lbs)	10,000	10,000	10,000
Tongue Weight (lbs)	1,000	1,000	1,000
Fuel Capacity (gal)	90	90	90

FREEDOM BRIDGE® CHASSIS

300HP
Model: Freightliner® XCS Series
Engine: Cummins ISB 6.7L
Transmission: Allison® 2,100 MH 6-Speed
w/Electronic Shifter
Alternator: Delcom Remy 160 Amp
Torque: 660 lb.-ft. @ 1,600 RPM (33D) • 700 lb.-ft. (36U,35BP)
Horsepower: 300HP (33D) • 340HP (36U,35BP)



DIMENSIONS & CAPACITIES

MODEL	33D	35BP	36U
Overall Length	33'-11"	37'-7"	37'-7"
Overall Height	12' 2"	12' 2"	12' 2"
Overall Width (Maximum)	102"	102"	102"
Interior Height (Maximum)	84"	84"	84"
Interior Width (Maximum)	96"	96"	96"
Patio Awning Width	17' 0"	17' 0"	17' 0"
Interior Storage (cu. ft.)	140	164	164
Exterior Storage (cu. ft.)	87	145	145
Fresh Water Capacity (gal)	100	100	100
Grey Water Capacity (gal)	57	57	57
Black Water Capacity (gal)	50	50	50

EXTERIORS



COVELITE



SILVER COSMO



S'MOCHA FROST



WHETSTONE