

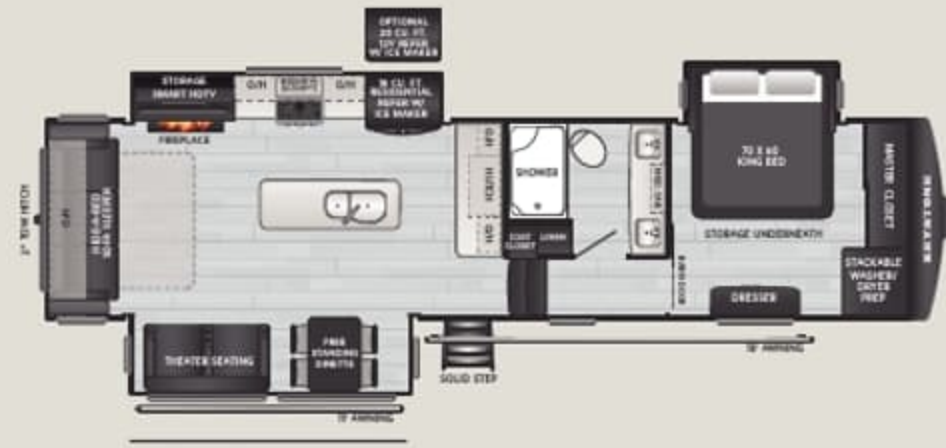

302RS | WEIGHT 11898 | LENGTH 35' 9" 4

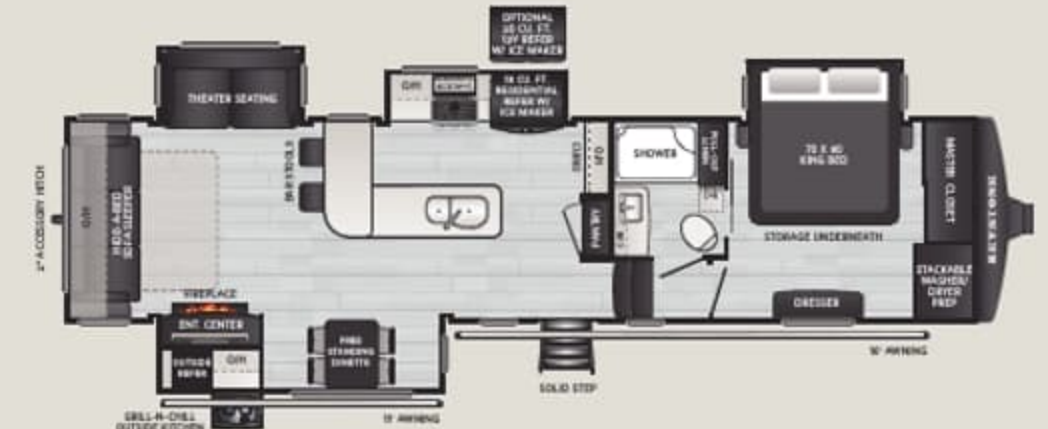

321RL | WEIGHT 12008 | LENGTH 36' 6"



338GK | WEIGHT 12685 | LENGTH 37' 11"



366LS | WEIGHT 14027 | LENGTH 40' 10"



379MB | WEIGHT 14445 | LENGTH 41' 11"



380LT | WEIGHT 14305 | LENGTH 42' 4"

NEW

**FLOORPLAN
COMING SOON**

381DL | WEIGHT TBD | LENGTH 42' 10"



390DS | WEIGHT 14258 | LENGTH 42' 11"



STANDARD FEATURES & OPTIONS

INTERIOR

- ◆ 100" Wide Body Construction
- ◆ Dramatic High Ceilings w/ 6'10" Tall Summit Slides
- ◆ Norco BAL® G 5.5 Slideout Mechanism
- ◆ Flush Floor Kitchen Slides
- ◆ Exclusive Four-Season RV Polar Pack™ Climate Protection
- ◆ Dual Coleman®-Mach® Quiet Series Power Saver™ 15K BTU Air Conditioners
- ◆ Blade Pure™ High-Performance Air Flow System w/ MERV 9 Air Filtration
- ◆ Suburban 35k BTU Gas Furnace
- ◆ Attic Vents in All Models
- ◆ 75-Gallon Fresh Water Tank
- ◆ On-Demand Tankless Water Heater
- ◆ Dove Tail and Lodge Decor Options
(SEE KEYSTONERV.COM FOR DETAILS)
- ◆ Solid Surface Countertops
- ◆ Furrion Kitchen Appliances
- ◆ Furrion 19.6 cu. ft. 12V Refrigerator or 18 cu. ft. Residential Refrigerator w/Ice Maker
- ◆ Stackable Washer & Dryer Prep
- ◆ 48" or 42" One-Piece Fiberglass Shower w/ Seat
- ◆ King Sized Beds
- ◆ JBL Sound System w/ MyZone®
- ◆ Recliner Theatre Seats

EXTERIOR

- ◆ Lippert Titan™ Hydraulic Auto-Leveling System w/ Digital Touchscreen & Under Frame LED Lighting
- ◆ Hitch Vision™ Technology in Fully Painted, Molded Front Cap
- ◆ Road Armor™ Suspension w/ 1/2" Shackle Plates
- ◆ Road Armor™ Rubberized Hitch Pin
- ◆ Cooper G-Rated Tires
- ◆ 2" Hitch Receiver w/ 4-Pin Towing Harness
(SELECT MODELS)
- ◆ Backup Camera and Side Mount Camera Prep
- ◆ Strut Assisted Solid Step®
- ◆ SolarFlex™ Protect
- ◆ Water Filtration
- ◆ 3-Way Pass-through Switches for Slides/Awnings
- ◆ Drop Frame Chassis
- ◆ Flush Floor Main Slides
- ◆ Exclusive Four-Season RV Polar Pack™ Climate Protection

OPTIONS

- ◆ Full Body Paint Options Available:
NEW Black Steel Paint
- ◆ Optional Super Sofa (SELECT MODELS)
- ◆ Slide Awning Package
- ◆ 12V Cooling Drawer
- ◆ Generator Prep
- ◆ 13.5K 3rd A/C
- ◆ SolarFlex™ Discover
- ◆ Dragonfly® Energy Lithium-Ion Batteries
- ◆ Frameless Dual-Pane Windows

