

SUPER LITE SERIES SUNSET TRAIL

One horsepower and away we go!

CROSSROADS

* Do not attempt. Professional driver on closed course.



2+5
YEAR
WARRANTY.

Learn more about the Sunset Trail 2 + 5 Warranty
(the best in the industry)

Visit www.crossroadsrv.com for more detailed
information, selection and virtual tour.

SUPER LITE SERIES SUNSET TRAIL

Construction Standards

- 16" OC Aluminum four walls
- R-7 Spun fiberglass sidewall
- Lamilux fiberglass exterior
- Trailair's Equa-Flex™ Equalizer suspension
- 18,000 BTU furnace
- 14" Radial tires
- 26" Radius entry door

Exterior Standards

- 7'6" width on Super Lite Series
- 8'9" Height w/out A/C, 9'4" w/A/C
- Patio awning
- Tinted windows
- Ext. Receptacle for patio lights w/ switch
- Detachable power cord
- Large exterior storage
- Dual 30 lb LP tanks
- Black tank water flush

Living Standards

- AM/FM CD Stereo w/ interior and exterior speakers
- TV antenna & LCD TV bracket
- Satellite cable prep
- Booth dinette w/ drawers
- Microwave, 3-burner range
- Night shades
- Double door refrigerator
- Large bath w/ corner shower
- 6 Gallon gas/electric water heater w/ DSI



LT19QB

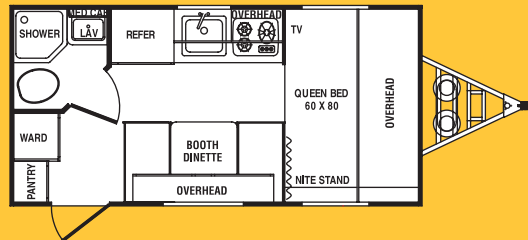

LT20RB

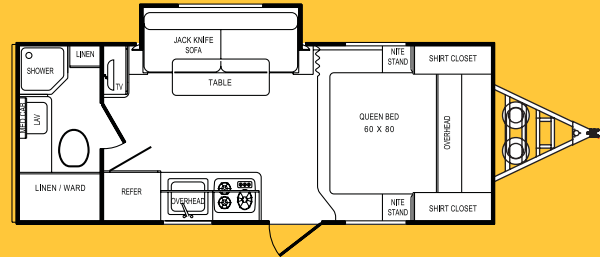

LT22BH

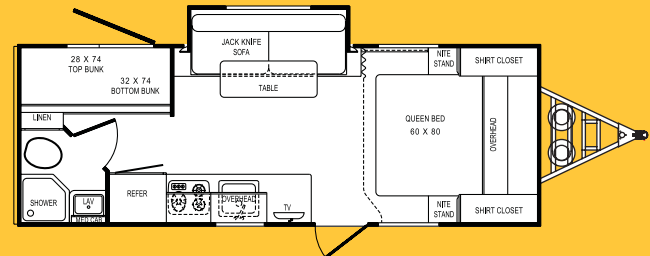

Popular Options

- Low profile A/C
- Outside shower
- 14" Aluminum rims
- LCD TV
- Fantastic fan
- Upgrade insulation
- Spare tire

Model Number	Dry Weight	Carrying Capacity	Hitch Weight	Exterior Height w/ AC	Exterior Length	Tire Size	Fresh Water Cap.	Black Water Cap.	Gray Water Cap.
LT19QB	2985	3793	235	9' 5"	19' 5"	205 / 75R14	20	26	26
LT20RB	3670	3313	440	9' 5"	23' 11"	205 / 75R14	20	26	26
LT22BH	3900	2968	410	9' 5"	25' 9"	205 / 75R14	20	26	26



888-226-7496
www.crossroadsrv.com