

ALUMASCAPE SUITE II®

2009



HOLIDAY RAMBLER®

This is Living®



Alumascape Suite II



34RET

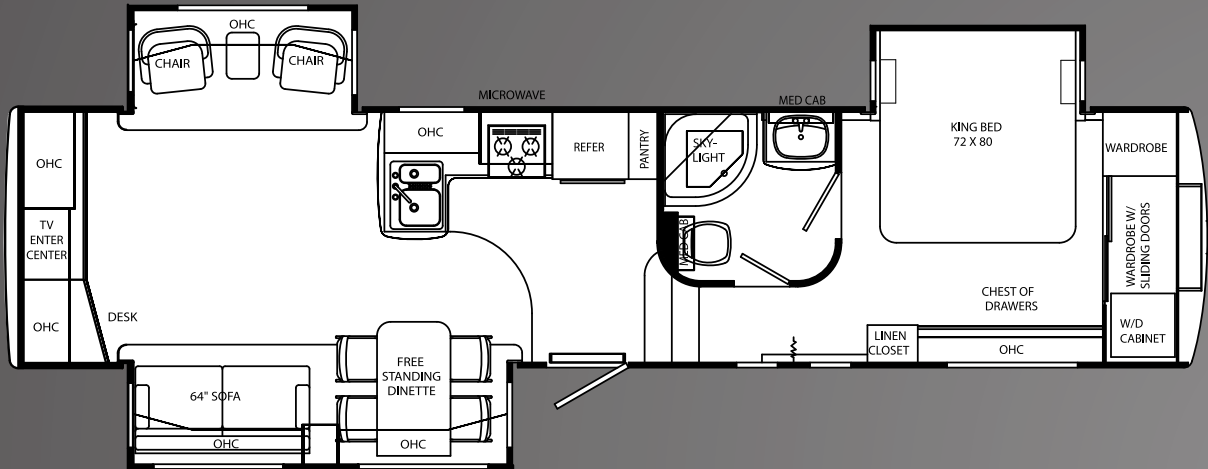

36CKQ

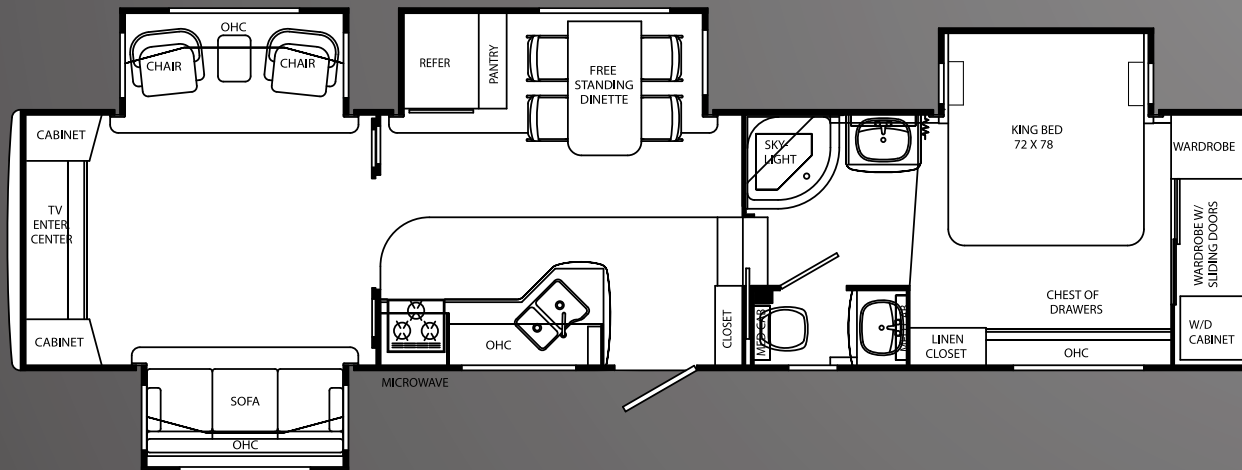

34SKT

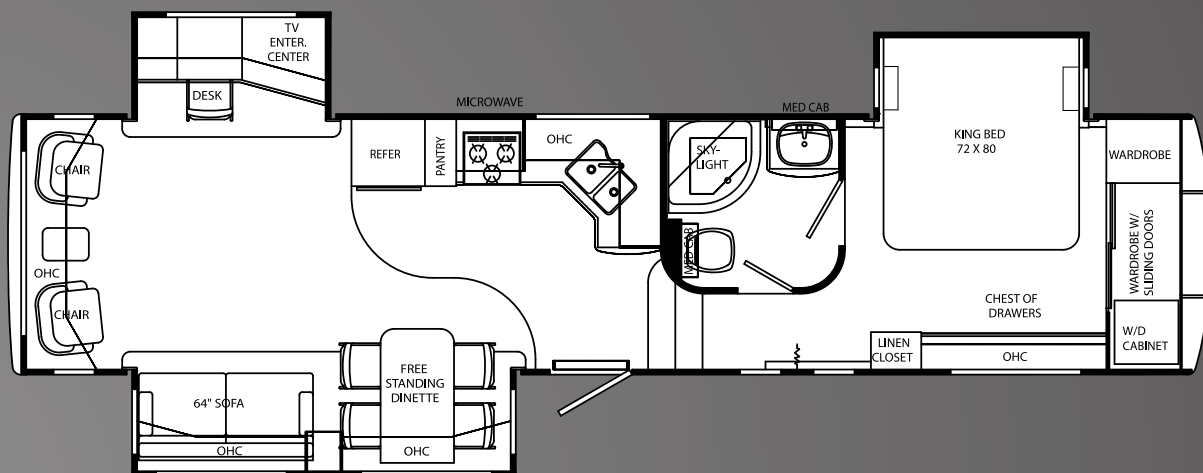

36SKQ

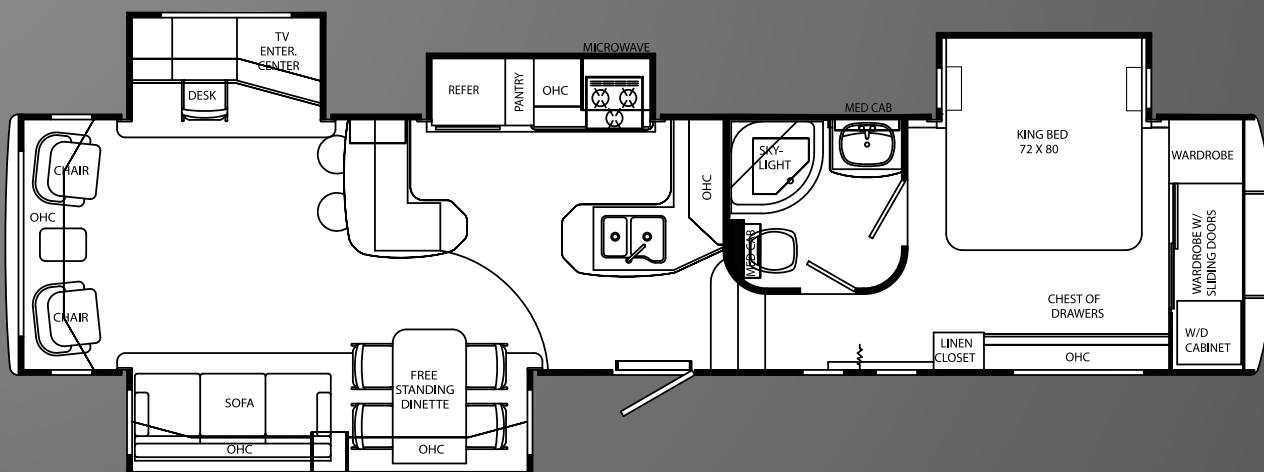



36RLQ

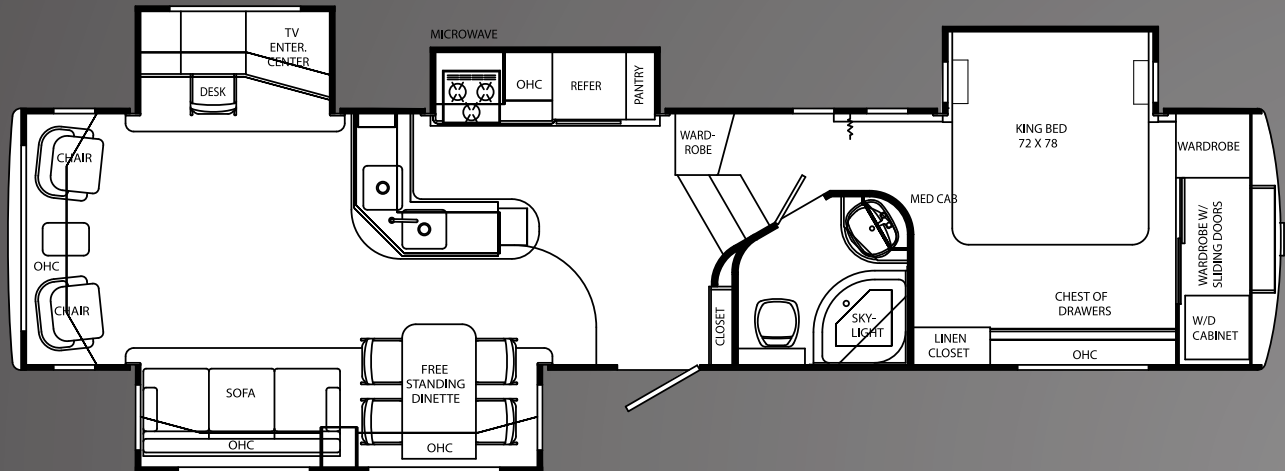

36SKT

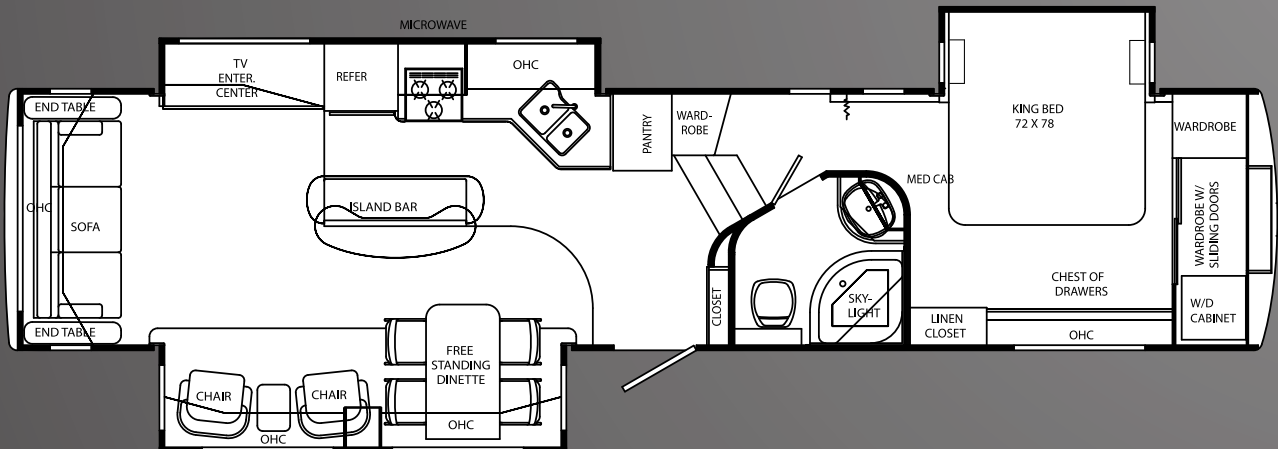

Due to continuous product improvement, please see the website for the latest in standards and options, specifications, and technical data. *Go to www.holidayrambler.com.*

Weights*	34RET	34SKT	36CKQ	36SKQ	36RLQ	36SKT
Gross Vehicle Weight Rating	16,950	16,950	16,950	16,950	16,950	16,950
Hitch Weight	TBD	TBD	TBD	2,820	TBD	TBD
Axle(s) Weight	7,000	7,000	7,000	7,000	7,000	7,000
Unloaded Vehicle Weight	TBD	TBD	TBD	12,810	TBD	TBD
Net carrying Capacity (NCC)	TBD	TBD	TBD	4,140	TBD	TBD
Tire Size and Load Range	16" G	16" G	16" G	16" G	16" G	16" G
Measurements						
Overall Length	36' 10"	36' 10"	38' 10"	38' 10"	38' 10"	38' 10"
Overall Height (Including A/C)	TBD	TBD	TBD	13"	TBD	13'
Exterior Width	98'	98'	98'	98'	98'	98'
Awning Length	18"	TBD	19"	18'	TBD	18"
Tank Capacities						
Water Heater	10	10	10	10	10	10
Grey Tank	50/50	TBD	40/50	40/50	40/50	50/50
Black Tank	50	TBD	40	50	50	50
Fresh Tank (2 - 65 gallon)	70	70	70	70	70	70
L.P. Tank**	30 (2)	30 (2)	30 (2)	30 (2)	30 (2)	30 (2)

* Towing capacity is limited by GCWR; your vehicle's towing capacity is the difference between the GCWR and the actual vehicle weight, including all water, fuel, passengers and cargo. Your towed vehicle should be equipped with auxiliary brakes if the weight of the towed vehicle exceeds 1,000 lbs. Consult your owner's manual for further towing information.

** All tank capacities are estimated based upon calculations provided by the tank manufacturers and represent approximate capacities. The actual "usable capacity" may be greater or less than the estimated capacities based upon fabrication and installation of the tanks.

*** Actual filled LP capacity is 80% of listing due to safety shut-off required on tank.

The actual overall length of the recreational vehicle may differ from that indicated in the brochure due to variances in the manufacturing process and/or installed components. The actual length may be greater or less than that indicated. Due to the large variety of options and floorplan arrangements available to our customers, actual weights for each unit can differ significantly. Holiday Rambler provides a weight sticker on each unit we produce which includes that unit's tank capacities and approximate weight. Consult your local Holiday Rambler dealer for unit availability and further information. The information printed in this brochure reflects product design, fabrication, and component parts at the date of printing. The manufacturer reserves the right, at any time, to make changes in product design or material or component specifications as its sole option, without notice. This includes the substitution of components of a different brand or trade name which will result in comparable performance. All information printed in this brochure is subject to change after the date of printing. Some features shown or mentioned in this brochure are optional and may only be available in selected floorplans. Photographs may show props or decorations that are not standard equipment on Holiday Rambler models. Holiday Rambler, the Holiday Rambler logo and its design, are registered trademarks. All other products and company names are trademarks and/or registered trademarks of their respective holders. While the color of the motorhome's exterior and the interior fabrics depicted in this sales brochure are fair and reasonable depictions, the colors depicted may not be an exact match of the actual colors because of the variances in photo-processing and variances caused by inserting the photographs within the sales brochure. Due to product improvements, changes during the model year and/or transcription errors that may occur, information represented within this brochure may not be accurate at the time of your purchase. If certain information is significant to your purchasing decision, please confirm the information with your dealer prior to submitting your order. Component part and appliance manufacturers issue limited warranties covering those portions of the recreational vehicle not covered by the Limited Warranties issued by Monaco Coach Corporation. To learn which specific component parts and appliances are excluded from the Limited Warranties issued by Monaco Coach Corporation, please contact your selling dealership or Monaco Coach Corporation directly, or review the warranty packet inside the recreational vehicle.

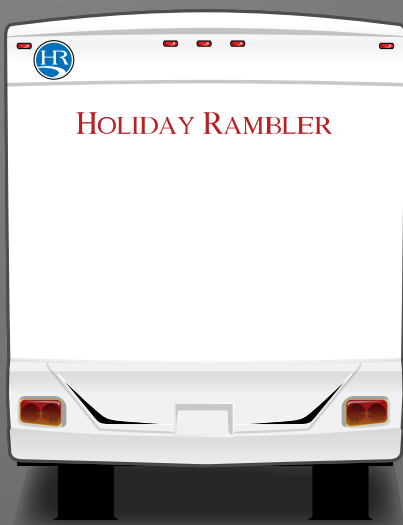



Due to continuous product improvement, please see the website for the latest in standards and options, specifications, and technical data. Go to www.holidayrambler.com.

BODY CONSTRUCTION: FEATURES

- Z-Frame Superstructure
- Front Electric Dual Motor/Switch Jacks w / Snap Pins
- Shock Absorbers
- Radial Tires
- White Steel Wheels
- Spare Tire With Sport Wheel with Carrier Under Frame - Surface Mount
- High Gloss Gelcoat Vacuum Bonded Laminated Fiberglass Sidewalls
- Main S/O House, 6'-5" Head Room
- 1Block Foam Insulation
- Front & Rear Molded Fiberglass Cap
- Steel Floor Framing
- Laminated 5/8" Sturdi-Wood Flooring
- Double I-Beam Aluminum Roof Structure w/ Rafter 16" On-Center w/1/4" OSB top deck
- Brite Tek - Exterior Roof Material
- Flat Floor Slide-Out - Main Living Area
- Enclosed and Heated Underbelly
- Heated and Insulated Alcove Storage Area
- PVC Diamond Plate Pattern Floor in Alcove Storage Area
- Ladder

- Rear Stabilizer Jacks

OPTIONS

- Aluminum Wheels
- Steel Pull Out Storage Tray in Storage Area
- Electric Rear Fold Down Stabilizer Jacks

APPLIANCES AND ACCESSORIES: FEATURES

- 8 cu. ft. Refrigerator
- Microwave with Touch Control
- High Output 3-Burner Range with Oven
- Systems Monitor Panel - Wall Mount
- Home Theater Surround Sound System
- Telephone Jacks at Kitchen Table, Desk Area and Entertainment Center
- 26" LCD TV with Remote Control - Livingroom (N/A: 34SKT, 36CKQ)
- 32" LCD TV with Remote Control - Livingroom (34RET, 36CKQ)
- I-Pod Compatible

OPTIONS

- 10 cu. ft. 2 way Refrigerator w / Ice Maker
- 12 cu. ft. Side by Side Refrigerator W / Ice Maker (N/A: 36SKT)
- 12 cu. ft. Side by Side Refrigerator W / Ice Maker & Water in the Door (N/A: 36SKT)
- 22" LCD TV with Remote Control - Bedroom
- Built-in Vacuum with Deluxe Tools

INTERIOR: FEATURES

- Newport Cherry II Cabinets
- Solid Surface Countertop with Waterfall Edge
- Woodgrain Passage Doors
- Utility Center by Entrance Door - S/O Switches & Security Light Switches
- Linoleum in Kitchen, Bathroom & Entry Area
- Decorative Glass in Overhead Cabinet Doors - Rear Overhead, Main S/O Center Overhead Cab
- Roll Out Pantry with Cabinet with 3 Baskets
- 3 - New Interior Décor Choices: Roasted Chestnut, Jewel, Harvest
- Ceiling Fan with Light

OPTIONS

- Champagne Select Cabinets
- Designer Accessory Pillow Package
- Electric Fireplace

FURNITURE: FEATURES

- King Bed Slide-Out with Chest of Drawers
- Fabric Glider Recliner
- Hide-A Bed Sofa with Air Mattress
- Free-Standing Dinette Table with Four Wood Chairs

OPTIONS

- Ultima Vinyl Euro Chair(s) with Ottoman
- Leather Glider Recliner
- High Back Desk Chair (34SKT, 36RLQ, 36SKQ Only)
- U Shape Dinette (34RET, 34SKT)
- Queen Bed

ELECTRICAL SYSTEMS AND LIGHTS: FEATURES

- 50 AMP Electrical Management Service
- Detachable Power Cord
- Awning Light Outlet
- Two (2) Exterior Security Lights - Individual Lighted Switches in the Utility Center
- Battery Disconnect & Battery Box
- Cable TV, Telephone and Electrical Outlet
- Cable TV Hook-up in Basement Storage
- Cable TV/DSS with Video Box
- TV Antenna with Cable Box
- Dual Exterior Cable/Satellite Recept

OPTIONS

- (1) 12v Deep Cycle Battery
- (2) 12V Deep Cycle Batteries
- Generator Prep
- Solar Prep

PLUMBING AND L.P. SYSTEMS: FEATURES

- Molded One Piece Kitchen Sink
- Brushed Nickle High Profile Single Handle Faucet with Pull Out Sprayer
- 10 gal. L.P. Gas/Elect. W / DSI Water Heater with Fast Recovery
- Bathroom Sink w/Brushed Nickel Faucet & Lever Handles
- Adjustable / Hand Held Brushed Nickel Shower Fixture with Hose and Lever Handles
- Lighted Water Management System w/Drain, Spray-Port Water Sprayer with 15' Polyurethane Hose, Outside Shower with Hot & Cold, Soap Dispenser, Paper Towel Holder, Water Heater By-pass Kit
- One-Piece Fiberglass Radius Shower w/ Obscure Glass Door
- No-Fuss Flush Holding & Tank Rinsing System
- Washer/Dryer Prep w/ 50AMP Service
- Two [Split] 30 lb. L.P. Tanks with Automatic Changeover and Cover

HEATING, VENTS AND AIR CONDITIONING: FEATURES

- 40M BTU Hydroflame Electronic Ignition Furnace
- In-floor Ducted Heating System
- One Carrier 15,000 BTU Rooftop Air Conditioner with Remote Control
- Fantastic Fan - Bedroom
- Remote Control
- Wire Prep and Ducting for 2nd A/C

OPTIONS

- Combination Washer / Dryer
- Second Carrier 15,000 BTU Rooftop A/C with Remote Control

WINDOWS / DOORS AND AWNINGS: FEATURES

- DarkTinted Radius Windows
- Tinted Skylight in Bathroom
- Patio Awning
- Swing-Out Entry Door Handle
- Window in Stool Room (36CKQ)

OPTIONS

- Dual Pane Windows w/Dark Tint
- Slide Out Covers for All Slide Outs

WINDOWS TREATMENTS: FEATURES

- Pleated Day/Night Shades in Living Area and Bedroom



HOLIDAY RAMBLER®

This is Living®

BEING DIFFERENT MAKES ALL THE DIFFERENCE.

Take a closer look, and you'll discover that Holiday Rambler, a brand of Monaco Coach Corporation, gives you more industry "bests" than any other RV manufacturer. The convenience of our 350 service centers. The value of Monaco Financial Services. And the online support of holidayrambler.com. At Holiday Rambler, we've built our reputation by listening to you — and answering to you. And that's the difference that's made us the best.

WARRANTIES

12 MONTH basic limited warranty

5 YEAR limited warranty on aluminum frame structure of sidewall and roof

Applies to certain models. See owner's manual for complete details.

PRESIDENTIAL SUITE

PRESIDENTIAL

ALUMASCAPE SUITE II

ALUMASCAPE

NEXT LEVEL

SAVOY LE/LX

MINTARO

BLACK DIAMOND