

# SPIRIT



2 0 0 1



# Spirit



31T BLUESTONE

The 31T couch/dinette slideout, shown here, not only increases the living area in the lounge and galley area, it also features Winnebago Industries' revolutionary **STORE-MORE**® Hydraulic Slideout System that allows interior and exterior storage compartments to extend with the slideroom.

What does "value" mean to you? With Itasca, it means offering a well-equipped, high-quality motor home at a price that might surprise you. And that's exactly what you'll find in the 2001 Itasca® Spirit®. Each Spirit is loaded with features like a crowned fiberglass roof, stile-and-rail cabinet doors, and ceiling-ducted air conditioning. Add Winnebago Industries' unsurpassed construction strength, fit and finish and warranty coverage, and you can see that the only thing "entry-level" about the Itasca Spirit is the price.

In addition to its four cupholders, the new multi-purpose beverage tray includes a storage tray and a tip-out storage compartment. (NA on Chevrolet®)



31T



31T

Available cab features include UltraLeather HP™ seats (shown here), an AM/FM stereo CD (Ford® only) and heated exterior mirrors with electronic controls. The cab area features standard power windows and door locks as well as fixed lumbar support in both cab seats and driver and passenger air bags (Ford only).



29N

Located in the overhead sleeping area, the available interior entertainment center can include a 19" color TV, VCR with remote, video selection system and single bunk. All models are digital satellite system ready.



31T

Convenient features, like this bedroom vanity with fold-up table (31T only), are what set the Spirit line apart.

# Function

## An entry-level motor home with refinements.



29N SEASPRAY

Spirit's wide-body design offers plenty of room to make yourself at home. You'll find many upgrade items as standard features, including comfortable custom Stitchcraft furniture, deep overhead cabinets with contemporary wood door styling, premium stain-resistant carpeting and ceiling-ducted roof air.



The flush-mounted monitor panel lets you manage most of your systems from one central location inside the coach. It includes the battery condition gauge, holding tank levels, LP tank level, water tank level, water pump switch, water heater switch and indicator lights, and features an improved, larger design.

Large 4" handles allow easy access to cabinet doors and drawers.



31T

A residential-height toilet with foot pedal flush, shower surround with a removable clothes rod and a folding shower door are some of the upgraded amenities in the bathroom.



31T

Galley features include a double stainless steel sink, a single-control faucet, countertops with plenty of work space and a full complement of appliances including a Magic Chef® three-burner range with oven. The large 31T slideout floorplan includes an available 19" color TV and an available VCR over the large in-line galley area, allowing easy viewing from either the dinette or couch.

Like all Itasca motor homes, the Spirit is satellite system ready. The available satellite dish antenna is equipped with an elevation sensing unit.



### SPIRIT DECOR OPTIONS

To assure their strength and durability, fabrics selected for use in the Spirit must pass a series of rigorous tests. Just one example is the "double rub" test, where a machine mechanically simulates a person getting in and out of a seat up to 30,000 times. (This equates to nearly four times a day for over 20 years!)

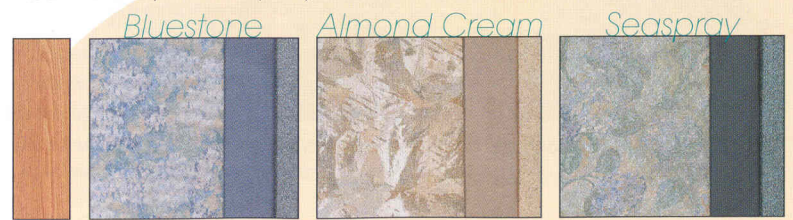

Portsmouth Oak Woodgrain

# 2001 Spirit Floorplans

What sets an Itasca motor home apart? You've already seen that we offer more on the inside. But our advantages are much more than simply increased interior comfort. From our smooth, one-piece fiberglass Thermo-Panel® exterior (which you can see), to the welded steel **SUPER STRUCTURAL**™ our motor homes are built on (which you can't see), and from the fit and finish of our storage compartments (which you can see), to the interlocking joints that secure our walls to the floor and ceiling (which you can't see), our motor homes are simply built to a higher standard. A standard we've been improving on for more than forty years.



31T

Experienced RVers know that certain features add greatly to a motor home's ease of use, and you'll find these features on the new 2001 Spirit. These include aluminum running boards, larger storage compartments (pass-through on some models), freshwater tanks and lines located above floor level, a manual winterizing valve for the water system and a water heater bypass valve. For increased comfort in any climate, the available dual-glazed, thermo-insulated tinted windows provide superior insulation and reduce light transmittal. Firestone® Ride-Rite® adjustable rear air springs provide superior ride control and comfort and are available on the 27P (Ford only), 29N and 31T.



The roomy **STOREMORE** compartments on the 31T extend with the slideout room and include a light for easier access to stowed items.

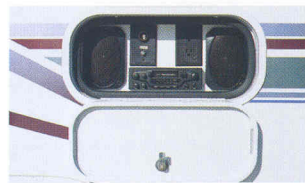

The available exterior entertainment center includes an AM/FM radio with antenna and cassette or CD, 12 volt DC receptacle, 110 volt AC outlet, TV jack and speakers, all neatly housed in a lockable compartment.

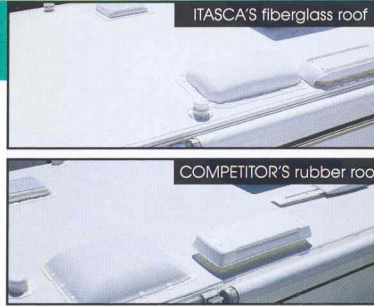

ITASCA'S fiberglass roof

COMPETITOR'S rubber roof

Spirit's one-piece fiberglass roof is stronger and more durable than the rubber roofs found on most other comparably priced motor homes. In addition, the radiused exterior design sheds water while the flat interior ceiling provides for better cabinet attachments and more interior storage.



The standard awning rail does more than hold the available awning. Its integrated rain gutter also serves to channel water to the front and rear of the motor home, away from the awning's face.



Driver's conveniences include available electric remote heated mirrors.



The available Onan® MicroQuiet™ 4,000 watt generator includes an hourmeter, 110 volt wiring and a manual on/off switch conveniently located inside the coach.

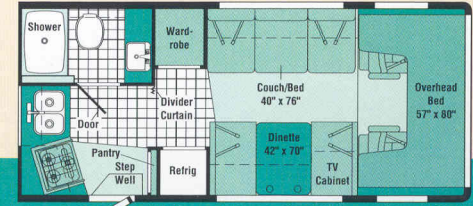

22E

This 22' wide-body features an angled rear galley with seating and sleeping space in the living area.

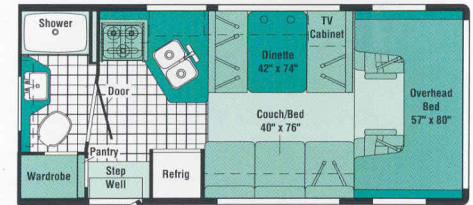

22R

This 22' wide-body includes a 42" wide dinette, an angled galley and a spacious rear bath.

# Super Value

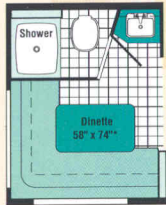

\*Not available as sleeping space in Canada

Couch/Bed w/2 Tables 40" x 76"

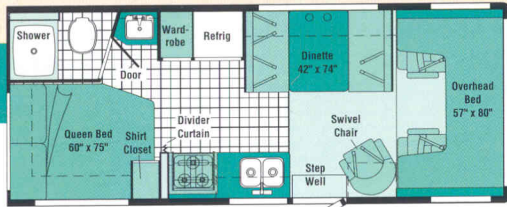
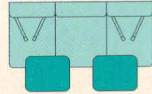

TV Cabinet Over Chair

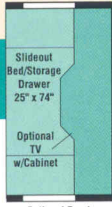

Optional Front Overhead Area

24V

This 24' wide-body includes a standard queen-size bed or an available L-shaped dinette.

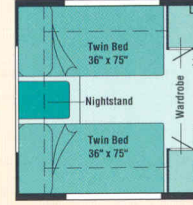

Couch/Bed w/2 Tables 48" x 76"

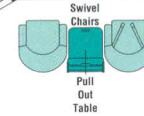
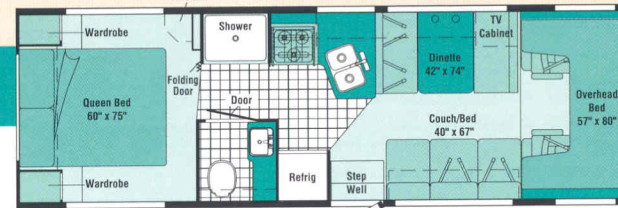
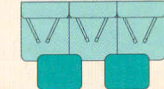

Optional Front Overhead Area

29N

This 29' wide-body offers a unique, angled galley and several possible configurations in the living area.

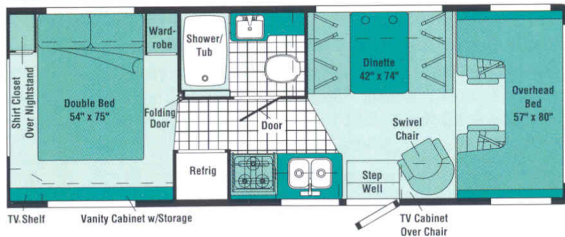
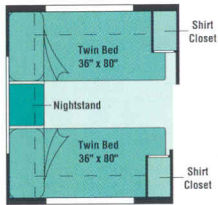

TV Shelf Vanity Cabinet w/Storage

TV Cabinet Over Chair



Optional Front Overhead Area

27P

This 27' wide-body includes a walk-around double bed and a large enclosed bathroom with shower/tub.

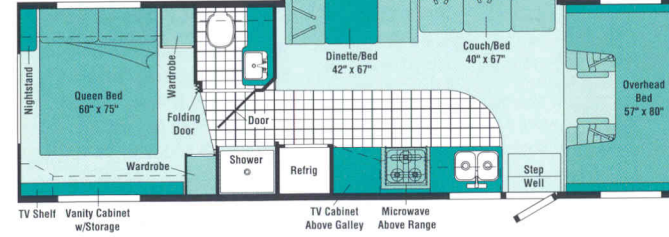
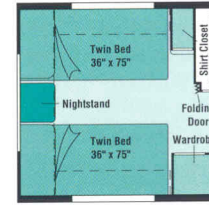

TV Shelf Vanity Cabinet w/Storage

TV Cabinet Above Galley Microwave Above Range

31T

This 31' wide-body features the **STOREMORE** Hydraulic Slideout System which moves the exterior storage compartments out with the room and creates more interior living space. Wardrobes and a vanity cabinet with storage are in the bedroom.

Vinyl Floorcovering  
 Seatbelts

Note: Dimensions shown are for sleeping space only and dashed lines denote overhead storage areas.

# 2001 Spirit Specifications

	22E	22R	24V	27P	29N	31T
<b>Length - Ford/Chev</b>	22'1"/22'6"	22'1"/22'6"	24'6"/24'11"	27'/27'5"	29'4"/NA	31'4"/NA
<b>Exterior Height w/AC - Ford*/Chev*</b>	11'1"/11'3"	11'1"/11'3"	11'1"/11'3"	11'3"/11'5"	11'2"/NA	11'2"/NA
<b>Exterior Width^</b>	8'3.9"	8'3.9"	8'3.9"	8'3.9"	8'3.9"	8'3.9"
<b>Exterior Storage</b>	10 cu. ft.	12 cu. ft.	28 cu. ft.	38 cu. ft.	61 cu. ft.	45 cu. ft.
<b>Interior Height</b>	6'11"	6'11"	6'11"	6'7"	6'7"	6'7"
<b>Interior Width</b>	8'	8'	8'	8'	8'	8'
<b>Fresh Water Capacity w/Heater*</b>	36 gal.	36 gal.	46 gal.	39 gal.	37 gal.	37 gal.
<b>Holding Tank Capacity - Black/Gray</b>	30/36 gal.	36/30 gal.	30/36 gal.	34/42 gal.	27/40 gal.	34/32 gal.
<b>LP Capacity^</b>	12 gal.	12 gal.	12 gal.	12 gal.	12 gal.	18 gal.
<b>Fuel Capacity - Ford/Chev/Diesel</b>	37/35/NA gal.	37/35/NA gal.	55/55/NA gal.	55/55/55 gal.	55/55/55 gal.	55/NA/NA gal.
<b>GVWR - Ford/Ford Diesel (CA)</b>	10,700 lbs./NA	10,700 lbs./NA	11,500 lbs./NA	14,050/14,000*lbs.	14,050/14,000*lbs.	14,050 lbs./NA
<b>GVWR - Ford Diesel (49 States)</b>	NA	NA	NA	14,050* lbs.	14,050* lbs.	NA
<b>GVWR - Chev</b>	12,300 lbs.	12,300 lbs.	12,300 lbs.	12,300 lbs.	NA	NA
<b>Wheelbase - Ford/Chev</b>	138"/139"	138"/139"	158"/159"	188"/189"	190"/NA	220"/NA

## AUTOMOTIVE/CHASSIS

	22E	22R	24V	27P	29N	31T
<b>Spare Tire, Stainless Steel Wheel Covers, Tire Tool</b> wrench, <b>Trailer Hitch</b> 3500# draw bar/350# maximum vertical tongue weight & wiring	S	S	S	S	S	S
<b>Auxiliary Ride-Rite Rear Air Springs</b> Ford					0	0
<b>Chassis - Chevrolet G3500</b> 8.1L SFI Vortec engine, 124 amp alternator, 4-wheel anti-lock brakes, 4L80-E transmission	0	0	0	S		
<b>Chassis - Ford E350</b> 5.4L Super-Duty V-8 SOHC Triton™ engine, 4-speed overdrive transmission, 130 amp alternator, dual airbags, 4-wheel anti-lock brakes	0	0	0			
<b>Chassis - Ford E350</b> 6.8L Super-Duty V-10 SOHC Triton engine, 4-speed overdrive transmission, 130 amp alternator, dual airbags, 4-wheel anti-lock brakes	S	S	S			
<b>Chassis - Ford E450</b> 6.8L Super-Duty V-10 SOHC Triton engine, 4-speed overdrive transmission, 130 amp alternator, dual airbags, 4-wheel anti-lock brakes					0	S
<b>Chassis - Ford E450</b> 7.3L Power Stroke® diesel engine, 4-speed overdrive transmission, 130 amp alternator, dual airbags, 4-wheel anti-lock brakes					0	0
<b>Stainless Steel Wheel Liners</b>	0	0	0	0	0	0

## CAB AREA & DRIVER CONVENIENCES

	22E	22R	24V	27P	29N	31T
<b>Beverage Tray, Cab Divider Curtain, Cab Seats w/Seat Belts</b> 3-point shoulder w/adjustable D-loop & lap w/retractors, armrest, fixed lumbar support, multi-adjustable slide/recline, fabric covered, <b>Cigarette Lighter/12 Volt Electrical Supply, Cruise Control, Domelight, Hood Release, Intermittent Windshield Wipers, Power Assist Steering w/Tilt Wheel, Power Door Locks &amp; Windows, Rubber Driver &amp; Passenger Floor Mats, Sunvisors (2), Trim Panels</b> driver & passenger doors (chassis supplied)	S	S	S	S	S	S
<b>Cab Seats</b> UltraLeather HP covered	0	0	0	0	0	0
<b>Glove Compartment</b> Chevrolet only	S	S	S	S		

## ENTERTAINMENT

	22E	22R	24V	27P	29N	31T
<b>Radio (Cab)</b> AM/FM stereo cassette, speakers (4), <b>Satellite System Ready, TV Enhancement Package</b> antenna (amplified), 12 volt receptacle(s), interior jack(s), coax wiring, cable input (27P, 29N, 31T include bedroom TV shelf or stand*)	S	S	S	S	S	S
<b>Radio (Cab)</b> AM/FM stereo CD (Ford)	0	0	0	0	0	0
<b>Satellite Dish Antenna</b> RV digital, elevation sensing unit	0	0	0	0	0	0
<b>13" 12 Volt Color TV &amp; VCP</b> w/remotes & swivel/slide shelf, front lounge/dinette area*	0	0	0	0	0	0
<b>19" AC Color TV</b> w/remote & video selection system, galley cabinet*						0

	22E	22R	24V	27P	29N	31T
<b>19" AC Color TV &amp; VCR</b> w/remotes & video selection system, galley cabinet*						0
<b>19" AC Color TV</b> w/remote, video selection system & single bunk, front overhead bunk*			0	0	0	
<b>19" AC Color TV &amp; VCR</b> w/remotes, video selection system & single bunk, front overhead bunk*			0	0	0	
<b>Exterior Entertainment Center w/Cassette or CD Player</b> DC receptacle, AC duplex receptacle, AM/FM radio, TV jack, radio antenna, speakers (2), lockable compartment	0	0	0	0	0	0
<b>Exterior Entertainment Center Table*</b> removable	0	0	0	0	0	0

## INTERIOR

	22E	22R	24V	27P	29N	31T
<b>Ceiling Lights</b> incandescent w/wall switches, <b>Cupholder(s), Day/Night Pleated Shades, Front Overhead Bunk</b> mattress, sliding side windows, privacy curtain, side storage cabinets, <b>Nonpowered Roof Vent</b> front overhead bunk, <b>Textured Fabric Ceiling</b>	S	S	S	S	S	S
<b>Dual-Glazed, Thermo-Insulated Windows*</b>	0	0	0	0	0	0
<b>Front Overhead Bunk Ladder</b>						S
<b>Front Overhead Bunk Window</b> delete	0	0	0	0	0	0
<b>Wall Mirror</b> frameless, decorative						S
<b>Wardrobe Cabinet</b> clothes rod, carpeted shelf	S	S	S			

## CABINETY

	22E	22R	24V	27P	29N	31T
<b>Portsmouth Oak Woodgrain</b> stile-and-rail construction raised panel inserts (upper doors only)	\$	\$	\$	\$	\$	\$

## COUNTERTOPS

	22E	22R	24V	27P	29N	31T
<b>Laminate</b> w/wood-look T-mold edging	\$	\$	\$	\$	\$	\$

## FLOORCOVERING

	22E	22R	24V	27P	29N	31T
<b>Carpeting w/Pad, Vinyl Floorcovering</b> bath & galley	\$	\$	\$	\$	\$	\$

## FURNITURE

	22E	22R	24V	27P	29N	31T
<b>Couch</b>	\$	\$			\$	\$
<b>Couch</b> w/2 tables			0	0		
<b>Dinette</b> access to storage below	\$	\$	\$	\$	\$	\$
<b>Lounge Chair(s)</b> swivel/slide			\$	\$	0	
<b>L-Shaped Dinette</b> rear			0			

## GALLEY

	22E	22R	24V	27P	29N	31T
<b>Decorative Wall Border, Double Stainless Steel Sink</b> sink cover (countertop material), <b>Microwave Oven w/Range Hood, Range</b> 3-burner w/oven, Magic Chef, <b>Range Hood w/Light &amp; Fan, Refrigerator/Freezer</b> double-door, Norcold®, <b>Single-control Faucet</b>	\$	\$	\$	\$	\$	\$
<b>Pantry</b>	\$	\$				
<b>Spice Rack</b> built into cabinet		\$			\$	

## BATH

	22E	22R	24V	27P	29N	31T
<b>3-Rod Towel Rack</b> mounted to door, <b>Dual-control Lavatory Faucet, Dual-control Shower Faucet w/Flexible Shower Head, Lavatory Cabinet, Medicine Cabinet, Power Roof Vent, Rectangular Sink, Removable Clothes Rod, Shower Door</b> folding, <b>Tissue Holder, Toilet w/Foot Pedal Flush</b>	\$	\$	\$	\$	\$	\$
<b>Shower</b>	\$	\$	\$		\$	\$
<b>Shower/Tub</b>				\$		
<b>Shower Light, Skylight</b>				\$	\$	\$
<b>Towel Bar</b>	\$		\$	\$	\$	\$
<b>Towel Ring</b>	\$	\$	\$	\$	\$	
<b>Wall Mirror</b> w/frame	\$		\$	\$	\$	

## BEDROOM

	22E	22R	24V	27P	29N	31T
<b>Bedsread, Pillow Shams, Mattress</b> Serta® w/underbed storage*			\$	\$	\$	\$
<b>Double Bed</b>			\$			
<b>Queen-Size Bed</b>		\$		\$	\$	
<b>Twin Beds</b>		0	0	0		
<b>Nonpowered Roof Vent</b>		\$	\$	\$		
<b>Vanity Cabinet</b> w/fold-up table					\$	

## EXTERIOR

	22E	22R	24V	27P	29N	31T
<b>AC Duplex Receptacle, Aluminum Running Boards, Awning Rails</b> w/rain gutter, <b>Entrance Door</b> main w/screen door, deadbolt lock, <b>Ladder, Mirrors</b> plate mount w/convex, <b>Porch Light</b> w/interior switch, <b>Rear Mudflaps, Sidewall Skin</b> 1-piece fiberglass, smooth, <b>Single-door Step</b> manual, <b>Storage Compartments</b> valance panels, trunk liner	\$	\$	\$	\$	\$	\$
<b>Awning*</b> patio	0	0	0	0	0	0
<b>Mirrors</b> plate mount, electric remote w/defrost	0	0	0	0	0	0
<b>Single-door Step</b> electric w/door jamb switch	0	0	0	0	0	0

## SYSTEMS

	22E	22R	24V	27P	29N	31T
<b>6 Gallon Electronic Ignition Water Heater, 10' Sewer Hose</b> stores in bumper, <b>30 Amp 25' Power Cord, AC/DC Load Center/Converter Unit</b> DC automotive style fuses, AC circuit breakers, 15 amp battery charger, 45 amp converter, <b>Automatic Dual Battery Charge Control, Automatic Heater/Air Conditioner, Auxiliary Start Circuit, City Water Hookup, Coach Battery</b> deep cycle, <b>Coach Battery Disconnect System, Generator Prep Kit, LP Tank</b> permanent mount w/gauge, <b>Monitor Panel</b> wall mount, battery condition gauge, generator hourmeter gauge,* generator start/stop switch,* holding tank levels, LP tank level, water heater switch, water heater light, water pump switch, water tank level, <b>Water Heater Winterization Bypass Valve, Water Pump demand, Water System Winterizing Valve, Water Tank Drain, Water Tank Fill w/Locking Door</b>	\$	\$	\$	\$	\$	\$
<b>Coach Batteries*</b> (2) deep cycle	0	0	0	0	0	0
<b>Exterior Wash Station</b>	0	0	0	0	0	0
<b>Furnace</b> 25,000 BTU, Suburban® low profile	\$	\$	\$			
<b>Furnace</b> 30,000 BTU, Suburban, low profile				\$	\$	\$
<b>Generator*</b> 3,600 watt, Onan MicroQuiet, LP				0	0	

	22E	22R	24V	27P	29N	31T
<b>Generator*</b> 4,000 watt, Onan MicroQuiet, gas	0	0	0	0	0	0
<b>Heated Drainage System*</b>	0	0	0	0	0	0
<b>Inverter*</b> DC/AC, 130 watt			0	0	0	0
<b>Roof Air Conditioner</b> 13,500 BTU, ceiling-ducted	\$	\$	\$	\$	\$	\$
<b>Roof Air Conditioner</b> 14,800 BTU, ceiling-ducted						\$

## SLIDEOUT

	22E	22R	24V	27P	29N	31T
<b>Slideout Room</b> (driver side) 20" dinette/couch extension w/slidoorm cover, <a href="#">STORE MORE</a>						\$

## SAFETY

	22E	22R	24V	27P	29N	31T
<b>3-Point Cab Seat Belts, 10 B.C. Fire Extinguisher, Bumpers</b> front & rear, <b>Carbon Monoxide Detector/Alarm, Center High-mount Stop Lamp, Courtesy Light(s) w/Wall Switch(es), Driver &amp; Passenger Airbags</b> Ford, <b>Exterior Assist Handle, Ground Fault Interrupter, Interior Assist Strap, LPG Leak Detector/Alarm, Laminated Safety Glass Windshield, Lap Belts In Selected Areas, Smoke Detector/Alarm</b>	\$	\$	\$	\$	\$	\$
<b>Escape Window</b>			\$	\$	\$	\$

## WARRANTY

	22E	22R	24V	27P	29N	31T
<b>12-Month/15,000-Mile Basic Warranty, 36-Month/36,000-Mile Warranty On Structure,** 10-Year Limited Parts &amp; Labor Warranty On Roof</b>	\$	\$	\$	\$	\$	\$

NA Not Available

• The height of each model is based on the curb weight of a typically equipped unit on the standard chassis. The actual height of your vehicle may vary by as much as 2" depending on chassis or equipment variations.

^ Spirit floorplans feature a wide-body design — over 96". In making your purchase decision, you should be aware that some states restrict access on some or all state roads to 96" in body width. Before making your purchase decision, you should confirm the road usage laws in the states of interest to you.

\* Not all items available in combination. See dealer for details.

◇ Capacities shown are tank manufacturer's listed water capacity (W.C.). Actual filled LP capacity is 80% of listing due to overfilling prevention device on tank.

\$ Standard

0 Optional

\*\* See your dealer for complete warranty documentation information.

Winnebago Industries' continuing program of product improvement makes specifications, equipment, model availability and prices subject to change without notice. Comparisons to other motor homes are based on the most recent information available.

# Spirit

## A Few More Details.



### WIT Club



Membership in the Winnebago Itasca Travelers (WIT) Club is a great way to meet people and get even more enjoyment from your motor home. As an owner of a Winnebago Industries RV, you can join the Club and take advantage of some great services — like professional travel planning and mail forwarding — and participate in some great rallies and caravans. Call 1-800-643-4892 ext. 1 for more information.

### TripSaver

In recent RVDA surveys, Winnebago Industries has been voted number one in the industry for service, parts, and warranty support by dealers across the country. And who would know better than the people who service motor homes? We believe a large part of our service success is due to our commitment to getting you back on the road as soon as possible after experiencing a mechanical emergency. That's why we created TripSaver. This industry-leading program guarantees that qualifying, in-stock emergency warranty repair parts will be shipped directly from the factory within 24 hours. Furthermore, a Winnebago Industries built part or component that is not in stock will be specially manufactured and shipped air freight.



**TRIP**Saver  
Emergency-Shipped Parts

### Warranty Protection

All new Itasca motor homes include a 12-month/15,000-mile basic protection plan, 36-month/36,000-mile warranty protection on lamination and slideroom construction and assemblies, and a standard 10-year limited parts and labor warranty on the roof. As if those aren't enough, we also stand behind most major appliances and equipment we install (a rarity in the industry) so you can count on the convenience of one-stop service for warranty repairs. It all adds up to some of the most comprehensive warranty programs in the industry backed by the most recognized motor home manufacturer in the world.



Visit us at  
[www.winnebagoind.com](http://www.winnebagoind.com)

## Read this guide.

To learn more about what separates our motor homes from others, ask for this free guide next time you visit your Winnebago Industries dealer. It explains our superior manufacturing process. Use it to learn more about important safety and quality considerations as you shop for the motor home that's best for you.



For Sales and Service Information Contact:



©2000 Winnebago Industries, Inc., Forest City, IA 50436

Printed in USA

Seat belts are your most important hookup. Always buckle up.