

NEW Outback

LOFT



Outback LOFT

The Loft is the first sport utility travel trailer to feature a bonus room that expands UP from the roof. With a touch of a button, you raise the roof on the second story and create a spacious living area with screened windows on all four sides, sofa sleeper, L-shaped lounge and entertainment center with LCD TV. The Loft upper level is easily accessed by an interior staircase. The Loft by Outback takes toy hauler living to a whole new level.

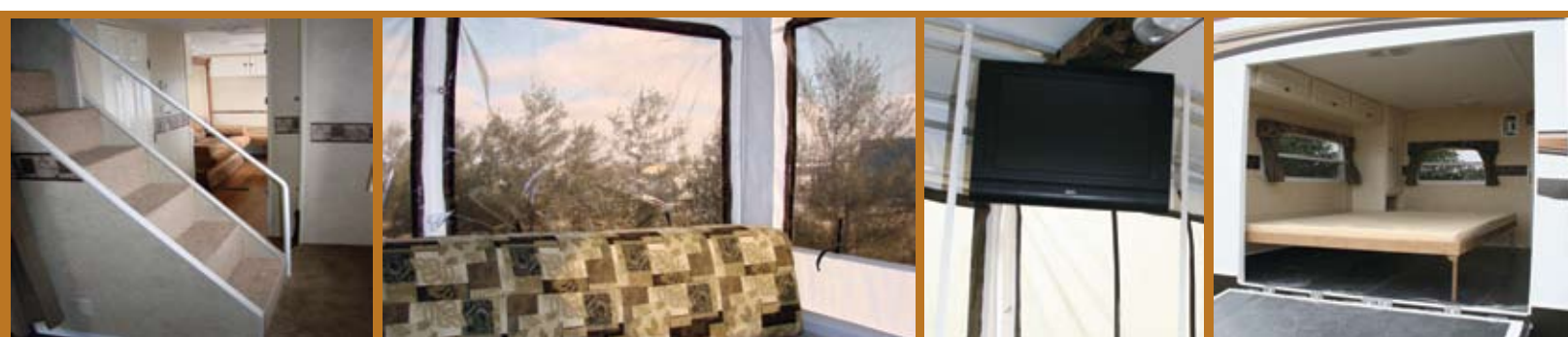

Staircase forward of the toy garage leads up to the Loft bonus room and makes for easy access.

The 7-1/2' x 7-1/2' Loft bonus room is comfortably equipped and spacious. Ceiling height is 6'4".

20-inch LCD TV in the bonus room folds flat for storage.

Large rear toy garage doubles as a bedroom. Queen bed folds down from the rear wall.

NEW *Outback* LOFT

27 LOFT *floorplan*

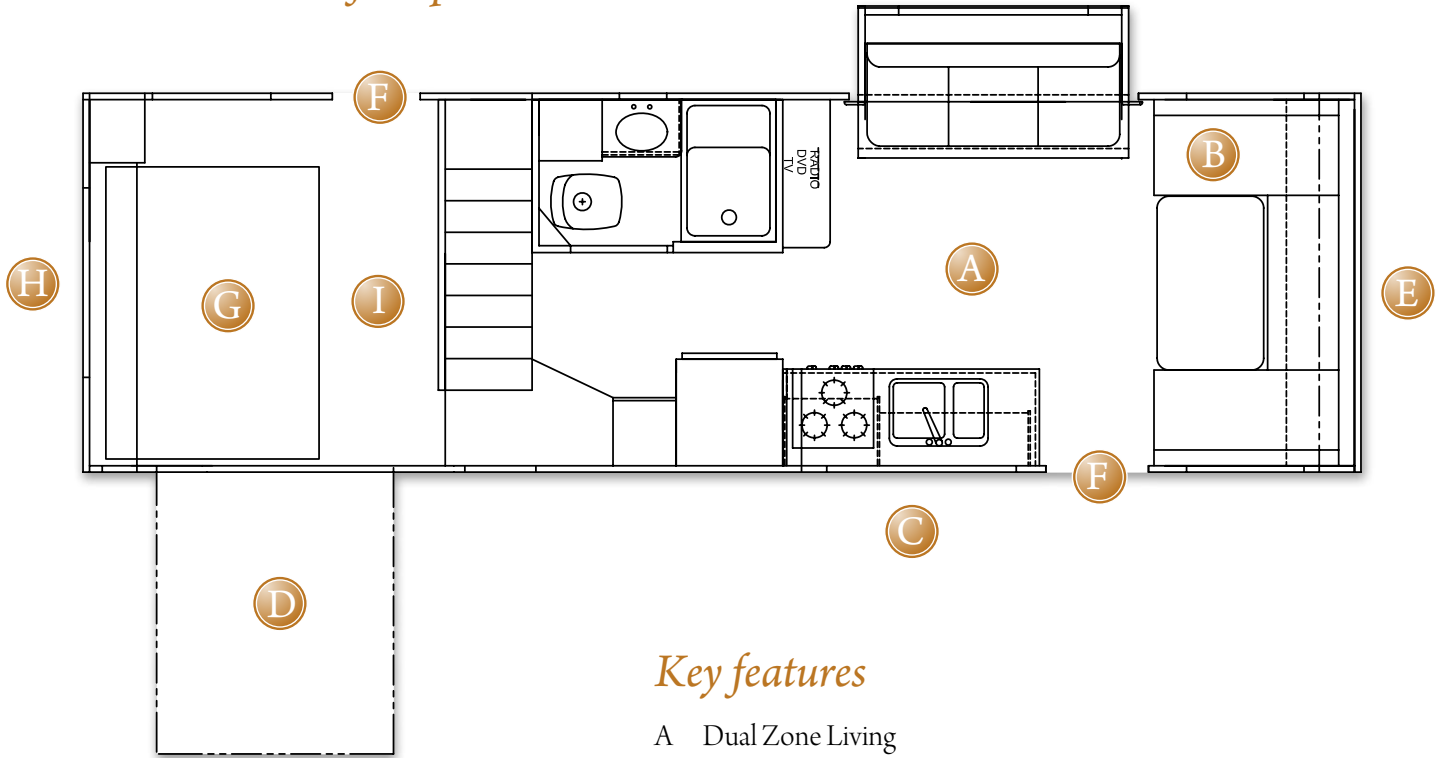

Key features

- A Dual Zone Living
- B King Dinette Seats 6
- C Outside Camp Kitchen
- D 50" Side Ramp Door
- E Heated and Enclosed Underbelly
- F Driver and Passenger Side Entry Doors
- G Second Level Loft Room is Great for Viewing Sports Events
- H Full Aluminum Construction
- I Huge Toy Garage for Golf Carts, ATV, Camping Gear

Specifications

Shipping Weight	6795 lbs.
Hitch Weight	730 lbs.
Length	30' 10"



2642 Hackberry Drive
Goshen, IN 46526
574-535-2100
www.Keystone-outback.com

Product information is as accurate as possible as of the date of publication of this brochure. Features, floor plans, and specifications are subject to change without notice. Please also consult Keystone's web site at keystonerv.com for more current product information and specifications. Tow Vehicle Disclaimer: CAUTION: Owners of Keystone recreational vehicles are solely responsible for the selection and proper use of tow vehicles. All customers should consult with a motor vehicle manufacturer or their dealer concerning the purchase and use of suitable tow vehicles for Keystone products. Keystone disclaims any liability or damages suffered as a result of the selection, operation, use or misuse of a tow vehicle. KEYSTONE'S LIMITED WARRANTY DOES NOT COVER DAMAGE TO THE RECREATIONAL VEHICLE OR THE TOW VEHICLE AS A RESULT OF THE SELECTION, OPERATION, USE OR MISUSE OF THE TOW VEHICLE. November 2007. K-20-095

K-20-095