



# CHEETAH04

*Adventures as colorful as the people you meet.*





# CHEETAH04

## The call of the wilderness.

You hear it. Maybe it started from far away at first, but now it's getting louder, more persistent. It's the voice that's nudging you toward new experiences — daring you to rekindle your spirit of adventure — telling you that now's the time to live the life you've always dreamed about. And for all who hear it, Safari has a motorcoach just for you.

You see, the passion for adventure is at the heart of every coach we build. You feel it in the powerful performance of our big Caterpillar® engine and exclusive Roadmaster chassis. You find it in dozens of high-tech features and innovations. And you experience it in the unmatched livability of our plush, stylish interiors. Yes, these are just some of the things that make adventures in a Safari so alluring. And once you've heard the call, you'll know it's time to take a closer look.

Welcome to the 2004 Cheetah by Safari.





## The Safari Pride



There's more to owning a Safari motorcoach than just driving. There's also the fun and camaraderie that comes from sharing your adventures with other Safari owners. Because, like you, they know life is to enjoy. And best of all, no matter where you go, you're part of the Safari family. So, sit back and let the good times roll.





Cheetah shown in Stonecrest.



**You're not  
afraid to bend our ear.  
We're not afraid  
to listen.**

The 2004 Cheetah is a product of years of listening to our owners, taking their suggestions, and understanding the things that contribute to a superior RV experience.

This year, we've given the coach's exterior a sleek new look, with smooth fiberglass sidewalls and deluxe full body paint. The front cap features a new contemporary look with integrated bumper and new headlamps. The coach also offers many attractive options, including chrome power heated remote mirrors, a rear ladder and a full-length Safari mud flap. Ready for an exciting new world of adventures? The Cheetah is ready to take you there in style.







1.

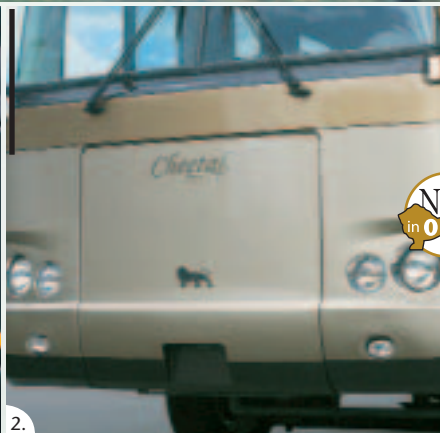

2.

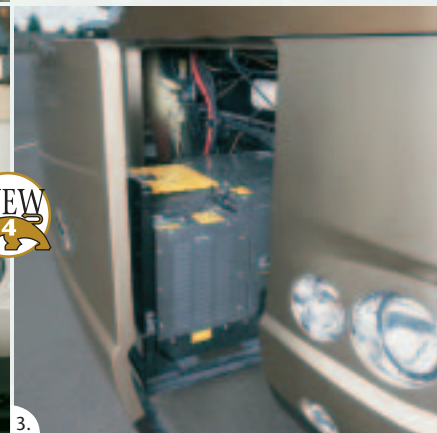

3.



### ALL THE WAYS WE MAKE LIFE EASIER.

1. This central utility bay is conveniently located and gives you easy access to all your hook-up functions.
2. & 3. The powerful Onan® 6.5 kW LP generator (or optional Caterpillar® 8.0 kW diesel generator) is easily serviced thanks to this manual slide-out tray, located in the front of the coach.

### EXPRESS YOURSELF WITH STYLE.



From coast to coast, Safari coaches are recognized by our distinctive optional wildlife murals. Each mural is hand-painted by Dame family craftsmen, and you have your choice of hundreds of designs. Or if you prefer, custom designs are also available.



As you enter the Cheetah, take a deep breath and slowly take in all the luxuries and conveniences that greet you. You'll have your choice of four stunning interiors: Java, Shangri-La, Nassau and Stonecrest. And the beautiful cabinetry, in your choice of three different woods, gives the coach warmth and elegance. Other highlights we'd like to point out include beveled decorative mirrors, the plush carpeting, new optional day/night pleated shades in the living area and bedroom, and sleek tile flooring — or optional plank flooring (shown below).







This is where the journey begins — surrounded by the luxury of the Cheetah's new dash console, featuring a stylish carbon fiber instrument panel. All the controls are within easy reach, and the high-tech amenities include a color rear vision system with audio, optional power sunvisors, 10-disc CD changer and Sirius satellite radio system (requires subscription).

*Cheetah 40SMD shown in Java/Alder with optional Ultraleather™ Euro recliner with ottoman.*



*Cheetah 40SMD shown in Java/Alder with optional plank flooring.*

In the galley, top-of-the-line appliances make even the simplest meal more fun, including the double-door refrigerator with ice maker option, the recessed three-burner cooktop and the versatile spacesaver convection microwave with multiple cook functions. You'll appreciate the styling of the solid surface countertops, stainless steel sinks, and optional raised panel refrigerator doors, as well as the wood plank flooring in the kitchen and bathroom.



1. From rinsing vegetables to washing dishes, everything's easier with our handy new pull-out faucet.



2. The bathroom is as roomy as it is attractive. You'll appreciate the easy-to-clean solid surface countertop with integrated sink, as well as the medicine cabinet and handy towel bars. Most models feature a one-piece fiberglass shower with glass door and brass frame. And while a bathtub is standard on the 40DST, it's an option on the other floorplans.



*Cheetah 40SMD shown in Java/Alder.*

3. Beautifully coordinated bedspread, pillows and window treatments greet you in the bedroom. And you'll find plenty of storage space for all your necessities, including a mirrored wardrobe, nightstands and a dresser with laminate top. Most models even have a built-in clothes hamper. You'll also enjoy the 19" stereo color TV with remote, and you have the option of a convenient, timesaving combination washer/dryer.

# A whole new level of comfort.

This year, the coach features a new suspension system, designed especially for Safari. IPD sway bars in the front and rear help control body roll, while customized KONI adjustable shock absorbers may be fine-tuned to produce a damping action that's most comfortable for you.



The SmartStructure steel truss system is engineered as part of the chassis, creating a strong foundation for your coach and providing large pass-through storage compartments. To ensure its longevity, the entire structure is pre-primed and coated with a rust inhibiting paint.



RR4R-Series Chassis

## Roadmaster Chassis

For superior front-to-rear balance and overall performance, you can't beat the Roadmaster RR4R. Roadmaster chassis are customized to the exact specifications of each Safari coach model and include many distinguishing features that make them the right chassis for your luxury motorhome.

- Cushion Air Glide suspension provides a smoother ride with excellent handling and cornering.
- The Cheetah's rear-mounted aluminum radiator, charged air-cooler and external transmission cooler significantly increase cooling capacity.
- The SmartStructure basement truss system, combined with the raised rail chassis, provides greater strength and structural integrity while reducing weight and increasing storage capacity.

- A larger, 34" spacing between the frame rails offers greater side-to-side stability. The rails also widen in the rear of the coach to accommodate engine access.
- The full air brakes with Automatic Traction Control (ATC) eliminate wheel spin during acceleration, and the anti-lock braking system (ABS) maintains traction and steering when braking on slick surfaces.
- A PAC exhaust brake system allows the driver to use engine exhaust braking on long downhills, saving brake wear and enhancing safety.
- Dual fuel fills provide the convenience of filling the fuel tank from either side of the coach.
- A 10,000-lb. hitch receiver gives the coach powerful towing capacity.



# The strength of Alumaframe®

Thanks to our Alumaframe® Superstructure, your Safari coach is built to take on anything the road can dish out. We revolutionized the industry by replacing outdated wood and tubular aluminum construction with our exclusive system of aluminum C-Channel crossmembers. These run the full length of the coach, with double-welded intersections for superior strength. This makes your Safari lighter and sturdier than other coaches and gives you reliability you can count on down the road.

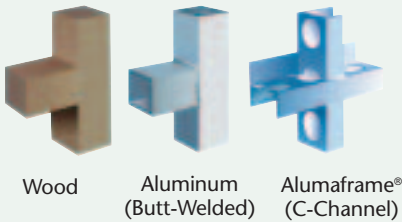

## 5-Layer Floor:

- A 5/8" Structurwood™
- B 1-1/2" steel tube
- C Blue foam
- D Luaun
- E Darco

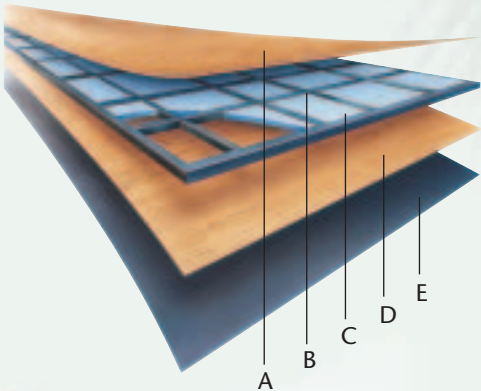

## 5-Layer Exterior Wall:

- A High-gloss gel coat fiberglass
- B Interlocking C-Channel filled with 1-1/2" fiberglass insulation bonded in place so it doesn't sag or leave spaces uninsulated
- C Vapor barrier
- D Bead foam adds comfort, saves energy and provides a thermal insulative barrier
- E Interior paneling

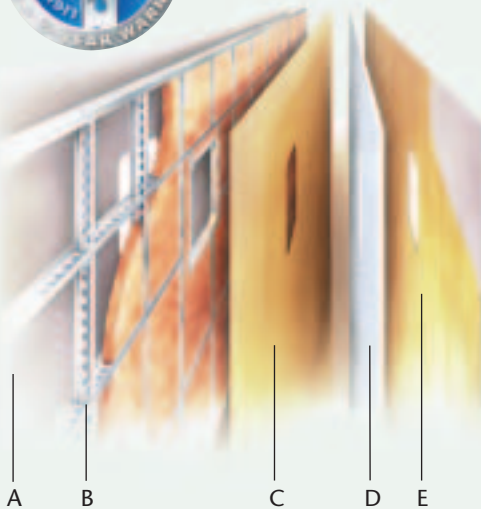

## 9-Layer Roof Construction:

- A Peaked aluminum roof
- B Luaun backing
- C Thick, tapered bead foam insulation
- D Aluminum double I-beam superstructure filled with fiberglass insulation
- E Vapor barrier
- F Structure foam: thermal insulative barrier
- G 1/2" bead foam insulation
- H Foam padding for extra insulation
- I Padded vinyl ceiling

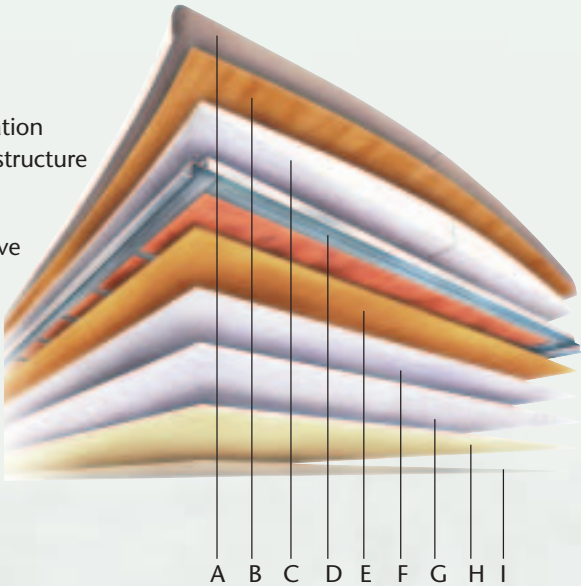

Even the toughest mountain climbs are a breeze, thanks to the Cheetah's gutsy Caterpillar® 3126E/C7 330 HP diesel engine with Allison® 3000 MH 6-speed electronic transmission.



## The perfect finish.

Safari coaches are painted in our own state-of-the-art facility using a multi-step paint process to help lengthen the life of your motorhome's exterior. The process includes sanding, application of sealer and base coat, hand-applied graphics, spray painting, and three applications of clear coat.

# Showing our colors.

Our designers have created exquisite color combinations for your 2004 Cheetah. Now you get to choose the one that's right for you.

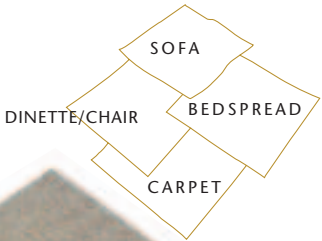

JAVA



NASSAU

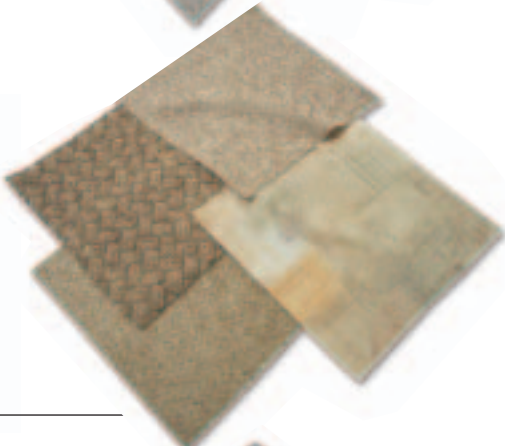

SHANGRI-LA

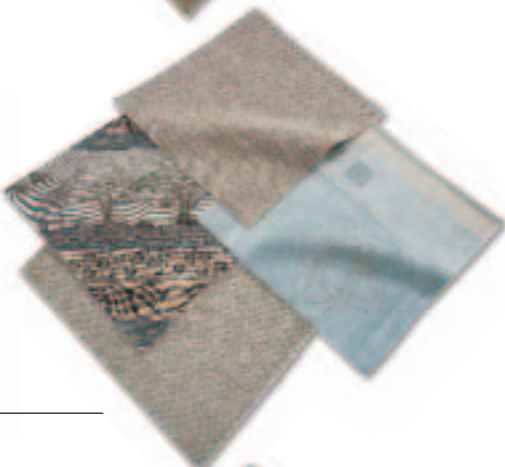

STONECREST

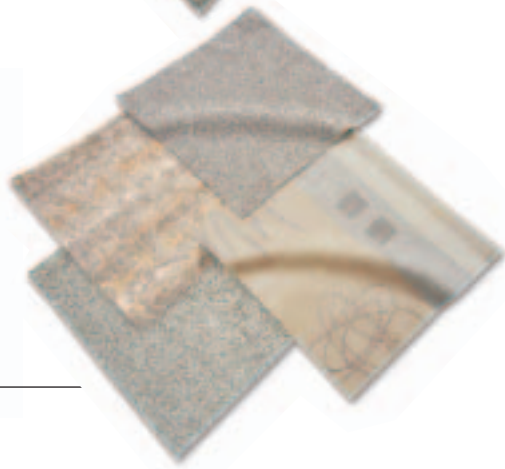

Manufactured in, not added on. 3M Scotchgard™ Carpet Stain Release is applied during the carpet manufacturing process for a higher level of protection. Dupont Teflon® soil repellent is applied to virtually all upholstery fabric during the finishing process for superior coverage.\*

\*Brand and application of carpet or upholstery fabric protection may vary depending on date recreational vehicle was manufactured.





The Cheetah features solid wood square raised panel cabinet doors with stylish new brass finished hardware.



This year, an exciting new option allows you to complement your choice of cabinetry with matching plank flooring in the kitchen and bath.

### CHEETAH WEIGHTS & MEASUREMENTS

Weight Rating (Lbs.)	36PDD	38PDQ	40SMD	40DST	40PBT	40SRT
Gross Vehicle	32,000	32,000	32,000	32,000	32,000	32,000
Gross Combined	42,000	42,000	42,000	42,000	42,000	42,000
Gross Axle (Front)	12,000	12,000	12,000	12,000	12,000	12,000
Gross Axle (Rear)	20,000	20,000	20,000	20,000	20,000	20,000
<b>Measurements</b>						
Wheelbase	228"	252"	270"	270"	270"	270"
Overall Length	36' 11"	38' 11"	40' 5"	40' 5"	40' 5"	40' 5"
Height (with A/C)	12' 2"	12' 2"	12' 2"	12' 2"	12' 2"	12' 2"
Interior Height	78"	78"	78"	78"	78"	78"
Interior Width	94.5"	94.5"	94.5"	94.5"	94.5"	94.5"
Exterior Width	100.5"	100.5"	100.5"	100.5"	100.5"	100.5"
<b>Tank Capacities* (Gal.)</b>						
Water Heater	10	10	10	10	10	10
Gray Tank	55	55	55	55	55	55
Black Tank	39	39	39	39	39	39
Fresh Tank	95	95	95	95	95	95
LP Tank**	38	38	38	38	38	38
Fuel Tank	90	90	90	90	90	90

\* All tank capacities are estimated based upon calculations provided by the tank manufacturers and represent approximate capacities. The actual "usable capacity" may be greater or less than the estimated capacities based upon fabrication and installation of the tanks.

\*\* Actual filled LP capacity is 80% of listing due to safety shut-off required on tank.

Due to the large variety of options and floorplan arrangements available to our customers, actual weights for each unit can differ significantly. Safari provides a weight sticker on each unit we produce which includes that unit's tank capacities and approximate weight. Consult your local Safari dealer for unit availability and further information. The information printed in this brochure reflects product design, fabrication, and component parts at the date of printing. The manufacturer reserves the right, at any time, to make changes in product design or material or component specifications as its sole option, without notice. This includes the substitution of components of a different brand or trade name, which will result in comparable performance. All information printed in this brochure is subject to change after the date of printing. Some features shown or mentioned in this brochure are optional and may only be available in selected floorplans. Photographs may show props or decorations that are not standard equipment on Safari models. Safari, the Safari logo and its design, are registered trademarks. All other products and company names are trademarks and/or registered trademarks of their respective holders.

While the color of the motorhome's exterior and the interior fabrics depicted in this sales brochure are fair and reasonable depictions, the colors depicted may not be an exact match of the actual colors because of the variances in photo-processing and variances caused by inserting the photographs within the sales brochure. Due to product improvements, changes during the model year and/or transcription errors that may occur, information represented within this brochure may not be accurate at the time of your purchase. If certain information is significant to your purchasing decision, please confirm the information with your dealer prior to submitting your order.

The actual overall length of the recreational vehicle may differ from that indicated in the brochure due to variances in the manufacturing process and/or installed components. The actual length may be greater or less than that indicated.

BODY CONSTRUCTION

Standard Features

Aluminum Superstructure  
Steel Cage Cockpit Construction  
Peaked Aluminum Roof with  
Fiberglass Insulation  
Smooth Gel Coat Fiberglass  
Exterior Walls  
Front and Rear Molded Fiberglass  
Caps with Integrated Bumpers  
Laminated Structurwood™ Flooring  
with Aluminum Framing  
Power Step Well Cover  
Foam Insulated Underbelly  
with Luaun Backer  
Power Heated Remote  
Exterior Mirrors  
Baggage Doors with Integrated  
Single Handle Latches  
Wheel Mud Flaps  
Deluxe Full Body Paint  
Entry Step Storage

Options

3M® Film Front Mask  
Chrome Power Heated Remote  
Exterior Mirrors  
Mural  
Rear Ladder  
Full Length Safari Mud Flap

COCKPIT

Standard Features

Fiberglass Automotive  
Dash with Carbon Fiber  
Instrumentation Panel  
CD Player with Six Speakers  
Multi-Positioned Sunvisors  
Rear Vision System with Audio  
Intermittent Windshield Wipers  
Tilt and Telescoping  
Steering Wheel  
Power Steering  
Dual Roof Mounted Air Horns  
Cup Holder  
Soft Touch Vinyl Pilot and  
Co-Pilot Seats with Six-Way  
Power Pilot Seat  
Carpet Driver and Passenger  
Floor Mats  
Adjustable Accelerator and  
Brake Pedals  
CB Prep with Antenna

Options

Six-Way Power Co-Pilot Seat  
Power Sunvisors  
Ten-Disc CD Changer  
Sirius Satellite Radio System  
(Requires Subscription)

CB Radio  
AM/FM Stereo Cassette  
(Deletes CD) (N/A with  
Sirius Option)

APPLIANCES AND ACCESSORIES

Standard Features

Double-Door Refrigerator with  
Flat Panel Doors  
Recessed High-Output  
3-Burner Cooktop  
Spacesaver Convection  
Microwave with Touch Control  
25-Inch Stereo Color TV  
with Remote in Living Area  
Living Area Stereo TV Wired  
through Ceiling Speakers  
19-Inch Stereo Color TV  
with Remote in Bedroom  
TV Antenna and Booster  
Cable TV Hook-Up and  
Telephone Jacks  
Washer/Dryer Prep

Options

Double-Door Refrigerator  
with Ice Maker  
Four-Door Refrigerator  
with Ice Maker  
High-Output 3-Burner Range  
with Oven  
Combination Washer/Dryer  
Home Theater System  
with DVD Player  
Stereo VCR

INTERIOR

Standard Features

Alder Cabinetry  
Solid Wood Square Raised  
Panel Cabinet Doors  
Low Friction Roller Drawer Guides  
Brass Finished Cabinet Hardware  
Solid Surface Kitchen Countertop  
with Stainless Steel Sinks and  
Two Sink Covers  
Tip Out Tray under Kitchen Sink  
Waste Basket Storage  
Four-Compartment  
Drawer Organizer  
Slide-Out Wire Pantry (N/A  
with Four-Door Refrigerator)  
Ceramic Tile Flooring in  
Kitchen and Bathroom  
Wallpaper Border in Bathroom  
Padded Vinyl Ceiling  
Nylon Carpeting and Pad in  
Living Area and Bedroom  
Mini Blinds Throughout

Solid Surface Bathroom  
Countertop with Integrated Sink  
Medicine Cabinet with Shelves  
Bathroom Mirror  
Towel Bars in Bathroom  
Nightstands with Laminate Tops  
Bedroom Dresser with  
Laminate Top  
Clothes Hamper (N/A: 40PBT)  
Bedsread with Pillows

Options

Regal Cherry Cabinetry  
Maple Cabinetry  
Laminate Plank Flooring  
in Kitchen and Bathroom  
Raised Refrigerator Panel Insert  
Day/Night Pleated Shades in  
Living Area with Blackout  
Shades in Bedroom

FURNITURE

Standard Features

Queen Bed  
Fabric Easy Bed Sofa with  
Drawer – Curbside (36PDD,  
38PDQ, 40DST, 40PBT)  
Fabric Easy Bed Sofa with  
Drawer – Driver's Side  
(N/A: 40DST, 40PBT)  
Fabric Recliner – Curbside  
(N/A: 38PDQ, 40DST, 40PBT)  
Fabric Recliner – Driver's Side  
(40DST, 40PBT)  
Round Hardwood Top Dinette  
Table with Two Freestanding Chairs  
Two Folding Dinette Chairs  
Computer Table (40DST, 40PBT)

Options

Ultraleather™ Recliner –  
Curbside (N/A: 38PDQ, 40DST,  
40PBT)  
Ultraleather™ Recliner –  
Driver's Side (40DST, 40PBT)  
Ultraleather™ Euro Recliner  
with Ottoman – Curbside  
(N/A: 38PDQ, 40DST, 40PBT)  
Ultraleather™ Euro Recliner  
with Ottoman – Driver's Side  
(40DST, 40PBT)  
Fabric Hide-A-Bed Sofa  
(36PDD, 38PDQ, 40DST, 40PBT)  
Computer Table (38PDQ, 40DST,  
40PBT)  
Booth Dinette (N/A: 40SMD)



**ELECTRICAL SYSTEMS  
AND LIGHTS**

*Standard Features*

50 Amp 120V Distribution  
Panel and Power Cord  
Onan® 6.5 kW LP Generator  
on Slide-Out Tray  
Four 6V Deep Cycle Batteries  
Two 12V Heavy Duty  
Chassis Batteries  
Battery Disconnect Switches  
1500 Watt Inverter  
Porch Light  
Pilot and Co-Pilot Map Lights  
Power Entry Step with Light  
Water Pump Switch  
Lights in Outside Storage  
Compartment  
110V Receptacles inside  
Storage Compartment  
Underhood Utility Light  
110V/12V/Phone Receptacle  
in Dash Area  
Recessed Systems Control Center  
Fluorescent Ceiling Lights  
in Kitchen  
Decorative Dining Light  
Cosmetic Vanity Lights  
in Bathroom  
Decorative Wall Lights  
in Bedroom  
Decorative Wall Lights in  
Living Area

*Options*

Energy Management System  
Power Tech 8.0 kW Diesel  
Generator with Caterpillar®  
Engine on Slide-Out Tray

**HEATING, VENTS, AND  
AIR CONDITIONING**

*Standard Features*

Dual 13.5M BTU Air  
Conditioner with Ducted  
Air and Wall Thermostat  
40M BTU Electronic  
Ignition Furnace  
Electronic AC/Heat  
Climate Control System  
In-Floor Ducted Heating System  
12V Attic Fan in Kitchen  
12V Roof Vents in Bath Area  
12V Wet Bay Heater

*Options*

13.5M BTU Air Conditioner  
with Heat Pump

**PLUMBING AND  
LP SYSTEMS**

*Standard Features*

Demand Water System and  
Water Pump  
10-Gallon LP Gas/Electric Water  
Heater with Electronic Ignition  
Winterization Valving System  
Gravity and Pressurized Water Fill  
Pull-Out Kitchen Faucet  
One-Piece Fiberglass Shower  
(N/A: 40PBT)  
Bath Tub (40DST)  
Glass Shower Door with  
Brass Frame  
Toilet with Sprayer  
Insulated Systems Compartment  
with Easy Access to Hook-Up  
Service Bay Faucet

*Options*

Bath Tub (Std. in 40PBT)

**SAFETY**

*Standard Features*

Fire Extinguisher  
Deadbolt Lock on Entrance Door  
120V GFI Protected Circuit  
(Kitchen, Bathroom, Exterior)  
LP Gas Detector  
Smoke Detector  
Carbon Monoxide Detector  
Pilot and Co-Pilot Three-Point  
Seat Belts (Lap and Shoulder)  
Third Brake Safety Light  
Egress Window

**WINDOWS, DOORS,  
AND AWNINGS**

*Standard Features*

Radius Dual Pane Safety Glass  
Dark Tinted Slider Windows  
Entry Door with  
Removable Screen  
Entry Assist Handle  
Tinted Skylight in Bathroom  
Patio Awning with Color  
Coordinated Hardware

*Options*

Front Door Awning  
Carefree® Automatic Patio Awning  
Window Awning

**CHASSIS/ENGINE/  
SUSPENSION**

*Standard Features*

Roadmaster RR4R-Series Chassis  
Caterpillar® 3126E/C7 330 HP  
Diesel Engine with Allison® 3000  
MH 6-Speed World Transmission  
and Electronic Shifter  
Torque: 860 lbs./ft. Max. Net  
at 1,424 RPM  
Cubic Inch Displacement:  
504.5~/8.3L  
160 Amp Alternator  
Rear Axle Ratio: 4.30:1  
Dual Fuel Fill  
Radial Tires: 275/70R/22.5  
Four Air Bag Suspension  
with Four Gas Shocks  
Anti-Lock Braking System  
with Full Air Brakes (Drum)  
Automatic Traction Control  
Pac Exhaust Brake  
Fuel and Water Separator  
Fuel Filter  
Rear Side Air Intake  
Air Cleaner Restriction Indicator  
Hydraulic Leveling System  
10,000 Lb. Hitch Receiver\*  
with Six-Point Connector  
Undercoating

*Options*

Polished Aluminum Wheels

\* Your towed vehicle should be  
equipped with auxiliary brakes  
if the weight of the towed load  
exceeds 1,000 lbs.

Floorplans for the way you live.

With Cheetah’s six terrific floorplans, you’ll have only one problem — deciding which one you like best. And just wait until you see all the options. Like the Fabric Hide-A-Bed sofa, four-door refrigerator with ice maker, and booth dinette. Choosing the floorplan you want may not be easy, but you’ll have fun doing it — and even better, living it.

36PDD CHEETAH

TILE

CARPET

FURNITURE

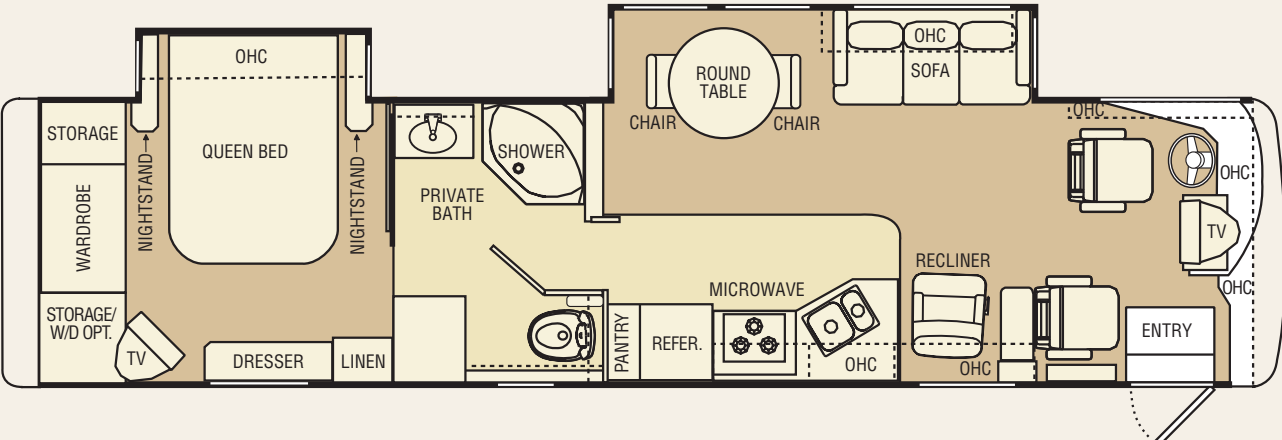

NEW  
in 04

38PDQ CHEETAH

Introducing the new Cheetah quad slide.

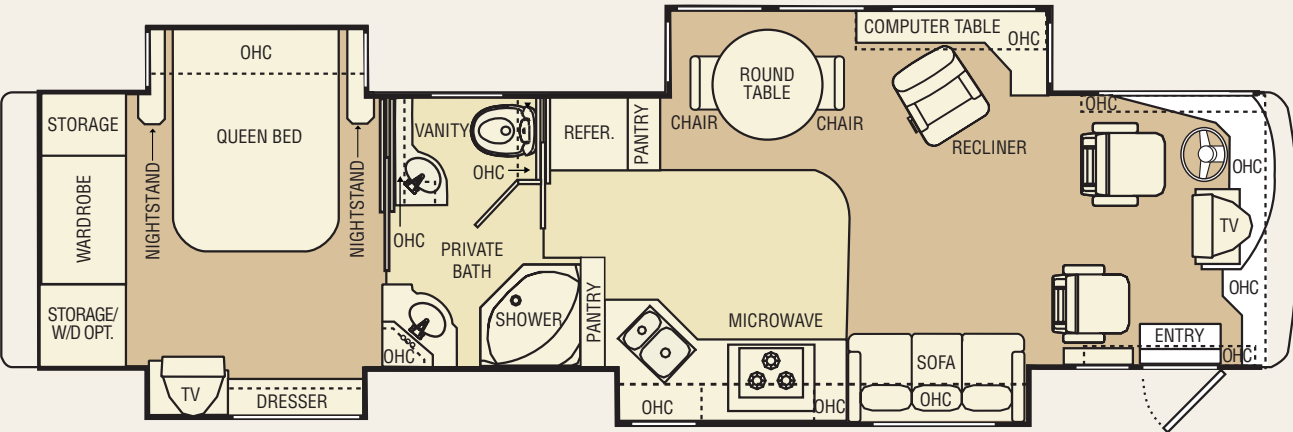

40SMD CHEETAH

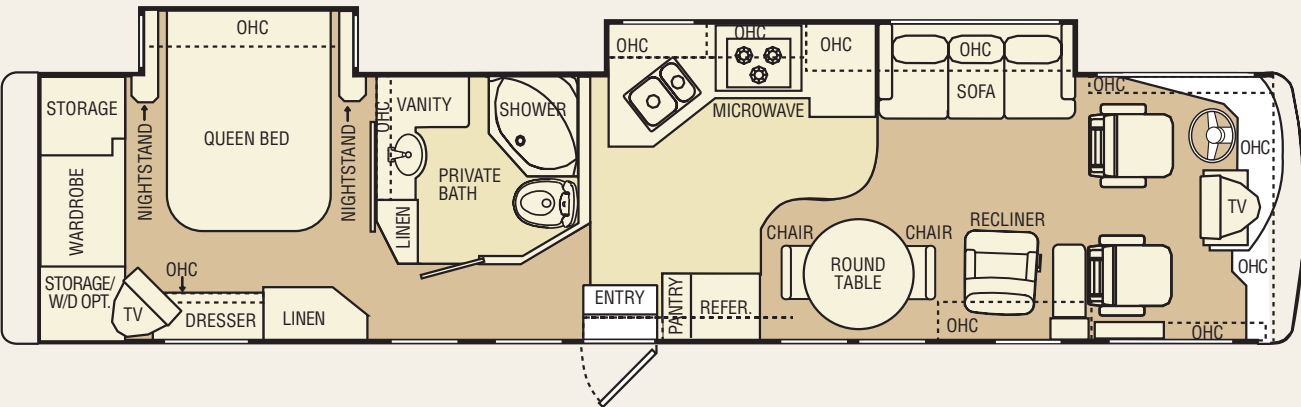



40DST CHEETAH

TILE

CARPET

FURNITURE

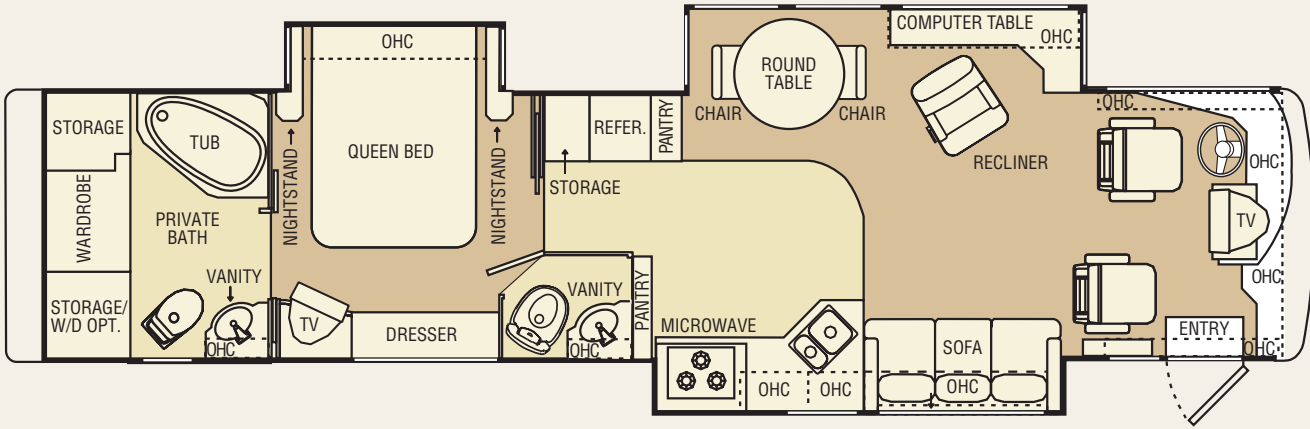

40PBT CHEETAH

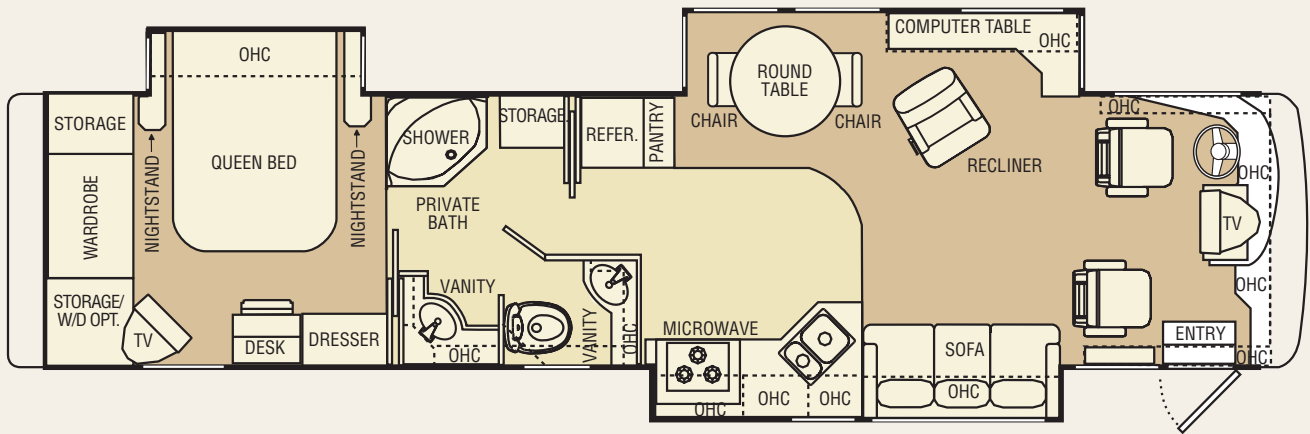

40SRT CHEETAH

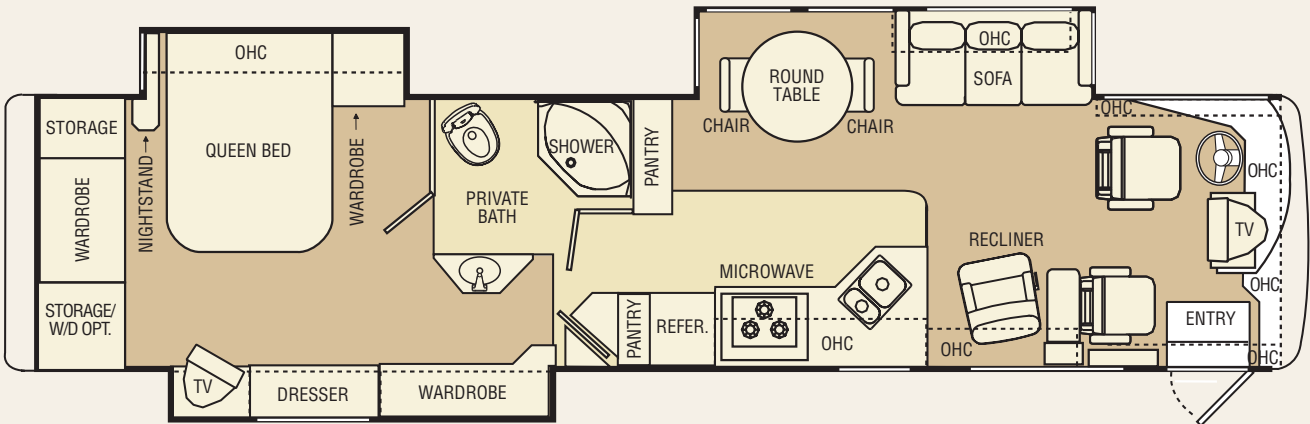



## CHEETAH04



### Adventures worth sharing.



As a Safari owner, you're entitled to join us throughout the year for rallies designed just for you. You'll meet freedom-loving folks from across the country, all celebrating the adventure of the open road. In addition, you'll enjoy sharing travel information and tips about your coach in our Safari Adventures magazine,

published six times per year. And at [www.safarimotorcoaches.com](http://www.safarimotorcoaches.com), you'll find a world of information online, right at your fingertips.



Safari's "Women's Only" seminars provide the opportunity for us to get the feminine perspective, which helps us continue designing great motorcoaches.





**No matter where you roam,  
the Safari Family Advantage travels with you.**

When you purchase a coach from Safari, you become part of an industry-leading family of companies called Monaco Coach Corporation. What does that mean for you?



It means you have access to a wider array of benefits. To begin with, your coach is built by a level of expertise that could only be achieved through the teamwork and combined experience of all our companies. Like, for example, such exclusive innovations as the Roadmaster chassis — designed specifically for each individual model of our diesel coaches. You also get the benefit of our White Glove factory



inspection program, for a higher level of quality assurance and added peace of mind. And your dealer will be happy to tell you about our other innovative programs, including our Extended Care service agreements. Of course, once you're on the road, you'll have access to our nationwide network of more



than 350 service facilities, meaning wherever you travel, you're never far from a friend. Ready to roll? In a 2004 Safari, the strength of our entire family is behind you every mile of the way.

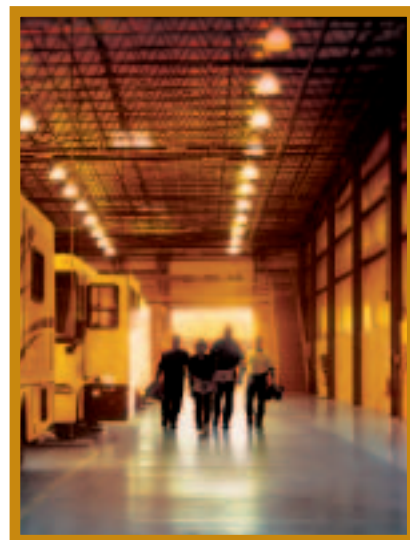

**350** | Service  
and growing | Facilities  
Nationwide

#### WARRANTIES

**12 MONTH/24,000 MILE**  
basic limited warranty

**5 YEAR/50,000 MILE**  
limited warranty on aluminum or  
steel frame structure of sidewall,  
roof, front and rear cap

**3 YEAR/36,000 MILE**  
limited warranty on  
Roadmaster chassis

See owner's manual for complete details.



**MONACO COACH CORPORATION**



**Everything but ordinary.**

*Every Safari comes with the ability to roam free.*

There's a spirit in the air. One that whispers freedom — gently urging you to break out and go exploring on your own terms. At Safari, our coaches are bred with a passion for adventure. Whether it takes you to remote mountain hideaways, winding coastal roads or simply across the Midwest to visit



your kids. We've combined the very best in engineering and innovation to give you feature-packed coaches at some of the best values in the industry. But in the end, don't just take our word for it. Visit a Safari dealer near you, and get a real taste of the adventure that lies ahead.

---

*The 2004 Safari Lineage*

**PANTHER**

**ZANZIBAR**

**SAHARA**

**CHEETAH**

**TREK**

YOUR SAFARI MOTORCOACH DEALER:

Visit our web site at [www.safarimotorcoaches.com](http://www.safarimotorcoaches.com) for the dealer nearest you or call 1-800-634-0855.

BY MONACO COACH CORPORATION • 91320 Coburg Industrial Way • Coburg, OR 97408

© 2003 Monaco Coach Corporation (NYSE: MNC) Printed in USA

0803 NPN: BROSCHE