

# 2005 DAMON CHALLENGER



Prewitt, New Mexico

You've just found the most motorhome for the money. Challenger.



# WELCOME TO PARADISE.



Paradise is where luxury doesn't cost a fortune and amenities grow on trees. And it's where you are when you step inside the stylish 2005 Challenger Motorhome. Our new Challenger is a wide body with a full basement and multiple pass-through storage compartments. Challenger is filled with amenities that you would normally find in higher priced motorhomes. And it's all





rolled into one beautiful package that surpasses your expectations but doesn't exceed your budget.

**LUXURY AMENITIES.**

A Carrier® ducted air conditioner is mounted on the roof and has a remote thermostat so you can adjust the temperature from inside your Challenger.

Huge 40-inch-deep living-area slideouts and 30-inch-deep bedroom slideouts are available on select models to provide a wide-open interior usually found on higher priced motorhomes.

Challenger's aerodynamic gelcoated front and rear fiberglass caps offer a sleek, stylish appearance.

## FLOOR PLANS

Damon offers a variety of floor plans and options. All provide the roomiest, most convenient mobile living experience you've ever had.

**327**



40-inch living-area slideout • 30-inch bedroom slideout • Private stool area

**335**

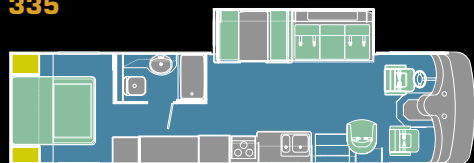

Generous closet space • 40-inch living-area slideout

**348**

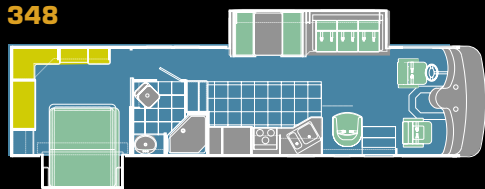

Living-area slideout • 30-inch bedroom slideout • Garden tub

**353**

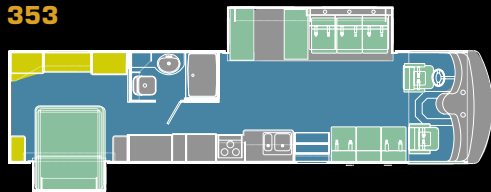

40-inch living-area slideout • 30-inch bedroom slideout

**371**

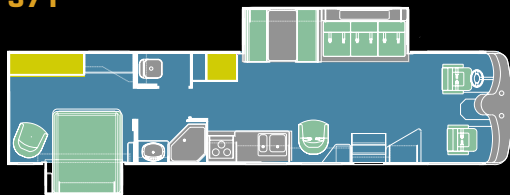

Dual-zone living • 40-inch living-area slideout • Floor-mounted television



## MORE DELICIOUS DETAILS.

It's easy to enter and exit Challenger's captain's chairs, since the low-profile engine cover takes up so little floor space.

Cabinet doors are handcrafted with solid-wood for durability and long-lasting beauty.

Beautiful side-mounted awnings let you enjoy the patio, rain or shine. They also protect slideouts from detrimental weather.

Four-point hydraulic leveling jacks come standard on all Challenger slideouts and operate with an electric touchpad control.

A 5,000-lb. heavy-duty trailer hitch lets you tow most SUVs.

The kitchen is vinyl tile floor which is easy to keep clean and won't scratch or dent.

It's easy to keep your cooking supplies organized in Challenger's huge pantry with adjustable shelves and roll-out drawers.

There's plenty of room for your active life, thanks to extra-large, extra-strong multiple pass-through rotocast storage compartments. Plus, they have drain valves for quick wash out.

110-volt/12-volt outlets in the cockpit let riders use laptop computers, telephones and other electronic devices.

The optional driver's side door makes fuel stops easy. Features a slider window and lock for added convenience and security.

Premium AM/FM/Pioneer® CD player in the cockpit dash comes standard.

## SIDEWALLS

Sidewalls are five layers thick, consisting of:

- Exterior fiberglass
- Wood backer
- Aluminum frame
- Bead-foam insulation
- Interior wallboard

Walls are also vacuum-bond laminated for added strength and rigidity.

## FLOOR

A water-resistant, Structurwood® floor supports the living area. Framed in 1.5-inch welded-steel tubing, it's insulated with solid bead-foam and protected with a galvanized underbelly, providing rust and corrosion protection.





## BUILT WITH A REMARKABLE BALANCE OF STRENGTH AND SOPHISTICATION.

### ROOF

Challenger's roof is vacuum-bond laminated for superior strength and rigidity. It features an aluminum rafter support system with bowed rafters to maintain the roof's crowned shape. A crowned roof permits better water runoff, which helps prevent leaks.

### BASEMENT AND STORAGE

The Challenger basement construction incorporates a strong, welded-steel truss system. Trusses are horizontal to better distribute weight. They also allow for Challenger's full basement and massive pass-through storage compartments.

### UTILITIES

Travel in any season because of Challenger's heated holding tanks and fully contained plumbing systems. Tanks are mounted horizontally, making service and maintenance easy.

### CHASSIS

Quality construction starts here. And Challenger uses only the finest: either a rugged Ford® or Workhorse® chassis depending on the floor plan.



# FEEL RIGHT AT HOME.

Now it's time to choose your favorite fabrics, paint colors, wood styles, floor plans and other options. No matter which model and design package you choose, you can be assured that every Challenger Motorhome we make is built the same way — the right way — with the same high-quality materials, components and state-of-the-art construction techniques.

## SPECIFICATIONS AND FEATURES

For a complete list, visit [www.DamonRV.com](http://www.DamonRV.com)

### Bathroom

12" x 12" vinyl tile flooring	S
Shower surround with door	S
Skylight in shower	S
Power vent	S
Foot-flush toilet	S

### Bedroom

Standard mattress	S
Upgraded innerspring or Memory Foam mattress	O
Bedspread and headboard	S
TV area and jack	S
Color TV	O
Pin-up lights	S

### Chassis

Ford® F53 chassis with 6.8L V-10 engine (310-hp, 425 lb.ft. torque)	O
Workhorse® W chassis with Vortec™ V-8 engine (340-hp, 445 lb.ft. torque)	O
Four-point leveling jacks with semi-automatic touchpad controls	S
Spare tire, wheel and bracket	S
Front and rear mud flaps	S
Stainless-steel wheel liners	S
Trailer hitch (5,000 tow lbs. / 500 tongue lbs.)	S
Emergency start circuit	S
Under-hood light	S

Automatic transmission with overdrive	S
Layer of neoprene vibration dampener	S

### Cockpit

New, molded ABS dash	S
Electronically controlled dash air conditioning	S
AM/FM/CD player	S
Cruise control	S
Tilt steering wheel	S
Map light and dash fans	S
Driver's door with slider window	O
Tinted wraparound windshield with privacy shade	S
Side-mounted power mirrors	S
Front-mounted power mirrors with heat	O
Floor mats	O
Reclining swivel captain's chairs (ultra-leather optional)	S
3-point, wall-mounted seat belts	S
Sun visors	S
Backup monitor system with audio	O
Drink holders	S

### Entry

Electric entrance step	S
Ice chest and battery access in stairwell	S

### Exterior

Paint package	O
Fog lights	S
Radius-cornered domed BriteTEK™ TPO roof	S
Rear ladder	O
Aerodynamic front and rear fiberglass caps	S
Side-mounted patio awning	S
Side-mounted awning over slideout	S
White smooth fiberglass exterior with deluxe graphics	S
Upgraded gelcoated sidewall	O
White-trimmed, radius-topped entrance door with deadbolt lock and black-trimmed, clear window with shade and valance	S

Black-framed, radius-corner, slider windows	S
Black-framed, dual-pane windows	O
Patio light	S
Easy-to-clean, lighted, rotocast storage compartments	S
Full basement pass-through storage	S
Gas spring-supported storage doors	S

### Kitchen

Refrigerator: flush-mounted, double-door	S
Refrigerator: large flush-mounted, double-door	O
Refrigerator: raised-panel, hardwood front (oak or maple)	O
Refrigerator: large flush-mounted, double-door with icemaker	O
3-burner range and oven with folding range cover	S
Cooktop IPO range and oven (requires convection microwave)	O
Microwave oven	S
Microwave/convection oven	O
Lighted power range hood	S
Monitor panel with LPG readout	S
Sink cover	S
Pantry (N/A on 335)	S
Solid-wood cabinet doors throughout (flat-panel lower, raised-panel upper) (oak or maple)	S
12" x 12" vinyl tile flooring	S
Plank flooring (oak or maple)	O
Booth dinette	S
Freestanding dinette with 2 folding chairs	O
Two folding chairs (available with freestanding dinette)	O
Mini blinds	S
Wallpaper border	S
Fantastic® power vent	O

### Living Area

Barrel chair(s) (N/A on 353)	S
Euro recliner with leather seating surface and ottoman (N/A on 353)	O
Two Euro recliners IPO sofa bed (353 only)	O
Sofa bed (passenger side) (353 only)	S

Crystal Springs

Palm Coast

Silver Falls

Spice Valley

Hide-a-bed	S	Generator: 5.5 kW	O
Lambrequin window treatments	S	Generator: 7.0 kW Onan® Marquis Gold™ (requires 50-amp service)	O
Day/night shades (except kitchen)	S	Converter: solid-state 60-amp, 12-volt with transfer switch	S
100% nylon carpeting with stain treatment and padding	S	Dual 6-volt auxiliary batteries	S
Color TV in cockpit overhead with full-function remote, antenna booster and jack	S	Electronic battery distribution center	S
Video package (VCR/DVD player and control center)	O	Battery disconnect	S
Decorator clock and mirror	S	30-amp, 120-volt service	S
Fabric ceiling	S	50-amp, 120-volt service	O
<b>Utilities</b>			
Air conditioner: 13,500-BTU ducted central (front)	S	Exterior GFCI receptacle	S
Air conditioner: 15,000-BTU ducted central upgrade (front)	O	Enclosed heated potable and holding tanks	S
Air conditioner: 13,500-BTU ducted central (rear)	O	Telephone, cable TV and satellite hookups	S
Remote thermostatically controlled air conditioning	S	Pre-wired for roof-mounted satellite dish	S
Furnace: 35,000-BTU electronic ignition, floor-ducted	S	DSS manual satellite dish	O
Water heater: 6-gallon gas with electronic ignition	S	Exterior shower	O
Water heater bypass kit	S	Carbon monoxide detector, LP gas and smoke detectors	S
Pre-wired for generator with auto changeover	S		

S = Standard O = Optional N/A = Not available

<b>Weights &amp; Measures</b>	<b>327</b>	<b>335</b>	<b>348</b>	<b>353</b>	<b>371</b>
Chassis	Workhorse/Ford	Workhorse/Ford	Workhorse/Ford	Workhorse/Ford	Workhorse/Ford
Wheelbase	208	216.5	228	228	242
Overall length	33' 9"	35' 1"	36' 6"	36' 6"	37' 11"
Overall width	101"	101"	101"	101"	101"
Overall height with AC	12' 0"	12' 0"	12' 0"	12' 0"	12' 0"
Std. weight (appx. lbs.)	16,894/16,199	16,358/15,957	17,422/16,805	17,357/16,839	17,785/17,295
BVWR	20.7K/20.5K	20.7K/20.5K	20.7K/22K	20.7K/22K	22K
GCWR	26K	26K	26K	26K	26K
Fresh water (appx. gal.)	75	75	75	75	75
Grey/black water (appx. gal.)	50	50	50	50	50
LP (lbs.)	103.5	103.5	103.5	103.5	103.5
Sleeping capacity	4	4	4	5	4
Exterior storage capacity (cu. ft.)	152	158	167	160	181
Interior drawers	17	14	23	21	20
Fuel capacity (appx. gal.)	75	75	75	75	75

### PAINT

Challenger's exterior has a wonderfully fluid, sweeping look, with bold, clean graphics and optional paint styles. Few other motorhomes in Challenger's class offer this many choices.



Deluxe Graphics Package (Standard)



Desert Sand Paint Package (Optional)

### DÉCOR

Choose from a selection of well-appointed décor package that lend a sense of personality and make you feel right at home in your Challenger.

Maple

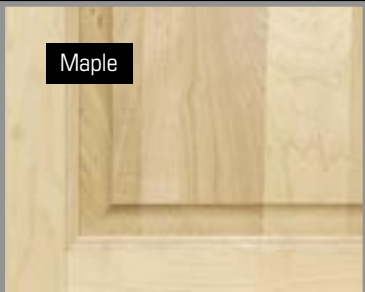

Oak

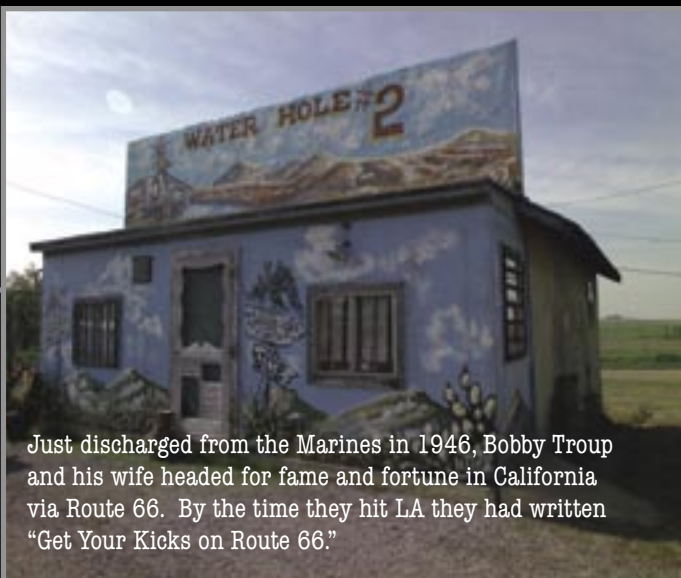
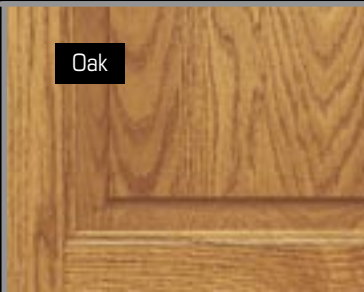

Just discharged from the Marines in 1946, Bobby Troup and his wife headed for fame and fortune in California via Route 66. By the time they hit LA they had written "Get Your Kicks on Route 66."





38-Span Bridge. Bridgeport, Oklahoma



**DAMON**  
MOTOR COACH

P.O. Box 2888 • Elkhart, IN 46515

Sales: 800-860-5658

Customer Service: 800-860-3812

[www.DamonRV.com](http://www.DamonRV.com)



DC 8/04 © 2004 Damon Motor Coach Printed in U.S.A.

Due to constant product improvements, the specifications of certain models may be discontinued without notice or obligation. Components and features may differ to conform to local codes. Due to EPA environmental restrictions, engine power and torque ratings may change mid-year.



# Challenger

## 2005.5 FLOOR PLANS

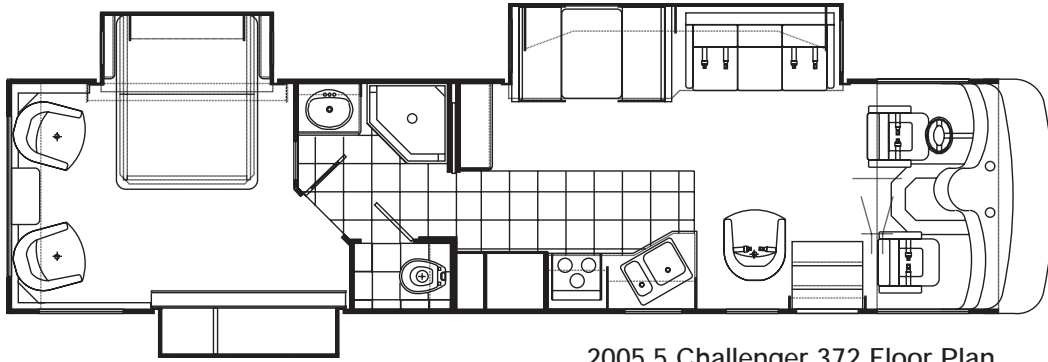

2005.5 Challenger 372 Floor Plan

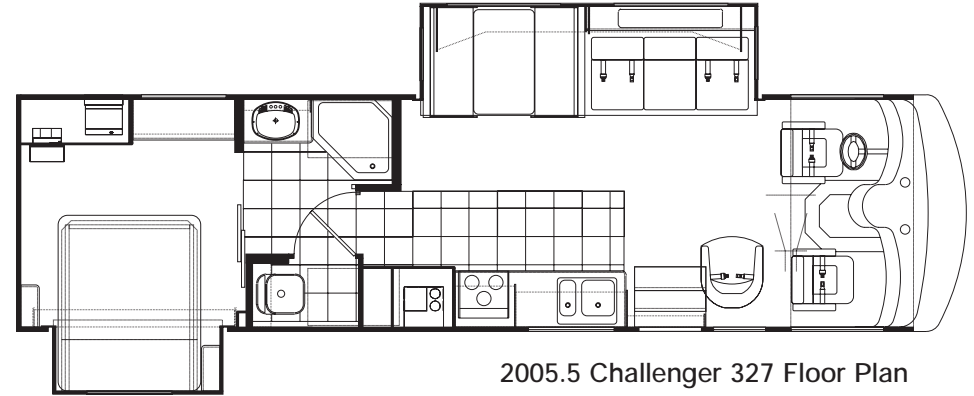

2005.5 Challenger 327 Floor Plan

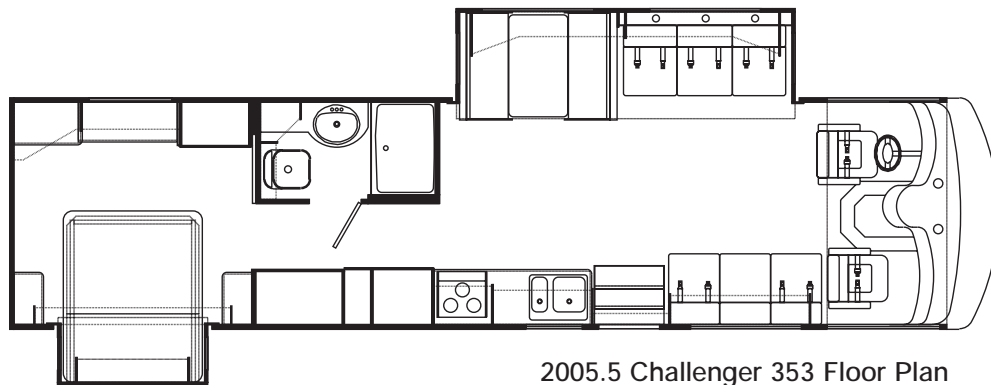

2005.5 Challenger 353 Floor Plan

*Value by design is back!*

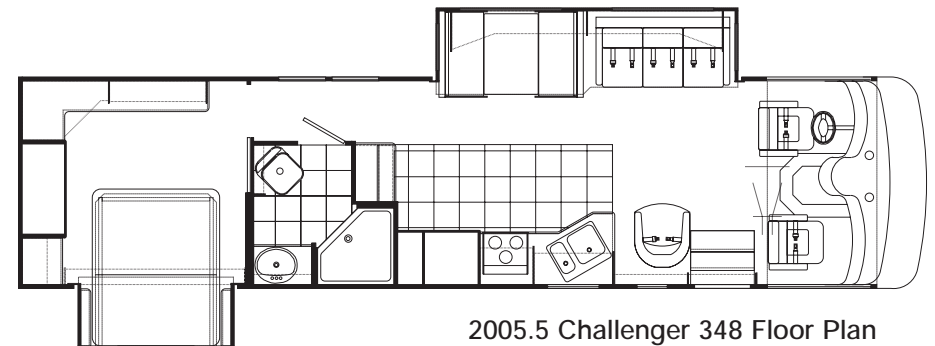

2005.5 Challenger 348 Floor Plan

# 2005.5 CHALLENGER SPECIFICATIONS

Challenger Bathroom	327	348	353	372
Vinyl tile flooring	S	S	S	S
Shower with surround	S	S	S	S
Shower door	S	S	S	S
Skylight in shower	S	S	S	S
Power vent	S	S	S	S
Foot-flush toilet	S	S	S	S
Wallpaper border	S	S	S	S
Challenger Bedroom	327	348	353	372
Standard mattress	S	S	S	S
Upgrade innerspring mattress	0	0	0	0
Bedspread and pillow shams with pillows	S	S	S	S
TV area and jack	S	S	S	S
13" color TV	0	N/A	N/A	N/A
19" color TV	N/A	0	0	0
Pin-up lights	S	S	S	S
Challenger Chassis	327	348	353	372
Four-point leveling jacks with semi-automatic touchpad controls	S	S	S	S
Spare tire, wheel and bracket	S	S	S	S
Front and rear mud flaps	S	S	S	S
Stainless-steel wheel liners	S	S	S	S
Trailer hitch (5,000 tow lbs. / 500 tongue lbs.)	S	S	S	S
Emergency start circuit	S	S	S	S
Under-hood light	S	S	S	S
Automatic transmission with overdrive	S	S	S	S
Layer of neoprene vibration dampener	S	S	S	S
Challenger Cockpit	327	348	353	372
Molded ABS dash	S	S	S	S
Electronically controlled dash air conditioning	S	S	S	S
AM/FM/CD player (single disc, in-dash)	S	S	S	S
Cruise control	S	S	S	S
Tilt steering wheel	S	S	S	S
Map lights (single pancake)	S	S	S	S
Dash fans	S	S	S	S
Driver's door with slider window	0	0	0	0
Tinted wraparound windshield	S	S	S	S
Windshield privacy shade	S	S	S	S
Side-mounted power mirrors	S	S	S	S
Front-mounted power mirrors with heat	0	0	0	0
Reclining swivel captain's chairs	S	S	S	S
Ultra-leather, reclining swivel captain's chairs	0	0	0	0
3-point, wall-mounted seat belts	S	S	S	S
Sun visors	S	S	S	S
Backup monitor system with audio	S	S	S	S
Drink holders	S	S	S	S

Challenger Entry	327	348	353	372
Electric exterior entrance step	S	S	S	S
Battery access in stairwell	S	S	S	S
Challenger Exterior	327	348	353	372
Partial paint package	0	0	0	0
Fog lights	S	S	S	S
Wide-body design	S	S	S	S
Radius-cornered domed TPO roof	S	S	S	S
Rear ladder	S	S	S	S
Aerodynamic front and rear fiberglass caps	S	S	S	S
Side-mounted patio awning	S	S	S	S
Side-mounted awning over slideout	S	S	S	S
White smooth fiberglass exterior with deluxe graphics	S	S	S	S
Upgraded gelcoated sidewall	0	0	0	0
Locking exterior storage doors	S	S	S	S
White-trimmed, radius-topped entrance door with deadbolt lock and black-trimmed, clear window with shade and valance	S	S	S	S
Black-framed, radius-corner slider windows	S	S	S	S
Black-framed, dual-pane windows	0	0	0	0
Patio light	S	S	S	S
Easy-to-clean, lighted, rotocast storage compartments	S	S	S	S
Full basement pass-through storage	S	S	S	S
Gas spring-supported storage doors	S	S	S	S
Challenger Kitchen	327	348	353	372
Refrigerator: flush-mounted, double-door	S	S	S	S
Refrigerator: large flush-mounted, double-door	0	0	0	0
Refrigerator: raised-panel, hardwood front (oak or maple)	S	S	S	S
3-burner range and oven	S	S	S	S
Folding range cover	S	S	S	S
Microwave oven	S	S	S	S
Lighted power range hood	S	S	S	S
Monitor panel with LPG readout	S	S	S	S
Sink cover	S	S	S	S
Pantry	S	S	S	S
Solid-wood, raised-panel cabinet doors throughout (upper and lower)	S	S	S	S
Vinyl tile flooring	S	S	S	S
Booth dinette	S	S	S	S
Mini blinds	S	S	S	S
Wallpaper border	S	S	S	S
Fantastic® power vent	0	0	0	0

Challenger Living Area	327	348	353	372
Barrel chair(s)	S	S	N/A	S
Euro recliner with leather seating surface and ottoman	0	0	N/A	0
Sofa bed (passenger side)	N/A	N/A	S	N/A
Hide-a-bed	S	S	S	S
Lambrequin window treatments	S	S	S	S
Day/night shades (except kitchen)	S	S	S	S
100% nylon carpeting with stain treatment and padding	S	S	S	S
25-inch color TV in cockpit overhead with full-function remote, antenna booster and jack	S	S	S	S
Video package (VCR/DVD player and control center)	0	0	0	0
Decorator mirror	S	S	S	S
Soft-touch padded vinyl ceiling	S	S	S	S
Challenger Utilities	327	348	353	372
Air conditioner: 13,500-BTU ducted central (front)	S	S	S	S
Air conditioner: 15,000-BTU ducted central upgrade (front)	0	0	0	0
Air conditioner: 13,500-BTU ducted central (rear)	S	S	S	S
Remote thermostatically controlled air conditioning	S	S	S	S
Furnace: 35,000-BTU electronic ignition, floor-ducted	S	S	S	S

Water heater: 6-gallon gas with electronic ignition	S	S	S	S
Water heater bypass kit	S	S	S	S
Pre-wired for generator with auto changeover	S	S	S	S
Generator: 5.5 kW Onan® Marquis Gold™	0	0	0	0
Converter: 60-amp	S	S	S	S
Dual 6-volt auxiliary batteries	S	S	S	S
Battery disconnect	S	S	S	S
50-amp, 120-volt service	S	S	S	S
Exterior GFCI receptacle	S	S	S	S
Enclosed heated potable and holding tanks	S	S	S	S
Telephone hookup	S	S	S	S
Cable TV/satellite hookup	S	S	S	S
Pre-wired for roof-mounted satellite dish	S	S	S	S
Exterior shower	0	0	0	0
Carbon monoxide detector, LP gas and smoke detectors	S	S	S	S

Floor plans and specifications are subject to change without notice.

Challenger Weights and Measures	327	348	353	372
Chassis	Workhorse/Ford	Workhorse/Ford	Workhorse/Ford	Workhorse/Ford
Wheelbase	208	228	228	242
Overall length	33' 9"	36' 6"	36' 6"	37' 11"
Overall width	101"	101"	101"	101"
Overall height with AC	12' 0"	12' 0"	12' 0"	12' 0"
Std. weight (appx. lbs.)	16,894/16,199	17,422/16,805	17,357/16,839	N/A/17,133
GVWR	20.7K/20.5K	20.7K/22K	20.7K/22K	22K/22K
GCWR	26K/26K	26K/26K	26K/26K	26K/26K
Fresh water (appx. gal.)	75	75	75	75
Grey / black water (appx. gal.)	50	50	50	50
LP (lbs.)	103.5	103.5	103.5	103.5
Sleeping capacity	4	4	5	4
Exterior storage capacity (cu. ft.)	152	167	160	172
Interior drawers	17	23	21	18
Interior storage capacity (cu. ft.)	8	15	12	11
Fuel capacity (appx. gal.)	75	75	75	75



P.O. Box 2888 • Elkhart, IN 46515  
 Customer Service: 800-860-3812  
 Sales Department: 800-860-5658  
[www.DamonRV.com](http://www.DamonRV.com)

