

# ROYALS

I N T E R N A T I O N A L





## ROYALS INTERNATIONAL | 2006

If you have never seen a Royals International in person it might be hard to believe that so much elegance and luxury can be built into an RV. Nothing has been overlooked. Every detail and feature have been carefully planned to create a perfect living environment for seasonal or full-time living. Royals International RVs are built with premium materials and only the very best in home furnishings. We put the same care and thought into building our units as we would our own homes. No corners are cut. No shortcuts are taken – only outstanding quality.



## WHY CARRIAGE

We stress the importance of **quality** in manufacturing. With superior **quality** come reliability, durability, and most importantly, customer satisfaction. **Quality** that has withstood the test of time. We are a progressive thinking company mindful of the future. We continually explore new directions in search of the best equipment and designs. We devote much of our attention to the engineering of our units to maximize the full potential of every component. It's more than our stunning interiors that set us apart from other manufacturers. The **quality** of what we use to achieve that look on the inside is just as important as what we use on the outside and underneath, even where you might not first glance. Looking below the surface of each unit is where you will begin to understand what makes a Carriage so unique. We insist on meticulous installation of all the components on every coach. Adding the exquisite interior fabrics and custom made cabinetry and furniture to the top **quality** foundation we create for every unit makes for an incomparably finished unit, unequalled and unavailable anywhere else in the industry.



Cypress



Juniper Berry



Sandalwood



Timeless Design Cobblestone | Carpet for all



Corian Tops



# ROYALS

I N T E R N A T I O N A L

## 2006 ROYALS FIFTH WHEEL FLOORPLANS

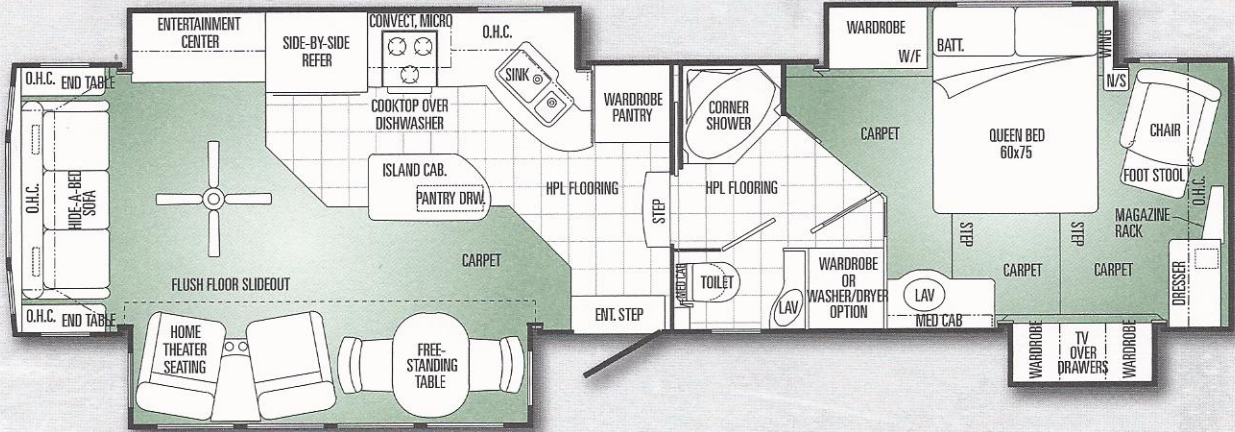

37' MAJESTIC

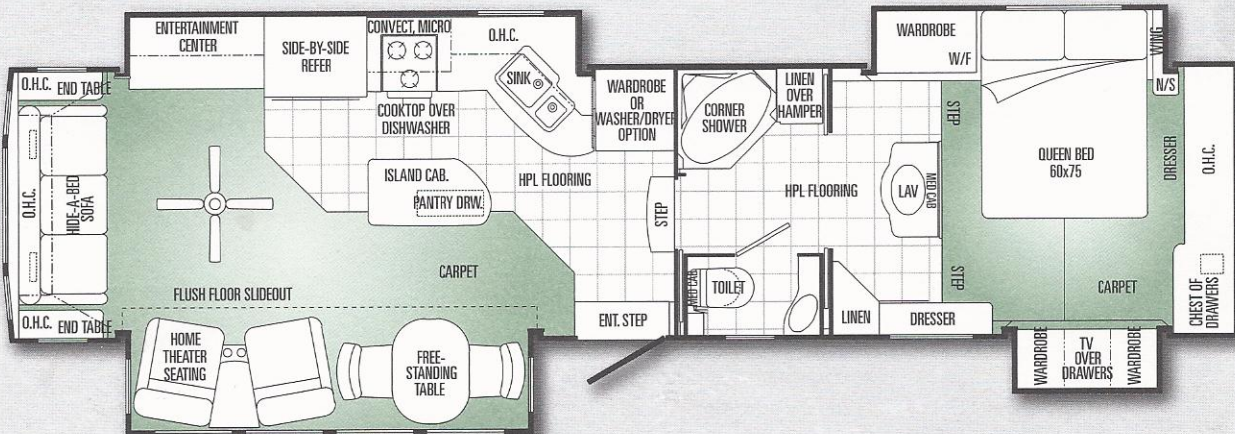

37' EMPEROR

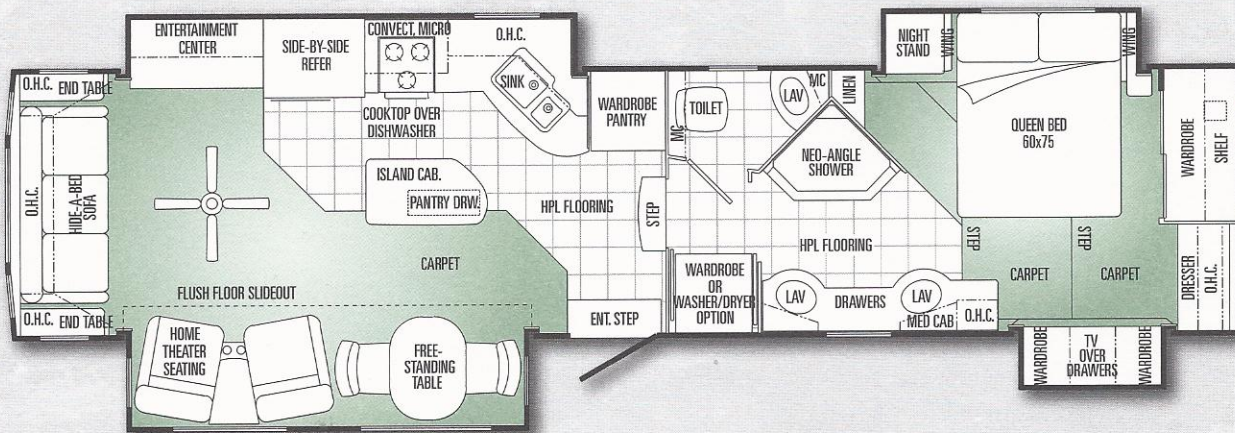

38' MONARCH

# ROYALS

I N T E R N A T I O N A L

## 2006 ROYALS FIFTH WHEEL SPECIFICATIONS

### INTERIOR

#### STANDARD FEATURES

- Residential carpet w/pad throughout
- Armstrong® HPL tile @ kitchen & bathroom
- Roman tufted shades
- Decorator wall border in stool room
- Wood grab handles
- Designer window treatments throughout.
- Metal center drawer guides w/bearings
- Dovetailed drawer boxes
- Maple raised panel doors & solid drawers
- Radius hardwood cabinets hand stained
- Solid hardwood trim & interior door frames.
- Deluxe hidden hinge cabinet doors.
- Brushed Nickel handles on all cabinet doors/drawers
- Hand laid leaded glass in accent cabinets.
- Decorator kit
- Deluxe 12V recessed fluorescent ceiling lights
- Accent lighting behind select window treatments in main living area
- Backlit 12V light switches
- Deluxe xenogen lighting in kitchen, living room and bedroom
- Accent lighting behind all glass cabinet doors
- Deluxe bevel edge mirror(s)
- Solid wood pocket doors
- Cedar lined wardrobes

#### OPTIONS

- Slide-out Arizona Room

### SYSTEMS

#### STANDARD FEATURES

- Back lit switches
- Slide battery tray
- Interior step lights
- 12V lights in exterior storage compartments
- 12V entrance step light

- 12V light @ hitch
- 12V Dimmer @ Dinette
- Washer/dryer prep
- Winegard® TV antenna
- TV Jacks in Living room & Bedroom
- Phone jacks - 3 std
- Battery shut off switch
- Deka AGM batteries 3
- Heavy duty 75 amp solid state converter
- Dual 40# LP gas bottles w/slide tray
- 12V gas detector
- Smoke detector
- Black & Gray holding tank flush kit
- Monitor panel
- Drain Master sewer hose & carrier (built-in)
- Water heater by-pass system
- Water system (demand large capacity)
- Water system hook-up (direct city)
- Water management system
- Chrome water hook-ups
- Enclosed low point drains
- Holding tank evacuation system
- Electric dump valves: heated & enclosed
- Furnace Suburban™ (pilotless)42,000 BTU
- 12 gal gas/electric water heater w/DSI
- 12V master shut-off switch for all slide-outs
- 12V re-setable breakers
- 50 amp service
- 50 amp marine power cord
- Solar panel prep
- 15,000 BTU ducted air conditioner with heat pump - Carrier™ - 2
- Central vacuum system
- Gen Prep w/auto change over
- CO detector

#### OPTIONS

- Generator Onan 5,500 watt LP Marquis Gold
- 2000 Watt Xantrex Inverter System
- Washer/dryer: Sense Clean "DD" Combo
- Washer/dryer: Kenmore 2 pc (N/A 37'Emperor)

### CONSTRUCTION/SAFETY & RUNNING GEAR

#### STANDARD FEATURES

- 100" wide body width
- Fiberglass insulation glued in place
- Enclosed underbelly w/R14 fiberglass insulation, plus R7
- fiberglass insulation in main floor & roof
- Astro Foil™ in roof, end walls, sidewalls & S.O sub floor
- All-climate insulated (engineered for full-time use)
- Full 2" sidewall w/box tube aluminum welded both sides
- Fully decked roof (1/2" exterior grade plywood)
- 5/8" tongue & groove plywood floor
- Aluminum main floor frame
- Eight-lug aluminum wheels w/radial tires
- 215/75R17.5 H-range Tires
- Spare tire crank down
- Power rear stabilizing jacks
- Snap pins @ front jack legs
- Front electric power jacks (independent motors & switches)
- Heavy duty 12V rack & gear slide-out systems
- Fully insulated slide-out floors 2-1/4" thick
- Painted frame w/stacked 2"x 12" 11 gauge steel mains
- Fully enclosed frame w/heated tanks
- Owens Corning™ insulation floors, walls & roof
- Drop frame construction
- MOR/ryde® suspension IS (Independent Suspension) w/disc brakes
- MOR/ryde® pin box
- Dual insulated floor design double vapor varrier

#### OPTIONS

N/A

## **EXTERIOR**

### **STANDARD FEATURES**

- Dual pane Frameless windows w/GL20 tinted glass
- Escape window (bedroom)
- Breakaway switch
- Dead bolt door lock
- Custom molded one piece front & rear fiberglass caps
- Molded fiberglass cap under gooseneck
- Gelcoat fiberglass exterior sidewalls
- Custom molded fiberglass fender skirts
- Automotive style bumper
- Custom exterior full body automotive paint w/double clearcoat finish
- Custom raised decal package
- Gelcoat fiberglass rocker panels (dent resistant)
- Flush mount baggage doors 1" thick insulated w/struts
- Felt lined exterior compartments
- Mid ship turn signals
- Patio light - 12V
- 110V exterior recept (GFI)
- Rear Ladder
- 32" radius entrance door
- Basement storage w/2 - 4 access doors w/12V lights
- Fully enclosed poly flex underbelly
- Large 32 cubic foot front compartment for generator or added storage
- Courtesy light @ sewer hook-up
- Scare lights (2)
- Fiber-optic lighted hand rail
- Carefree window awnings
- Awning rail w/gutter & down spouts
- Rear bay window awning
- LP tray - slide out
- Slider bin in storage compartment under bath area
- Entertainment system w/Sony Wega 20" TV, AM/FM/CD stereo
- Exterior shower
- Carefree Apex XL power box awning w/remote & auto retract

### **OPTIONS**

- Electric step
- Accessory Receiver w/Bike Rack

## **ENTERTAINMENT**

### **STANDARD FEATURES**

- Cable TV hookup
- Satellite (automatic dish & receiver)
- Television 32" LCD Sony Wega
- Winegard Video Control center
- Bose Lifestyle System

### **OPTIONS**

- N/A

## **KITCHEN**

### **STANDARD FEATURES**

- Maxx Air 12v vent w/thermostat
- Corian counter tops - kitchen & bath with recessed range and cover
- Sink covers (2)
- Kohler stainless steel sink
- Kohler Lift-off faucet
- Fisher/Paykel dish drawer
- Amana 3 burner cook top
- Refrigerator: Norcold side-by-side with icemaker & water in door
- Solid maple table with 2 chairs
- Sharp convection Microwave (over range)
- Kohler water purifier w/separate faucet
- Door activated cabinet lights above & below kitchen sink
- Built-in silverware drawer
- Kitchen island w/chrome pull-out pantry

### **OPTIONS**

- Appliance package - Black or Stainless Steel (Microwave, refer, range and dish drawer)

## **LIVING ROOM**

### **STANDARD FEATURES**

- End tables
- Flexsteel leather Hide-A-Bed sofa w/pillows
- Flexsteel home theatre seating group - leather
- Ceiling Fan
- Slide-Out Keyboard Tray @ desk

### **OPTIONS**

- N/A

## **BATHROOM**

### **STANDARD FEATURES**

- Neo - angle shower
- Decorator brushed nickel shower enclosure
- Corian lavatory top w/stainless steel bowl
- Kohler towel rings
- Kohler towel bars
- Lav in stool room
- Brushed nickel light bar - medicine cabinet
- Oversized medicine cabinet
- Kohler brushed nickel lavatory faucet w/pop-up drain
- Deluxe Kohler brushed nickel shower fixtures w/adjustable slide bar
- Thetford "Avia" china toilet w/electric push button flush
- Maxx Air 12V Vent in stool room/bath hall
- Shower bubble w/shade (16 x 24)
- Armstrong® HPL Flooring
- Heat & A/C in stool room
- Carpet runner @ shower

### **OPTIONS**

- N/A

## **BEDROOM**

### **STANDARD FEATURES**

- Select Comfort Sleep # mattress
- Deluxe fitted bedspread w/pleated skirt & pillows
- Bed sheet set
- Deluxe brushed nickel mirrored sliding wardrobe doors
- Built in night stands each side of bed
- Xelogen spot lights @ head of bed
- Television 13" Sony Wega
- Accent prism lights 2 each side of bed
- Solid wood privacy door in bedroom
- Bedroom slide-out
- Wood facer on slide-out
- Cedar lined wardrobes
- Floor safe

### **OPTIONS**

- Work Station IPO Chair (37' Majestic Only)

# ROYALS

I N T E R N A T I O N A L

## 2006 ROYALS FIFTH WHEEL SPECIFICATIONS

ROYALS INTERNATIONAL	MAJESTIC	EMPEROR	MONARCH
Approx. Exterior length	37'11"	37'11"	38' 5"
Approx. Exterior width	100"	100"	100"
Approx. Exterior Height w/AC1	12' 11"	12' 11"	12' 11"
Approx. Dry Axle Weight*			13,785
Approx. Hitch Weight*			3,230
Approx. Total Dry Weight*			17,015
Approx. Average Load Capacity			2,215
Axles ( number of )	2	2	2
Fresh Water Capacity w/ water heater **	82 Gal.	82 Gal.	82 Gal.
Black/Gray Holding Tank Capacity	38/72 Gal.	38/72 Gal.	38/72 Gal.

\* Above listed weights are actual units that include all slide out rooms and all popular options ordered on most coaches. These weights are provided as a guideline only. The actual weight of each individual unit (all units are weighed as they come off the production line) is posted inside each vehicle.

\*\* Fresh water capacity includes the combined capacity of the fresh water tanks and the water heater



# ROYALS

I N T E R N A T I O N A L

[www.carriageinc.com](http://www.carriageinc.com)

Post Office Box 246 • Millersburg, Indiana 46543 • (574) 642-3622

© 2006 Carriage, Inc Printed in U.S.A.



Visit our Website.

Due to continual improvement of Carriage Inc. products, we reserve the right to change material, colors, specifications and prices at any time without prior notification. Selected decorator items used in the photos are not part of the product. Carriage, Inc. assumes no responsibility for any error in type or print reproduction of specifications or color in this brochure.

## SPACIOUS KITCHENS | 2006

New coach designs make RV living even more natural and comfortable. Efficiently designed with more work space and storage than ever, Carriage interiors create a warm and inviting place for sharing time with family or friends. Full size sinks, solid surface counter tops, beautiful solid maple cabinets and slide-outs nearly double the space to provide a home-like quality and convenience.



*Our sinks, in the kitchen and baths, feature gorgeous, high-quality, residential-style Kohler faucets catering to your fine tastes. Solid surface counter tops complete the look of luxury.*



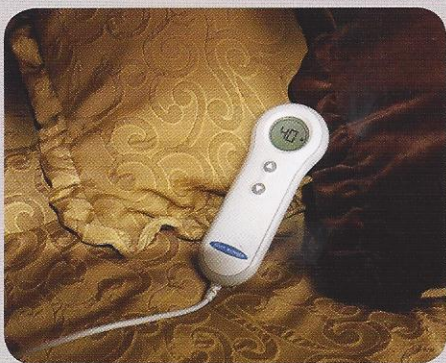

## BEAUTIFUL BEDROOMS | 2006

Royals International RVs are ideal for extended stays or full-time living. Our bedroom and baths are as luxurious as any fine hotel. Tile floors, cedar-lined wardrobes, beautiful solid wood cabinets and trim are everywhere. And now, our bedrooms come standard with **Select Comfort Sleep Number mattresses** to give you your best night's sleep ever. How could this be any more your home?

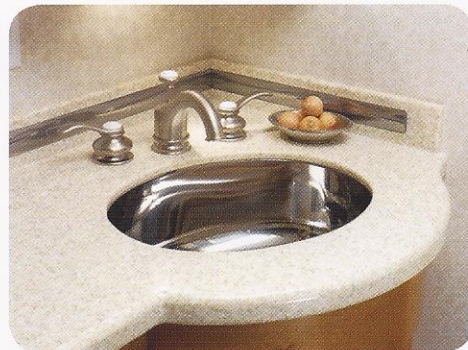

## QUALITY CRAFTSMANSHIP

After building RVs for over 37 years, we have gained our customers' respect through hard work and unwavering support. We have earned a reputation as the industry innovator, leading the way in style and design. We have always been dedicated to using the finest **quality** materials to create an RV that delivers you to what we refer to as **the best fifth wheel in the industry**. Our units are built for those with discriminating taste who can appreciate the Carriage difference. **Quality** craftsmanship and the underlying sense of family pride that is built into each unit. We have a history in this business. We have been committed to excellence for over 37 years and will be there for you in the future.



Royals International offers numerous amenities we know you'll appreciate. Units come standard with a 32" LCD Sony Wega TV, Bose Lifestyle System, Flexsteel leather Hide-A-Bed sofa with pillows, Flexsteel home theatre seating group in quality leather, along with beautiful accent lighting and an exterior entertainment system featuring a Sony Wega 20" TV, AM/FM/CD stereo. In addition, all of our cabinets are made of fine hardwood in your choice of maple or honey maple finishes.



Carriage is quality because we build with quality components. We use recognized name-brand manufacturers for the items we don't build at our factory, like Armstrong® flooring and Norcold® refrigerators. We could build with less expensive parts, and some manufacturers do. We know you'll appreciate the high standards we live up to with every Carriage.

# ROYALS

I N T E R N A T I O N A L

Carriage Inc. manufactures Royals International, Carriage, Carri-Lite, Cameo LXI and Compass lines of fifth wheels and travel trailers. Founded in 1968, our company stresses job pride and skilled craftsmanship to ensure that Carriage products continue to meet the highest standards of excellence. From the beginning, the Carriage philosophy has always been "to build a quality unit, not quantity mass-produced units" and our continued commitment to that ideal has resulted in a 37 year tradition of providing beauty, durability, value, and service to our customers.



**Best  
Warranty  
in the  
Business**



We can offer the best warranty in the business because we believe in the **quality** of our products.



## INDUSTRY AWARDS

Carriage Inc. received its industry leading sixth (6) Quality Circle Award in December 2004 for fifth wheels. Dealer Satisfaction in areas such as sales, product management, and service/warranty support. It is in these products, that are designed and built by our outstanding groups of employees, that makes this award possible.

We are most proud of this recognition, because it is voted on by our dealer body, not industry peers.

Post Office Box 246  
Millersburg, Indiana 46543

**(574) 642-3622**  
**www.carriageinc.com**

Due to continual improvement of Carriage Inc. products, we reserve the right to change material, colors, specifications and prices at any time without prior notification. Selected decorator items used in the photos are not part of the product. Carriage, Inc. assumes no responsibility for any error in type or print reproduction of specifications or color in this brochure.

