

Travel the Back Roads with Palomino



Truck Campers
Winter Creek





Winter Creek Standards & Options

Model 11 FWSL

Standards: 12 Volt Power Vent in Bath • 19" LCD Flat Screen TV W/Digital Surround Sound • 20,000 BTU Furnace with Auto Ignition • 6 Gal. Gas/Elec.DSI Water Heater • Amplified TV Antenna • Armstrong Vinyl Floor Covering • Backup and Tail Lights • Bed Spread • Carbon Monoxide and LP Gas Detectors • Detachable 30 Ft. Power Cord - 30 AMP • Dometic 6 Cu. Ft. Refrigerator • Dually Brackets • Egress Vent/Cab Over • Electric Jacks-Happi Jac W/Remote • Entry Assist Handle • EPDM

Rubber Roof • Fire Extinguisher • Front Sliding Cab Window • Ladder • Laminated Smooth Fiberglass Exterior • Lower Door Window • Outside Shower • Pillow Top Mattress • Power Range Hood with Light and Fan • Raised Refrigerator Panel • Smoke Detector • Stainless Steel Package • Steel Floor Supports • System Monitor Panel • Three-Burner Range with Oven & Range Cover • Toilet and Shower • TV Cable Ready • Vented Battery Box • White Radius Dual Pane Safety Glass Windows

Options: 2500 Watt Onan® LP Generator • 11,000 BTU Air Conditioner (Ducted) • Create-A-Breeze Fan • Happi Jac Tie Downs • Microwave Oven • Rear Awning • Side Awning (N/A 115RS) • Slide Topper Awning

Palomino's Winter Creek Truck Campers let you experience the beauty of the rugged back roads without sacrificing comfort and convenience. With slide-outs that enhance interior space, these units are fully furnished with all the necessities and lots of extras to make your leisure time an enjoyable adventure.

Description	815 RS	915 RS	11 FWSL	115 RS
Total Exterior Length	18'	18'	20'	20'
Total Exterior Width	96"	96"	96"	96"
Floor Length	9'8"	9'8"	11'8"	11'8"
Wheel Well Width	48"	48"	48"	48"
Exterior Height with Ladder	9'	9'	9'	9'
Interior Height	6'7"	6'7"	6'7"	6'7"
Dry Weight (lbs.)	3549 lbs.	3627 lbs.	3762 lbs.	3834 lbs.
Center of Gravity (from front of truck bed)	45"	45"	54"	55"
Fresh Water Capacity (Gals)	40 Gal.	40 Gal.	40 Gal.	40 Gal.
Black Water Capacity (Gals)	27 Gal.	27 Gal.	27 Gal.	27 Gal.
Gray Water Capacity (Gals)	27 Gal.	27 Gal.	27 Gal.	27 Gal.
LP Gas Capacity	Two - 20 lbs.	Two - 20 lbs.	Two - 20 lbs.	Two - 20 lbs.
Cab Over Bed Size	60" X 80"	60" X 80"	60" X 80"	60" X 80"
Dinette Bed Size	40" X 62"	40" X 62"	40" X 62"	40" X 62"
Converter with Charger (AMP)	45	45	45	45



Model 11 FWSL

Model 915 RS

Model 915 RS

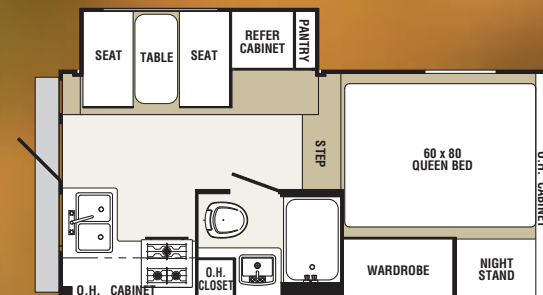

815 RS

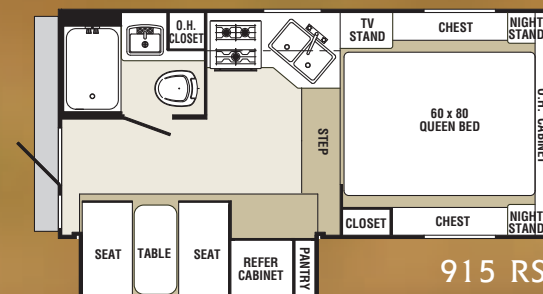

915 RS

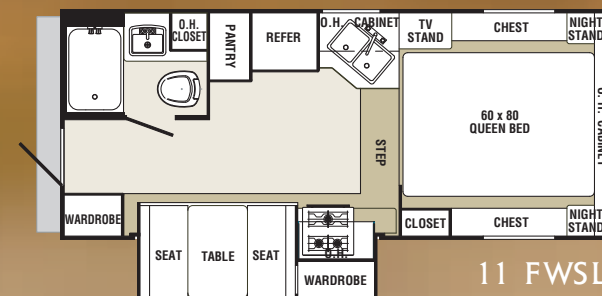

11 FWSL



115 RS



Model 11 FWSL



20,000 BTU furnace takes the chill off cold nights



Optional 11,000 BTU air conditioner will keep you cool on hot days



Happi Jac camper anchor and turnbuckle



Pass-thru storage conveniently accessible from inside or outside



Optional Onan® 2500 Watt LP Generator



The standard outside shower keeps any mess outside



Optional 10 bladed, 3 speed Create-A-Breeze™ Fantastic Vent keeps fresh air circulating



Front rubber bumpers protect the front of the truck bed.



AM/FM CD/DVD Player with 5.1 Dolby Digital Surround Sound



Battery storage

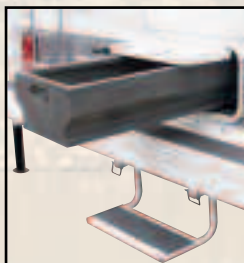

Slide-out storage



Electric jack

Free Emergency Roadside Assistance Service
Administered by Coach-Net®.
Ask your dealer for more information.

Built for the Back Roads

Palomino truck campers are built for the road with top grade building materials and proven construction techniques along with an attractive smooth fiberglass exterior.

Palomino RV can not know the GVWR or features of your truck nor the purpose you have in mind for the use of your Truck Camper. Therefore, Palomino RV makes no warranties or representation, expressed or implied, as to the performance or reliability of your truck with a Palomino Truck Camper.

All illustrations and specifications contained in this literature are based on the latest product information at time of publication. Palomino RV reserves the right to make changes in prices, colors, materials, equipment and specifications and to discontinue models at anytime without notice or obligation and assumes no responsibility for any error in this literature.

DEALER



Palomino RV
1047 East M-86
Colon, MI 49040
Phone: (269) 432-3271
Fax: (269) 432-2516
www.palominorv.com