



**STARCRRAFT**

2009 Rock Star Toyhaulers

Wide-Body Lite

Ultra-Lite





FB2900 Cocoa with Sierra Maple Décor

## Create Your Story!

Your action-packed story begins with Rock Star, the bold new toyhauler line built for your non-stop lifestyle. This lightweight travel trailer is designed to last long and look amazing with a steel powder-coated frame, all-weather rubber roofing, and *smoother Filon*® finish. The FBSO3000 includes a slide-out sofa with an inflatable hide-a-bed air mattress and queen loft bunk, while the FB2900 features electric track-mounted bunks that lift out of your way. The easy-assist ramp door with adjustable spring tension operates with ease for loading and unloading surfboards, dirt bikes, or whatever drives your spirit. With the large water tank and optional generator and fuel station, Rock Star becomes completely self-contained, and can take you and your crew anywhere that accelerates your life.



FB2900 Sofa as Bed



FB2900 Sofa Folded Flat



FB2900

The multi-functional sofa folds out for an extra bed and folds flat against the wall for more space.



**FB2900 Cocoa with Sierra Maple Décor**



**FB2900**

Cooking for the crew? No problem with this compact but complete kitchen.



**FB2900**

The bathroom features a shower for cleaning up after a day out on the trails.



**FB2900 Cocoa with Sierra Maple Décor**



**FB2900**

The high tech media center offers several entertainment options for the whole family.



Spacious overhead cupboards create plenty of storage opportunities.

The bedroom with roomy queen-size bed provides a cozy hideaway.



**FB2900 Bedroom**

# Ultra-Lites

# Wide-Body Lites

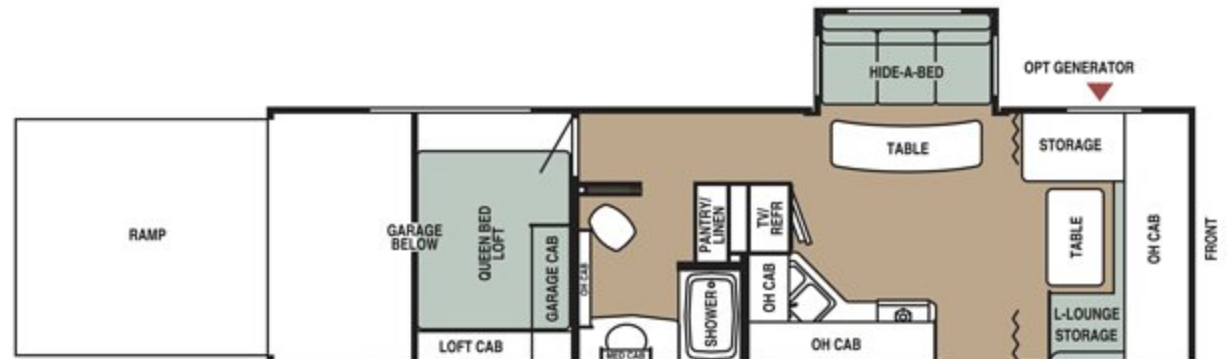
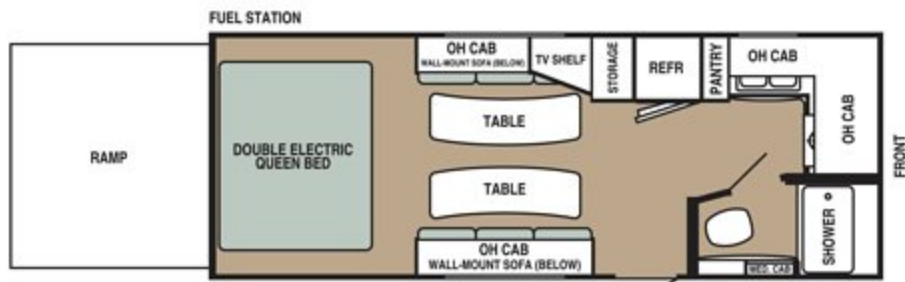
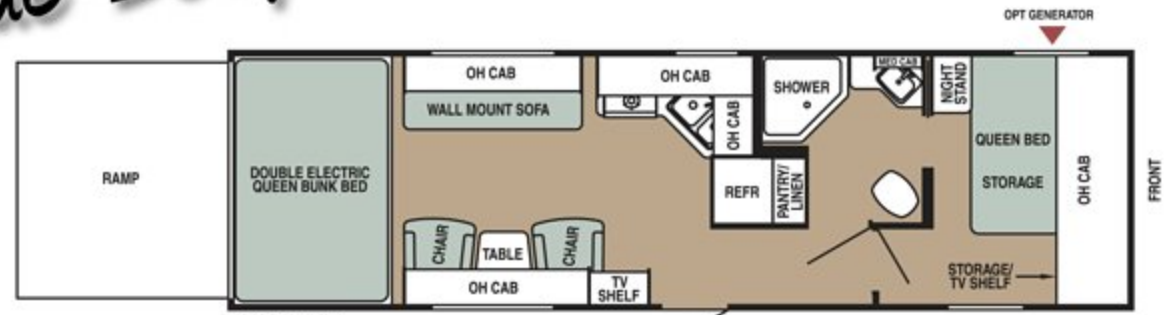
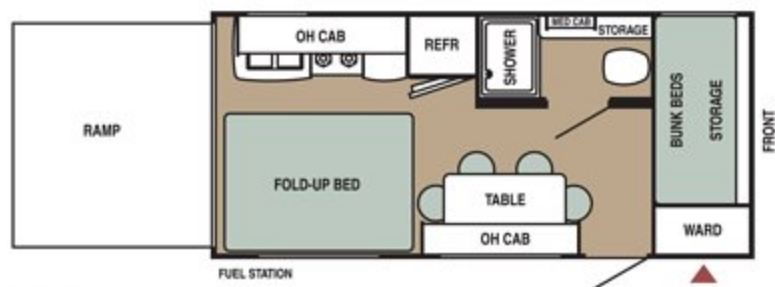

**LEGEND:** ■ COMFORT AREAS ■ VINYL ▲ STORAGE

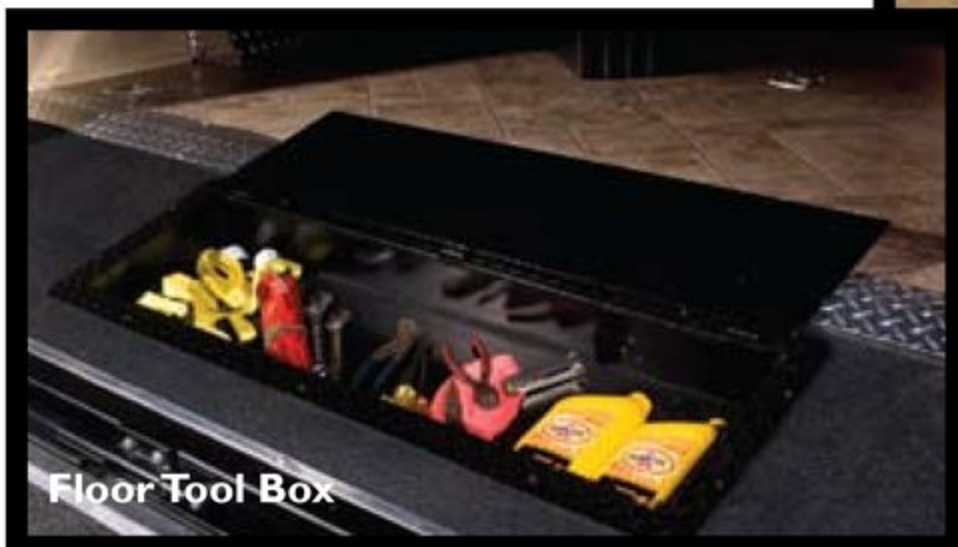

FB2900 Ramp & Screen Room

## Specifications — WEIGHTS, MEASUREMENTS & CAPACITIES

	ULTRA-LITE		WIDE-BODY LITE	
	19FB	21MPH	FB2900	FBSO3000
GVWR (gross vehicle weight rating - lbs.)	7100	7100	11000	12000
UVW (unloaded vehicle weight - approx. lbs.)	4313		7291	8689
HW (hitch weight - approx. lbs.)	426		1370	2125
CCC (cargo carrying capacity - approx. lbs.)	2213		2651	2253
Overall Length - Center of Ball to Bumper	22' 0"	26' 6"	33' 1"	33' 8"
Body Width	8' 0"	8' 0"	8' 6"	8' 6"
Interior Height	6' 8"	6' 8"		
Overall Exterior Height (add 8" for opt. A/C)	9' 4"	9' 4"	11' 4"	12' 4"
Radial Tire Size	ST205/75R 14C	ST205/75R 14C	ST235/80R 16E	ST235/80R 16E
Ducted Furnace w/Electronic Ignition (Floor Ducted on Wide-Body Lites)	19M BTU	19M BTU	30M BTU	30M BTU
6-Gallon LP Water Heater w/Bypass	X	X	X	X
Freshwater System w/12-Volt Quiet Pump - Includes Water Heater (approx.)	64 gal. under floor	64 gal. under floor	122 gal.	122 gal.
Gray/Black Holding Tanks (approx.)	35/26 gal.	30/30 gal.	54/54 gal.	45/54 gal.
Double 20# LP Tanks w/Auto Regulator & Tank Cover	X	X	X	X
45-AMP Power Center w/Battery Charger	X	X	X	X
Straight Axles w/All-Wheel Electric Brakes (Super Lube Straight Axles on Wide-Body Lites)	2	2	2	2
2 5/16" Ball Coupler	X	X	X	X
Sleeping Capacity	4	8	6	6

### GVWR — Gross Vehicle Weight Rating

The maximum permissible weight of the trailer when fully loaded with all systems filled. It includes all weight at the trailer axle(s) plus hitch.

### UVW — Unloaded Vehicle Weight

Sometimes referred to as the Gross Vehicle Weight or Curb Weight, the UVW is the dry weight of the trailer as manufactured at the factory. It includes all weight at the trailer axle(s) plus hitch.

### HW — Hitch Weight

Hitch Weight represents the portion of the trailer weight that is carried by the tongue to the hitch ball on the tow vehicle.

### CCC — Cargo Carrying Capacity

Sometimes referred to as Rated Cargo Load, the CCC is equal to the GVWR minus each of the following: UVW, full fresh water weight (including water heater) plus filled propane tank(s) and battery weight.

## Options

### Ultra-Lite:

Lichen Green w/Sierra Maple Décor  
 Cocoa w/Sierra Maple Décor  
 Camper's Comfort Package: 13.5M-BTU Duo-Therm™ Air Conditioner, A&E Systems Electric Awning, Dometic® Microwave, Monitor Panel, Pleated Night Shades, Spare Tire & Carrier, Skylight over Shower in Bath, TV Antenna, iPod®/MP3 Adapter, Jensen® AM/FM/CD Stereo w/Outside Speakers  
 Comfort Plus Package: Gas/Electric DSI Water Heater (6-gal.), Sink Cover (single), Spray-Port™ Exterior Sprayer  
 Equa-Flex™ Flexible Equalizers  
 12-Volt Fantastic Roof Vent  
 Sierra Maple Cathedral Refrigerator Panels  
 Aluminum Wheels (4 Wheels)  
 Tinted Safety Glass Windows  
 Jensen® 19" LCD TV (110/12-Volt)  
 Fuel Station w/18-Gallon Gasoline Tank

### Wide-Body Lite:

Lichen Green w/Sierra Maple Décor  
 Cocoa w/Sierra Maple Décor  
 Camper's Comfort Package: Ducted 13.5M-BTU Duo-Therm™ Air Conditioner, A&E Systems Electric Awning, Sylvania Convection Microwave, Monitor Panel, Pleated Night Shades, Spare Tire & Carrier, Skylight over Shower in Bath, TV Antenna, SONY® Xplōd® AM/FM/CD Stereo w/iPod® Adapter/Charger & Outside Speakers  
 Comfort Plus Package: Gas/Electric DSI Water Heater (6-gal.), Sink Cover (double), Spray-Port™ Exterior Sprayer, Tinted Safety Glass Windows, Aluminum Wheels (4 wheels)  
 Equa-Flex™ Flexible Equalizers  
 Jensen® 19" LCD TV (110/12-Volt)  
 Outside Gas BBQ Grill  
 12-Volt Fantastic Roof Vent  
 SONY® Xplōd® Amplifier and Subwoofer  
 Ducted 15M-BTU Duo-Therm™ Air Conditioner in lieu of Ducted 13.5M-BTU Air Conditioner  
 Tinted Thermal-Paned Safety Glass Windows  
 Slideout Topper (FBSO3000)  
 4.0 KW Onan® Generator w/30-Gallon Gasoline Tank  
 Fuel Station w/30-Gallon Gasoline Tank  
 4.0 KW Onan® Generator and Fuel Station w/30-Gallon Gasoline Tank

## Décor

Lichen Green

Cocoa



## Warranty Information\*

- 1-Year Hitch-to-Bumper
- 12-Year Roof Covering
- 2- and/or 3-Year Appliances

\*Refer to Actual Warranty Information for Details

# Starcraftsmanship

**Quality starts with attitude.** At Starcraft, we've always referred to that attitude as *Starcraftsmanship!* It's a working philosophy that starts with research and design, and carries all the way through production to sales and service. It's our way of bringing you more in terms of customer satisfaction, value, service and warranty.



Since 1964, Starcraft has been a leader in the evolution of the recreational vehicle. Today's Starcrafts have every comfort and convenience the industry has to offer, and then some! Our secret weapon is our people – on the line, in our offices and on the road. We've watched generations of busy families get away to connect with each other, with nature, with themselves. That's the real reason people want to go RVing, and that's what this lifestyle is all about.

When you take the best ideas, designs, materials and people, and put them all together, year after year, you earn a reputation. That reputation goes on the line every time we sell another product. Add up the reasons for our success, and you have the best reason of all to buy a Starcraft ... *Starcraftsmanship.*



## Join the Starcraft Camper Club

When you purchase a new Starcraft, you'll receive a free one-year membership to the Starcraft Camper Club, a camping group of Starcraft owners. Our club offers you the friendship and security of caravan-style travel at lower group rates. Organized trips and gatherings are held throughout the year and detailed in the club's quarterly publication, *Chatter*. Participating in the Starcraft Camper Club is a great way to develop friendships with people who have the same interests and share your love of RVing.

# STARCRAFT

Be sure to visit our website at [www.starcraftrv.com](http://www.starcraftrv.com) for the latest product updates and floorplans, additional in-depth specs and information, and to locate your nearest dealer.

©2008 Starcraft RV, Inc. • P.O. Box 458 • Topeka, IN 46571 • (260) 593-2550  
Due to constant product improvements, Starcraft RV, Inc. reserves the right to make changes, including (but not limited to) equipment, accessories, colors and prices without further notice or obligation. Some equipment shown separately, or on product illustrated in this catalog, may be optional at extra cost.

15000031

9/08

FB2900 Wide-Body Lite

# Go RVing