

KEY FEATURES

- New "Fuel efficient" 19G and 23S models
- Full 82" interior ceiling height
- Ceiling ducted air conditioning system
- Models 21RB, 23A and 25C feature a tub/shower with curved curtain rod
- Optional home theater system with DVD player and radio tuner
- HD/DSS satellite prep
- Crown roof and ducted air now standard on all models
- Convenience package includes keyless entry and valve stem extenders
- Optional electric patio awning

FLOORPLANS

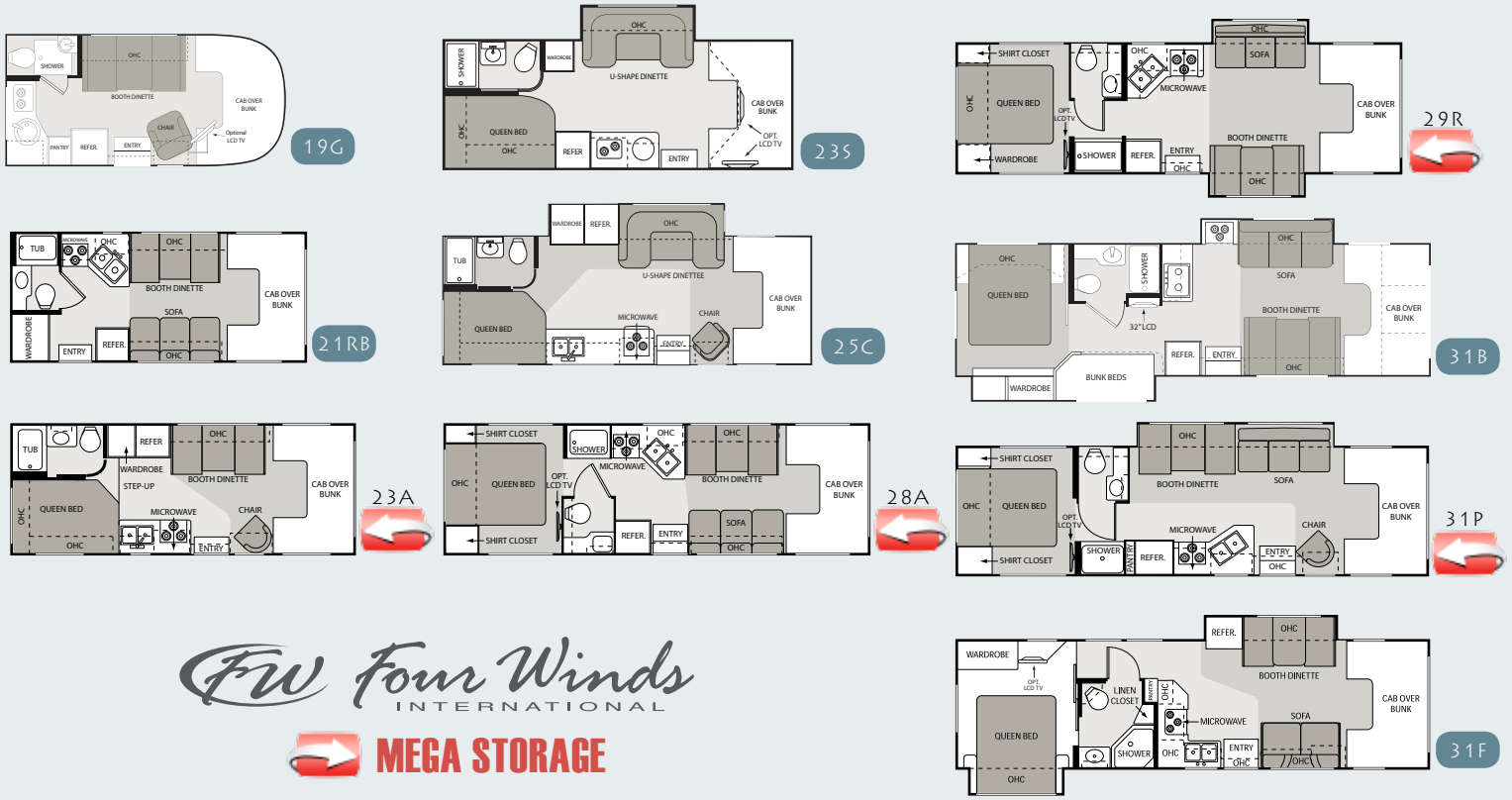

SPECIFICATIONS

Model	19G	21RB	23A	23S	25C	28A	29R	31B	31P	31F
Ford Chassis with Triton engine	5.4L/V-8	5.4L/V-8	6.8L/V-10	N/A	6.8L/V-10	6.8L/V-10	6.8L/V-10	6.8L/V-10	6.8L/V-10	6.8L/V-10
Gross Vehicle (GVWR)	9,600	11,500	12,500	N/A	14,500	12,500	14,500	14,500	14,500	14,500
Gross Combined (GCWR)	13,000	13,000	18,500	N/A	20,000	18,500	20,000	20,000	20,000	20,000
Ford Chassis-6.0L power stroke diesel (opt)	N/A	N/A	V-8	N/A	V-8	V-8	V-8	N/A	N/A	N/A
Gross Vehicle (GVWR)	N/A	N/A	14,500	N/A	14,500	14,500	14,500	N/A	N/A	N/A
Gross Combined (GCWR)	N/A	N/A	20,000	N/A	20,000	20,000	20,000	N/A	N/A	N/A
Chevy Chassis with 6.0L Vortec engine	N/A	V-8	V-8	N/A	V-8	V-8	V-8	V-8	V-8	N/A
Gross Vehicle (GVWR)	N/A	12,300	12,300	N/A	14,050	12,300	14,050	14,050	14,050	N/A
Gross Combined (GCWR)	N/A	16,000	16,000	N/A	17,600	16,000	17,600	17,600	17,600	N/A
Sprinter Chassis with 3.0L diesel engine	N/A	N/A	N/A	V-6	N/A	N/A	N/A	N/A	N/A	N/A
Gross Vehicle (GVWR)	N/A	N/A	N/A	11,030	N/A	N/A	N/A	N/A	N/A	N/A
Gross Combined (GCWR)	N/A	N/A	N/A	14,530	N/A	N/A	N/A	N/A	N/A	N/A
MEASUREMENTS										
Wheel Base (Ford/Chevy) (in Inches)	138	138/139	158/159	170"	189/190	190/191	205/206	223"/224"	219/220	223/-
Exterior Length (without ladder)	19'10"	22'8"	24'10"	24'10"	27'4"	29'9"	32'2"	32'2"	32'3"	32'2"
Exterior Height (with air conditioning)	10'3"	10'10"	10'10"	11'	10'10"	10'10"	10'10"	11'5"	10'10"	11'5"
Exterior Width (without mirrors)	91"	99"	99"	99"	99"	99"	99"	99"	99"	99"
Interior Height	80"	82"	82"	80"	82"	82"	82"	82"	82"	82"
Awning Size (manual/electric)	8'/-	12'/12'	15'6"/-	15'/15'	18'/18"	14'/14'	15'/15"	10'6"/10'6"	16'/16'	16'/16'
CAPACITIES										
Fuel - Ford/Chevy (gallons)	37/-	37/35	55/57	26.4	55/57	55/57	55/57	55/57	55/57	55/-
LPG (pounds)	40	40.9	40.9	68.2	40.9	40.9	40.9	40.9	40.9	40.9
Fresh Water (gallons)	20.5	21	40	40	40	40	40	40	40	33
Waste Water (gallons)	17	25	24.5	38	24.5	25	22	32	31	32
Gray Water (gallons)	17	22	38.5	34	38.5	22	23	36	29	36
Water Heater (gallons)	6	6	6	6	6	6	6	6	6	6
Furnace (BTUs)	16,000	25,000	25,000	25,000	30,000	30,000	30,000	30,000	30,000	30,000
Exterior Storage Capacity (cubic feet)	6.5	6	69	65	69	111	101	47	101	26

2009 FOUR WINDS STANDARD & OPTIONAL FEATURES

BODY CONSTRUCTION/EXTERIOR

Fully welded tubular steel floor system	S
Fully welded tubular aluminum roof and sidewall cage construction	S
Vacu-Bond laminated roof, walls and floors with high-density block foam insulation	S
Filon fiberglass exterior sidewalls	S
Slick fiberglass exterior	O
Exterior graphics package	S
Exterior graphics/partial paint package	O
Exterior rear Mega Storage compartment (N/A on 21RB and 31F)	S
Seamless roto-cast storage compartments	S
Flush mount radius luggage doors	S
Premium one-piece TPO roof (Energy Star approved)	S
Manual patio awning	S
Electric patio awning (N/A on 19G, 23A and 31B)	O
Slide-out room awning (N/A on 19G, 21RB, 23A, 23S and 28A)	S
Roof ladder	S
Drop-down stairwell entrance step (N/A on 21RB and 31F)	S
Manual entrance step (21RB, 31B and 31F only)	S
Automatic electric entrance step (21RB, 31B and 31F only)(Std. on 23S)	O
Outside shower	O

AUTOMOTIVE/COCKPIT

14,500 GVWR Ford 6.0L PowerStroke™ diesel engine and Onan® 3.6 LP generator (23A, 25C, 28A and 29R only)	O
3,500-lb. trailer hitch (19G and 23S only)	S
5,000-lb. trailer hitch (N/A 19G and 23S)	S
AM/FM dash radio with large buttons, CD player and weather band tuner	S
3-point seat belts for driver and passenger	S
Power window and door locks	S
Deluxe exterior mirrors (N/A on 23S)	S
Deluxe heated remote mirrors (N/A on 19G)(Std. on 23S)	O
Aluminum running boards (N/A on 31B and 31F)	S
Fiberglass running boards (23S, 31B and 31F only)	S
Spare tire	S
Aluminum wheels (19G only)	S
Wheel liners (N/A on 19G)	O

Upgrade dash insert (Ford and Chevy)	O
Infiniss™ Leather driver and passenger captain's chairs	O
Power driver seat (Ford chassis only)	O
Back-up monitor	O

INTERIOR

Residential linoleum (galley, bath and entry way)	S
Linoleum throughout the coach (19G and 23S only)	S
Metal entry grab handle	S
Windshield privacy curtain	S
9,200 BTU roof air conditioner in front (19G only)	S
13,500 BTU roof air conditioner in front (N/A on 19G)	S
15,000 BTU roof air conditioner in front (N/A on 19G and 23S)	O
Ceiling ducted air conditioning system (N/A on 19G and 23S)	S
Golden Maple cabinetry (N/A on 19G)	S
Cinnamon Maple cabinetry (Std. on 19G)	O
Cherry cabinetry	O
European styled curved cabinet doors (19G only)	S
Raised panel upper cabinet doors	S
Hardware with Brushed Nickel finish	S
Hidden hinges on cabinet doors (19G, 31B and 31F only)	S
Mini blinds throughout	S
Day/night shades throughout	O
Soft-Touch vinyl ceiling (31B and 31F only)	S
Hard vinyl ceiling (N/A on 31B and 31F)	S
Barrel chair (19G, 23A, 25C and 31P only)	S
Leatherette euro recliner with ottoman in place of barrel chair (23A, 25C and 31P)	O
Fabric jackknife sofa (N/A on 23A, 23S and 25C)	S
Infiniss™ Leather jackknife sofa (N/A on 23A, 23S and 25C)	O
Fabric hide-a-bed sofa (29R only)	O
Infiniss™ Leather hide-a-bed sofa (29R only)	O
Infiniss™ Leather hide-a-bed sofa with air mattress (31P on a Ford chassis and 29R only)	O
Fabric jackknife sofa with pedestal table in place of dinette (29R only)	O
Infiniss™ Leather jackknife sofa with pedestal table in place of dinette (29R only)	O

Booth dinette (N/A on 23S and 25C)	S
Fabric U-shaped dinette (23S and 25C only)	S
Infiniss™ Leather U-shaped dinette (23S and 25C only)	O
Fantastic® fan in kitchen area	O
Fantastic® fan in overhead bunk (N/A on 19G and 23S)	O

GALLEY

Single door refrigerator (19G only)	S
Double door refrigerator (N/A on 19G)	S
Decorative raised wood refrigerator panels	O
2-burner "European" cooktop (19G and 23S only)	S
3-burner high-output gas range top	S
Microwave oven	S
3-burner high-output gas range top with oven (N/A on 23S)	O
Convection microwave	O
Laminate countertops	S
Large single bowl sink (19G and 23S only)	S
Large double bowl sink	S
Flip-up countertop extension (23A, 31P and 31F only)	S
Full extension metal drawer guides	S

ENTERTAINMENT & ACCESSORIES

19" LCD television (19G only)	O
26" television in front overhead with electric swivel in cab-over (N/A on 19G)	O
Entertainment center with 26" LCD television and slide-out bunk (no sliding bunk on 23S)(N/A on 19G, 31B and 31F)	O
Entertainment center with 32" LCD television and slide-out bunk (31B and 31F only)	O
19" LCD television in bedroom—can be removed and mounted to exterior hook-ups (N/A on 19G, 21RB, 23A and 25C)	O
19" LCD television for the bunk beds (31B only)	O
Dual LCD monitors with DVD and gaming inputs located in the bunk bed overheads (31B only)	O
Outside entertainment center with AM/FM stereo and CD player (N/A on 19G and 21RB)	O
Outside entertainment center includes a 26" LCD television, AM/FM stereo, CD/DVD player, iPod ready jack and speakers (31P only)	O
Home theater system with DVD player and radio tuner (N/A on 23S)	O
Television antenna and booster	S

High-definition satellite dish	O
--------------------------------	---

BEDROOM/BATHROOM

Queen-size bed with innerspring mattress (N/A on 19G and 21RB)	S
Twin beds with night stand (N/A with Mega Storage; 28A only)	O
Bunk beds in hallway slide room (31B)	S
Bedspread and pillow shams (N/A on 21RB)	S
China bowl toilet (N/A on 19G)	S
Skylight in shower	S
Tub/shower with curtain and curved curtain rod (21RB, 23A and 25C only)	S
Shower with pleated shower curtain (N/A on 21RB, 23A and 25C)	S
Shower with glass door (N/A on 19G and 31F)	O
Neo-angled shower with glass door and surround (31F only)	S

SAFETY & CONVENIENCE

Entry door with deadbolt lock	S
Telephone jack	S
Smoke, LPG, carbon monoxide detector and fire extinguisher	S
Passenger seat belts in select areas	S
Child safety seat tether anchor in booth dinette (N/A in 19G and 25C)	O
Slide-out battery tray	S
Convenience Package: includes keyless entry and valve stem extenders (N/A on 19G and 23S)	O

ELECTRICAL & PLUMBING

Guardian RV Quietpac® 40G gas generator (3600-watt)(N/A 23S)	O
Onan® Microquiet™ 4.0 gas generator (4000-watt)(N/A 23S)	O
Onan® 3.6 LP generator (3600-watt) (Standard with Ford PowerStroke™ diesel engine chassis option)(23S)	O
Onan® 3.2KW diesel generator (3200-watts)(23S only)	O
30-amp service with shoreline power cord and battery disconnect switch	S
Automatic generator transfer switch	O
Emergency start switch (N/A on 23S)	S
Second auxiliary house battery (N/A on 19G)	O
6-gallon DSI gas water heater	S
6-gallon DSI gas/electric water heater	O
Water heater bypass system	S
Heated and enclosed holding tanks (31B and 31F only)	S
Holding tanks with heat pads (not available on 31B and 31F)	O



VEHICLE LOADING: Every effort has been made to provide the greatest number of options for the recreation vehicle owner. Along with these choices comes the responsibility to manage the loads that are imposed by the choices so that they remain within the manufacturer's specified chassis weight limits. Do not overload the recreation vehicle.

IMPORTANT: Towing capacity may vary by chassis model, floorplan, options and loading of the vehicle. This may result in a towing capacity which is less than the maximum capacity of the hitch. Do not exceed the vehicle's Gross

Combined Weight Rating (GCWR), or the hitch rating. A separate functioning brake system is required for any towed vehicle or trailer weighing more than 1,000 lbs. (450 KG) when fully loaded. Liquid capacities and weights are approximations only.

WARNING: This information is intended as a guide only. Weights of individual vehicles may vary. Consult your owner's manual and weight sticker affixed to each vehicle for complete loading, weighing, and towing instructions. Actual filled LP capacity is 80% of listing due to safety shut-off required on tank.

WARRANTY: The vehicles are provided with a one-year, 15,000-mile limited warranty and a three-year, 45,000-mile limited structural warranty. Chassis, component part and appliance manufacturers issue limited warranties covering those portions of the vehicle not covered by the limited warranties issued by Four Winds International. To learn what portions of the vehicle are excluded from coverage under the limited warranties issued by Four Winds International, please contact your selling dealership or Four Winds International directly, or review the warranty packet inside the vehicle.

Product information, specifications, and photography in this brochure were as accurate as possible at time of printing. Photographs may contain some features that are optional on your vehicle. Since we continually strive to improve our products, actual products may differ. The manufacturer reserves the right, at any time, to make changes in product design, materials, component specifications and pricing, without notice. All capacities are approximate and dimensions are nominal. Some features or options may be different or unavailable in Canada.