

EXCURSION 2013

FLEETWOOD RV | CLASS A DIESEL



Copper Java



Cocoa Pearl



Gold Starfire



Platinum Frost

TOP FEATURES

- 300HP Cummins® ISB 6.7L w/Exhaust Brake
- 2100MH Allison® Transmission
- 22.5" Aluminum Wheels
- Automatic 4-Point Hydraulic Leveling Jacks
- 90-Gallon Fuel Tank
- Impressive Pass-Through Storage
- 84" Interior Height
- Tile Flooring Throughout
- 40" Sony® LCD HDTV Blu-ray® Ready
- Hardwood Cabinetry
- Volanic Series Polished Solid-Surface Countertops
- Designer Reversible Comforter
- Washer/Dryer Combo Option
- Residential Refrigerator Option (Standard on 35B & 35C)
- Hide-A-Loft Overhead Bed Option

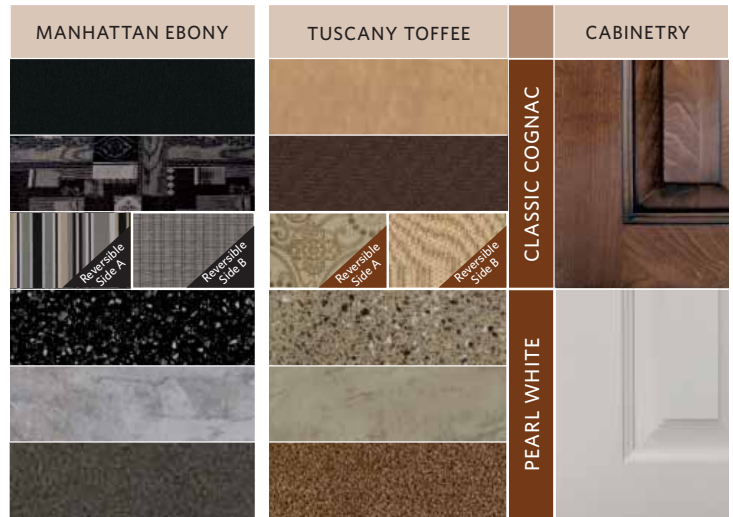

33A

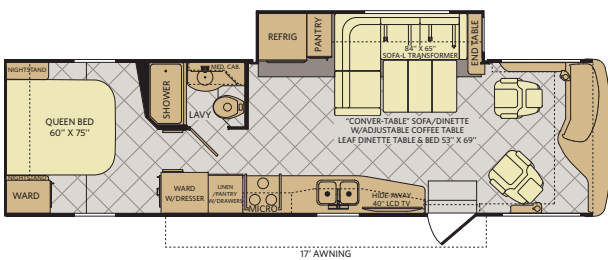

INTERIOR STORAGE CAPACITY: 166 CU. FT. Available options: 084, 126, 144, 146, 186, 217, 853
 EXTERIOR STORAGE CAPACITY: 140 CU. FT.

35C

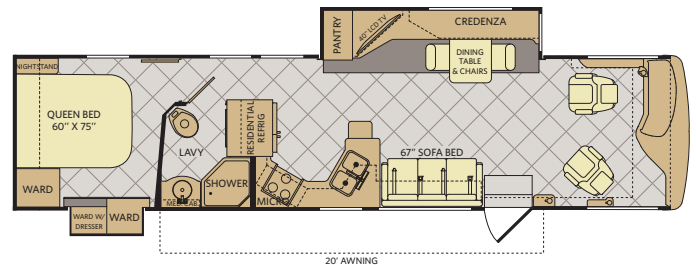

INTERIOR STORAGE CAPACITY: 170 CU. FT. Available options: 084, 126, 186, 217, 853
 EXTERIOR STORAGE CAPACITY: 161 CU. FT.

35B

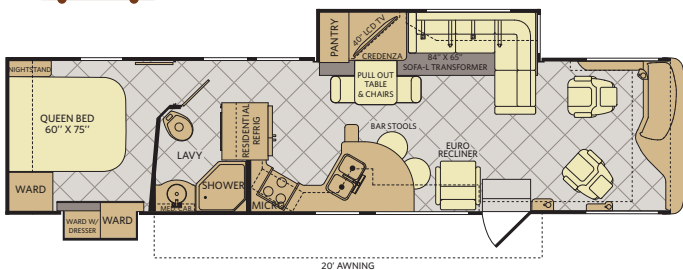

INTERIOR STORAGE CAPACITY: 170 CU. FT. Available options: 084, 126, 186, 217, 853
 EXTERIOR STORAGE CAPACITY: 161 CU. FT.

OPTIONS

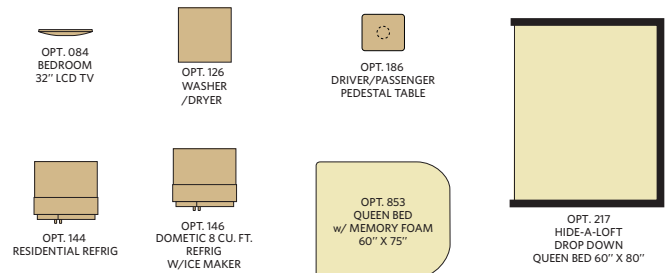

WEIGHTS & MEASUREMENTS

CHASSIS	POWER BRIDGE®		
	MODELS	33A	35B
Wheelbase (inches)	208"	242"	242"
GVWR (lbs) ¹	26,000	26,000	26,000
Front GAWR (lbs) ²	10,500	10,500	10,500
Rear GAWR (lbs) ²	17,500	17,500	17,500
GCWR (lbs) ³	30,000	30,000	30,000
Hitch Rating (lbs) ^{5,††}	10,000	10,000	10,000
Fuel Capacity (gal)	90	90	90

POWER BRIDGE® CHASSIS

Model: Freightliner® XCS Series
Engine: Cummins® ISB 6.7L w/Exhaust Brakes
Transmission: Allison® 2100 MH 6-Speed w/Electronic Shifter

Alternator: Delco Remy 160 Amp
Torque: 660 lb-ft @ 1,600 RPM
Horsepower: 300HP

DIMENSIONS & CAPACITIES

MODELS	33A	35B	35C
Overall Length ⁴	33' 11"	36' 9"	36' 9"
Overall Height (suspension inflated)	11' 10"	11' 10"	11' 10"
Overall Height (suspension deflated)	11' 7"	11' 7"	11' 7"
Overall Width (maximum) ^{5,6}	102"	102"	102"
Interior Height (maximum)	84"	84"	84"
Interior Width (maximum)	96"	96"	96"
Fresh Water Holding Tank (gal)	88	88	88
Grey Water Holding Tank (gal)	60	60	60
Black Water Holding Tank (gal)	32	32	32
Appliance Propane Tank (gal) (WC) ⁷	28.2	28.2	28.2
Water Heater Tank (gal)	6	6	6



CONFIGURE A COACH THE WAY YOU WANT!

COLORS • FLOOR PLANS • OPTIONS • DÉCOR

www.FLEETWOODRV.com



FLEETWOOD RV IS AN ALLIED SPECIALTY VEHICLE COMPANY.

Addendums

- GVWR (Gross Vehicle Weight Rating) is the maximum permissible weight of this fully loaded motorhome. The GVWR is equal to or greater than the sum of the (UVW) unloaded vehicle weight plus the (OCCC) occupant cargo-carrying capacity*.
- GAWR (Gross Axle Weight Rating) is the maximum permissible loaded weight a specific axle is designed to carry.
- GCWR (Gross Combined Weight Rating) is the value specified by the motorhome manufacturer as the maximum allowable loaded weight of this motorhome with its towed vehicle. Towing and braking capacities may be different. Refer to Fleetwood and chassis manufacturer's manuals for complete information.
- Length measured from front bumper to rear bumper (excludes accessories).
- Excludes safety equipment and awnings.
- Motorhomes feature a body width over 96" which will restrict your access to certain roads. Before purchasing, you should research any state and/or province road laws which may affect your usage.
- Tank manufacturer's listed water capacity (WC). Actual propane capacity is 80% of water listing as required by the safety code.

† The chassis manufacturer recommends the installation of a supplemental brake control system to activate the brakes on the vehicle or trailer you are towing. Hitch receiver ratings expressed are maximum for the hitch receiver installed and may require the purchase of additional equipment that is dependent on the weight of the towed load. Consult with hitch receiver manufacturer for further information.

* UVW and OCCC are found on the label containing the federal certification tag in each RV.

†† The Minimum Towable Load of this vehicle is the available weight capacity, up to GCWR, when the coach is fully loaded to maximum GVWR. However, if the coach is loaded to something less than maximum GVWR, that extra available weight capacity can be added to your Towable Load. For example, if your coach is loaded to 1000lbs less than maximum GVWR, your Towable Load increases accordingly. Do not exceed the hitch rating weight, GVWR or GCWR.

IMPORTANT—PLEASE READ

Product information, photography and illustrations included in this publication were as accurate as possible at the time of printing. For further product information and changes, please visit our website at www.fleetwoodrv.com or contact your local Fleetwood RV dealer. Prices, materials, design and specifications are subject to change without notice. All weights, fuel, liquid capacities and dimensions are approximate. Fleetwood RV has designed its recreational vehicles to provide a variety of uses for customers. Each vehicle features optimal seating, sleeping, storage and fluid capacities. The user is responsible for selecting the proper combination of loads (i.e., occupants, equipment, fluids, cargo, etc.) to ensure that the vehicle's capacities are not exceeded.

CONTACT US

To locate a dealer near you, visit our website at www.fleetwoodrv.com or call 1-800-322-8216. We can also be contacted at Fleetwood RV Customer Relations, P.O. Box 1007, Decatur, IN 46733.

FLEETWOOD RV

** All 2013 Fleetwood RV motorhomes include a 1-year emergency Fleetwood RV Trusted Roadside Assistance membership. For complete info, see your Fleetwood RV dealer.

©2012 Fleetwood RV Inc. Printed in USA. Inventory Control Number EXC13F3, 09/12. Model Year 2013, Third Edition.