

Two American icons – Airstream and Eddie Bauer – combine to give you one unforgettable way to explore. Foldaway furniture to give you approximately 400 extra cubic feet of storage for kayaks, bikes and fishing gear? Check. A slew of super pet-friendly features? Check. Quality hand-crafting to ensure durability and stylish good looks through all kinds of wear and tear? Check. Not to mention the sport hatch with roll away screen that brings the outdoors “indoors.”

Travel in the Eddie Bauer Airstream means the luxury of comfort no matter how far you are from “civilization”.

You don't just like to be outside, you live to be outside.



Most notably, the Eddie Bauer provides a wide rear sport hatch accommodating any oversized gear. Interior modular furnishings fold away to give you nearly 400 cubic feet of added space where you need it. Kayaks, bicycles, and fishing tackle load and unload effortlessly across the non-slip Aquatrac™ bumper perch.

25FB EDDIE BAUER



Functional Highlights for the Outdoor Adventurer

- Modular dinette/lounge furnishings fold away to increase your storage capacity (nearly 400 cu. ft.)
- Perimeter interior tie-downs secure stored gear
- Premium Michelin™ tires and 16" wheels provide greater ground clearance
- A "Fern Green" Sunbrella™ awning captures the essence of the Eddie Bauer brand.



Eddie Bauer Floorplans

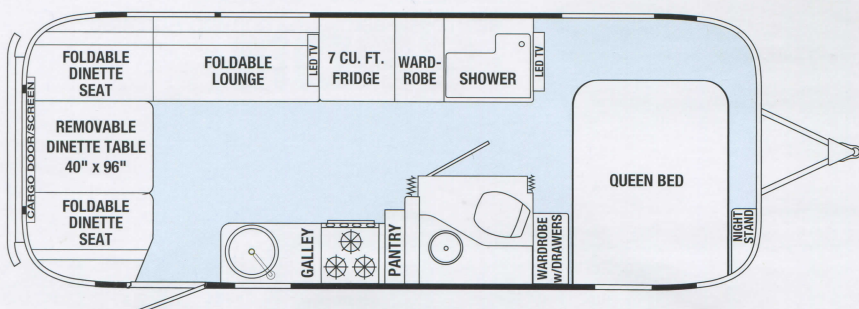

25FB Eddie Bauer

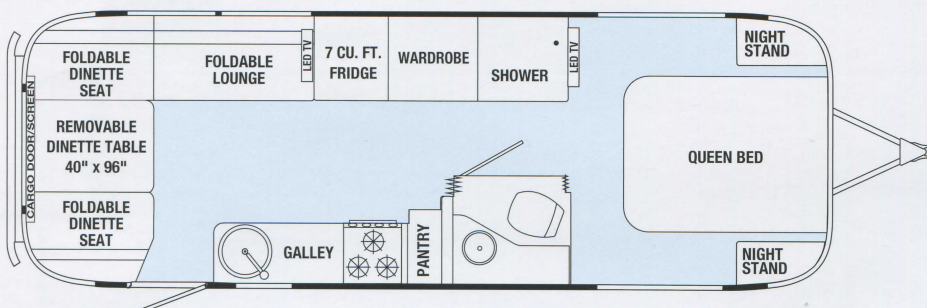

27FB Eddie Bauer



The Airstream Eddie Bauer hatch has a roll-away screen to bring the views in and keep the bugs out.

SPECIFICATIONS

	25FB	27FB
Exterior Length	25'11"	28'
Width Exterior	8'5.5"	8'5.5"
Width Interior	8'1"	8'1"
Height Exterior w/A/C	9' 9.5"	9' 9.5"
Height Interior w/A/C	6' 7.5"	6' 7.5"
Hitch Weight (w/LP and w/o options, water and cargo) (lbs.)	734	885
Unit Base Weight (w/LP and w/o options, water and cargo) (lbs.)	5,750	5,975
Gross Vehicle Weight Rating	7,300	7,800
Net Carrying Capacity (NCC=GVWR-UBW) (lbs.)	1,550	1,825
Fresh Water Tank w/drain valve (gal.)	39	39
Gray Water Tank w/drain valve (gal.)	37	37
Black Water Tank (gal.)	39	39
Water Heater w/electronic ignition (gal.) (XT)	6	6
A/C w/heat pump (BTU)	15,000	15,000
Furnace w/electronic ignition (BTU)	25,000	25,000
LP (2 steel tanks) (lbs.)	60	60
Deep Cycle Battery (lead acid) Group 24	2	2
Sleeping Capacity	2-5	2-5



Four-footed friends? Welcome.

Traveling in the Eddie Bauer Airstream means never having to leave your best buddies behind. Pet-friendly features are standard – so dogs are always welcome.

Please visit www.airstream.com to learn more and to find your nearest Airstream Dealer.



Axles



GVWR
7,300 - 7,800 lbs

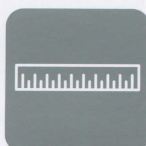

Length
25'11" - 28'



Sleeps





Airstream Online

Learn more! visit www.airstream.com

To find more helpful hints, product selector tools,
 locate a dealer or learn more about our heritage
 and our community,
 please visit www.airstream.com.



THOR
 INDUSTRIES, INC.



Proudly made
 in the U.S.A.

Airstream is a subsidiary
 of Thor Industries, Inc.

Airstream now offers
 24/7 roadside service &
 technical assistance
 provided by CoachNet.



Airstream, Inc.
 419 West Pike Street
 P.O. Box 629
 Jackson Center, OH 45334 USA
 937-596-6111

All content and images
 © Airstream 2014 & 2015
 Eddie Bauer 15k 10/14

Product information, specifications, and photography in this brochure were as accurate as possible at time of printing. Photographs may contain some features that are optional on your vehicle. Since we continually strive to improve our products, actual products may differ. Prices and specifications are subject to change without notice. All capacities are approximate and dimensions are nominal. Some features or options may be different or unavailable in Canada.

Vehicle Loading – Every effort has been made to provide the greatest number of options for the recreation vehicle owner. Along with these choices comes the responsibility to manage the loads that are imposed by the choices so that they remain within the manufacturer's specified chassis weight limits. Do not overload the recreation vehicle.

Dry Weights - based on standard features; optional equipment not included. Net Carrying Capacity (NCC) is determined by subtracting Unit Base Weight (UBW) from the Gross Vehicle Weight Rating (GVWR), and is the capacity available for water, options and cargo. Liquid capacities and weights are approximations only.

Warning – This information is intended as a guide only. Weights of individual vehicles may vary. Consult your owner's manual for complete loading, weighing, and towing instructions.