

NeXCLUSIVE Features

NeXCLUSIVE Features	NeXus RV	Competition	Benefits
All Steel Cage Construction	●	⊗	72% Stronger than Aluminum
Azdel Composite Substrate in Place of Wood	●	⊗	Eliminates Black Mold / Lighter / Higher R-Factor
Pre-Stamped Metal Roof Truss System	●	⊗	Stronger Roof
High Grade UV Protected Automotive Window Seals	●	⊗	Eliminates Squeaks / Prevents Leaks
HVAC Duct System	●	⊗	Easy Flow Air Distribution
Seamless Wrap-Around Fiberglass Roof	●	⊗	No Seams / Perfect Water Runoff
Galvanized Steel Storage Boxes	●	⊗	More Durable and Protective Basement
Premold Wrap-Around Fiberglass Cap	●	⊗	Sleek Exterior Design / Water Protection
Plug/Play Electrical Harness Throughout	●	⊗	Fewer Electrical Issues / Easier to Fix
Luxury Designed Kitchens	●	⊗	Cook Larger Meals
Upgrade Beau™ Flooring	●	⊗	More Durable / Weather Resistant
Exterior Door Rubber Compartment Seals	●	⊗	Eliminates Leaks
Heated and Enclosed Holding Tanks	●	⊗	Four Season Motor Home
Vacuum Bond Laminate Slide-Out Rooms	●	⊗	Stronger Than the Normal Construction Process
Customer Service with Nationwide Network	●	⊗	Peace-of-Mind

At NeXus RV, we believe in manufacturing a superior built motor home. Our brands — the Bentley Class A Diesel Pusher Motor home, the Maybach Class A Gas Motor home, the Phantom Class C Motor home, the Wraith Super C Diesel Motor home, the Ghost Super C Diesel Motor home, and the Viper Class B+ Motor home — are known in the industry for exclusive manufacturing philosophies, which begin with our strong foundation of high strength low alloy 20-gauge steel framing.

We also believe there is an RV for everyone. Our company's principles reflect those of many privately held family owned companies that made the RV industry what it is today. We do what the customers and dealerships want, not what the stock market or shareholders suggest, as we are not a large publicly traded company. We are real people building RVs for real people.

Your Local Maybach Dealer



3400 Reedy Dr. 2994 Paul Dr.
 Elkhart, IN 46514 Elkhart, IN 46514
 1-855-786-3987 1-855-786-3987



VIPER CLASS B+ • PHANTOM CLASS C • WRAITH SUPER C DIESEL • GHOST SUPER C DIESEL • MAYBACH CLASS A GAS • BENTLEY CLASS A DIESEL PUSHER



www.NeXusRV.com

© NeXus RV, 01/17



NeXus RV



We Build Your Dream



www.NeXusRV.com | 1-855-RV-NEXUS



Floor Plans & Specifications

Distinctive Luxury Features

The Maybach is built on a rail chassis with the most durable, high strength, low alloy steel cage construction, plus we have selected the very best floor plan arrangements for ease of use and for ultimate storage capacity.

Remember – *We Build Your Dream!*

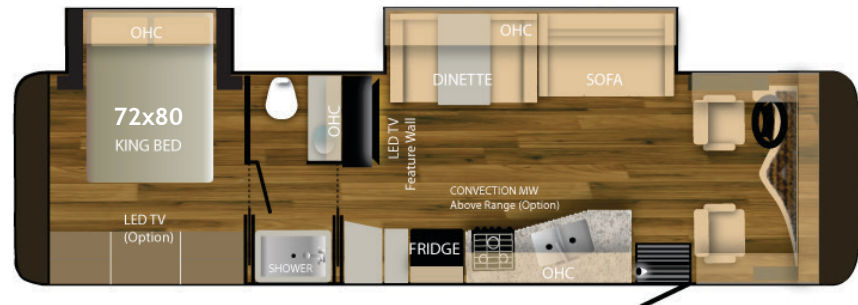

32M

Chassis	Ford F-53	Exterior Height w/AC	12' 10"	Black Tank	43 gal
Engine	320 HP	Exterior Width	8' 5"	Grey Tank	43 gal
Transmission	6-Speed TorqShift w/Tow Haul	Interior Height	84"	Fresh Water Tank	80 gal
GVWR	22,000 lbs	Fuel Capacity	80 gal	LP Gas Tank	20.3 gal
Wheel Base	208	Furnace BTUs	1-40,000	Water Heater	6 gal
Length	33' 2"	A/C BTUs	2-13,500	Sleeps	6

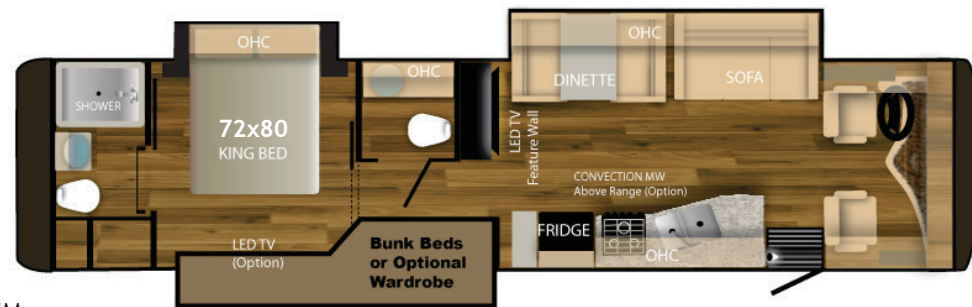

37M

Chassis	Ford F-53	Exterior Height w/AC	12' 10"	Black Tank	43 gal
Engine	320 HP	Exterior Width	8' 5"	Grey Tank	86 gal
Transmission	6-Speed TorqShift w/Tow Haul	Interior Height	84"	Fresh Water Tank	80 gal
GVWR	22,000 lbs	Fuel Capacity	80 gal	LP Gas Tank	20.3 gal
Wheel Base	242	Furnace BTUs	2-25,000	Water Heater	6 gal
Length	37' 5"	A/C BTUs	2-13,500	Sleeps	8

* Specifications and pricing subject to change without notice.



The NeXus RV Maybach Gas Class A Motor home is built with high quality chassis components:

- Ford F-53 Chassis
- Ford V-10 320 Horse Power Engine
- 6 Speed Ford Transmission w/Overdrive Torque 460 ft lbs
- 22" Tires

The Maybach offers luxury design at great savings. Fully equipped, it has a large windshield for maximum view, and allows the driver and passenger seats to be turned around to act as part of the living quarters.



Best ergonomically designed cockpit with dual screen, wrap around dash and luxurious driver/passenger seats.



Super slide living room with large kitchen shown with glazed maple hardwood cabinets.



37M Bunk beds with jack-knife sofa shown in glazed maple cabinets (or wardrobe option available.)



Spacious 37M master bedroom suite with optional washer/dryer and private bathroom shown with glazed maple hardwood cabinets.



Premolded rear fiberglass cap with exclusive fold down prep table and LED lighting.



Full pass through basement storage with galvanized steel compartments and heated holding tanks.

Refer to our website (www.NeXusRV.com) for more standard and optional specifications.