

# ADRENALINE

TOY HAULERS



**BACKED BY MORE THAN 50 YEARS** OF RV MANUFACTURING, COACHMEN'S ALL-NEW ADRENALINE TOY HAULER LINEUP IS DESIGNED FOR TODAY'S OUTDOOR ENTHUSIAST.





**26CB | LIVING**



**26CB | BEDROOM**

## WE'VE LISTENED

Your feedback was the driving force in the design of our product. More storage. More drawers. Comfortable seating areas. Larger beds. Lighter colored wood. More room to fit your toys and hobbies. These are just a few of the many features you will find in the Adrenaline Toy Hauler lineup.



**19CB | LIVING**





## YOU WANTED MORE STORAGE

The 25QB features an abundant amount of storage space with overhead cabinets, pantries and linen closets. Additionally, the bedroom invites you to relax in a spacious 60" x 80" queen walk around bed with three wardrobes and drawers underneath.





## FUNCTIONAL BY DESIGN

Like the rest of the Adrenaline lineup, the 30QBS is a perfect blend of quality, functionality, and looks! From the double entry bedroom to the 12' 6" separated garage, this floorplan is packed with amenities in all the right places.





**BOTTOM RIGHT:** All Adrenaline models are set up to accommodate the optional patio kit. The ramp patio extends living space, and provides a safe, secure place to hang out and enjoy the outdoors.



www.azdelonboard.com

- 50% Lighter than Wood
- No rot, mold or water damage
- 3x better thermal insulation than wood
- Odorless, no formaldehyde
- Sound & energy absorbing
- Impact & puncture resistant
- Made in the USA



## POPULAR STANDARD FEATURES

1. All Adrenaline models are fully prepared for generators. This gen prep includes wiring, fuel lines, gen box, and auto transfer switch.
2. 30 gallon fuel station with gauge and 12V pump allows you to always be on the go!
3. Adrenaline incorporates Azdel, replacing wood in our laminated sidewalls.
4. Convection oven microwave.
5. E-Z Flex<sup>®</sup> suspension enhancement, Nev-R-Adjust<sup>®</sup> brakes and E-Z Lube<sup>®</sup> axles from Dexter Axle give our customers a safer, smoother ride while traveling.
6. 8 cu. ft. Norcold<sup>®</sup> refrigerators.
7. Thermofoil countertops provide complete coverage with no T-mould, eliminating water swells and dirt intrusion.
8. LED accent lighting inside and out.
9. JENSEN<sup>®</sup> 40" LED TV and AM/FM/DVD Bluetooth<sup>®</sup> Stereo w/ app control.



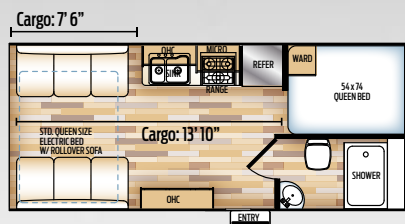

**19CB**

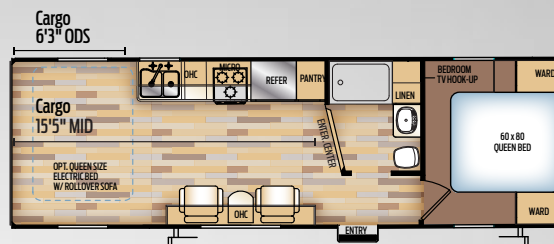

**25QB**

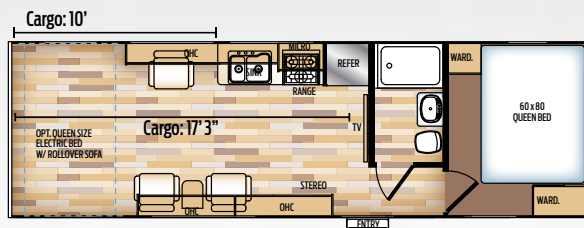

**26CB**

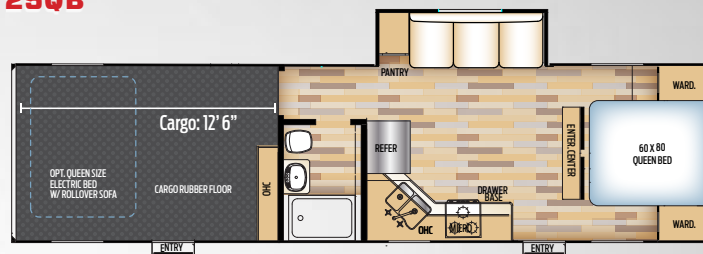

**30QBS**



	ANT19CB	ANT25QB	ANT26CB	ANT30QBS
Hitch Weight	761	771	738	1001
UVW	6081	6894	7017	8810
GVWR	9561	10931	10898	13004
Total Length	25'	32'8"	32'8"	37'8"
Exterior Height	12' 3"	12' 3"	12' 3"	12' 3" **
Cargo Capacity	3421	3978	3822	4135
Water Capacity	100 Gal	100 Gal	100 Gal	100 Gal
Black	30	30	30	30
Gray Water	60	60	60	60
Tire	ST225/ 75R15 LR D	ST225/ 75R15 LR D	ST225/ 75R15 LR D	ST235/ 80R16 LR E

\*\* Height is 12' 11" including second A/C unit

## EXTERIOR STANDARDS

- 102" Wide-Body Construction
- 8" Mega Rail Powder Coated Chassis (10" On 30qbs)
- Dexter Axle E-Z Lube®
- Dexter Axle E-Z Flex® Suspension
- Dexter Axle Nev-R-Adjust® Brakes
- 15" Aluminum Wheels W/ D-Rated Radial Tires (19cb/25qb/26cb)
- 16" Aluminum Wheels W/ E- Rated Radial Tires (30qbs)
- Nitrogen FILLED Tires
- Azdel Laminated Sidewalls
- Heated And Enclosed Underbelly
- Tinted Safety Glass Windows
- Radius Entrance AND Baggage Doors W/ Slam Latches
- 7'6" Patio Ready Ramp Door
- Key Lock Ramp Door Bar Latches
- Generator Prep (Includes Transfer Switch, Fuel Lines, Remote Start, Wiring)
- Power Awning W/ LED Light Strip
- Rain Gutters W/ Extended Drip Spouts
- Electric Tongue Jack
- 2-30LB LP Bottles W/ Cover
- Dual Battery Rack W/ Battery Box
- One Piece TPO Roof
- Black Tank Flush
- LED Lighting
- Exterior Marine Grade Speakers
- 4 Point Manual Stabilizer Jacks
- Rear Cargo Loading LED Light

- 30" Radius Entrance Door
- Solar Prep
- Deluxe Entry Door Assist Handle
- 3 Step Entry W/ LED Lights
- Diamond Plate Front Rock Guard W/ LED Lights
- Digital TV Antenna W/ Power Booster
- Outside Spray Port

## INTERIOR STANDARDS

- Shaker Style Cabinets And Doors
- Designer Carefree Flooring
- LED Lighting Throughout
- Night Shades and/or Snap Shades Throughout
- 3 Burner Cooktop
- Thermofoil Counter Tops
- Easy Glide Full Extension Ball Bearing Drawer Guides
- Rear Pull Down Screen
- Steel Secured 2500# Rated D-Rings
- Auto-Ignition Furnace W/ Wall Mount Thermostat
- Maxx Air Fan w/ Remote in Cargo Area (19CB/25QB/26CB)
- Maxx Air Fan w/ Remote in Living Area (30QBS)
- A/C Prep In Garage (30QBS)
- Medicine Cabinet
- Tub/Shower W/ Surround
- Porcelain Foot Flush Toilet
- Queen Size Electric Bed w/ Roll Over Sofas (19CB)
- Euro Recliners (2 - 25QB, 3 - 26CB)

- Multi Zone Interior Speakers
- Bedroom TV Hookups
- USB Charging Ports - Multiple Locations

## ADRENALINE PACKAGE (MANDATORY OPTION)

- 13,500 BTU Ducted A/C (19CB/25QB/26CB)
- 15,000 BTU Ducted A/C (30QBS)
- 8 cu ft Norcold® Refrigerator
- Convection Microwave
- 40" JENSEN® LED TV
- Jensen® AM/FM/DVD/MP3 Bluetooth Stereo w/ App Control
- Spare Tire and Carrier
- Battery Disconnect
- Road Side 30 Gallon Fuel Station
- 6 Gallon Quick Recovery Gas/Electric DSI Water Heater
- Bed Spread

## OPTIONS

- Queen Size Electric Bed
- Queen Size Electric Bed w/ Roll Over Sofas (Standard 19CB)
- 4,000 Watt Onan Generator (19CB/25QB/26CB)
- 5,500 Watt Onan Generator (30QBS)
- Additional Maxx Air Fans
- Patio Ramp Door System



Forest River, Inc. encourages our customers to purchase their Forest River products from a local dealership whenever possible for the following reasons:

It is the goal of Forest River, Inc. that all of our RV owners fully enjoy the RV experience and that customer satisfaction meets or exceeds their expectations!

- 1) Forest River, Inc. dealers are independently owned and operated businesses so priority service and scheduling is at their discretion and is often provided to customers that purchased their unit at that dealership.
- 2) Purchasing locally allows customers to establish meaningful relationships with a dealer, enhancing the RV experience through assistance with product questions, user tips or RV regulations for your state or country, and much more!
- 3) Canadian customers must meet requirements to bring an RV purchased out of the country to their home. These requirements may involve additional inspections and certifications, taxes and fees. Your local Canadian Dealer is a professional at meeting these requirements.
- 4) Scheduling timely warranty repairs and adjustments through a local dealership provides far greater flexibility and convenience to you, the customer!

## NOTES

YOUR **ADRENALINE** DEALER

[www.coachmenrv.com/adrenaline](http://www.coachmenrv.com/adrenaline)



**Coachmen**  
Leader to the Great Outdoors.

All information contained in this brochure is believed to be accurate at the time of publication. However, during the model year, it may be necessary to make revisions and Forest River, Inc., reserves the right to make all such changes without notice, including prices, colors, materials, equipment and specifications as well as the addition of new models and the discontinuance of models shown in this brochure. Therefore, please consult with your Forest River, Inc., dealer and confirm the existence of any materials, design or specifications that are material to your purchase decision. Litho. U.S.A. P&W: 2016.04.11



## Free One Year Membership — Coachmen Owners Association!

Coachmen is proud to sponsor the largest manufacturer sponsored camping club in North America. Coachmen Owner's Association (COA) provides you a world of ways to enjoy your RV. The is FUN ON OVERDRIVE and provides: Free Trip Routing, Exciting Tours & Rallies, Free Campground Directory, Local/State Club Activities, Easy RVing Magazine Free, Theme Park Discounts, Fuel Discounts, Free onebigplanet® Membership with discounts at 180,000 merchants and much more! Every new Coachmen RV buyer is eligible for a 1 Year FREE membership in the Coachmen Owners' Association. It all adds up to an easy ownership experience.

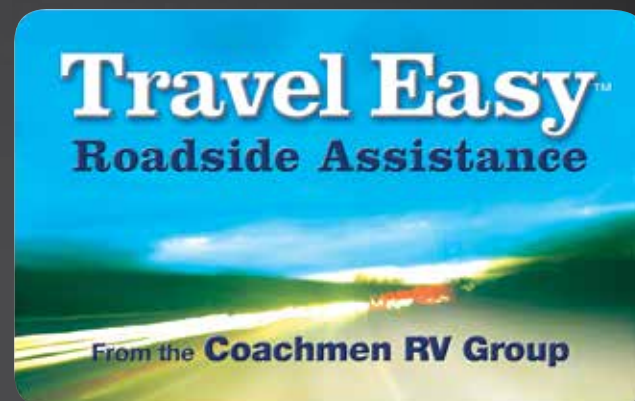

RVing is easier with Coachmen's Travel Easy Roadside Assistance provided FREE the first year of ownership to those who purchase a new Coachmen RV. Administered by Coach-net®, this service provides you with 24/7 operational, technical and emergency road service coverage. Also included is towing, fuel, delivery, jump starts, lock out service, tire changes, mobile mechanic and unlimited technical assistance. Anywhere. Anytime. Travel Easy is the security of knowing that help is an easy phone call away.



## PRE-DELIVERY INSPECTION FACILITY

20,000 square feet of quality assurance. The bare essentials for a premium product. This state-of-the-art facility gives immediate daily feedback to production for quality assurance in every unit built.

## Specification Definitions

**GVWR (Gross Vehicle Weight Rating)** - is the maximum permissible weight of the unit when fully loaded. It includes all weights, inclusive of all fluids, cargo, optional equipment and accessories. For safety and product performance do NOT exceed the GVWR.

**GAWR (Gross Axle Weight Rating)** - is the maximum permissible weight, including cargo, fluids, optional equipment and accessories that can be safely supported by a combination of all axles.

**UVW (Unloaded Vehicle Weight)** - is the

typical weight of the unit as manufactured at the factory. It includes all weight at the unit's axle(s) and tongue or pin and LP Gas. The UVW does not include cargo, fresh potable water, additional optional equipment or dealer installed accessories.

**\*\*Estimated average based on standard build optional equipment.**

**CCC (Cargo Carrying Capacity)\*\*** - is the amount of weight available for fresh potable water, cargo, additional optional equipment and accessories. CCC is equal to GVWR minus UVW. Available CCC should accommodate fresh potable water (8.3 lbs per gallon). Before filling the fresh water tank,

empty the black and gray tanks to provide for more cargo capacity.

**\*\* Estimated average based on standard build optional equipment**

Each Forest River RV is weighed at the manufacturing facility prior to shipping. A label identifying the unloaded vehicle weight of the actual unit and the cargo carrying capacity is applied to every Forest River RV prior to leaving our facilities.

The load capacity of your unit is designated by weight, not by volume, so you cannot necessarily use all available space when loading your unit.