



Ultra-Lite

MPG



MPG

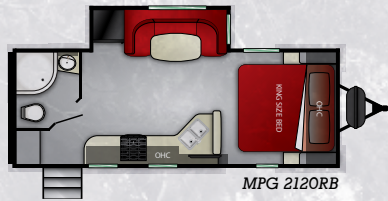

MPG 2120RB

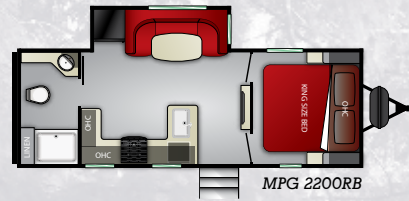

MPG 2200RB

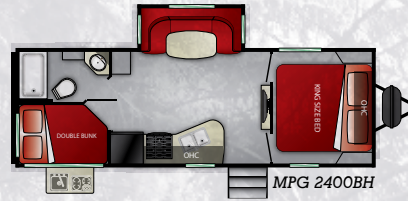

MPG 2400BH

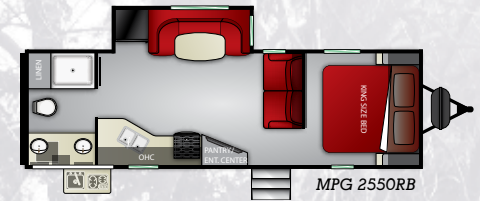

MPG 2550RB

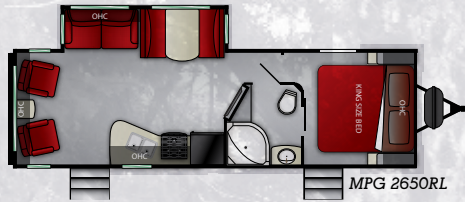

MPG 2650RL

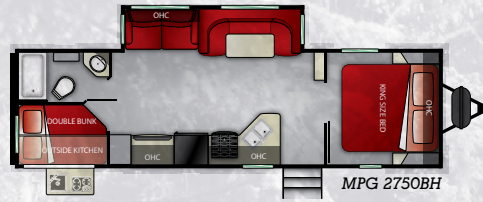

MPG 2750BH



MPG 2800QB

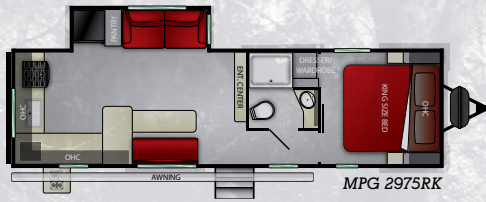

MPG 2975RK

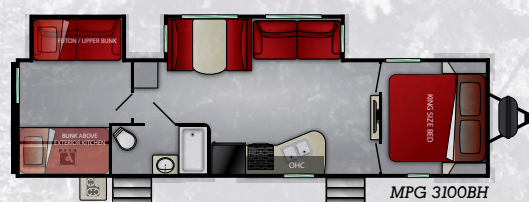

MPG 3100BH

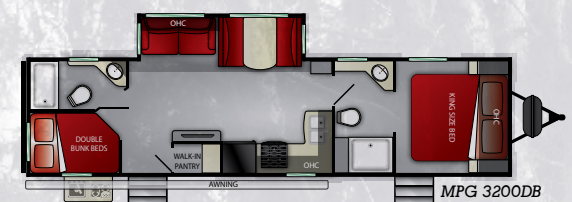

MPG 3200DB

Model	2120 RB	2200 RB	2400 BH	2550 RB	2650 RL	2750 BH	2800 QB	2975 RK	3100 BH	3200 DB
Length	26' 2"	TBD	29' 1"	TBD	31' 7"	32' 11"	33' 4"	TBD	36' 5"	36' 10"
Dry	4,960	TBD	5,320	TBD	6,020	6,300	6,240	TBD	6,930	6,596
Hitch	580	TBD	565	TBD	540	680	740	TBD	855	958
Height	11' 1"	TBD	11' 1"	TBD	11' 3"	11' 3"	11' 3"	TBD	11' 5"	11' 5"
Awning	14'	TBD	19'	TBD	20'	19'	19'	TBD	19'	20'
Tanks	44 ^F 30 ^G 30 ^B	TBD	44 ^F 30 ^G 30 ^B	TBD	44 ^F 30 ^G 30 ^B	44 ^F 30 ^G 30 ^B	44 ^F 30 ^G 30 ^B	TBD	44 ^F 30 ^G 30 ^B	40 ^F 60 ^G 60 ^B

Your Local Cruiser RV Dealer:



MADE IN THE U.S.A.

Product information is as accurate as possible as of the date of publication of this brochure. Due to Cruiser RV's commitment to continuous product improvement - floorplans, materials, components, features, measurements, specifications, options, etc. are subject to change at any time without notice or obligation. In certain conditions some additional equipment may be needed. Photos may show optional equipment or props used for photography purposes only.

Cruiser RV has listed the approximate base weight of the trailer without the option equipment included. Option equipment will impact the weight of the trailer. Please locate the weight sticker attached to the trailer you are considering for the most accurate trailer weight.

Tow Vehicle Caution: Owners of Cruiser recreational vehicles are solely responsible for the selection and proper use of tow vehicles. All customers should consult with a motor vehicle manufacturer or their dealer concerning the purchase and use of suitable tow vehicles for Cruiser RV products. Cruiser RV disclaims any liability or damages suffered as a result of the selection, operation, use or misuse of a tow vehicle. Cruiser RV's limited warranty does not cover damage to the recreational vehicle or the tow vehicle as a result of the selection of the tow vehicle.