

PULSE

2019 FLEETWOOD RV CLASS C DIESEL

TOP FEATURES

- Modern contemporary interior decors
- Euro style cabinets w/lighted toe kick
- LED lighting
- Stainless steel appliances
- Functional & spacious kitchen layouts
- Solid surface galley countertops w/under mount stonecast sink and cover
- Full body paint
- 1000W inverter
- Garmin Infotainment dash unit with navigation (RV Maps)
- Power lateral arm awning with LED lighting
- Two interior choices

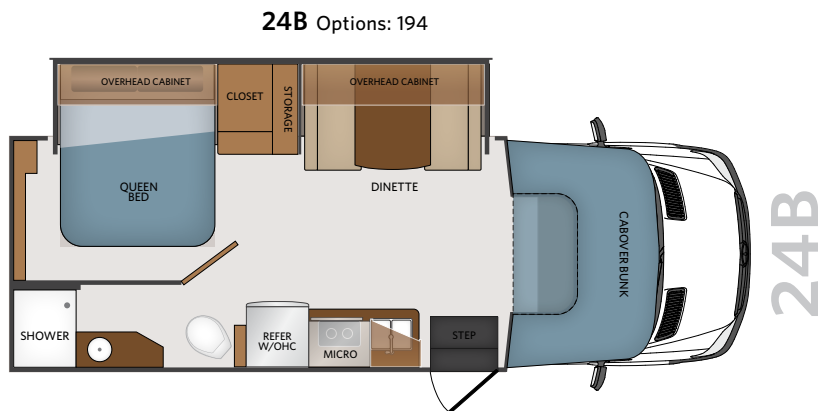
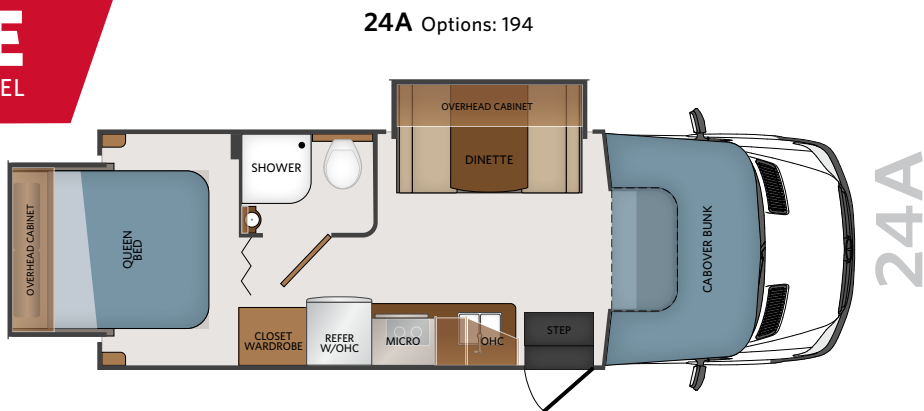

CHASSIS

| MODEL | 24A | 24B |
|---------------------------|--------|--------|
| Wheelbase (inches) | 170" | 170" |
| Front GAWR (lbs) | 4,410 | 4,410 |
| Rear GAWR (lbs) | 7,720 | 7,720 |
| GCWR (lbs) | 15,250 | 15,250 |
| GVWR (lbs) | 11,030 | 11,030 |
| Hitch Rating Weight (lbs) | 5,000 | 5,000 |
| Tongue Weight (lbs) | 500 | 500 |
| Fuel Capacity (gal) | 26.4 | 26.4 |

DIMENSIONS AND CAPACITIES

| MODEL | 28A | 29M |
|------------------------------------|--------|--------|
| Overall Length (inches) | 25' 2" | 25' 2" |
| Overall Height (with A/C) | 11' 4" | 11' 4" |
| Overall Width (maximum) | 7' 8" | 7' 8" |
| Interior Height (maximum) | 82" | 82" |
| Interior Width (maximum) | 88" | 88" |
| Patio Awning Width (feet & inches) | 15' 6" | 15' 6" |
| Interior Storage (cu. ft.) | 24 | 24 |
| Exterior Storage (cu. ft.) | 42 | 40 |
| Fresh Water Holding Tank (gal) | 29 | 29 |
| Grey Water Holding Tank (gal) | 33 | 33 |
| Black Water Holding Tank (gal) | 33 | 33 |
| Appliance Propane Tank (gal) (WC) | 13 | 13 |
| Water Heater Tank (gal) | 6 | 6 |

MERCEDES-BENZ CHASSIS

Model: Mercedes Benz Sprinter
 Engine: 3.0L Cylinder, 188HP, Turbo-Diesel Engine
 Transmission: Mercedes-Benz, 5-Speed, Automatic
 Alternator: 220 Amp
 Torque: 325 lb.-ft. @ 1,400 RPM
 Horsepower: 188HP @ 3,800 RPM

EXTERIOR CHOICES



STARLIGHT



RESORT

CONTACT US To locate a dealer near you, visit our website at www.fleetwoodrv.com or call 1-877-252-4666.

We can also be contacted at Fleetwood RV Customer Relations, P.O. Box 1007, Decatur, IN 46733.

©2019 REV GROUP

Printed in USA. 08/18. Model Year 2019. Second Edition.