

Avalanche

FULL-PROFILE FIFTH WHEELS

GO BOLDLY





# The ultimate ownership experience.

The goal of Keystone RV Company is to surprise and delight our owners at each and every touchpoint. We're happy when our campers are happy, and we are committed to providing the very best ownership experience in the industry.



**Keystone RV  
Company**

## 1 EASIER SHOPPING.

At Keystone, we make choosing an RV as easy as finding the Big Dipper on a dark summer night. With comprehensive online product information, Key Connect™ product advisors, and an unparalleled dealer network, we will help you select the perfect RV for your family's adventure.

## 2 INNOVATIVE THINKING.

The road's a nicer place when you have the industry's smartest features behind you. Keystone leads the pack in patented innovations that make our RVs safer, more comfortable, and easier to operate.

## 3 LONG HAUL QUALITY.

To keep you on the road, there are certain things we just won't build a Keystone RV without. Game-changing features like our Unified Wiring Standard, Tru-Fit™ five-point slide construction, and no-fail Tuf-Lok™ A/C duct joiners combined with exhaustive testing and inspections are some of the reasons why Keystone is able to offer our owners the industry's best 3-year limited structural warranty.

## 4 WORRY-FREE CUSTOMER SERVICE.

Wherever the road takes you, you're never too far from an authorized Keystone service center. We also offer live service assistance, ultra-fast parts shipping, online maintenance tips and tricks, and a single-point warranty claims policy. *That's* peace of mind.

## 5 KEYSTONE NATION.

When you choose Keystone, you become a part of one of the largest camping families in the country. We're Keystone Nation. A friendly community where people share photos, travel tips and amazing stories – all in the spirit of camaraderie and adventure. Come join us.

Experience the Avalanche lifestyle by visiting [#keystoneavalanche](#)

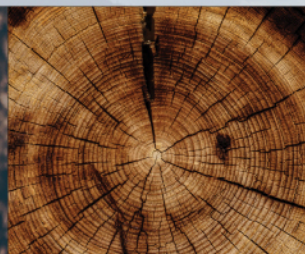



# Keystone EXCLUSIVE Innovations

Year after year, Keystone RV's experienced team delivers Built For the Long Haul quality you expect and exclusive innovations you won't find anywhere else.



**3-year Limited Structural Warranty,  
1-year Limited Base Warranty**

Every new Keystone RV comes with the industry's best three-year limited structural warranty AND a one-year limited base warranty. Ask your dealer, visit [keystonerv.com](http://keystonerv.com), or call Keystone Owner Relations for details.



**4G LTE and Wi-Fi Prep**

All Avalanches are equipped with a new Furrion® antenna that integrates 4G LTE and Wi-Fi with standard VHF/UHF/AM/FM reception.



**KeyTV™**

No more connection guesswork or poor reception. KeyTV offers a game-changing, single point of control of over-the-air, cable, and satellite feeds. Visit us online for more information.



**Color-Coded Wiring Standard**

Easy-to-trace circuits simplify electrical and entertainment system troubleshooting.



**Hitch Vision™**

Simplifies hitch hook-up with "no looking back" convenience.



**In-floor Heating Ducts**

Distributes heat evenly for greater comfort.



**Road Armor™ Suspension**

Equalizes axle load to dampen shock and vibration.



**Tru-Fit™ Slide Construction**

A more durable slide room design that minimizes functional motor and structural stress, resists leaking.



# AVALANCHE



FULL-PROFILE FIFTH WHEELS

## Live large.

Avalanche leads the industry in full-size construction, comfort, entertainment and value for extended-stay camping. Its unique wide-body design with high ceilings and frameless panoramic windows offers the kind of spacious living areas, bedrooms and bathrooms that make campers wonder why they would ever settle for anything less.

For more information, please visit [kestonerv.com/avalanche](http://kestonerv.com/avalanche)



### Room to Relax

Wide-body construction allowing for large, luxury features that make you feel right at home.



#### Furrion® Stove & Oven

Furrion's two-in-one range/oven combination features stainless steel exterior, glass oven door, and self-lighting oven.



#### Oversized Pass-Through Storage

Approximately 145 cu. ft. of pass-through storage with no-skid rubber diamond plate flooring.



#### Polar Pack All Season Protection

Exclusive all season Polar Pack protection allows you to camp in nearly any condition. Rated and tested to -4°F without water lines or tanks freezing.



#### One Touch 6-point Level-Up System

Leveling jacks automatically level your RV within two minutes simply with the touch of a button.



#### 18 cu. ft. Stainless Steel Refrigerator

Bigger than others in its class, allowing you to stock-up without sacrifice.



#### SolidStep® by Lippert Components

Simple and easy to operate. Provides a sturdy and secure entry and exit.

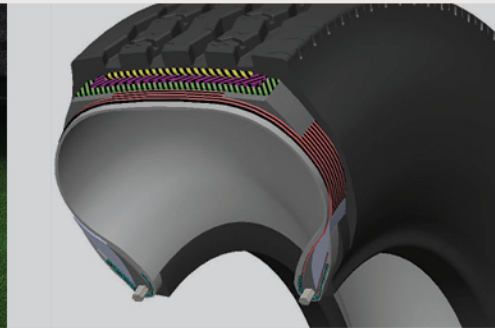

#### Heavy Duty G-rated Tires

Upgraded, higher-ply tires for maximum towing security and confidence.

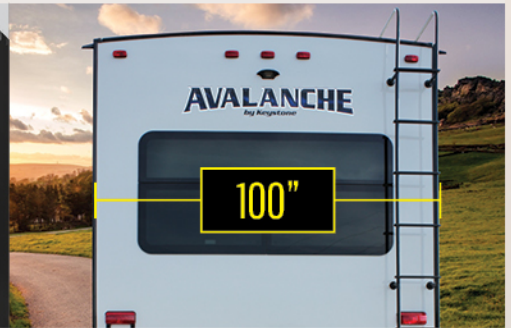

#### 100" Wide Body Construction

Wide body construction adds 4" additional living space in hallways, bedrooms and bathrooms.



#### Summit Slides with Expansive Windows

Tall slides that challenge the competition allowing for oversized windows and panoramic views.



#### Stackable Washer and Dryer Prep

Bring along a washer and dryer for the long haul. Every model comes prepped and ready for a stackable unit.

### Durability and Convenience

Built for long-term travel with G-rated tires, 7,000 lb. capacity axles and innovations to keep your journeys stress free.





more product detail at  
[www.keystonerv.com/avalanche](http://www.keystonerv.com/avalanche)



## Extended-Stay Comfort

Not only is Avalanche built for extreme comfort and convenience, it is built to impress. In addition to three new floorplans, we have re-vamped our interior design across the lineup, including stunning solid wood cabinet doors, intricate cabinetry design with elegant drawer fronts and slide fascia, light marbled countertop, glass-panel barn doors and many more brand new, eye-catching features.





### Inspired Décor

Avalanche is designed with you in mind. Our goal is to provide the best of the best, all so you feel right at home.



### Wide-Body Construction

Spacious 100" construction allowing for maximized storage throughout and plenty of room for the whole family.







more product detail at  
[www.keystonerv.com/Avalanche](http://www.keystonerv.com/Avalanche)

## Avalanche | FULL-PROFILE FIFTH WHEELS

- Stunning solid-wood cabinet doors, drawer fronts and slide fascia
- Furrion® recessed range with glass cover and stainless steel storage drawer
- 30" microwave
- 18 cu. ft. refrigerator, standard
- KeyTV™ Keystone's revolutionary single-source, easy-to-use controller for over-the-air, cable and satellite television
- Cordless MCD night roller shades provide superior insulation, clear views and privacy during the day, and nighttime blackout coverage
- Stackable washer and dryer prep, standard
- Summit slide rooms with 6' 10" interior height
- Two panoramic 5' x 4' slide box windows
- Spacious 100" wide-body construction
- 70" x 80" king-size beds
- High-pressure air conditioner (15,000 BTU and 13,500 BTU standard)
- -4°F rating with R-28 equivalent roof, R-37 equivalent floor and R-10 wall insulation
- 145 cu. ft. heated basement storage
- 12-gallon water heater with more than 16-gallon recovery per hour
- 2" receiver hitch with 300 lb. capacity
- High-gloss gel coat exterior
- Six-point hydraulic auto-leveling system
- EXCLUSIVE Road Armor™ suspension equalizes axle load to dampen shock and vibration
- G-rated tires and 7,000 lb. capacity axles
- Quad Solid Step™ by Lippert Components for added safety



**Hardwood Cabinets**  
Avalanche cabinetry features solid wood construction for building a sturdier kitchen.



**High Pressure Air Conditioners**  
High-capacity 15,000 BTU and 13,500 BTU units, standard on every Avalanche.

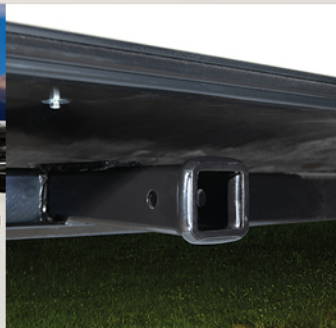

**2" Accessory Receiver Hitch**  
Every Avalanche comes standard with a 300 lb. carrying capacity receiver hitch. Perfect for use with any accessory approved for RV use. Check accessory owner's manual.



**Automotive Grade Painted Fiberglass Front Cap**  
Avalanche caps include Keystone's exclusive KeyGuard™ protective coating, designed to provide chip and rock protection.



# Avalanche | FULL-PROFILE FIFTH WHEEL FLOORPLANS

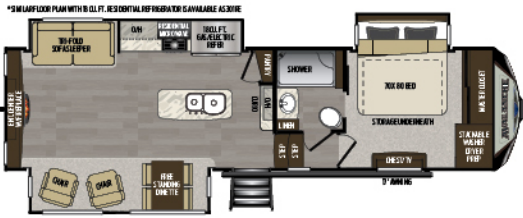

**300RE/301RE** | Rear entertainment, triple-slide, king bed  
Weight: 11378 LBS. | Length: 34'



**320RS/321RS** | Rear living room, triple-slide, king bed  
Weight: 11571 LBS. | Length: 35' 8"

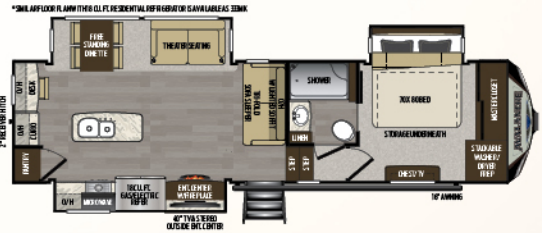

**332MK/333MK** | Mid-kitchen, triple-slide w/desk  
Weight: 11245 LBS. | Length: 34' 3"

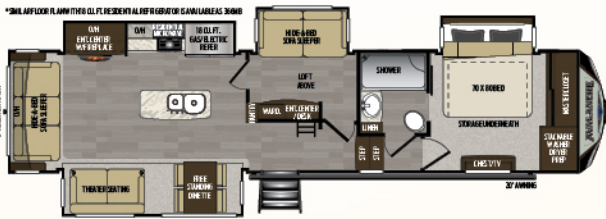

**365MB/366MB** | Center bonus room w/loft  
Weight: 12999 LBS. | Length: 39' 4"

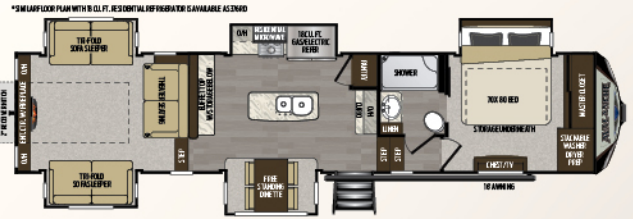

**375RD/376RD** | Rear den, five slides, massive storage tray  
Weight: 13416 LBS. | Length: 40' 7"

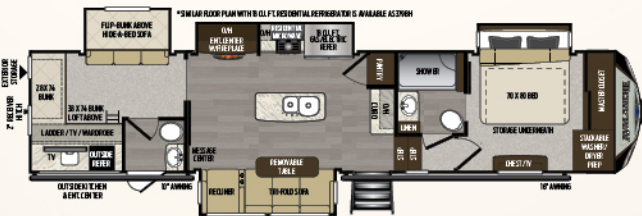

**378BH/379BH** | 1/2 bath, bunkhouse outside kitchen  
Weight: 13580 | Length: 40' 7"

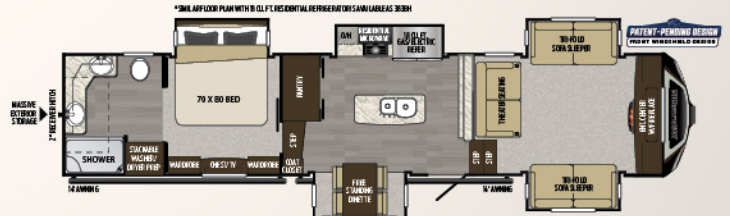

**382FL/383FL** | Rear master retreat, front living  
Weight: 13450 LBS. | Length: 41' 5"

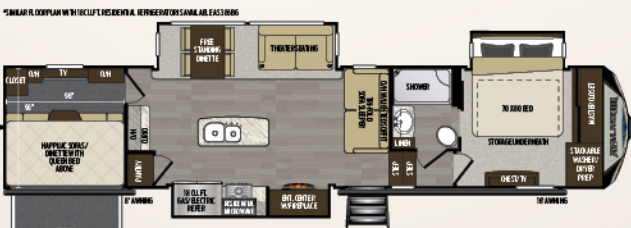

**385BG/386BG** | Garage bunkhouse, patio, triple-slide  
Weight: 13417 LBS. | Length: 41' 6"

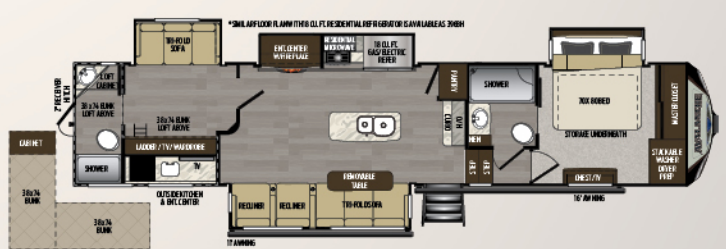

**395BH/396BH** | 2 full bathroom bunkhouse, loft, outside kitchen  
Weight: 13940 LBS. | Length: 41' 6"



### FULL-PROFILE FIFTH WHEELS

MODEL	WEIGHT	CARRYING CAPACITY	HITCH WEIGHT	FRESH WATER	WASTE WATER	GRAY WATER	LPG	LENGTH*	HEIGHT	HEIGHT	AWNING
300RE	11378	3622	2365	66	49	83	60	34'	8' 4"	13' 2"	17'
301RE	11540	3460	2395	66	49	83	60	34'	8' 4"	13' 2"	17'
320RS	11571	3429	2275	66	49	83	60	35' 8"	8' 4"	13' 2"	16'
321RS	11461	3539	2320	66	49	83	60	35' 8"	8' 4"	13' 2"	16'
332MK	11245	3865	2380	66	49	83	60	34' 3"	8' 4"	13' 2"	16'
333MK	11245	3755	2390	66	49	83	60	34' 3"	8' 4"	13' 2"	16'
365MB	12999	2501	2730	66	49	83	60	39' 4"	8' 4"	13' 2"	20'
366MB	12825	2675	2690	66	49	83	60	39' 4"	8' 4"	13' 2"	20'
375RD	13416	2584	2475	66	49	83	60	40' 7"	8' 4"	13' 2"	16'
376RD	13285	2715	2430	66	49	83	60	40' 7"	8' 4"	13' 2"	16'
378BH	13580	2920	2820	66	83	117	60	40' 7"	8' 4"	13' 4"	16'/10'
379BH	13580	2920	2820	66	83	117	60	40' 7"	8' 4"	13' 4"	16'/10'
382FL	13450	3050	2800	66	44	78	60	41' 5"	8' 4"	13' 4"	14'/14'
383FL	13375	3125	2815	66	44	78	60	41' 5"	8' 4"	13' 4"	14'/14'
385BG	13417	3083	2765	66	49	83	60	41' 6"	8' 4"	13' 2"	18'
386BG	13285	3215	2700	66	49	83	60	41' 6"	8' 4"	13' 2"	18'
395BH	13940	2560	2760	66	93	127	60	41' 6"	8' 4"	13' 2"	16'/11'
396BH	13916	2584	2715	66	93	127	60	41' 6"	8' 4"	13' 2"	16'/11'

DISCLAIMER: Product information is as accurate as possible as of the date of publication of this brochure. All features, floor plans, and specifications in this brochure are subject to change without notice. Please also consult Keystone's web site at [www.keystonerv.com](http://www.keystonerv.com) for more current product information and specifications. Tow Vehicle Disclaimer. CAUTION: Owners of Keystone recreational vehicles are solely responsible for the selection and proper use of tow vehicles. All customers should consult with a motor vehicle manufacturer or their dealer concerning the purchase and use of suitable tow vehicles for Keystone products. Keystone disclaims any liability or damages suffered as a result of the selection, operation, use or misuse of a tow vehicle. KEYSTONE'S LIMITED WARRANTY DOES NOT COVER DAMAGE TO THE RECREATIONAL VEHICLE OR THE TOW VEHICLE AS A RESULT OF THE SELECTION, OPERATION, USE OR MISUSE OF THE TOW VEHICLE. \*Length is defined as the distance from the centerline of hitch pin/coupler to rear bumper of trailer. Please review owner's manual prior to purchase for more information on service warranties, extended use, towing and maintenance. Owner's manuals can be found at [keystonerv.com](http://keystonerv.com).



more product detail at  
[www.keystonerv.com/Avalanche](http://www.keystonerv.com/Avalanche)



## STANDARDS AND OPTIONS

### EXTERIOR

Road Armor™ shock absorbing hitch pin  
 Rear observation camera prep  
 Solar prep  
 G-rated tires  
 2" receiver hitch w/300 lb. capacity  
 "No Sweat" vented attic system  
 10" beams with Z-frame technology (some models 12")  
 50 AMP service with detachable power cord  
 Hydraulic selector valves for slide-outs  
 Max Turn Technology™ high-gloss fiberglass front cap w/ Hitch Vision™ backup mirror  
 6-point hydraulic auto level up system  
 Tinted 80% safety glass windows  
 Rear ladder  
 Super-size 6' 4" tall, 30" wide entry doors  
 Dual pane windows (optional)  
 Generator prep (optional)  
 6 Point one-touch hydraulic auto leveling system (mandatory)

### ALL-IN-ONE "WATER WORKS" EXTERIOR UTILITY CENTER

KeyTV™ multisource TV control system  
 Easy siphon winterization system  
 Water heater bypass  
 Enclosed low point drain valves  
 Ducted heat for cold weather protection  
 Dump valves (most models)  
 Black tank spray hookup  
 Hot and cold high pressure water hose with quick disconnect

### ROAD ARMOR™ SUSPENSION

Improved impact absorption  
 Improved axle equalization  
 Greasable wet bolts (8)  
 Long lasting 1/2" steel shackle plates  
 Long lasting bronze bushings

### INTERIOR

Heavy duty ball bearing drawer guides  
 Extra deep, fully extendable drawers  
 Solid surface countertops  
 Solid surface sink cover  
 Stainless steel, extra deep sink with dual bowls  
 High-rise, single-lever kitchen faucet  
 Maximized kitchen storage w/ more drawers and pantry space  
 Ceiling fan  
 LP leak detector

### INTERIOR (CONTINUED)

40" designer fireplace with decorative surround  
 Power theater seats featuring heat and massage  
 "One Place Command Center" centrally located operational switches & gauges  
 Translucent glass shower door and massaging shower head  
 Shower skylight  
 Porcelain foot flush toilet  
 Cross ventilation bedroom windows (where available)  
 32" bedroom TV (optional)  
 32" bunk room TV (optional on 365MB, 378BH, 395BH)  
 18 cu. ft. residential refrigerator (mandatory on 301RE, 321RS, 333MK, 366MB, 376RD, 379BH, 383FL, 386BG, 396BH)

### PACKAGES

#### UPGRADED APPLIANCE

30" microwave  
 12-gallon DSI 2-way water heater  
 35,000 BTU furnace  
 18 cu. ft. gas/electric refrigerator  
 High output range w/22" oven

#### BEST CAMP COLLECTION

Solid wood cabinet doors, drawers, and hardwood fascia  
 Solid surface kitchen countertops and flush mounted sink covers  
 Huge 50" LED TV  
 12V AM/FM/CD/DVD home theater system w/surround sound effect speakers  
 KeyTV™ multisource TV/satellite control system  
 Stackable washer and dryer prep (all models)  
 Thermo-Shield R37 triple insulated, ducted and heated holding tanks  
 Drop frame technology

Class A bus-style latch slam baggage doors  
 G-rated tires  
 Heavy duty, Dexter® E-Z Lube® 7000 lb. axles  
 Power front and rear jacks  
 One-touch electric awning w/ adjustable arms  
 Aluminum wheels

#### COMFORT

100" Wide-body width with upgrade construction  
 Summit slides with super-sized windows  
 Frameless windows  
 Hidden hinge cabinets  
 MCD roller night shades  
 48" x 30" walk-in fiberglass shower  
 Fantastic fan (kitchen)  
 Quad Solid Step by Lippert Components for added safety



BUILT FOR THE LONG HAUL



PRINT 12.2018

