

Hideout

WESTERN

SINGLE-AXLE MINIS

TRAVEL TRAILERS

FIFTH WHEELS

TOY HAULERS

GO OUTSIDE AND

GET LOST



**Keystone RV  
Company**



# The ultimate ownership experience.

The goal of Keystone RV Company is to surprise and delight our owners at each and every touchpoint. We're happy when our campers are happy, and we are committed to providing the very best ownership experience in the industry.



**Keystone RV  
Company**

## 1 EASIER SHOPPING.

At Keystone, we make choosing an RV as easy as finding the Big Dipper on a dark summer night. With comprehensive online product information, Key Connect™ product advisors, and an unparalleled dealer network, we will help you select the perfect RV for your family's adventure.

## 2 INNOVATIVE THINKING.

The road's a nicer place when you have the industry's smartest features behind you. Keystone leads the pack in patented innovations that make our RVs safer, more comfortable, and easier to operate.

## 3 LONG HAUL QUALITY.

To keep you on the road, there are certain things we just won't build a Keystone RV without. Game-changing features like our Unified Wiring Standard, Tru-Fit™ five-point slide construction, and no-fail Tuf-Lok™ A/C duct joiners combined with exhaustive testing and inspections are some of the reasons why Keystone is able to offer our owners the industry's best 3-year limited structural warranty.

## 4 WORRY-FREE CUSTOMER SERVICE.

Wherever the road takes you, you're never too far from an authorized Keystone service center. We also offer live service assistance, ultra-fast parts shipping, online maintenance tips and tricks, and a single-point warranty claims policy. *That's* peace of mind.

## 5 KEYSTONE NATION.

When you choose Keystone, you become a part of one of the largest camping families in the country. We're Keystone Nation. A friendly community where people share photos, travel tips and amazing stories – all in the spirit of camaraderie and adventure. Come join us.

Experience the hideout lifestyle by visiting [#keystonehideout](#)





# Keystone EXCLUSIVE Innovations

Year after year, Keystone RV's experienced team delivers Built For the Long Haul quality you expect and exclusive innovations you won't find anywhere else.



## 3-year Limited Structural Warranty, 1-year Limited Base Warranty

Every new Keystone RV comes with the industry's best three-year limited structural warranty AND a one-year limited base warranty. Ask your dealer, visit [keystonerv.com](http://keystonerv.com), or call Keystone owner relations for details.



## 4G LTE and Wi-Fi Prep

All units are equipped with a new Furrion® antenna that integrates 4G LTE and Wi-Fi with standard VHF/UHF/AM/FM reception.



## EXCLUSIVE Color-Coded Wiring

Easy-to-trace circuits simplify electrical and entertainment system troubleshooting.



## Hitch Vision™

Simplifies hitch hook-up with "no looking back" convenience. (Fifth wheel models only.)



## In-Floor Heating Ducts

Ducting allows for more airflow that distributes heat evenly for optimal comfort.

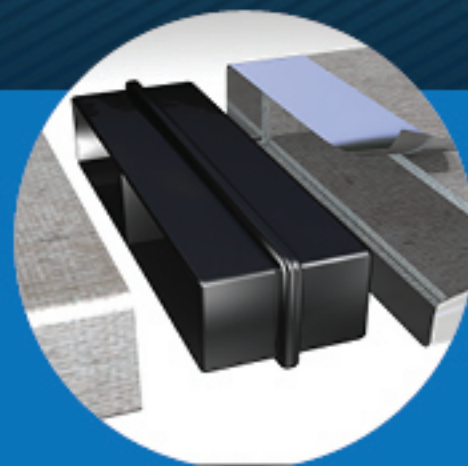

## Tuf-Lok™ A/C Duct Joiners

Crush resistant design securely joins A/C ductwork, drastically reducing chilled-air leaks and boosting cooling efficiency and comfort.



## Tru-fit™ Slide Construction

A more durable slide room design that minimizes functional motor and structural stress, resists leaking.



# HIDEOUT



SINGLE-AXLES | LHS | LUXURY | FIFTH WHEELS

## Joining the RV lifestyle? Start with a hideout.

If you're looking to begin the RV lifestyle, you have arrived. The Hideout brand is the perfect introduction with its small single-axle travel trailers all the way up to our easy-to-tow fifth wheels. The unparalleled value of Hideout's features and amenities combined with our extensive floorplan offering allows you to camp anywhere with the ones you love. Hideout's crisp, clean look will inspire you to get out and see the world through fresh eyes.

For more information, please visit [keystonerv.com/hideout](http://keystonerv.com/hideout)



### Exclusive and Unexpected Features



**MORryde® Step Above™ Steps**  
Ultra-Safe and secure main entry with strut assist. (N/A on 38' or LHS models.)



**EXCLUSIVE MaxTurn Technology™**  
Durable, patented bent-tube frame design maximized hitch turning radius without specialty accessories. (FW models only.)



**Furrion® Oven with Glass Cooktop**  
Chef-inspired appliance with lighted backplash that gives you the perfect blend of performance, precision and style.



**Power Tongue Jack**  
Easy-to-use jack makes RV setup fast and simple. (Luxury models only)



**Central Vacuum System**  
Class exclusive built-in, easy cleanup. No need to bring along any extras.



**New Under-Mount Stainless Steel Sink w/Covers**  
Sleek under-mount sink that is flush with the countertop, preventing food/residue from collecting in bumps and ridges. (luxury models only)



**Tinted Safety Glass Windows**  
Tinted windows assist in keeping your coach cool and the interior décor from fading.



**60-Gallon Fresh Water Tank**  
Higher capacity fresh water tank, great for dry camping or boondocking.

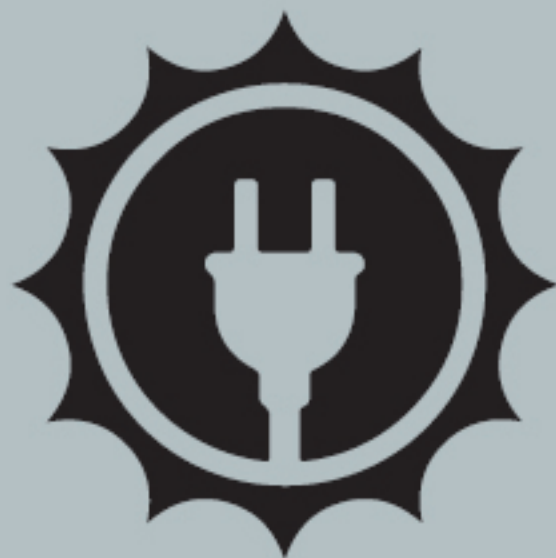

**Solar Prep**  
With wiring in place for plug-and-play solar panels and interior controls, Hideout makes it easy to add an aftermarket solar power system.



**50" HDTV with Jensen® Stereo System (select models)**  
Designed specifically for RVs, Jensen® entertainment components are strenuously tested to endure vibration, UV exposure, humidity and temperature fluctuation.

### Unbeatable Value





more product detail at  
[www.keystonerv.com/hideout](http://www.keystonerv.com/hideout)



## Slip into something a little more comfortable

From beginners to seasoned adventurers, families will enjoy the modern functionality of our newly re-designed Hideout lineup. Upgraded marbled countertops, textured-glass cabinet doors, stylish reclaimed wood-inspired flooring, residential batten ceiling strips, and garden tub with surround are just a few of the luxurious touches that simply cannot be found on most other RVs at this price point. Other new impressive features include panoramic windows in slide-boxes, hard-valance window treatments, and abundant storage in the bedroom and living area.



### Two Décor Options

Lighten up with Timber's parchment leatherette, paired with tonal window treatments and wall coverings (shown right and left) or go bold with Lodge's rich browns and dramatic accents (shown below).





# Hideout LHS

## TRAVEL TRAILERS

- **New** Furrion® glass cooktop (n/a on single-axles)
- **New** solid-look laminate, thick T-mold countertop (n/a on single axles)
- Lighted kitchen backsplash
- Lighted kitchen & entertainment center glass inserts (n/a on single axles)
- **New** panoramic main slide-out windows
- Tinted safety glass windows
- Jensen® electronics
- Central vacuum system (n/a single axles)
- Zone switch lighting
- Porcelain toilet
- Shower surround (n/a single axles)
- Smooth entrance doors with window
- Smooth baggage doors
- Solar prep (n/a single axles)
- LP bottle covers (n/a single axles)
- Voyager observation camera prep (n/a single axles)
- Floor joist 12" on center
- Cold Mountain package (slide models only)



**175LHS**

Single-axe, bunkhouse  
Weight: 3321 LBS. | Length: 21' 5"



**176LHS**

New single-axe, one slide, bunkhouse w/ roof mount a/c & 6 cu. ft. fridge  
Weight: 3735 LBS. | Length: 21' 5"



**177LHS**

Single-axe, rear dinette  
Weight: 3310 LBS. | Length: 21' 5"



**178LHS**

Single-axe, rear bath  
Weight: 3245 LBS. | Length: 21' 5"



**179LHS**

New single-axe, rear bathroom w/ roof mount a/c and 6 cu. ft. fridge  
Weight: 3720 LBS. | Length: 21' 5"



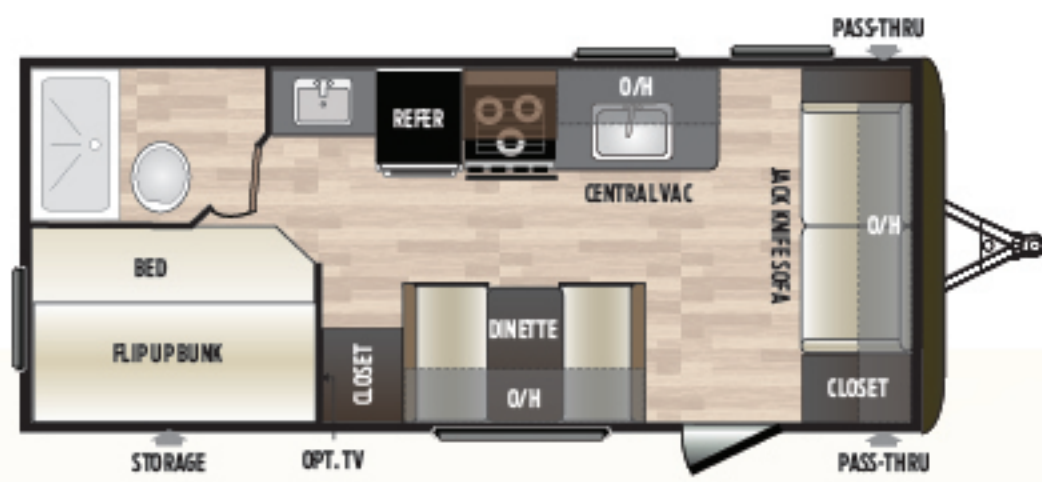

**19LHSWE** | Non-slide, double-over-double bunkhouse  
Weight: 4084 LBS. | Length: 23' 0"

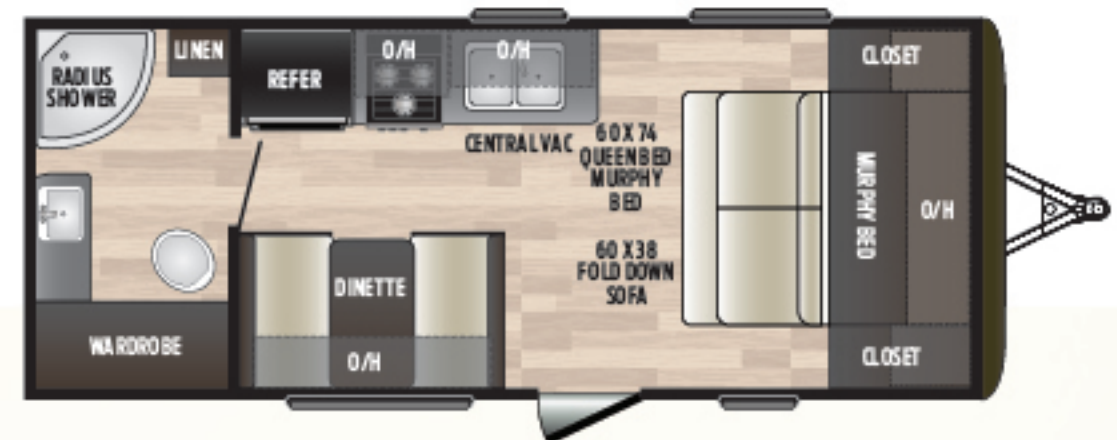

**195LHSWE** | Non-slide, rear bath, murphy bed  
Weight: 4378 LBS. | Length: TBD



**20LHSWE** | Non-slide, rear living  
Weight: 4318 LBS. | Length: 26' 2"

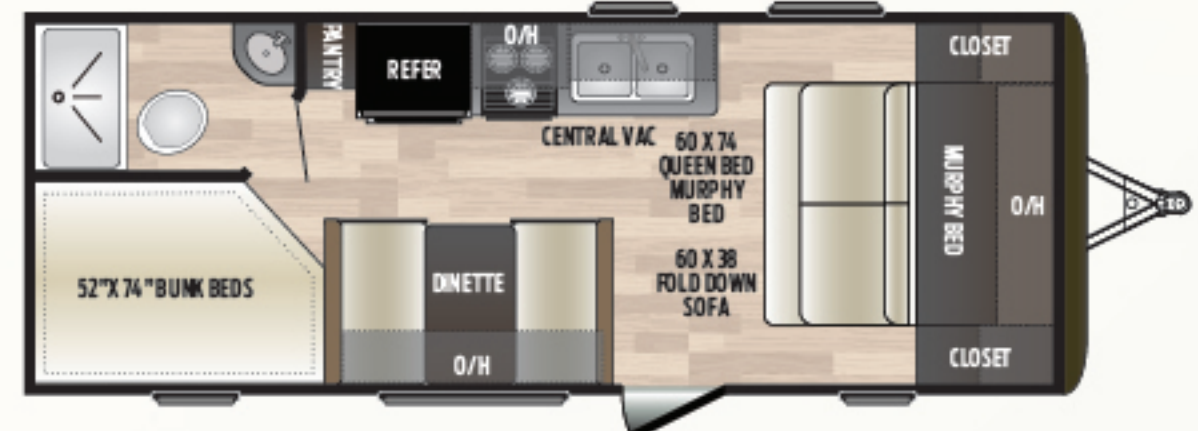

**21LHSWE** | Non-slide, double-over-double bunkhouse, murphy bed  
Weight: 4950 LBS. | Length: 25' 4"

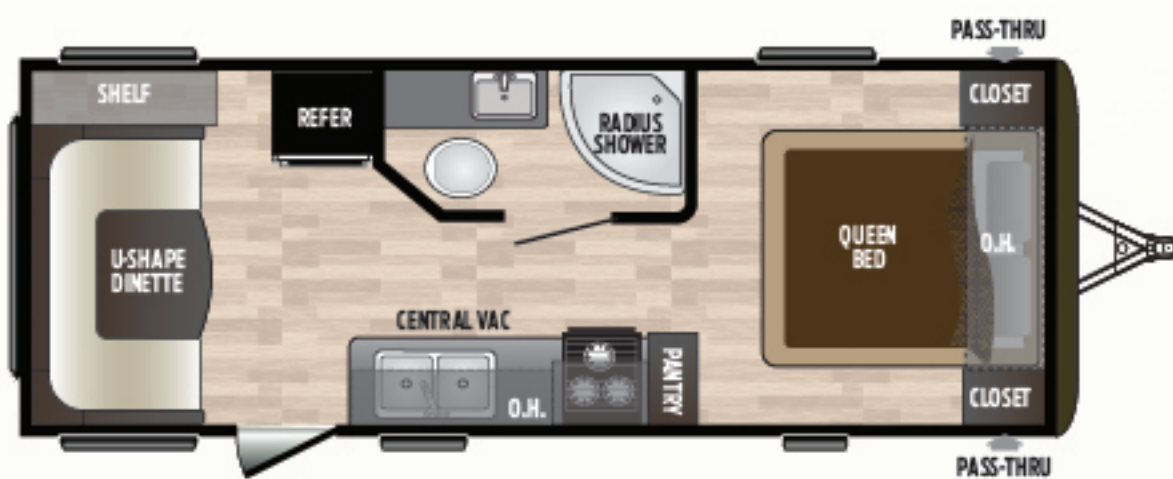

**22LHSWE** | Non-slide, rear dinette  
Weight: 4468 LBS. | Length: 26' 2"

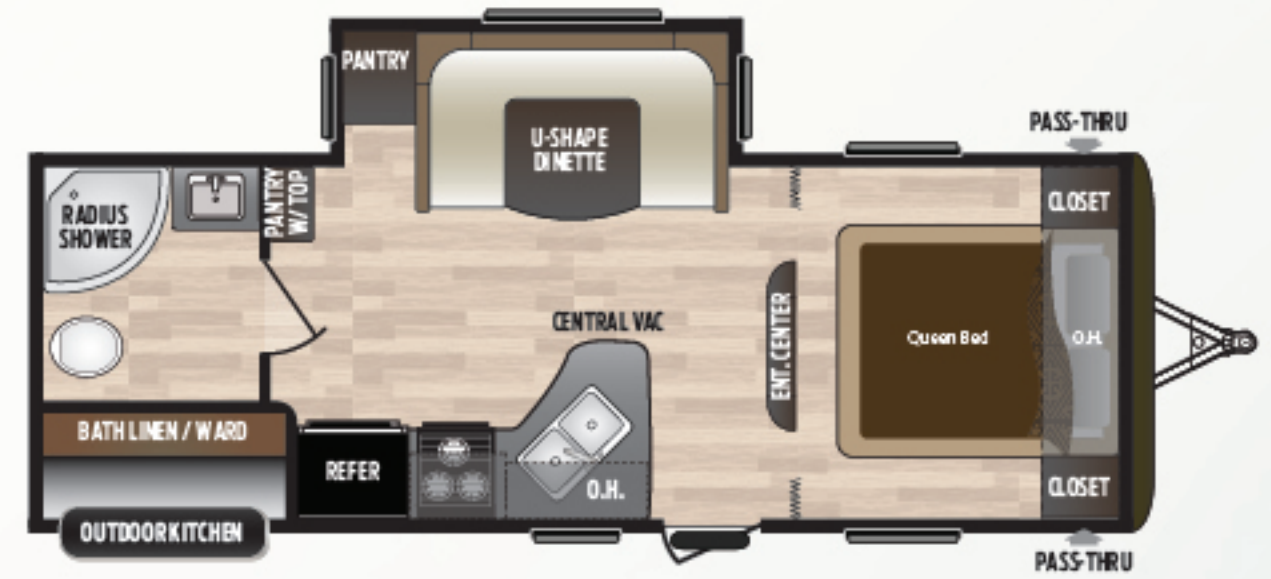

**23LHSWE** | One-slide rear bath, camp kitchen  
Weight: 5492 LBS. | Length: 27' 6"

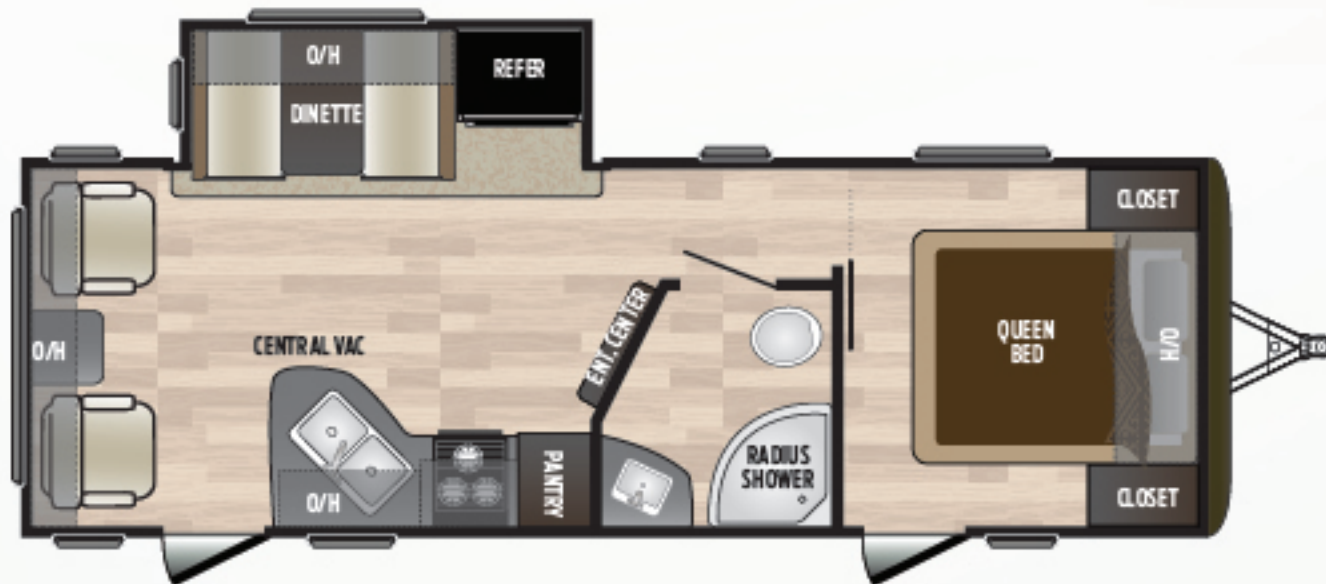

**24LHSWE** | One-slide, rear living, recliners, dual entry  
Weight: 5665 LBS. | Length: 28' 7"

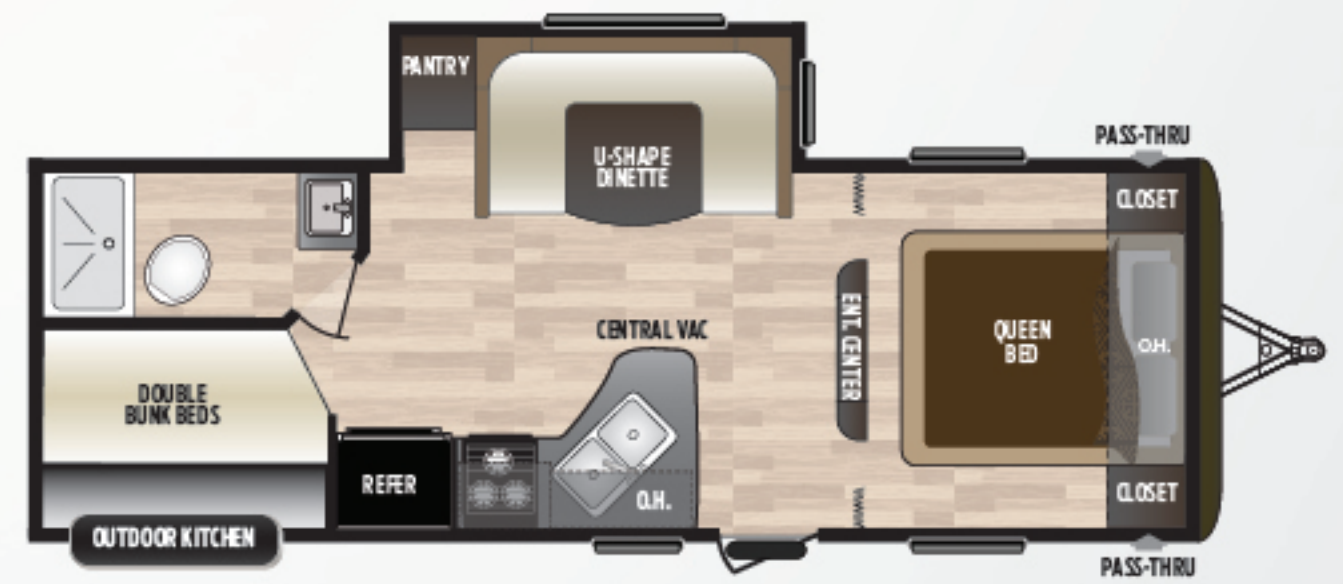

**245LHSWE** | One-slide, double-over-double bunkhouse, camp kitchen  
Weight: 5674 LBS. | Length: 28' 5"

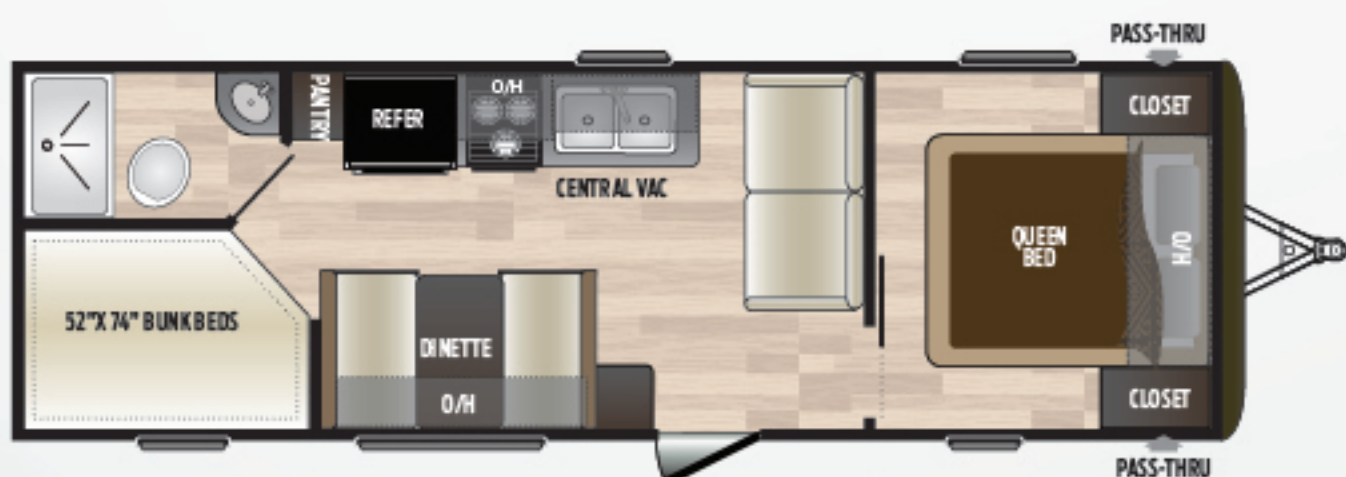

**25LHSWE** | Non-slide, double-over-double bunkhouse  
Weight: 4843 LBS. | Length: 29' 3"

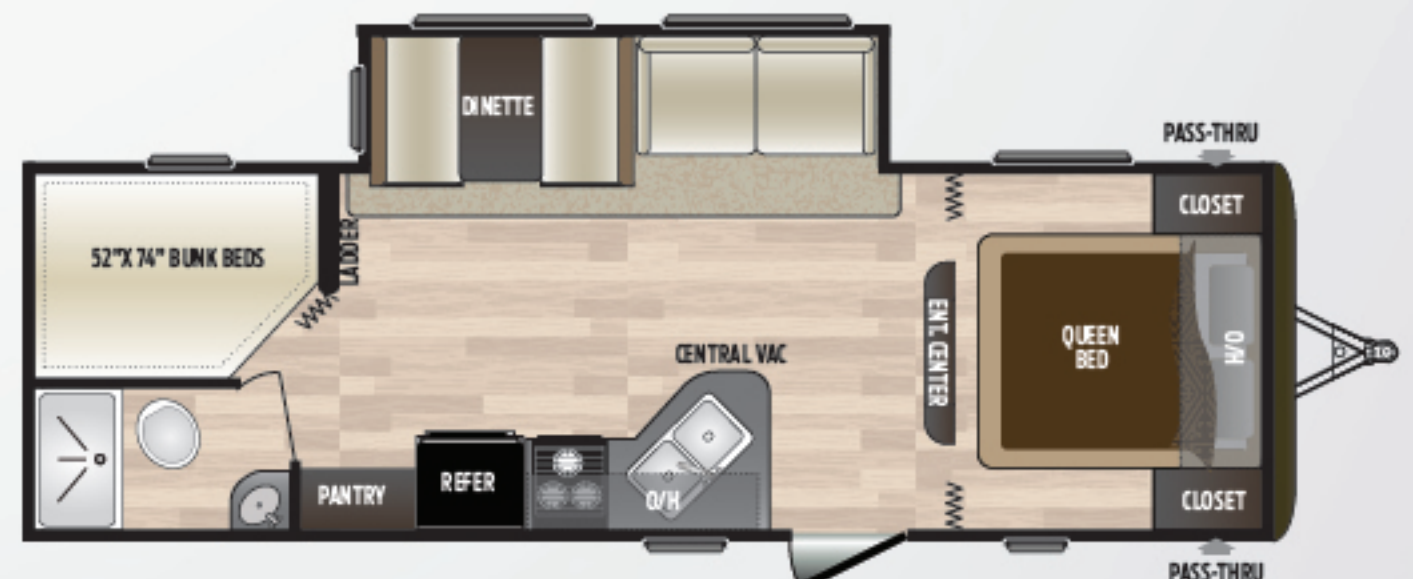

**26LHSWE** | One-slide, double-over-double bunkhouse  
Weight: 5709 LBS. | Length: 30' 0"





more product detail at  
[www.keystonerv.com/hideout](http://www.keystonerv.com/hideout)

## Hideout | LUXURY TRAVEL TRAILERS

- **New** Furrion® glass cooktop with subway tile lighted backsplash
- One piece countertops
- **New** under-mount stainless steel sink with sink covers
- Upgraded faucet with sprayer
- **New** panoramic main slide-out windows
- Tinted safety glass windows
- U-shaped dinette with “Do More” table (select models)
- 50” HDTV with Jensen® stereo (select models)
- Central vacuum system
- Zone switch lighting
- Porcelain toilet
- Ultra-stable and secure MORryde® Step Above™ steps (n/a 38’ models)
- Black tank flush
- Smooth metal front
- Smooth baggage and entry doors
- Friction-hinge door (n/a 38’ models)
- Solar prep
- Power tongue jack
- Cold Mountain Package which includes a fully enclosed underbelly
- Voyager® observation camera prep

## Worry-free Extended Season Camping

Interested in camping longer into the fall and getting out earlier in the spring? Hideout offers a Cold Mountain Package (slide models only) that makes this possible. An enclosed underbelly with forced heat helps prevent tanks from freezing when temperatures start to dip. Water lines are given an extra measure of protection by being run in your Hideout’s flooring.

Cold Mountain Package is not available on LHS or single-axle models.



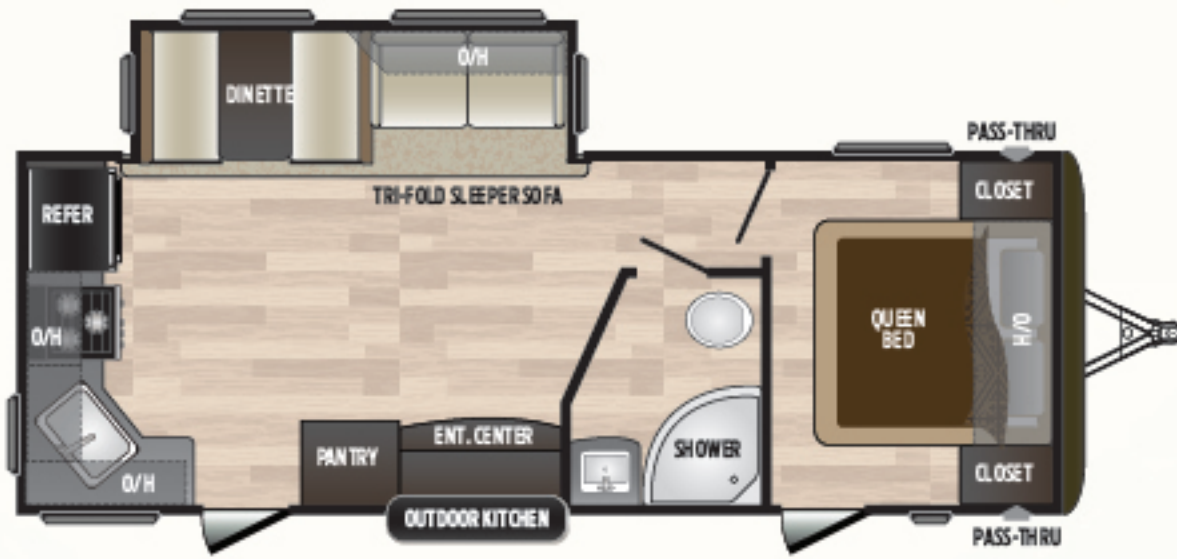

**25RKSWE** | One-slide, rear kitchen, camp kitchen  
Weight: 6021 LBS. | Length: 29'11"



**26RLSWE** | One-slide, rear living, recliners, dual entry  
Weight: 6237 LBS. | Length: 30'11"

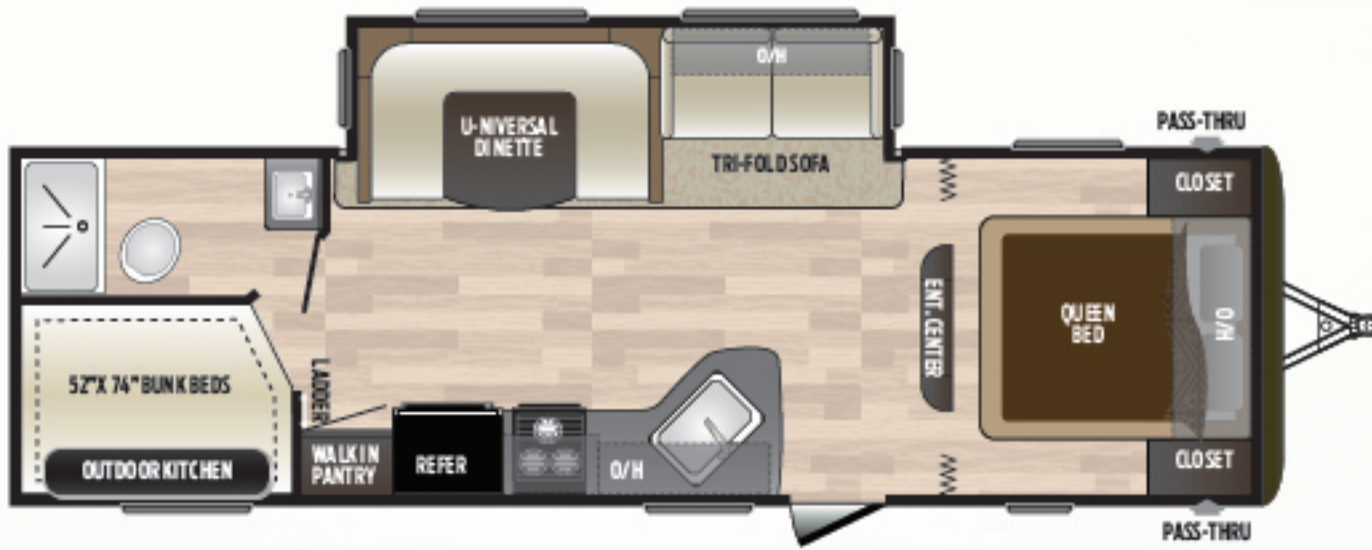

**27DBSWE** | One-slide, double-over-double bunkhouse  
Weight: 6257 LBS. | Length: 31'7"



**28BHSWE** | One-slide, double-over-double bunkhouse, dual entry, camp kitchen  
Weight: 6593 LBS. | Length: 32'8"

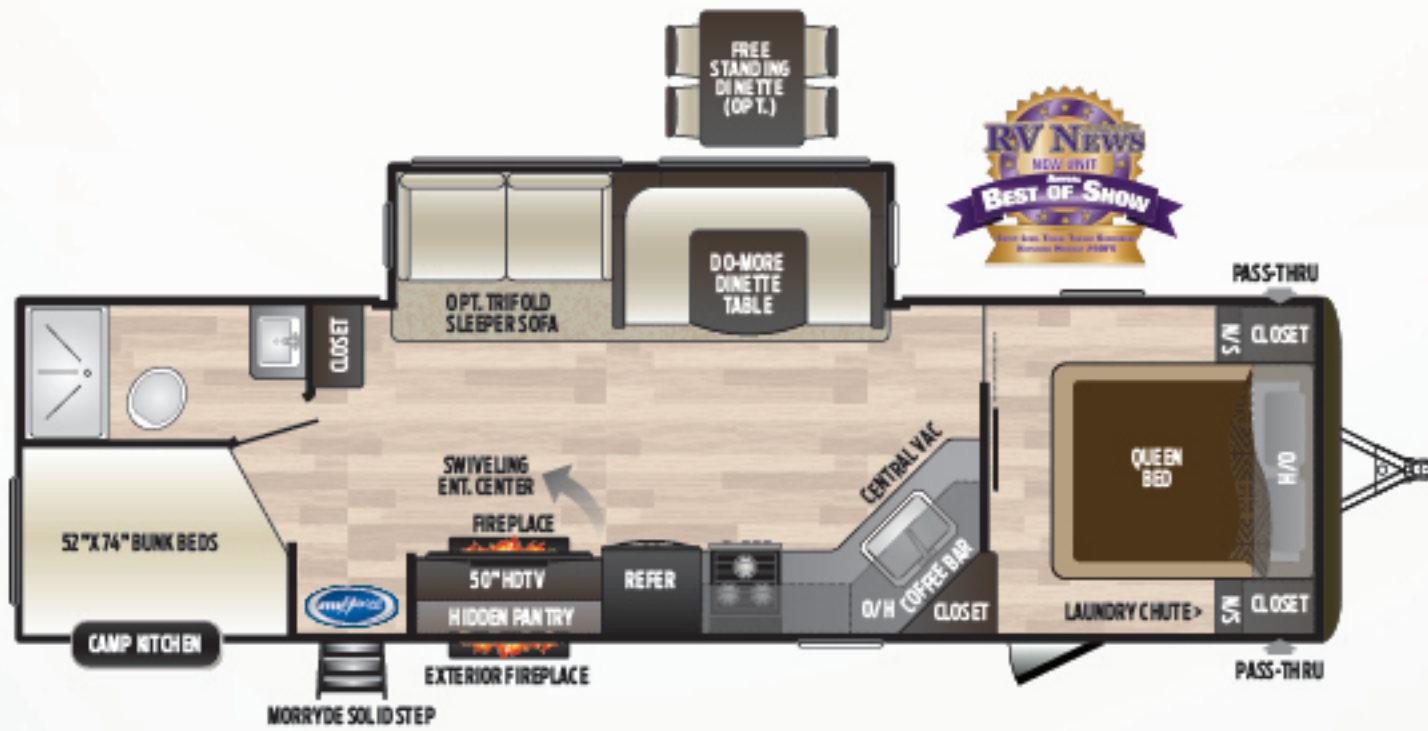

**29DFSWE** | New one-slide, double over double bunkhouse, dual fireplace hidden pantry  
Weight: TBD LBS. | Length: 33'11"



**30BHKSWE** | Two-slide, private bunkhouse, island kitchen, camp kitchen  
Weight: 7256 LBS. | Length: 34'11"



**31BHDSWE** | Two-slide, private bunkroom, camp kitchen  
Weight: 7375 LBS. | Length: 34'11"



- **New** Furrion® glass cooktop with subway tile lighted backsplash
- **New** under-mount stainless steel sink with sink covers
- Upgraded faucet with sprayer
- **New** panoramic main slide-out windows
- Tinted safety glass windows
- U-shaped dinette with "Do More" table (select models)
- 50" HDTV with Jensen® stereo (select models)
- Zone switch lighting
- Ultra-stable and secure MORryde® Step Above™ steps (n/a 38' models)

- Smooth metal front
- Smooth baggage and entry doors
- Friction-hinge door (n/a 38' models)
- Voyager® observation camera prep
- Porcelain toilet
- Black tank flush
- Central vacuum system

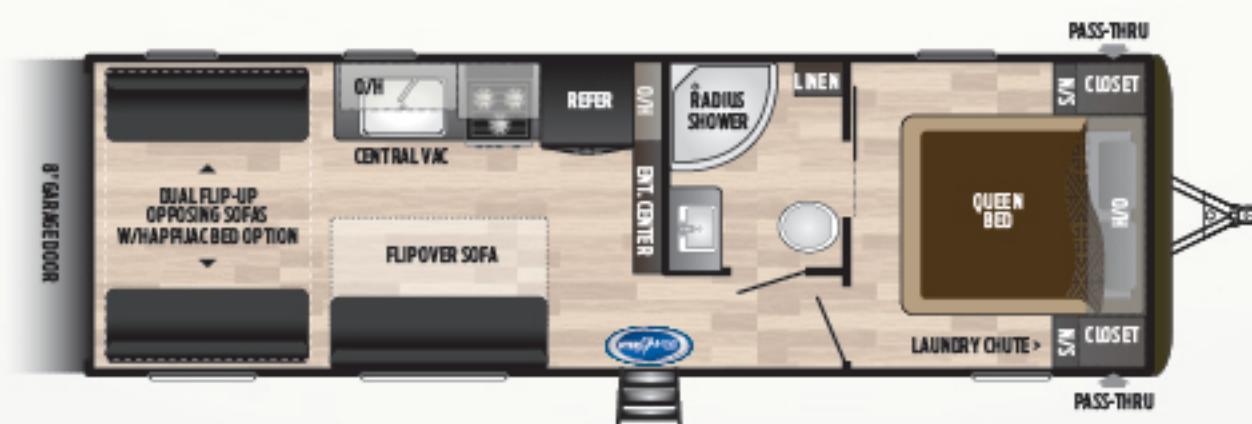

**25TH** | New non-slide, toy hauler w/ happyjac in rear  
Weight: 6190 LBS. | Length: 29' 11"

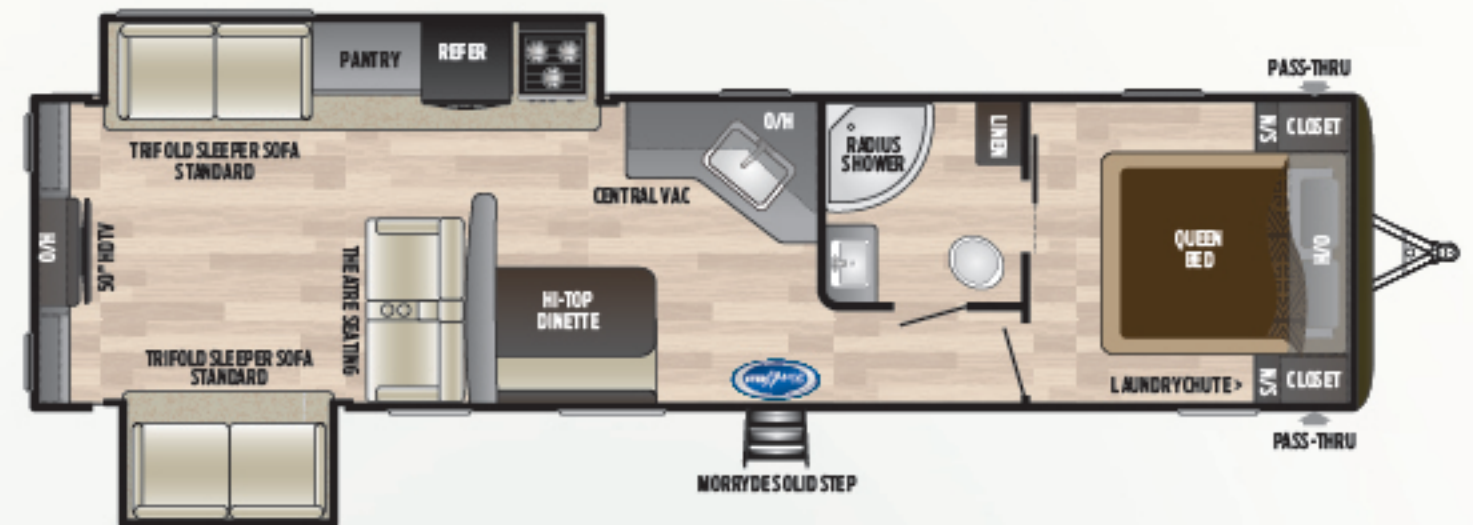

**32RDDS** | New two-slide, rear living room w/ theatre seating & built in dinette, opposing tri-fold sofas, 50" HDTV  
Weight: 7880 LBS. | Length: 36' 8"

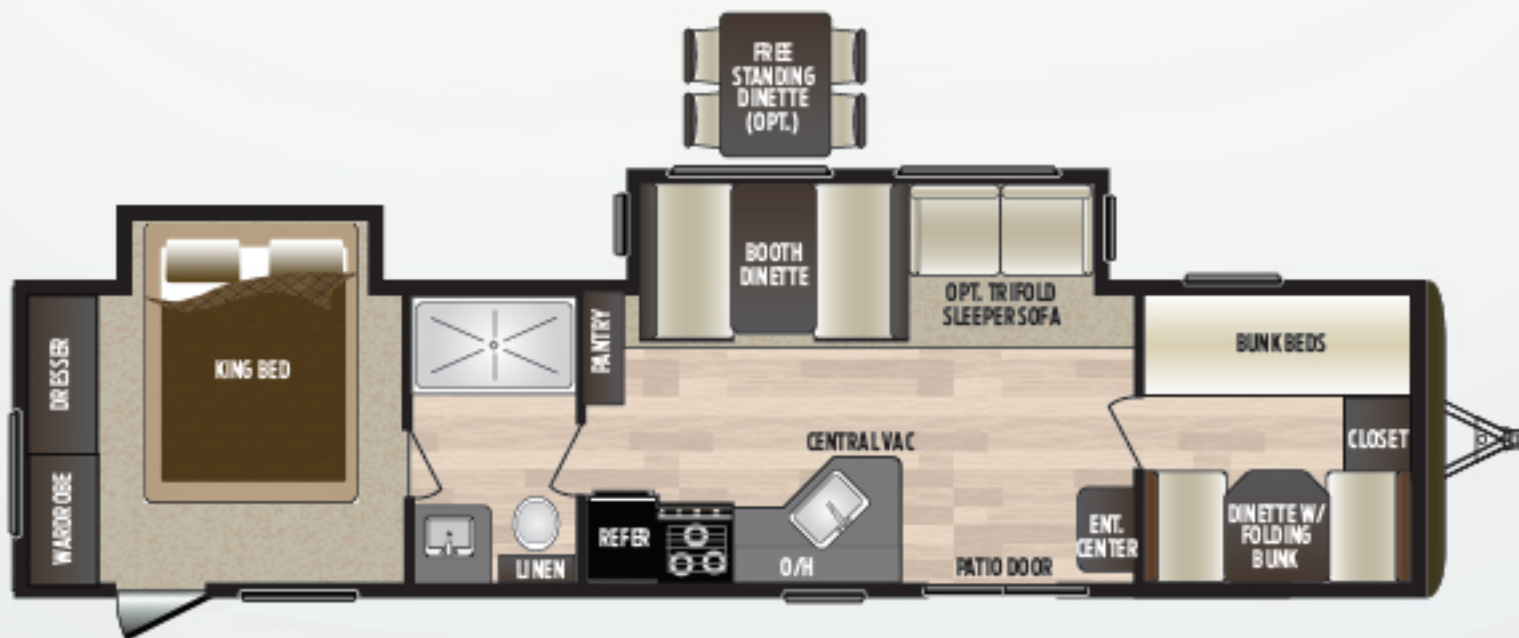

**38BHDS** | Two-slide w/ bed slide, bunkhouse, residential refrigerator, patio door  
Weight: 8312 LBS. | Length: 39' 11"

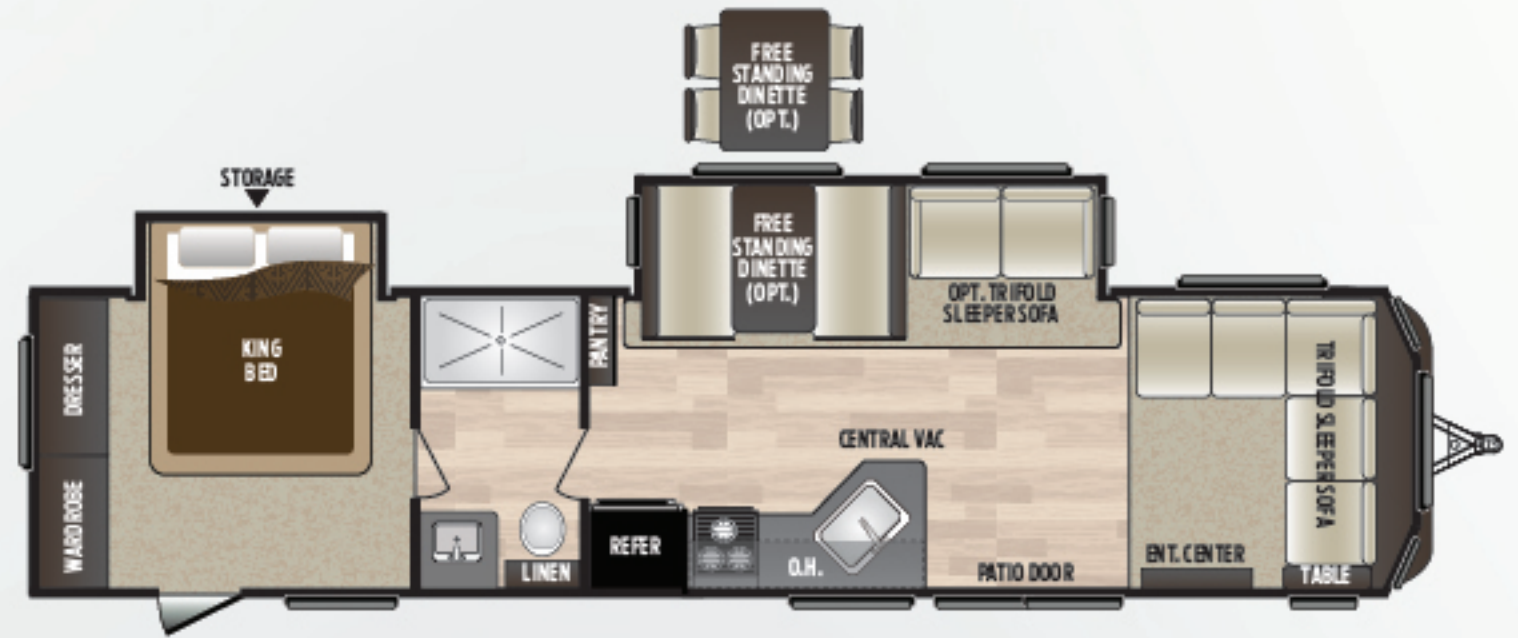

**38FDDS** | Two-slide w/ bed slide, front sectional, residential refrigerator, patio door  
Weight: 8355 LBS. | Length: 39' 11"

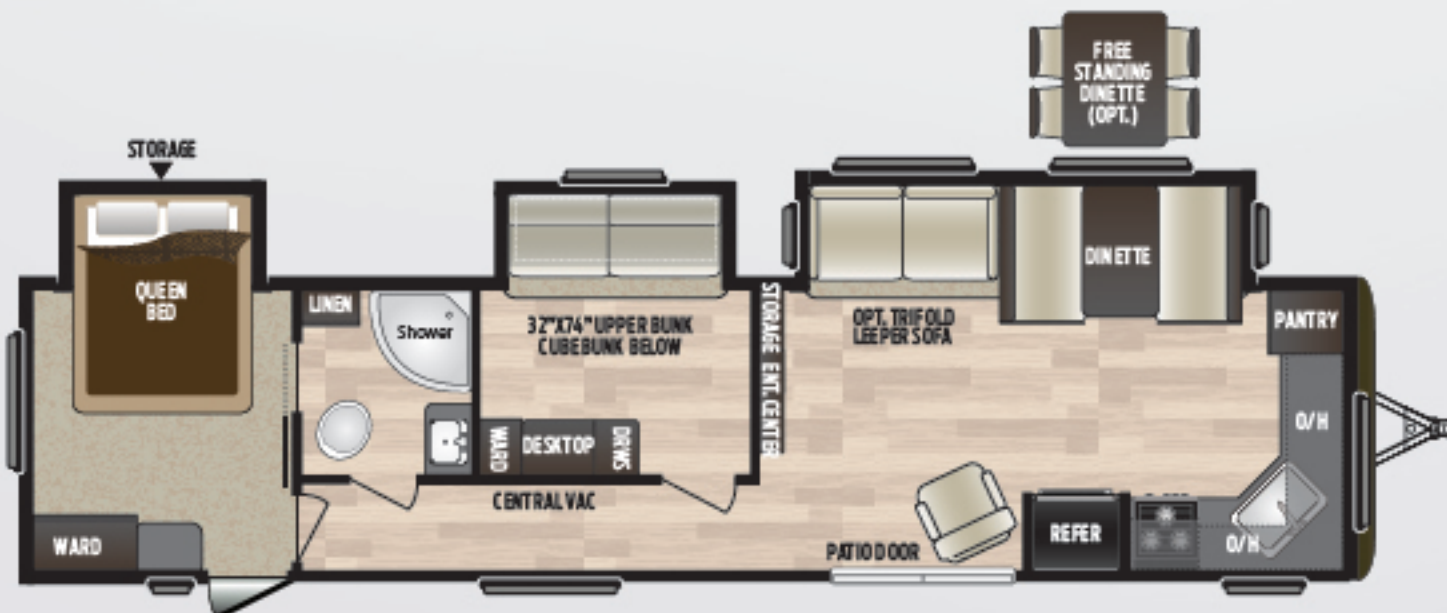

**38FKTS** | Three-slide w/ bed slide, mid-bunkhouse, residential refrigerator, patio door  
Weight: 9166 LBS. | Length: 39' 11"

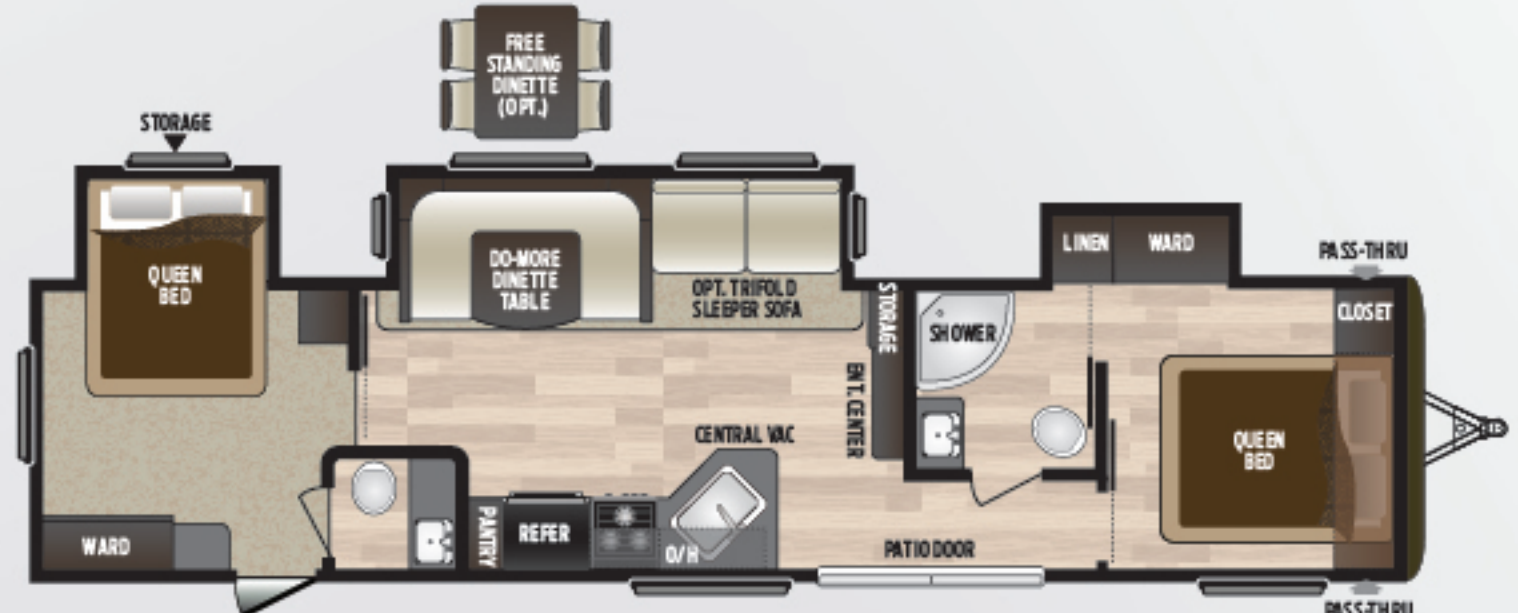

**38FQTS** | Three-slide w/ bed slide, double queen bedroom, bath & a half, residential refrigerator, patio door  
Weight: 9253 LBS. | Length: 39' 11"



- **New** Furrion® glass cooktop with subway tile lighted backsplash
- One piece countertops
- **New** under-mount stainless steel sink w/ sink covers
- U-shaped dinette with "Do More" table
- New panoramic windows in main slide-out
- 50" HDTV with Jensen® stereo (select models)
- Tri-fold sofa, standard
- Central vacuum system
- Porcelain toilet

- Zone switch lighting
- Skylight with shade
- Ultra-stable and secure MORryde® Step Above™ steps
- Black tank flush
- Fiction-hinge door
- Solar prep
- Electric stab jacks
- Aluminum wheels
- Voyager observation camera prep
- Patented Hitch Vision™ for faster and easier hook-up

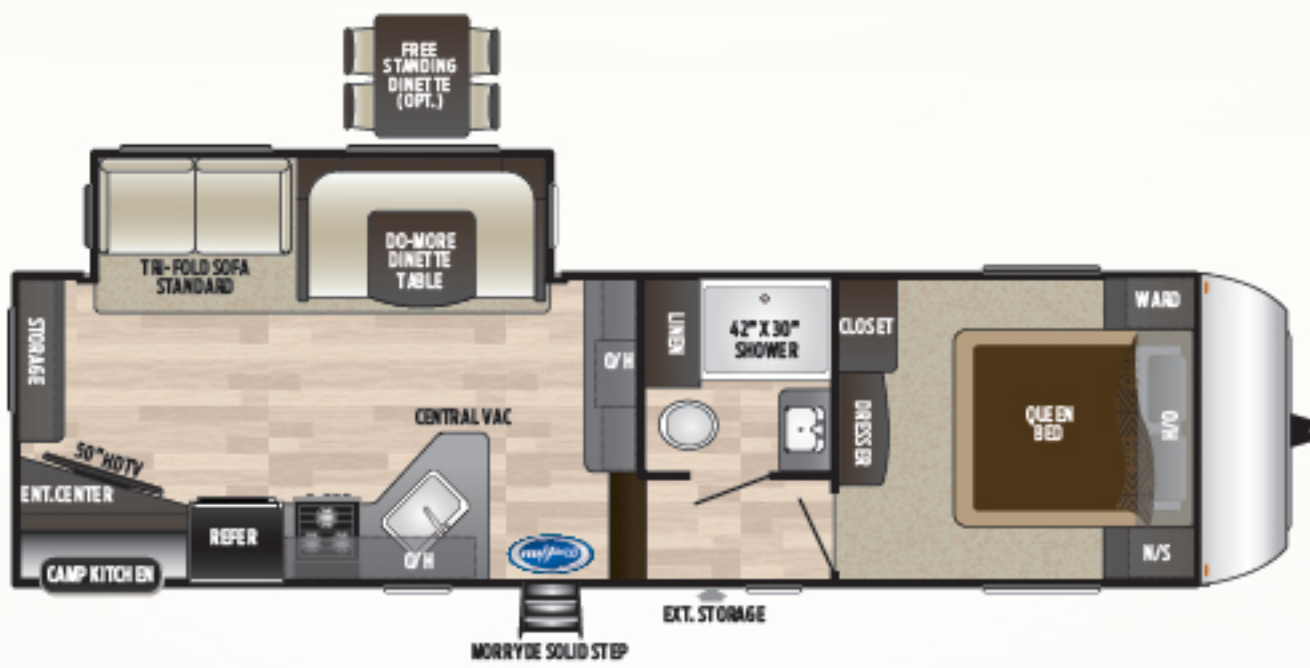

**262RES** One-slide, rear entertainment, camp kitchen, re-designed bedroom  
Weight: 8025 LBS. | Length: 30'11"

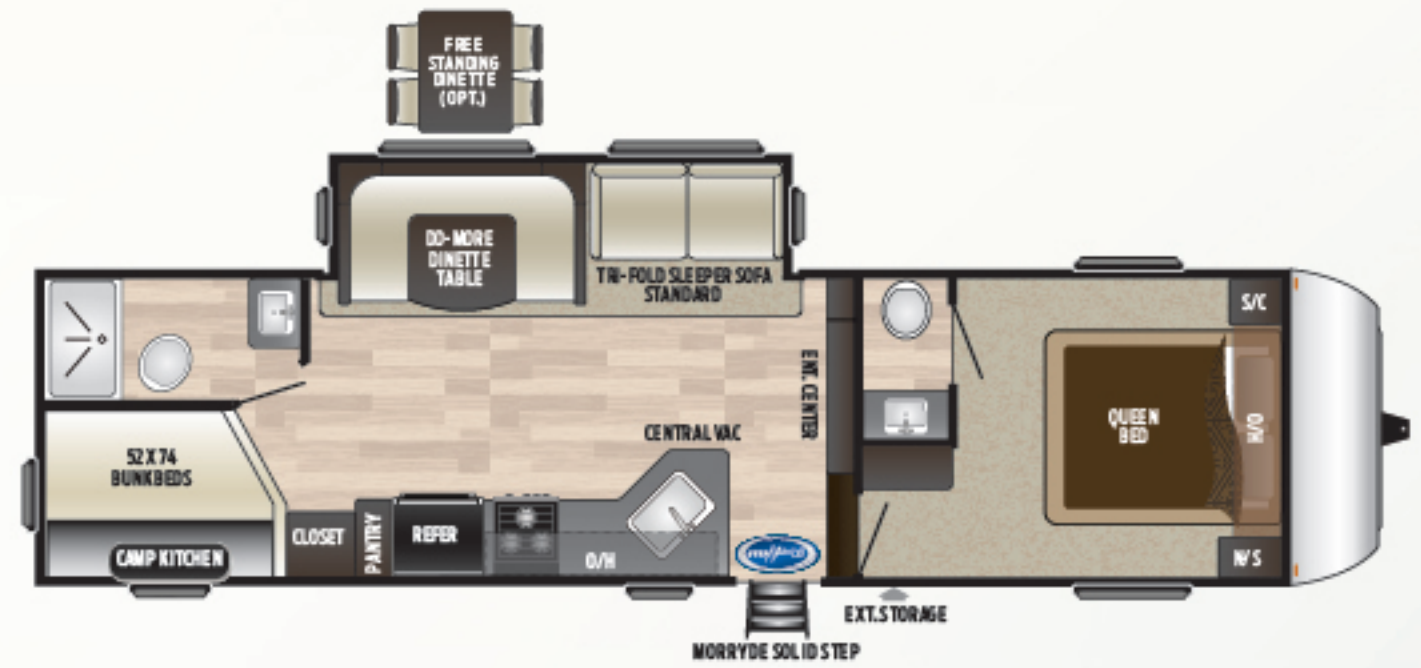

**281DBS** One-slide bunkhouse, camp kitchen, bath & a half, re-designed bedroom  
Weight: 8115 LBS. | Length: 32'4"



**292MLS** One-slide, rear kitchen, camp kitchen, re-designed bedroom  
Weight: 8435 LBS. | Length: 33'7"

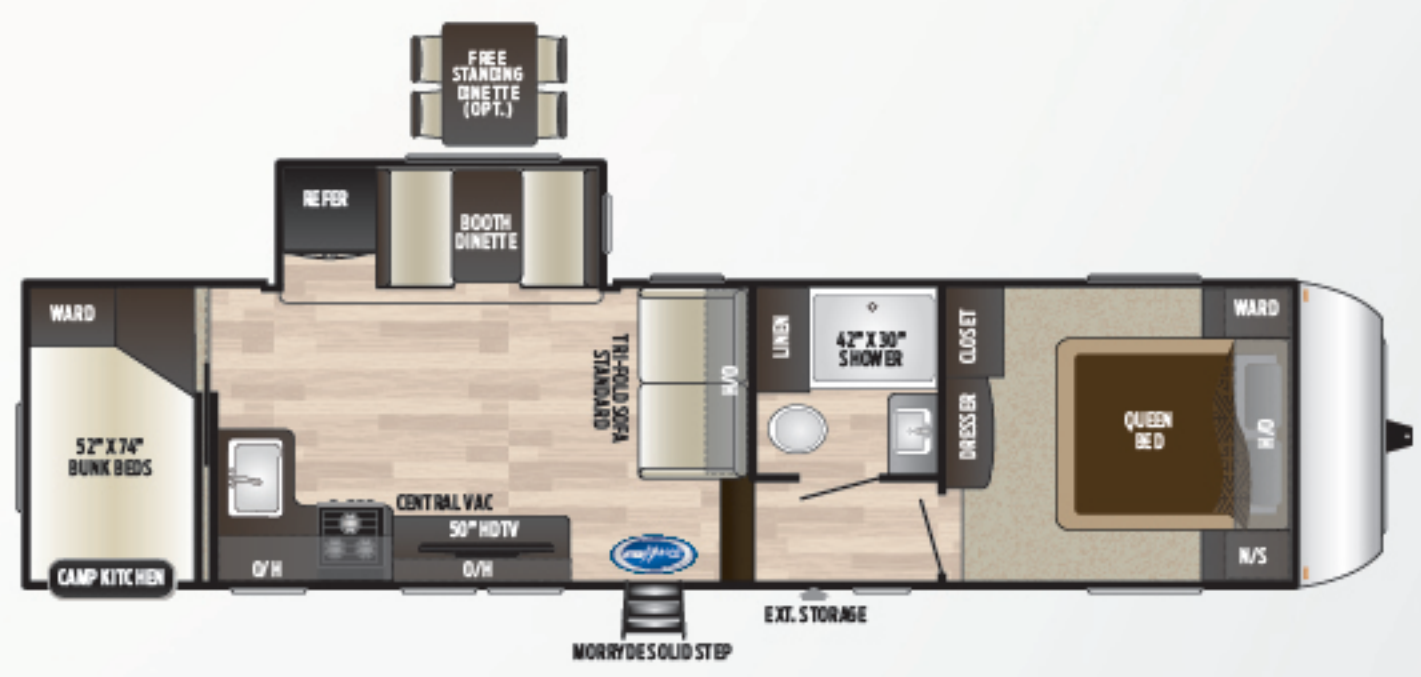

**295BHS** New one-slide, double over double bunkhouse, camp kitchen, re-designed bedroom  
Weight: 8505 LBS. | Length: 33'11"

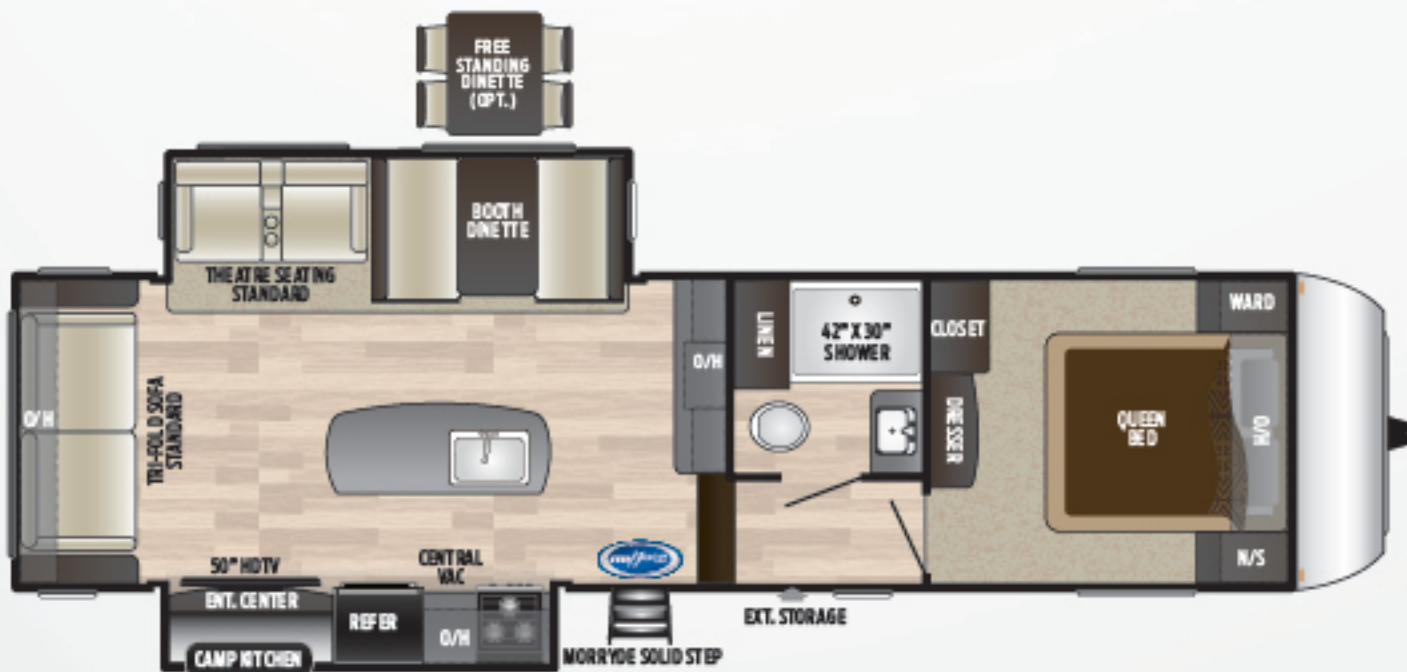

**299RLDS** Two-slide, rear entertainment, island kitchen, camp kitchen, re-designed bedroom  
• Weight: 9020 LBS. | Length: 33'0"



**308BHDS** Two-slide, bunkhouse, bath & a half, camp kitchen, re-designed bedroom  
• Weight: 9115 LBS. | Length: 35'6"



### LHS TRAVEL TRAILERS & SINGLE AXLES

MODEL	WEIGHT	CARRYING CAPACITY	HITCH	FRESH WATER	WASTE WATER	GRAY WATER	LPG	LENGTH*	HEIGHT
19LHSWE	4084	2716	478	60	40	40	60	23' 0"	11' 0"
195LHSWE	4378	2622	506	60	40	40	40	23' 10"	11' 0"
20LHSWE	4318	2882	464	60	38	38	40	24' 11"	11' 0"
21LHSWE	4412	2588	538	60	40	40	60	25' 4"	11' 0"
22LHSWE	4468	2732	458	60	38	40	60	26' 2"	11' 0"
23LHSWE	5492	2098	592	60	38	38	60	27' 6"	10' 3"
24LHSWE	5665	1955	620	60	38	38	60	28' 7"	10' 6"
245LHSWE	5674	1966	644	60	38	78	60	28' 5"	11' 3"
25LHSWE	4843	2657	530	60	38	38	60	29' 3"	11' 1"
26LHSWE	5709	1911	620	60	38	40	60	30' 0"	10' 3"
175LHS	3321	1079	485	27	30	30	20	21' 5"	10' 2"
176LHS	3735	765	520	27	30	30	20	21' 5"	10' 2"
177LHS	3310	1090	540	27	30	30	20	21' 5"	10' 2"
178LHS	3245	1195	440	27	30	32	20	21' 5"	10' 2"
179LHS	3720	760	480	27	32	30	20	21' 5"	10' 2"

### LUXURY TRAVEL TRAILERS

MODEL	WEIGHT	CARRYING CAPACITY	HITCH WEIGHT	FRESH WATER	WASTE WATER	GRAY WATER	LPG	LENGTH*	HEIGHT
25RKSWE	6021	1579	694	60	38	78	60	29' 11"	11' 3"
26RLSWE	6237	1505	742	60	38	38	60	30' 11"	11' 3"
27DBSWE	6257	1473	730	60	38	78	60	31' 7"	11' 3"
28BHSWE	6593	3027	820	60	38	78	60	32' 8"	11' 0"
29DFSWE	TBD	TBD	TBD	60	38	76	40	33' 11"	11' 0"
30BHSWE	7256	2492	948	60	38	38	60	34' 11"	10' 10"
31BHDSWE	7375	2305	880	60	38	38	60	34' 11"	10' 10"

### EASTERN BUILD TRAVEL TRAILERS

MODEL	WEIGHT	CARRYING CAPACITY	HITCH WEIGHT	FRESH WATER	WASTE WATER	GRAY WATER	LPG	LENGTH*	HEIGHT
25TH	6190	3510	880	43	39	39	40	29' 11"	11' 3"
32RDDS	7880	1890	970	43	39	39	40	36' 8"	11' 2"
38BHDS	8312	1658	1170	43	39	39	60	39' 11"	11' 2"
38FDDS	8355	1645	1205	43	39	39	60	39' 11"	11' 2"
38FKTS	9166	1834	1200	43	39	78	60	39' 11"	11' 4"
38FQTS	9253	2107	1200	43	78	78	60	39' 11"	11' 4"

### FIFTH WHEELS

MODEL	WEIGHT	CARRYING CAPACITY	HITCH WEIGHT	FRESH WATER	WASTE WATER	GRAY WATER	LPG	LENGTH*	HEIGHT
262RES	8025	2475	1605	43	39	78	60	30' 11"	12' 4"
281DBS	8115	2485	1670	43	69	30	60	32' 4"	12' 4"
292MLS	8435	2565	1510	43	39	78	60	33' 7"	12' 5"
295BHS	8505	2495	1700	43	39	78	60	33' 11"	12' 5"
299RLDS	9020	2180	1605	43	39	78	60	33' 0"	12' 5"
308BHDS	9115	2585	1820	43	78	39	60	35' 6"	12' 5"

DISCLAIMER: Product information is as accurate as possible as of the date of publication of this brochure. All features, floor plans, and specifications in this brochure are subject to change without notice. Please also consult Keystone's web site at [www.keystonerv.com](http://www.keystonerv.com) for more current product information and specifications. Tow Vehicle Disclaimer. CAUTION: Owners of Keystone recreational vehicles are solely responsible for the selection and proper use of tow vehicles. All customers should consult with a motor vehicle manufacturer or their dealer concerning the purchase and use of suitable tow vehicles for Keystone products. Keystone disclaims any liability or damages suffered as a result of the selection, operation, use or misuse of a tow vehicle. KEYSTONE'S LIMITED WARRANTY DOES NOT COVER DAMAGE TO THE RECREATIONAL VEHICLE OR THE TOW VEHICLE AS A RESULT OF THE SELECTION, OPERATION, USE OR MISUSE OF THE TOW VEHICLE. \*Length is defined as the distance from the centerline of hitch pin/coupler to rear bumper of trailer. Please review owner's manual prior to purchase for more information on service warranties, extended use, towing and maintenance. Owner's manuals can be found at [keystonerv.com](http://keystonerv.com).



	TT	FW	LHS TT	SINGLE
<b>EXTERIOR</b>				
HIDEOUT PATENTED HITCH VISION™	-	\$	-	-
GEL COATED MAXTURN FIBERGLASS FRONT CAP	-	\$	-	-
ELECTRIC ADJUSTABLE FRONT LANDING GEAR	-	\$	-	-
DIAMOND PLATE	\$	-	\$	\$
LIGHTED ADJUSTABLE POWER AWNING	\$	\$	\$	\$
BLACK TANK FLUSH	\$	\$	\$	-
OUTSIDE 110 RECEPTACLE	\$	\$	\$	\$
E-COATED WHEELS	\$	-	\$	\$
XL ENTRY ASSIST HANDLE	\$	\$	-	-
EXTERIOR TV HOOKUP/CABLE & BRACKET	\$	\$	\$	-
COLD MOUNTAIN PACKAGE	\$	\$	-	-
POWDER COATED I-BEAM FRAME	-	\$	-	\$
EASY LUBE AXLES	\$	\$	\$	\$
FULL LENGTH OUTRIGGERS	\$	\$	\$	\$
DUAL BATTERY RACK	\$	\$	\$	-
EXTERIOR SPEAKERS	\$	\$	\$	\$
BLACK RADIUS WINDOW FRAMES	\$	\$	\$	\$
TV ANTENNA WITH BOOSTER	\$	\$	\$	\$
CABLE HOOKUP	\$	\$	\$	\$
FULL WALK ON ROOF	\$	\$	\$	-
RADIUS ENTRY DOORS W/INTEGRATED STRUTS	\$	\$	\$	\$
OVERSIZED PASS-THRU STORAGE	\$	\$	\$	\$
HOSE STORAGE IN THE BUMPER	\$	\$	\$	\$
RAIN GUTTERS WITH DOWN SPOUTS	\$	\$	\$	\$
TRU-FIT FIVE POINT SLIDE ROOM CONSTRUCTION	\$	\$	\$	\$
SOLAR PREP	\$	\$	\$	-
BACKUP CAMERA PREP	\$	\$	\$	-
ROTO-CAST SEAMLESS HOLDING TANKS	\$	\$	\$	\$
HURRICANE STRAPS REINFORCED STRUCTURE	\$	\$	\$	\$
FOUR HEAVY DUTY STABILIZER JACKS	\$	\$	\$	\$
RADIAL TIRES	\$	\$	\$	\$
CAMBERED CHASSIS	\$	\$	\$	\$
96" EXTERIOR WIDTH	\$	\$	\$	\$
EXTERIOR SHOWER	\$	\$	\$	-
SPARE TIRE AND CARRIER	0	0	0	\$
REAR LADDER (MOST MODELS)	\$	0	-	-

TT Hideout Luxury Travel Trailers  
 FW Hideout Luxury Fifth Wheels  
 LHS TT LHS Travel Trailers  
 SINGLE LHS Single Axle Travel Trailers

**\$** STANDARD    **0** OPTIONAL    **-** NOT AVAILABLE

	TT	FW	LHS TT	SINGLE
<b>INTERIOR</b>				
TRI-FOLD SLEEPER SOFA (MEGA SLIDES)	0	\$	-	-
FREESTANDING DINETTE (SELECT MODELS)	0	0	-	-
PLEATED SHADES IN LIVING AREA	\$	\$	\$	-
FULL STRUTTED STORAGE UNDER MASTER BED	\$	\$	-	-
HD LED TV	0	\$	0	-
INTERIOR SURROUND SOUND SPEAKERS	\$	\$	\$	\$
BLUETOOTH DVD/CD/MP3 STEREO	\$	\$	\$	-
AM/FM W/MP3/BLUETOOTH	-	-	-	\$
MICROWAVE	\$	\$	\$	\$
MONITOR PANEL	\$	\$	-	-
6 CU. FT. REFRIGERATOR / FW- 8 CU. FT.	\$	\$	\$	-
RESIDENTIAL REFRIGERATOR (38BHDS, 38FDDS, 38FKTS, 38FQTS ONLY)	\$	-	-	-
BALL BEARING DRAWER GUIDES	\$	\$	\$	\$
12 VOLT 55 AMP CONVERTER	\$	\$	\$	-
15,000 BTU AIR CONDITIONER	-	0	-	-
13,500 BTU AIR CONDITIONER	\$	\$	\$	0
8K BTU AIR CONDITIONER	-	-	-	\$
BUILT-IN 30,000 BTU FURNACE	\$	\$	\$	-
20K BTU FURNACE	-	-	-	\$
3 CU. FT. GAS/ELECTRIC REFER	-	-	-	\$
GAS/ELECTRIC DSI WATER HEATER	\$	\$	\$	-
FLEX PEX TUBING WITH 10-YEAR WARRANTY	\$	\$	\$	\$
78" INTERIOR HEIGHT	\$	-	\$	-
TUB SURROUND	\$	\$	\$	-
PORCELAIN FOOT FLUSH TOILET	\$	\$	\$	\$
RG6 CABLE AND SATELLITE WIRING	\$	\$	\$	\$
4 1/2" CROWNED ROOF	\$	\$	\$	\$
RANGE WITH HI-OUTPUT BURNER	\$	\$	\$	\$
COLOR CODED LOOMED WIRING	\$	\$	\$	\$
FURRIOR® GLASS TOP OVEN	\$	\$	\$	-
REVERSIBLE DINETTE CUSHIONS	\$	\$	\$	\$
HIGH-RISE KITCHEN FAUCET	\$	\$	\$	\$
<b>SAFETY</b>				
FIRE EXTINGUISHER	\$	\$	\$	\$
SMOKE DETECTOR	\$	\$	\$	\$
LP DETECTOR	\$	\$	\$	\$
CO DETECTOR	\$	\$	\$	\$
SAFETY CHAINS	\$	\$	\$	\$
EMERGENCY BREAKAWAY SWITCH	\$	\$	\$	\$



# BUILT FOR THE LONG HAUL



PRINT 1.2019



**Keystone RV  
Company**