

Impact

TOY HAULERS

FIFTH WHEELS

TRAVEL TRAILERS

WORK HARD
PLAY
HARDER



The ultimate ownership experience.

The goal of Keystone RV Company is to surprise and delight our owners at each and every touchpoint. We're happy when our campers are happy, and we are committed to providing the very best ownership experience in the industry.



**Keystone RV
Company**

1 EASIER SHOPPING.

At Keystone, we make choosing an RV as easy as finding the Big Dipper on a dark summer night. With comprehensive online product information, Key Connect™ product advisors, and an unparalleled dealer network, we will help you select the perfect RV for your family's adventure.

2 INNOVATIVE THINKING.

The road's a nicer place when you have the industry's smartest features behind you. Keystone leads the pack in patented innovations that make our RVs safer, more comfortable, and easier to operate.

3 LONG HAUL QUALITY.

To keep you on the road, there are certain things we just won't build a Keystone RV without. Game-changing features like our Unified Wiring Standard, Tru-Fit™ five-point slide construction, and no-fail Tuf-Lok™ A/C duct joiners combined with exhaustive testing and inspections are some of the reasons why Keystone is able to offer our owners the industry's best 3-year limited structural warranty.

4 WORRY-FREE CUSTOMER SERVICE.

Wherever the road takes you, you're never too far from an authorized Keystone service center. We also offer live service assistance, ultra-fast parts shipping, online maintenance tips and tricks, and a single-point warranty claims policy. *That's* peace of mind.

5 KEYSTONE NATION.

When you choose Keystone, you become a part of one of the largest camping families in the country. We're Keystone Nation. A friendly community where people share photos, travel tips and amazing stories – all in the spirit of camaraderie and adventure. Come join us.

Experience the Impact lifestyle by visiting [#keystoneimpact](#)



Keystone EXCLUSIVE Innovations

Year after year, Keystone RV's experienced team delivers Built For the Long Haul quality you expect and exclusive innovations you won't find anywhere else.



3-year Limited Structural Warranty, 1-year Limited Base Warranty

Every new Keystone RV comes with the industry's best three-year limited structural warranty AND a one-year limited base warranty. Ask your dealer, visit keystonerv.com, or call Keystone owner relations for details.



KeyTV™

Game-changing single-point control of over-the-air, cable and satellite feeds.



Color-Coded Wiring

Easy-to-trace circuits simplify electrical and entertainment system troubleshooting.



4G LTE and Wi-Fi Prep

All units are equipped with a new Furrion® antenna that integrates 4G LTE and Wi-Fi with standard VHF/UHF/AM/FM reception.



In-Floor Heating Ducts

Ducting allows for more airflow that distributes heat evenly for optimal comfort.

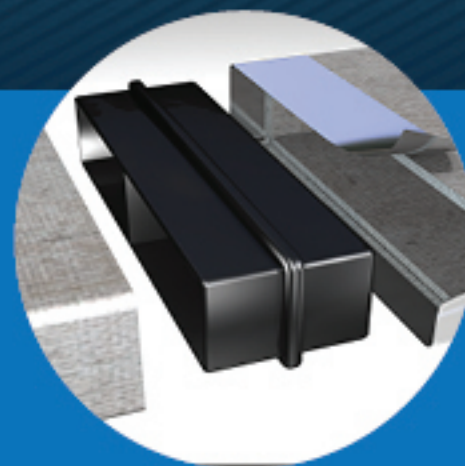

Tuf-Lok™ A/C Duct Joiners

Crush resistant design securely joins A/C ductwork, drastically reducing chilled-air leaks and boosting cooling efficiency and comfort.



Tru-fit™ slide Construction

A more durable slide room design that minimizes functional motor and structural stress, resists leaking.

IMPACT



FIFTH WHEELS | TRAVEL TRAILERS

It's where you play that matters most.

Get ready to gear-up with Keystone RV's Impact toy haulers. Impact offers weekend warriors a lineup of shorter toy haulers, lightweight travel trailers, and fifth wheels—all with the same robust construction as the brand's big brother, Keystone's Fuzion. Focused on providing the most value for your dollar, Impact makes it easy for you to get out and play.

For more information, please visit keystonerv.com/impact

Power Performance

Innovative tech and robust construction that allows your Impact to play harder than the competition.

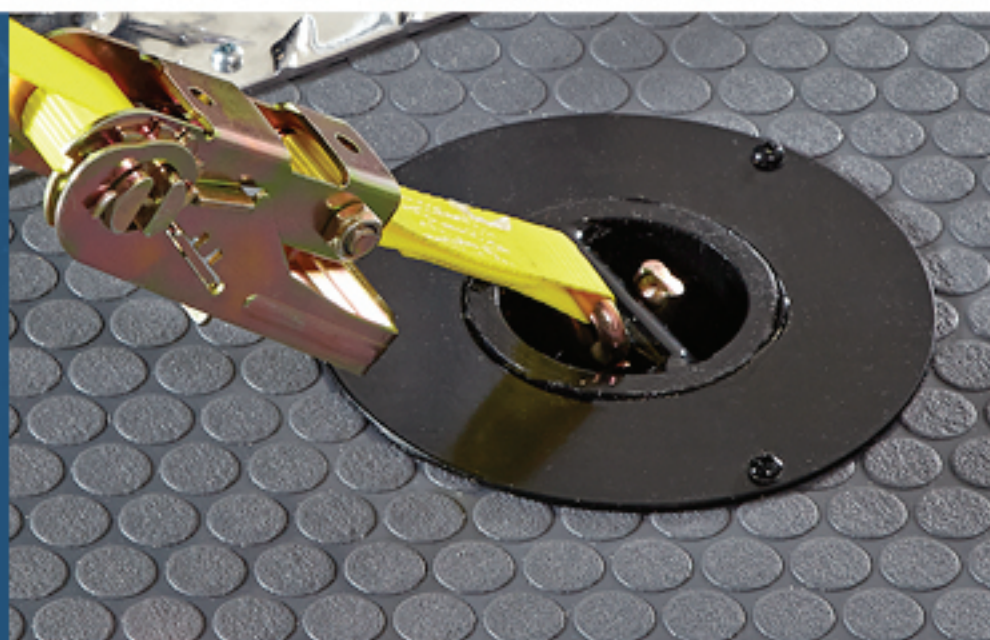

5K Interlock Tie-Down System
Industry-leading 5,000 lb. capacity tie-downs for increased safety & security.



G-Rated Tires on Fifth Wheel Trailers
Tow your toys confidently with higher ply, heavy duty tires.



30-Gallon Fuel Station
Built-in fueling for more hours of play.



Dexter Axles w/ Electric Self Adjusting Brakes
Equipped with U.S. made, heavy-duty axles, and electric self-adjusting brakes that significantly decrease stopping distance and cause less wear and tear on your tow vehicle.



Generator Prep
Fully integrated wiring and controls to help you add a generator easily.



8' Ramp Door
Lower pitch for a better load angle.



LED TV w/ DVD and 3-Zone Stereo
Have total control of your entertainment.



CNC Precision-Routed Sidewalls
Keystone's CNC routing process ensures perfectly cut / perfectly fit windows, doors, and slide-boxes.

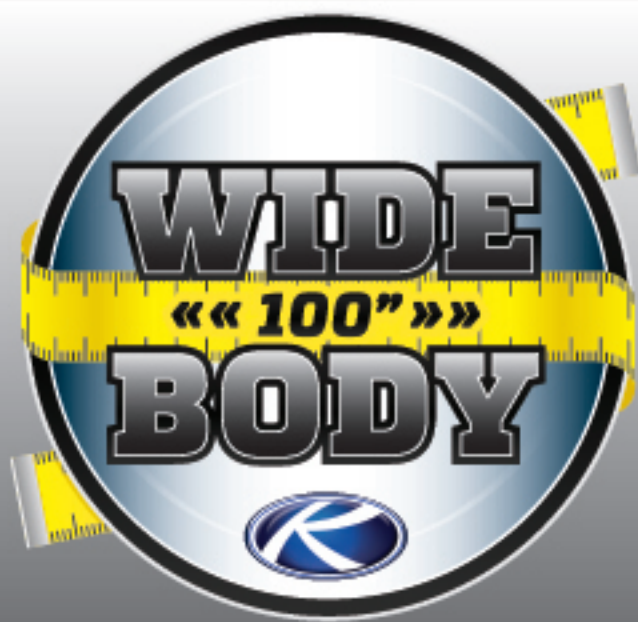

100" Wide Body Construction
Added width provides more carrying capacity for large toys.



Oversized Refrigerators
Keep more food on hand with 8 cu. ft. of refrigerator and freezer storage in most units, and 12 cu. ft. in 343 and 367 floorplans.

Ultimate Convenience

Do more. Store more. Travel often. Impact's many impressive features provide maximized accessibility.



more product detail at
www.keystonerv.com/impact



343 Island w/ Sink and Bamboo Style Covers



343 Corner pantry



343 Interior

Bright and Inviting Interiors

Our fresh, new farmhouse-style interior offers a bright inviting space with newly re-designed features. Impact interiors feature new painted gray cabinets, an attractive light wallboard, new white marbled countertops with bamboo sink covers and sleek black appliances. Impact offers two decors, Brindle (as shown) and Onyx (see website), available in open concept floorplans.



New, re-designed master bedroom with reclaimed wood-inspired feature wall, built-in laundry storage and accessible dual entry.



367 Sofa Slide w/ Heat, LED & Massage



367 Bedroom

Garage lengths span from 9' 6" to an impressive 19'.



343 Garage



Bathroom Laundry Hamper



more product detail at
www.keystonerv.com/impact

- 40" living room television / 32" on Vapor Lite
- Oversized reclining furniture with built-in LED lighting, heat and massage (n/a open concept) (opt. 28V, 29V)
- 35,000 BTU ducted furnace
- ¾ Ton A/C system for maximum cooling
- 5K interlock tie-down system in the garage, exclusive to Key Performance™
- Stainless steel, single-bowl sink with pull-out faucet
- 100" wide body frame and 8' ramp door—maximum garage space
- 30-gallon fuel cell for fuel station & generator
- 30-gallon fuel station with pump for conveniently refilling toys while you camp
- Dual, 30-gallon LP tanks
- Spare tire with carrier
- Generator prep makes for easy generator installation after purchase
- Upgraded aluminum wheels



26V | Light weight, open concept, tandem-axle, 14' garage
 Weight: 6556 LBS. | Length: 30' 6"

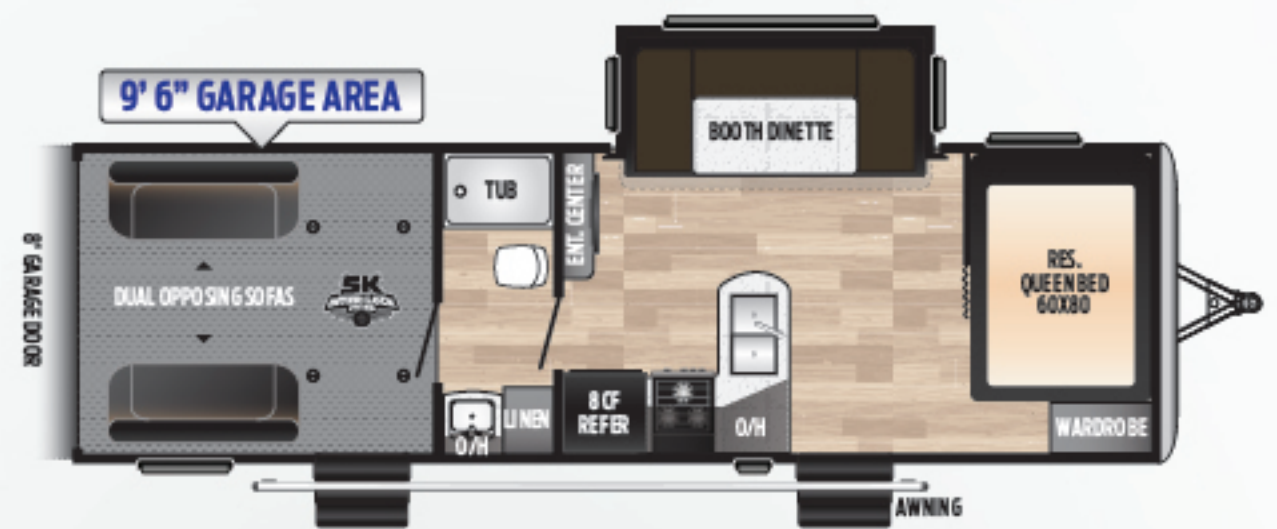

28V | Light weight, tandem-axle, one slide, 9' 6" garage
 Weight: 7120 LBS. | Length: 32' 8"

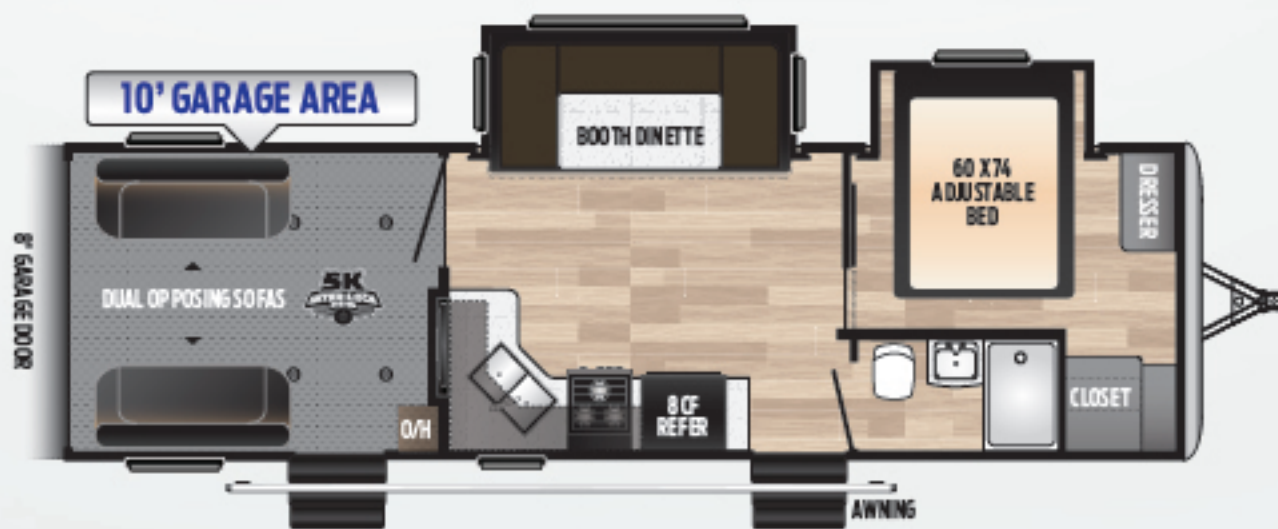

29V | Light weight, tandem-axle, two slides, 10' garage
 Weight: TBD LBS. | Length: 33' 10"



317 | New toy box, tandem-axle, two slides, 11' garage
 Weight: 9890 LBS. | Length: 37' 6"



330 | Tandem-axle, two slides, 12' 6" garage
 Weight: 9463 LBS. | Length: 37' 6"

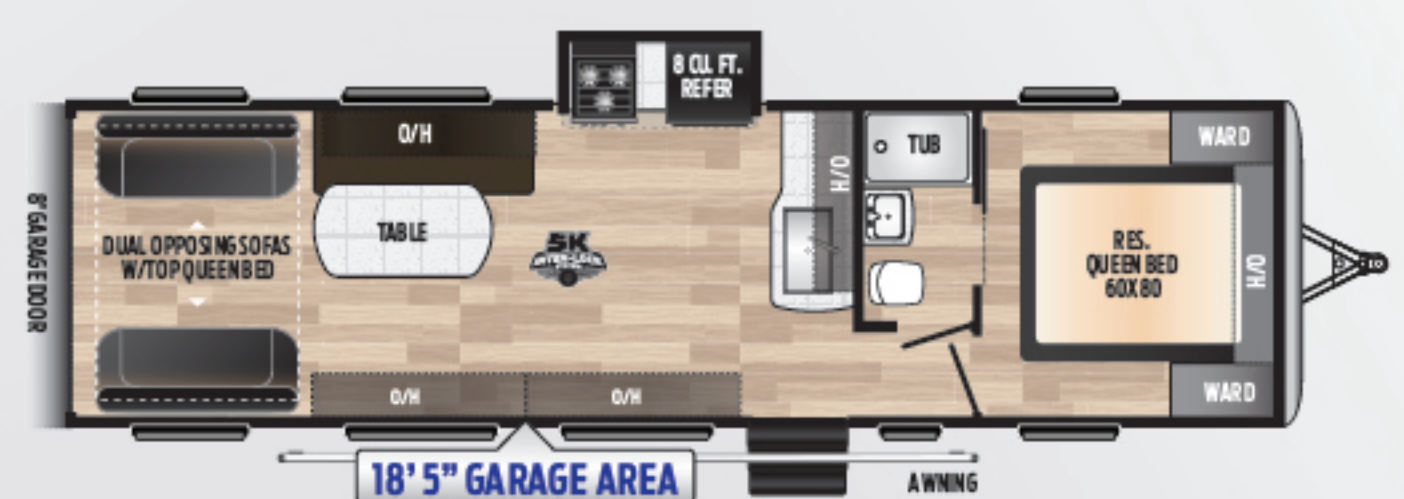

3118 | Open concept, tandem-axle, one slide, 18' 5" garage
 Weight: 8394 LBS. | Length: 35' 6"

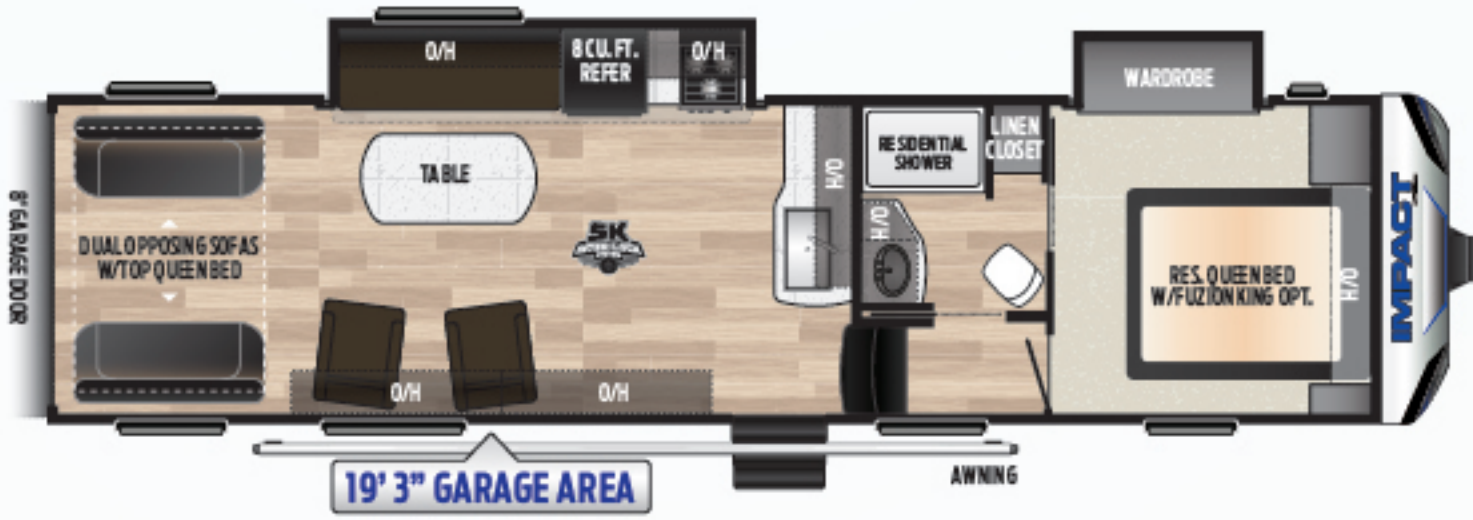

3219 | Open concept, tandem-axle, two slides, 19'3" garage
Weight: 10850 LBS. | Length: 35' 8"

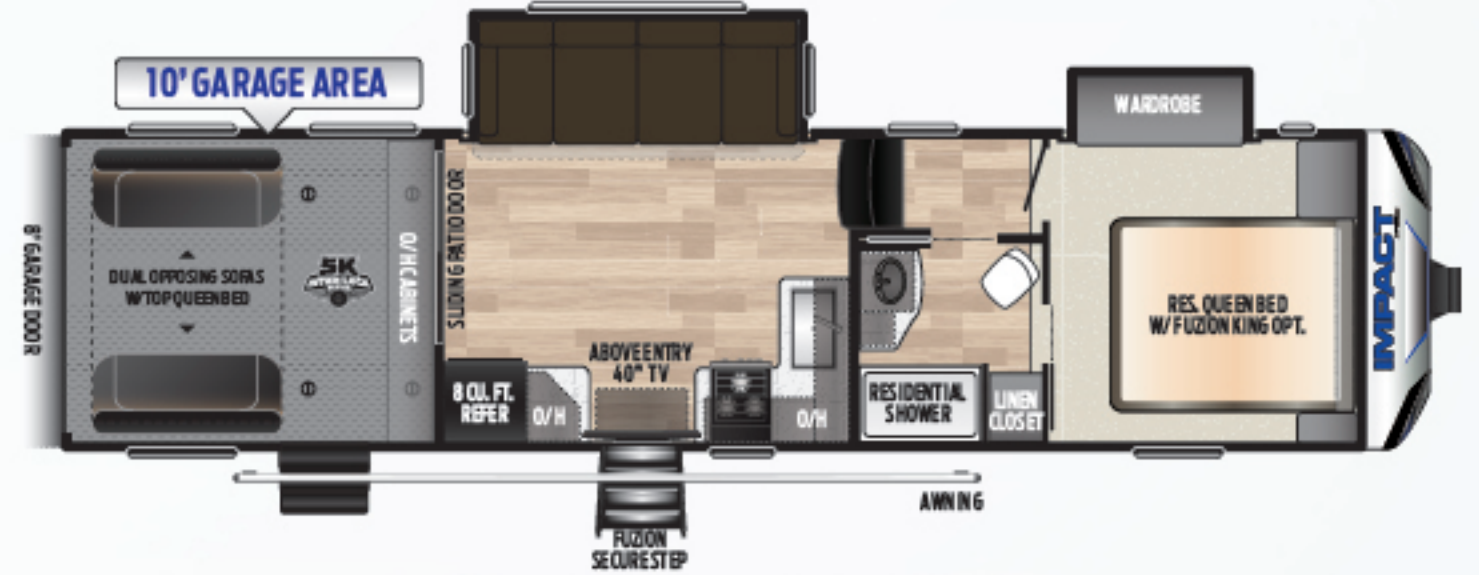

311 | Tandem-axle, two slides, 10' garage
Weight: 10985 LBS. | Length: 35' 7"

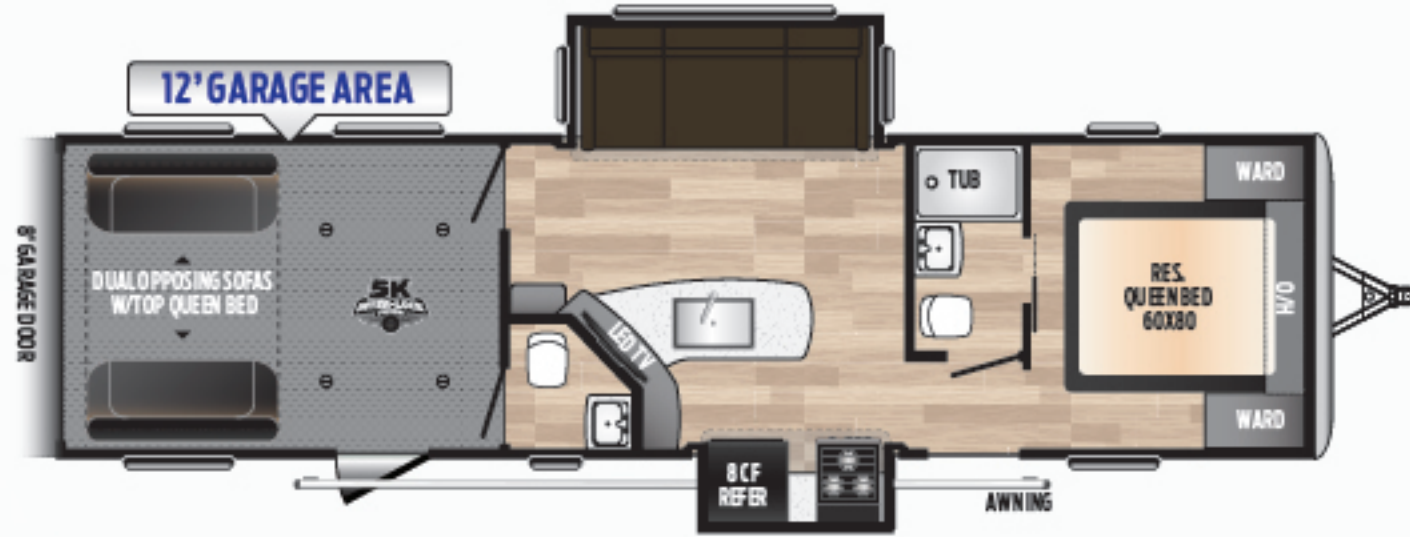

332 | Tandem-axle, 1 1/2 bath, 12' garage
Weight: 9648 LBS. | Length: 37' 6"

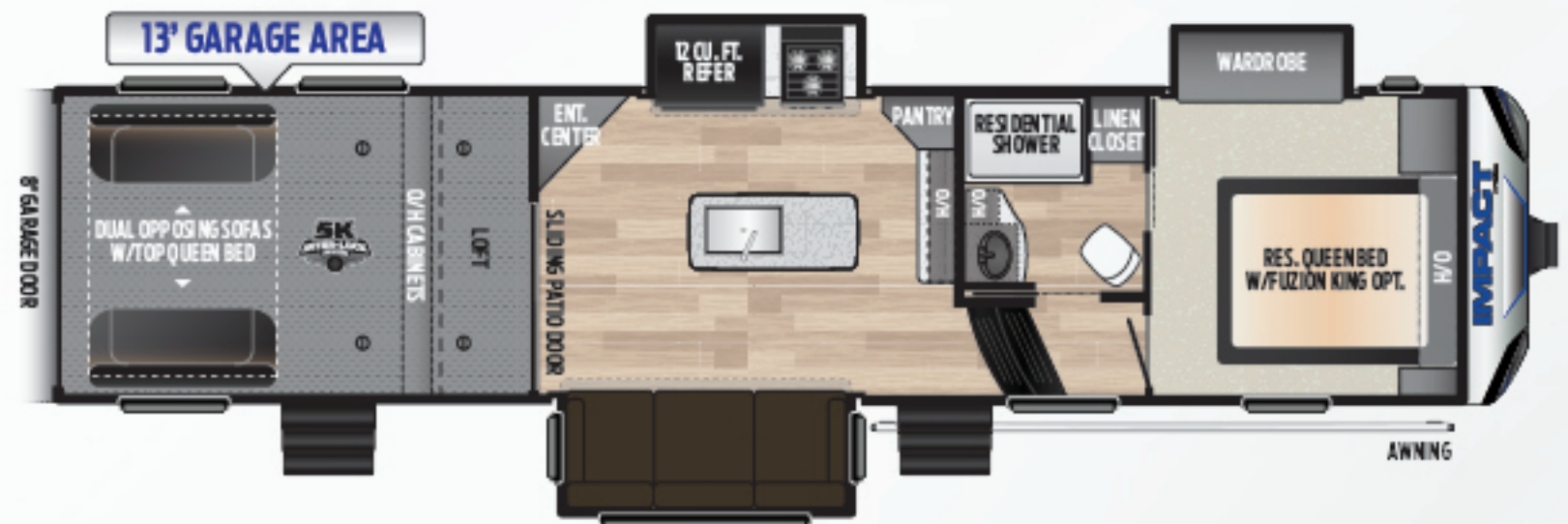

343 | Tandem axle, three slides, 13' garage
Weight: 12205 LBS. | Length: 39' 0"



351 | Tandem-axle, two slides, 12'6" garage
Weight: 12094 LBS. | Length: 38' 1"

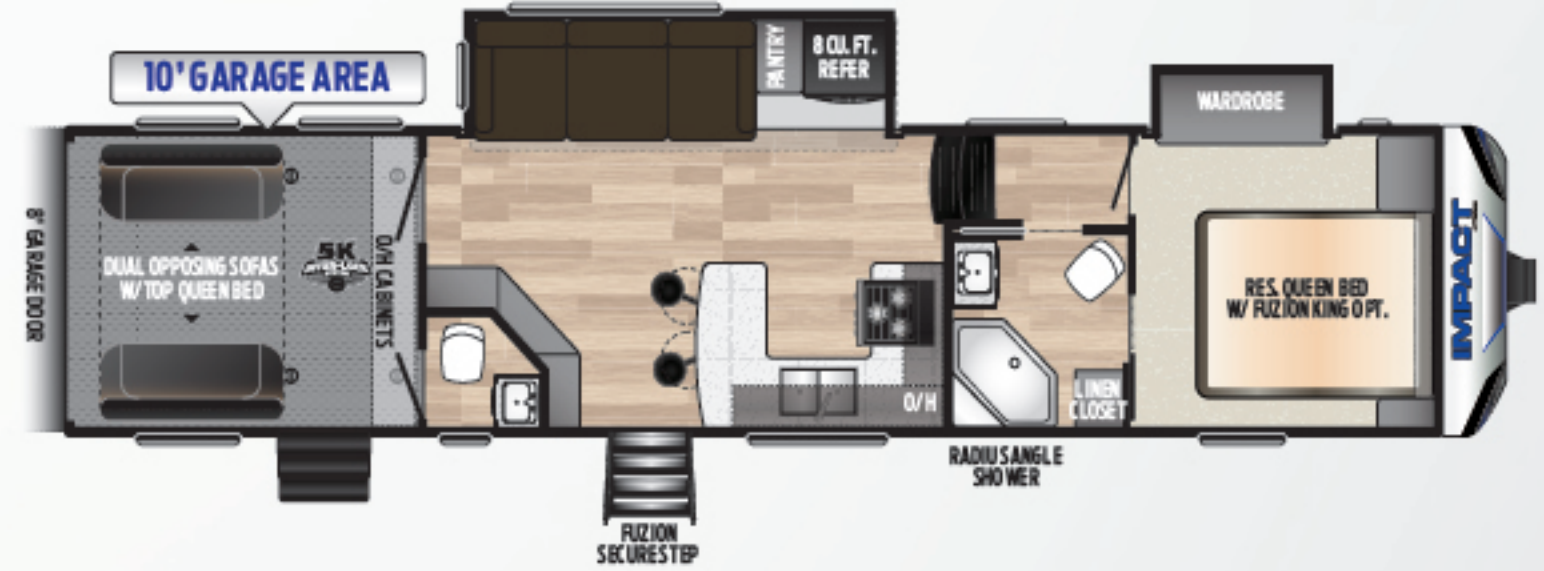

359 | Tandem-axle, one slide, 10' garage
Weight: TBD | Length: TBD

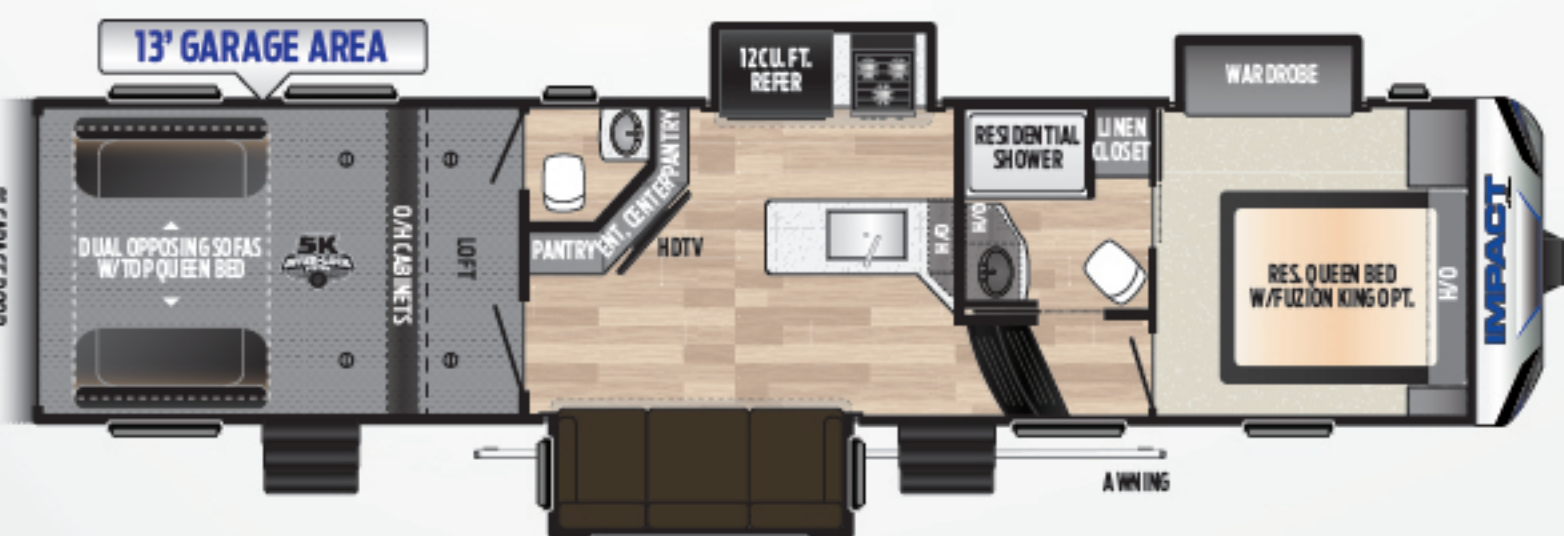

367 | Tandem axle, 1 1/2 bath, 13' garage
Weight: 12702 LBS. | Length: 39' 0"

FIFTH WHEELS & TRAVEL TRAILERS

| MODEL | WEIGHT | CARRYING CAPACITY | HITCH WEIGHT | FRESH WATER | WASTE WATER | GRAY WATER | LPG | LENGTH* | HEIGHT |
|-------|--------|-------------------|--------------|-------------|-------------|------------|-----|---------|--------|
| 311 | 10985 | 5465 | 2450 | 106 | 44 | 88 | 60 | 35' 7" | 13' 1" |
| 317 | 9890 | 3110 | 1675 | 100 | 30 | 60 | 60 | 37' 6" | 12' 4" |
| 330 | 9463 | 3537 | 1415 | 100 | 30 | 60 | 60 | 37' 6" | 12' 4" |
| 332 | 9648 | 3352 | 1560 | 100 | 60 | 60 | 60 | 37' 6" | 12' 4" |
| 343 | 12205 | 4695 | 2905 | 106 | 44 | 86 | 60 | 39' 0" | 13' 1" |
| 351 | 12094 | 4906 | 2900 | 106 | 44 | 88 | 60 | 38' 1" | 13' 1" |
| 359 | TBD | TBD | TBD | TBD | TBD | TBD | TBD | TBD | TBD |
| 367 | 12702 | 4298 | 2970 | 106 | 88 | 88 | 60 | 39' 0" | 13' 1" |
| 3118 | 8394 | 4106 | 1350 | 100 | 30 | 30 | 60 | 35' 6" | 12' 4" |
| 3219 | 10850 | 5865 | 2715 | 106 | 44 | 44 | 60 | 35' 8" | 13' 1" |
| 26V | 6565 | 4695 | 860 | 60 | 30 | 30 | 60 | 30' 6" | 12' 2" |
| 28V | 7120 | 4280 | 1020 | 60 | 30 | 30 | 60 | 32' 8" | 12' 2" |
| 29V | TBD | TBD | TBD | 60 | 30 | 60 | 60 | 33' 10" | 12' 2" |

Keystone
Exclusive



Operate two A/C units simultaneously for the most cooling power in the industry.

Keystone's Impact engineering team partnered with Dometic to build a game changing air conditioning system for our owners who like to play in hotter climates. With Omni Chill, Impact owners can operate two of their toy hauler's air conditioners simultaneously on a 30-AMP circuit. Other manufacturers' systems require owners to cycle their air conditioners, running only one unit at a time. Testing has shown that OmniChill's revolutionary technology keeps coaches up to eight degrees cooler than our competitors in 100°F ambient temperature.

3/4 TON HIGH EFFICIENCY AIR CONDITIONER SYSTEM

MOST ENERGY EFFICIENT, HIGHEST PERFORMING SYSTEM AVAILABLE

RUN 2 A/C'S ON A 30-AMP SERVICE WITH POWER TO SPARE

DELIVERS 15% GREATER AIRFLOW

| | FW | TT | VL |
|--|----|----|----|
| EXTERIOR | | | |
| Aluminum constructed, fully laminated fiberglass sidewalls | ○ | ○ | ○ |
| Electric front and rear stab jacks | ○ | ○ | |
| 100" wide body | ○ | ○ | ○ |
| 8 Ft. ramp door | ○ | ○ | ○ |
| Exterior convenience center | ○ | | |
| 16" wheels with 7,000 lb. Dexter® EZ Lube® axles | ○ | ○ | |
| 15" wheels with 4,400 lb. Dexter® EZ Lube® axles TT | | | ○ |
| Spare tire with carrier | ○ | ○ | ○ |
| LED lighted electric awning | ○ | ○ | ○ |
| Diamond plate rock guard on front TT only | | ○ | ○ |
| 12-gallon gas/electric water heater with DSI FW only | ○ | | |
| 6-gallon gas/electric water heater with DSI TT only | | ○ | ○ |
| 30-gallon fuel station with pump | ○ | ○ | ○ |
| 7' tall slide rooms | ○ | ○ | ○ |
| G-rated tires | ○ | | |
| F-rated tires | | ○ | |
| E-rated tires | | | ○ |
| Generator prep | ○ | ○ | ○ |
| LED Tail lights, brake lights & ramp loading lights | ○ | ○ | ○ |
| Aluminum wheels | ○ | ○ | ○ |
| Exterior shower with hot and cold water | ○ | ○ | ○ |
| Heated enclosed tanks | ○ | ○ | ○ |
| INTERIOR | | | |
| Oversized shower | ○ | | |
| 40" LED TV | ○ | ○ | |
| 32" LED TV | | | ○ |
| Bluetooth CD/DVD Player with MP3 connection | ○ | ○ | ○ |
| Residential reclining furniture w/ heat, LED, massage n/a open concept | ○ | ○ | |
| Dual electric beds with collapsible rollover sofa | ○ | ○ | |
| 8 cu. ft. refrigerator | ○ | ○ | ○ |
| 12 cu. ft. refrigerator (343, 367 Only) | ○ | | |
| 3-burner stove w/ oven | ○ | ○ | ○ |
| Hardwood cabinetry | ○ | ○ | ○ |
| 30" wide entry doors | ○ | ○ | ○ |
| Solid-core passage doors | ○ | ○ | |
| Tuff Ply flooring in the cargo area | ○ | ○ | ○ |
| 35,000 BTU ducted furnace | ○ | ○ | ○ |
| 2 Interior, 2 exterior speakers | ○ | ○ | ○ |

| | FW | TT | VL |
|---|----|----|----|
| INTERIOR (CONT.) | | | |
| Residential queen sized mattress in bedroom | ○ | ○ | ○ |
| Night shades | ○ | ○ | ○ |
| Microwave oven | ○ | ○ | ○ |
| 3/4 ton A/C System | ○ | ○ | ○ |
| 5K InterLock system | ○ | ○ | ○ |
| Two (2) RAM air vents in the cargo area | ○ | ○ | ○ |
| Stainless steel single bowl sink | ○ | ○ | ○ |
| SAFETY | | | |
| Fire extinguisher | ○ | ○ | ○ |
| Smoke detector | ○ | ○ | ○ |
| LP detector | ○ | ○ | ○ |
| CO detector | ○ | ○ | ○ |
| Safety chains | | ○ | ○ |
| Emergency Breakaway switch | ○ | | |
| OPTIONS | | | |
| King bed Glide-A-Bed™ system w/ under-bed storage | ○ | | |
| Frameless dual-pane safety glass windows | ○ | ○ | ○ |
| Ramp door patio package | ○ | ○ | ○ |
| Onan 5500 watt gasoline generator | ○ | ○ | |
| Onan 4000 watt gasoline generator | | | ○ |
| Dual ¾ ton A/C's | ○ | ○ | |
| 3-seat sofa w/ LED, heat, massage (28v, and 29v) IPO booth dinette | | | ○ |
| HappiJac® bed w/ upper bunks & table | | | ○ |
| HappiJac® bed system w/ table and upper bunks | ○ | ○ | |
| FW Fifth Wheels TT Travel Trailers VL Vapor lite Travel Trailers | | | |

DISCLAIMER: Product information is as accurate as possible as of the date of publication of this brochure. All features, floor plans, and specifications in this brochure are subject to change without notice. Please also consult Keystone's web site at www.keystonerv.com for more current product information and specifications. Tow Vehicle Disclaimer. CAUTION: Owners of Keystone recreational vehicles are solely responsible for the selection and proper use of tow vehicles. All customers should consult with a motor vehicle manufacturer or their dealer concerning the purchase and use of suitable tow vehicles for Keystone products. Keystone disclaims any liability or damages suffered as a result of the selection, operation, use or misuse of a tow vehicle. KEYSTONE'S LIMITED WARRANTY DOES NOT COVER DAMAGE TO THE RECREATIONAL VEHICLE OR THE TOW VEHICLE AS A RESULT OF THE SELECTION, OPERATION, USE OR MISUSE OF THE TOW VEHICLE. *Length is defined as the distance from the centerline of hitch pin/coupler to rear bumper of trailer. Please review owner's manual prior to purchase for more information on service warranties, extended use, towing and maintenance. Owner's manuals can be found at keystonerv.com.

BUILT FOR THE LONG HAUL



PRINT 1.2019

