

ARCADIA

SUPER LITE & FULL SIZE FIFTH WHEELS



KEYSTONE
RV COMPANY

CAMP BETTER





ARCADIA 293SLRD

2023 ARCADIA | EXCEPTIONAL FEATURES

- NGC2 CRAWLSPACE CHASSIS*
- PEAK WEATHER PROTECTION PACKAGE
- ENCLOSED, HEATED HOLDING TANKS W/ 12-VOLT HEAT PADS
- CURT® ARV DELUXE HITCH PIN
- CURT® PERFORMANCE SUSPENSION PACKAGE
- UPGRADED DEXTER® AXLES W/ NEV-R-LUBE™ HUBS AND NEV-R-ADJUST™ BRAKES
- UPGRADED E-LOAD TIRES W/ 6-YEAR WARRANTY
- ALPHA® TPO ROOF MEMBRANE W/ LIFETIME WARRANTY
- HYPERDECK™ LAMINATED FLOOR CONSTRUCTION
- STRAIGHT-LINE PASS THROUGH STORAGE
- STAND ALONE CONVENIENCE CENTER
- EXTRA LARGE 12-VOLT SOLAR FRIENDLY REFRIGERATORS
- UPGRADED 35,000 BTU FURNACE
- FIREPLACE W/ ADDITIONAL 5,000 BTU HEATING ELEMENT
- TANKLESS WATER HEATER FOR ENDLESS AND INSTANT HOT WATER
- BLADE PURE™ HIGH PERFORMANCE AIR FLOW SYSTEM
- RESIDENTIAL ROMAN SHADES
- SERTA® RESIDENTIAL-SIZE MEMORY FOAM MATTRESS
- OPTIONAL SOLARFLEX 200, 400i & 600i-L SOLAR POWER SYSTEMS
- OPTIONAL DRAGONFLY ENERGY LITHIUM-ION BATTERIES

*N/A ON SUPER-LITE MODELS



We instantly fell in love with our Arcadia when we toured it at the Tampa RV show. Wise use of space, huge, panoramic windows that bring the outside in, a large private bath with a roomy shower, a walk around queen bed with big wardrobes, massive amounts of storage, and cutting-edge technology. The clean, crisp, modern décor was the icing on the cake.

MIKE AND JENNIFER WENDLAND OF RVLIFESTYLE.COM
 — **ARCADIA 3250RL OWNERS**

VISIT OUR WEBSITE FOR PHOTOS,
 360° TOURS, AND FULL PRODUCT DETAILS



SUPER LITE FIFTH WHEELS

Utilizing the most advanced construction techniques in the industry, Arcadia Super Lite models are specifically engineered to provide maximum comfort, convenience and livability while maintaining lengths and weights that are easily towed by properly equipped half-ton trucks.

Like Arcadia's full-size floorplans, Super Lites feel open and expansive, thanks to their breathtaking styling and décor, oversized windows, unique cap design and Spacesaver chassis.

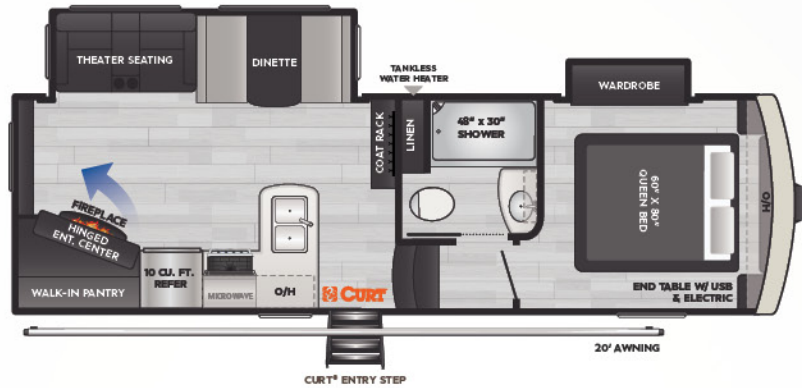

NEW! **288SLRE** | WEIGHT **TBD** | LENGTH **28' 8"**

- REAR LIVING, HIDDEN PANTRY, BEDROOM WARDROBE SLIDE

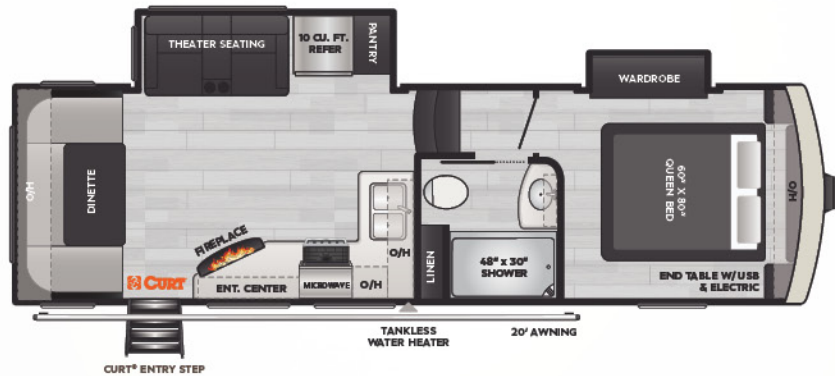

NEW! **293SLRD** | WEIGHT **7440** | LENGTH **29' 3"**

- XL DINETTE, BEDROOM WARDROBE SLIDE



NEW! **294SLBH** | WEIGHT **TBD** | LENGTH **29' 4"**

- DOUBLE BUNKS, SUPERSLIDE LIVING, BEDROOM WARDROBE SLIDE

SUPER-LITE

FLOORPLANS

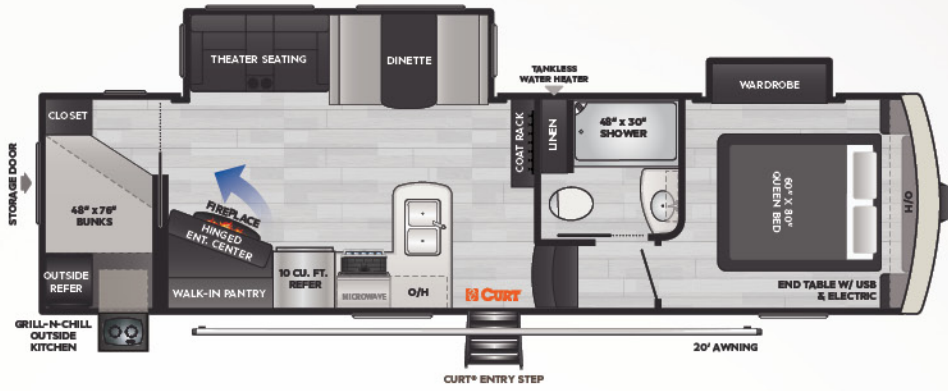

NEW! 328SLBH | WEIGHT TBD | LENGTH 32' 8"

- DOUBLE BUNKS, HIDDEN PANTRY, BEDROOM WARDROBE SLIDE

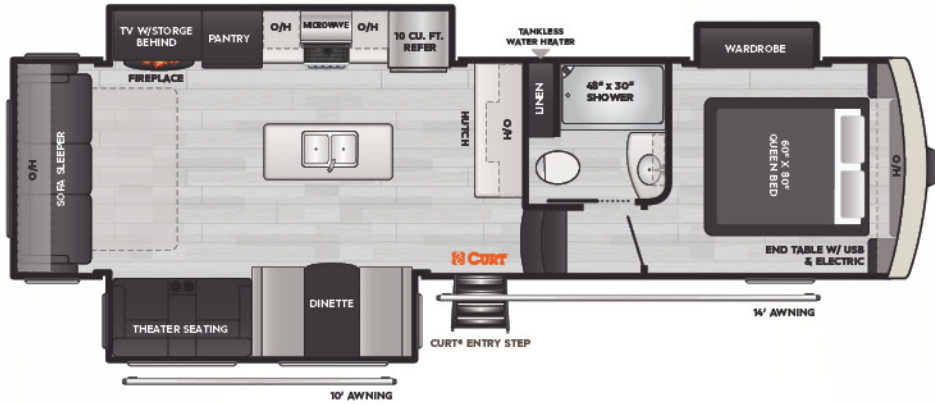

NEW! 332SLRL | WEIGHT 8800 | LENGTH 33' 2"

- XL REAR SOFA, BEDROOM WARDROBE SLIDE



NEW! 342SLTB | WEIGHT TBD | LENGTH 34' 2"

- TRIPLE BUNKS, BEDROOM WARDROBE SLIDE

MODEL	WEIGHT	CARRYING CAPACITY	HITCH WEIGHT	FRESH WATER**	WASTE WATER	GRAY WATER	LPG	LENGTH*	WIDTH	HEIGHT	AWNING
288SLRE	TBD	TBD	TBD	54	30	60	60	28' 8"	8'	12' 6"	TBD
293SLRD	7440	2880	1520	54	30	60	60	29' 3"	8'	12' 6"	20'
294SLBH	TBD	TBD	TBD	54	30	60	60	29' 4"	8'	12' 6"	TBD
328SLBH	TBD	TBD	TBD	54	30	60	60	32' 8"	8'	12' 6"	TBD
332SLRL	8800	2200	1755	54	30	60	60	33' 2"	8'	12' 6"	14'/10'
342SLTB	TBD	TBD	TBD	54	30	60	60	34' 2"	8'	12' 6"	TBD
3660RL	11030	2470	1880	95	49	88	60	36' 6"	8'	13' 4"	16'
3910MB	12195	1785	1985	95	49	88	60	39' 5"	8'	13' 5"	20'
3940LT	11607	2213	1820	54	88	88	60	39' 7"	8'	13' 4"	16'

FULL SIZE FIFTH WHEELS

Arcadia shattered industry norms and expectations with our 2021 product launch. Utilizing out-of-the-box thinking, patented features like our NGC2 Crawlspace Chassis, and numerous other innovations, Arcadia raised the bar on what's possible with a mid-profile fifth wheel. 2023 models now feature a solar-friendly 16 cu. ft, 12V refrigerator and tankless water heater.

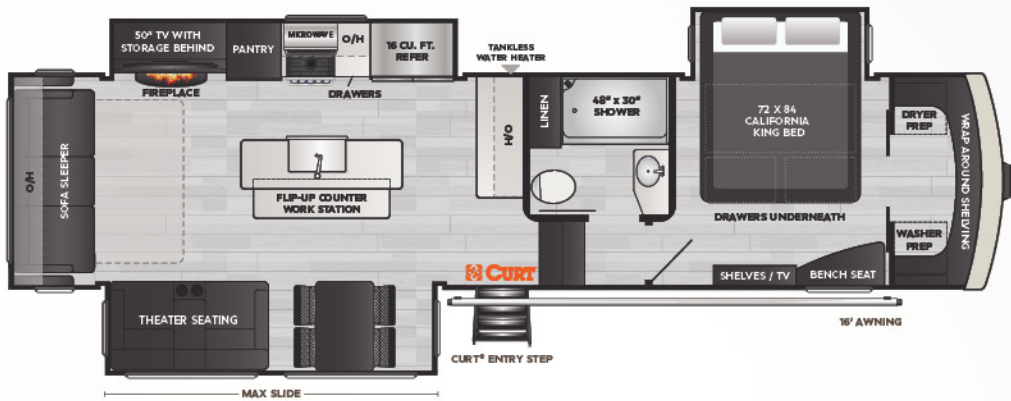

3660RL | WEIGHT 11030 | LENGTH 36' 6"

- REAR LIVING, MID-KITCHEN, KING BED SLIDE, WALK-IN CLOSET

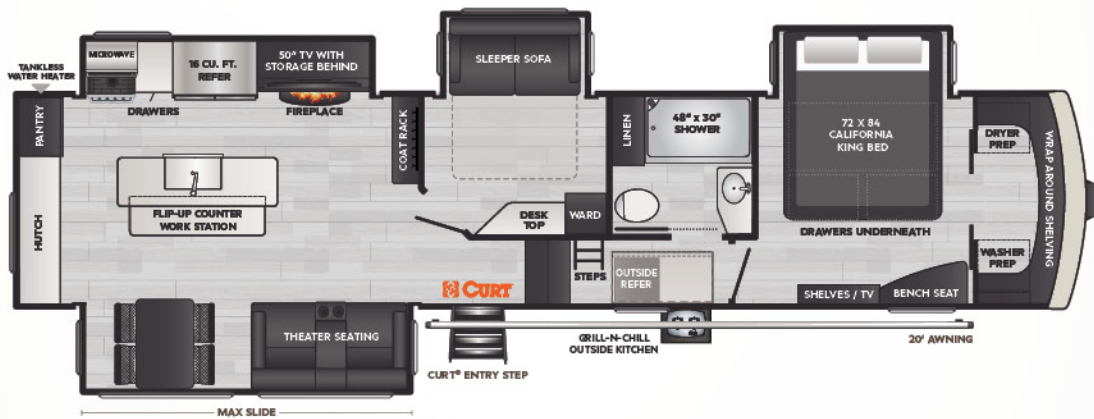

NEW! 3910MB | WEIGHT 12195 | LENGTH 39' 5"

- MID BONUS ROOM, LOFT, KING BED SLIDE

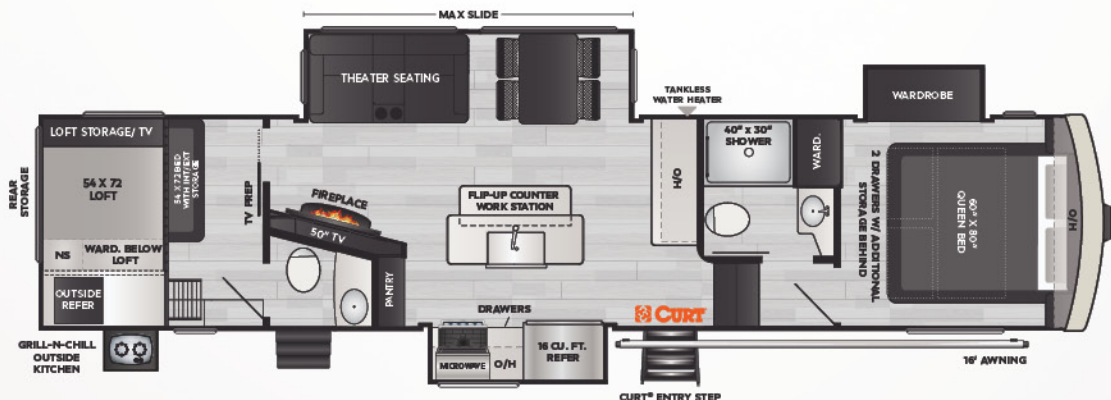

3940LT | WEIGHT 11607 | LENGTH 39' 7"

- 2 BEDROOM, 1 1/2 BATH, OUTSIDE KITCHEN, BEDROOM WARDROBE SLIDE

FLOOR PLANS



TAKE CHARGE OF HOW YOU CAMP

EXCEPTIONAL QUALITY, IMPOSSIBLY VERSATILE, SolarFlex™ IS SHATTERING CUSTOMER'S EXPECTATIONS OF FACTORY-INSTALLED SOLAR POWER. EXCLUSIVELY AVAILABLE ON ALL KEYSTONE RV MODELS.



Relieve battery anxiety with legendary Lithium-ion deep cycle batteries — the ultimate replacement for lead acid. Lightweight, reliable, and longer-lasting, Dragonfly Energy batteries are made in the USA and available exclusively from Keystone RV and authorized dealers.



Learn more about the SolarFlex difference and packages now available.

MY KEYSTONE

OWNER'S APP

THE ONLY APP YOU'LL NEED...

- » MANUALS & QUICK START GUIDES
- » HOW-TO VIDEOS
- » FIRST-TIME CAMPER'S ADVICE
- » ACCESS TO YOUR RV'S MOBILE APPS

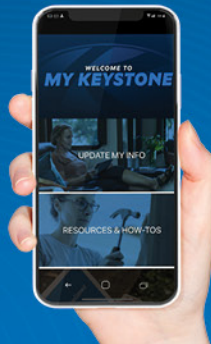

FOLLOW US FOR THE LATEST!



DISCLAIMER: Product Information is as accurate as possible as of the date of publication of this brochure. All features, floor plans, and specifications in this brochure are subject to change without notice. Please also consult Keystone's web site at www.keystonerv.com for more current product information and specifications. Tow Vehicle Disclaimer. CAUTION: Owners of Keystone recreational vehicles are solely responsible for the selection and proper use of tow vehicles. All customers should consult with a motor vehicle manufacturer or their dealer concerning the purchase and use of suitable tow vehicles for Keystone products. Keystone disclaims any liability or damages suffered as a result of the selection, operation, use or misuse of a tow vehicle. KEYSTONE'S LIMITED WARRANTY DOES NOT COVER DAMAGE TO THE RECREATIONAL VEHICLE OR THE TOW VEHICLE AS A RESULT OF THE SELECTION, OPERATION, USE OR MISUSE OF THE TOW VEHICLE. *Length is defined as the distance from the centerline of hitch pin/coupler to rear bumper of trailer. ** Fresh water capacity includes water heater. Please review owner's manual prior to purchase for more information on service warranties, extended use, towing and maintenance. Owner's manuals can be found at keystonerv.com.

PRINT 09.2022