

LIVING VEHICLE<sup>®</sup>

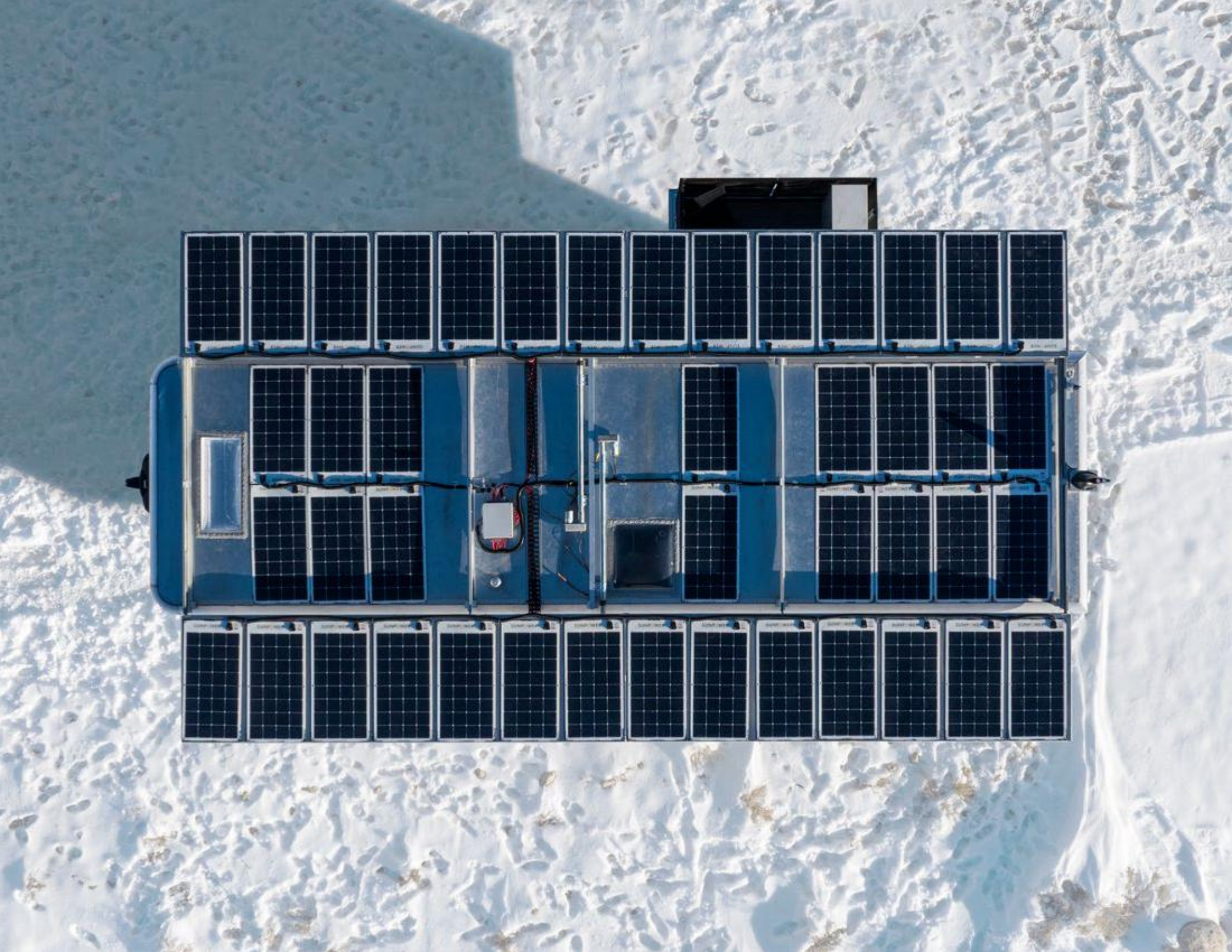







# Contents

8	Founder's Message
18	<b>HD</b> Series Travel Trailers
24	<b>HD24</b>
46	<b>HD30</b>
62	<b>GT</b> Series Fifth Wheels
66	<b>GT32</b>
74	<b>GT38</b>
80	Energy
82	Materials
86	Trim Levels
90	Features
106	Tow Vehicles
114	Certifications
116	Service & Warranty

# Founders' Message

## A Shared Dream

Living Vehicle was birthed from a dream to reshape our world. Since its inception in 2017, Living Vehicle® has steadfastly pioneered advancements, solidifying its status as the industry's vanguard. Our vision, underpinned by quality and sustainability, drives us to envision the world differently and to turn dreams into reality. We marvel at our journey thus far; Living Vehicle® epitomizes the passion, innovation, and collective efforts dedicated to forging a brighter, better future. Each model, including our revolutionary GT and HD series, is a beacon of unmatched quality, functionality, and design.

In an age dominated by 3-D and virtual realities, we remain grounded in the tangible, understanding that true creation transcends mere ideation. Every model presented here is available now, with production in full swing. We are builders, committed to making visions a reality. Our newest offerings encapsulate ground breaking technologies for unmatched self-sufficiency and off-grid independence. Living Vehicle stands as an All-Electric, perpetual power behemoth, integrating innovations like solar energy, water generation, and power creation, propelling us closer to our ultimate aim: crafting the first-ever Net-Zero living space.

For 2024, we proudly introduce our latest creations: the HD series and the new GT series, each representing monumental strides in our unwavering quest for excellence. Dive into the unparalleled innovation and luxury that Living Vehicle® now offers. What lies before you began as a dream, and we're elated to present the realized dream - the Living Vehicle® 2024.

Matthew & Joanna Hofmann  
Founders



Photo Credit: Apple





**THE ROBB REPORT**

**Best Travel Trailer to Live In: Living Vehicle**

Matthew Hofmann’s Living Vehicle trailers aren’t just for a weekend in the woods; they’re for actually living there. The chrome, shoe box-shaped trailer offers everything you would want from a New York apartment, with basically the same square footage. The former architect’s trailers have it all—outsized windows, a skylight, spa-style bathroom, washing machine and a roof-top solar system allowing for off-the-grid living. And because everyone’s idea of what makes the perfect home is their own, each unit is fully customizable.



**SUNSET TRAVEL AWARDS**

**Off-the-Grid Getaway: Living Vehicle**

The 2022 version of this luxe travel trailer runs on solar power, giving you the freedom of a refrigerator, air-conditioning, dishwasher, and more on wheels. The bedroom transforms into a mobile office, or you can convert it into a home theater. The best part? This vehicle can head off-road with its all aluminum frame and stainless-steel trim.



**RETHINKING THE FUTURE AWARD**

**Architectural Innovation of the Year: Living Vehicle**

“The sustainable travel trailer is a vision of that very future. The vehicle allows users to live and work off-grid with enduring, sustainable power. Designed to connect people with nature, mobility empowers connection with the world around and embraces the natural environment’s healing powers. Above all, the mobile lifestyle encourages individuals to be true to themselves and through the freedom of choice – the choice to freely be your best self.”



**SKIFT IDEA AWARDS**

**Spaces & Places Winner: Living Vehicle**

Living Vehicle® re-imagined how a recreation vehicle should look and function and, in the process, made the concept of work from anywhere genuinely possible. For example, the mobile desk package has a large walnut desk that can be lowered to reveal a queen-sized bed without disturbing the workplace. The 2022 Model features a wholly redesigned LVenergy System with enough power capacity to charge electric vehicles using a 240V level 2 charging station.



# Innovation: The LV Standard

A red check box  denotes standard equipment.

**1 SELF-SUPPORTING PATIO DECK**

Embrace the outdoors with the LV® exclusive patio deck living space. Automatic winch controls raise and lower the 1500 lb. rated patio. Integrated dual-umbrella mounts are attached to the powder coated folding railing system for seamless setup.

**2 WATER GENERATION**

The 2024 Living Vehicle® creates its own water supply while travelling off-grid. Humidity is extracted out of the air to fill the fresh water tank. Coupled with never-before-seen resource capacity, time off-grid is significantly extended.

**3 DUAL-ZONE MINI-SPLIT A/C & HEAT**

Gone are the days of inefficient RV-style rooftop air conditioners. Installed on all models is the European-style Mini Split system. With a SEER rating of 21, the system is ultra-efficient and capable down to -4° F with fully electric heat.

**4 ARCHITECTURALLY DESIGNED DETAILS**

Living Vehicle® is built with a quality-first standard at all levels of design and engineering. One must see in person to fully appreciate the manufacturing standards and attention to architecturally designed details.

**5 4-SEASON CAPABLE**

Living Vehicle® thrives below freezing, down to an industry first sub-zero, -4°F using electric heat with the **PRO** model. 100% rigid closed cell foam insulation and the conditioned basement that keeps the inside ice cool in up to 120°F + environments.

**6 CERTIFIED TO MEET LEED IAQ STANDARDS**

Conceived by a team of LEED Accredited Professionals, we apply the same sustainable building practices found in traditional architecture. LV® is tested to meet LEED standards for indoor air quality.

**7 AUTOMOTIVE QUALITY**

Living Vehicle® is architecturally designed down to the last detail; with minimal glues, solvents, and caulking, we limit engineered plastics wherever possible.

**8 ALL-ALUMINUM CABINETRY**

When space efficiency is of utmost importance, storage solutions take maximum advantage of every inch. The cabinet package is purpose-engineered for mobile applications, ultra-durable, and highly functional.

**9 THE LV ENERGY SYSTEM**

The powerhouse behind Living Vehicle®, LVenergy, features ultra-safe and readily available lithium-ion batteries rated for 10+ years and made from readily available marine-grade components.

**10 HD AUTO LEVELING**

Previously reserved for million-dollar coaches, one-touch hydraulic Auto-Leveling is standard. 4-point digital leveling APP-controlled for a rock-solid foundation and will even raise the entire LV® to change a spare tire.





# HD SERIES



## HD24

### ECO | COR | MAX | PRO

Length	24'
Width	8'-6"
Base Weight	11 - 13K
GVWR	14 - 16K
Axles	2
Energy	21 - 72kWh
Power	6 - 18kW
Solar	1.2kW-3.4kW (5kW OPT)
Sleeping	4 - 6
Temp. Rating	-4°F - 120°F

### LIVING VEHICLE® HD24

Conceived as a vessel for travel and adaptability, the 24 foot stance offers a more nimble, agile, and adaptable shape shifter for adventure-based travel. With the same power and energy capabilities as her larger sibling, the Living Vehicle® **HD24** is purpose-built for off-grid travel and ready to explore unknown destinations. The front sleeping area is reduced and the Euro Loft queen in the living area becomes the primary sleeping space.



## HD30

### ECO | COR | MAX | PRO

Length	30'
Width	8'-6"
Base Weight	14 - 16K
GVWR	18 - 20K
Axles	3
Energy	21 - 72kWh
Power	6 - 18kW
Solar	2kW-4.4kW (6kW OPT)
Sleeping	4 - 8
Temp. Rating	-4°F - 120°F

### LIVING VEHICLE® HD30

In the tradition of constant evolution and relentless innovation, a tremendously capable and functional model has emerged to replace the former generation of Living Vehicle®. Introducing the 30 foot long, three-axle beast of a modern masterpiece, the **HD30** model features a redesigned bedroom with multiple options, including a King bed. The fully integrated Mini-Split HVAC system accommodates the expanded solar roof.



Living Vehicle is assembled on top of the fully integrated commercial-grade aluminum chassis. Steel reinforcements are placed at high-stress points for added rigidity and load transfer.

# HD24

## Adventure Travel Unplugged

2024

The flagship of the **HD24** model lineup features perpetual power from natural resources. The **HD24-PRO** is the very definition of *Luxury Unplugged*.

### HD24-PRO [LVenergy]

The **HD24** hosts the most innovative and technologically advanced offering, an unreal powerhouse packed into a strikingly compact footprint. Living Vehicle® has designed the **HD24** with unequalled performance and capabilities. At 72kWh of battery storage and 18kW of raw inverter power. The **HD24** [LVenergy] system goes well beyond the mandatory provision of necessary power for superior capability.

### Walk-in Gear Closet & Storage

Instead of a dedicated bedroom, the front of the **HD24** Living Vehicle® floor plan highlights a massive 5' x 8' walk-in closet, expansive even by residential standards. This space has been conceived for the adventurer, explorer, and digital creative with high requirements for gear storage. The sleeping quarters are neatly hidden above the lounge and enclosed with a coach-style privacy curtain. When not in use, the push of a button hides the queen bed for seamless storage.

### Featuring the Dual Solar Awning

A 48" horizontal knife-edge aluminum plane extends into space on each side of the **HD24**. This mechanical masterpiece is only possible by clearing the roof of all equipment and relocating it to the basement. When viewed from above and extended, the top of the Living Vehicle® is covered with 3,400 watts of ultra-efficient, industry-leading solar panels. When closed, there is nothing but a sea of solar panels.





# HD24 Exterior

28

Dual Solar Awning, Standard equipment on the **HD24-PRO** with 3,400 W solar

Seamless aluminum sheet roof

All-solar roof with the removal of rooftop air conditioning

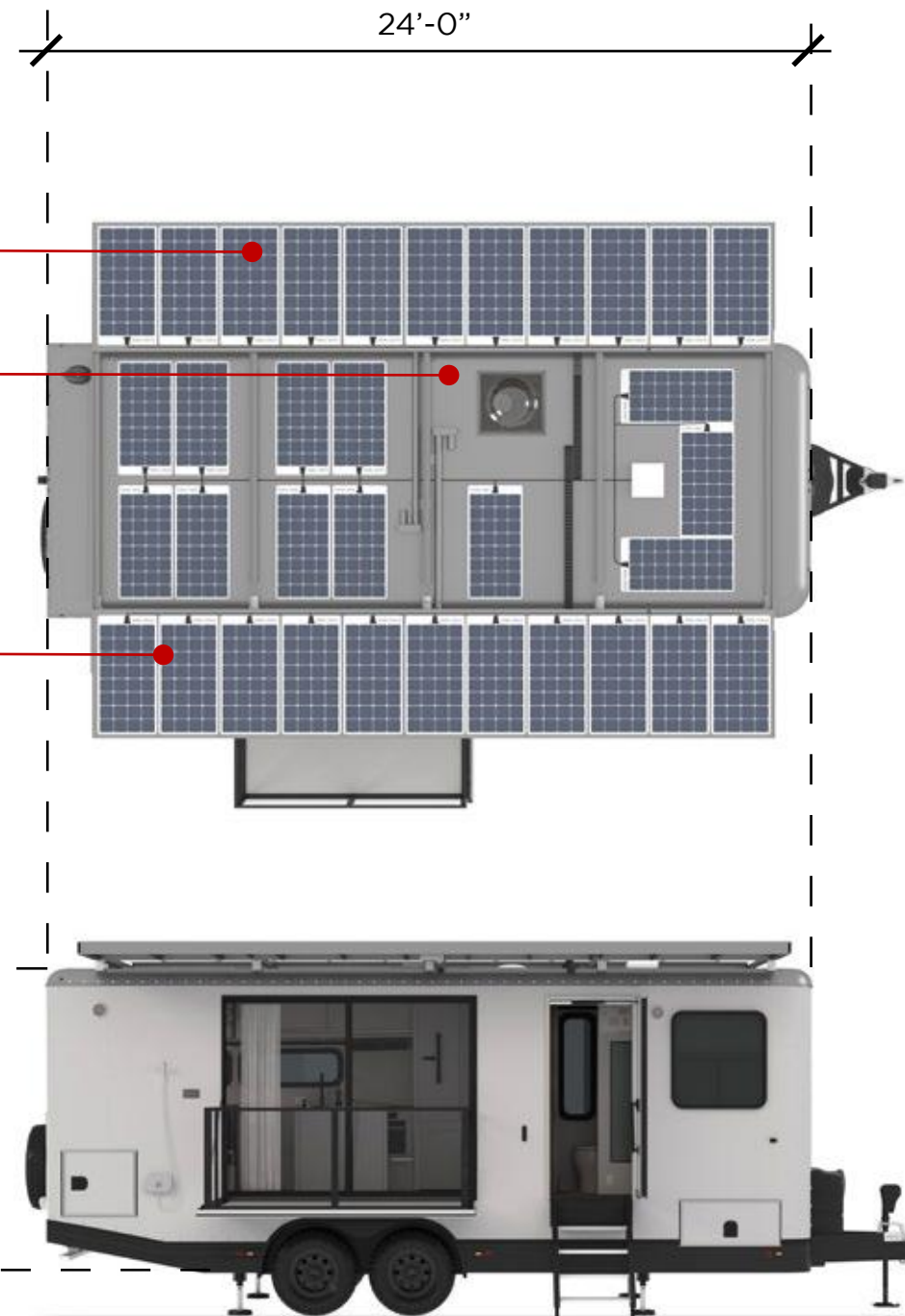

**RIGHT** 2" double seal hatch doors, fully insulated with closed cell rigid foam. All-metal gas struts and automotive locking hardware.

**BELOW** Easy access to service and utility connection points



29



# HD24 Interior Layout

## CLOSET & GEAR LOCKER OPTION

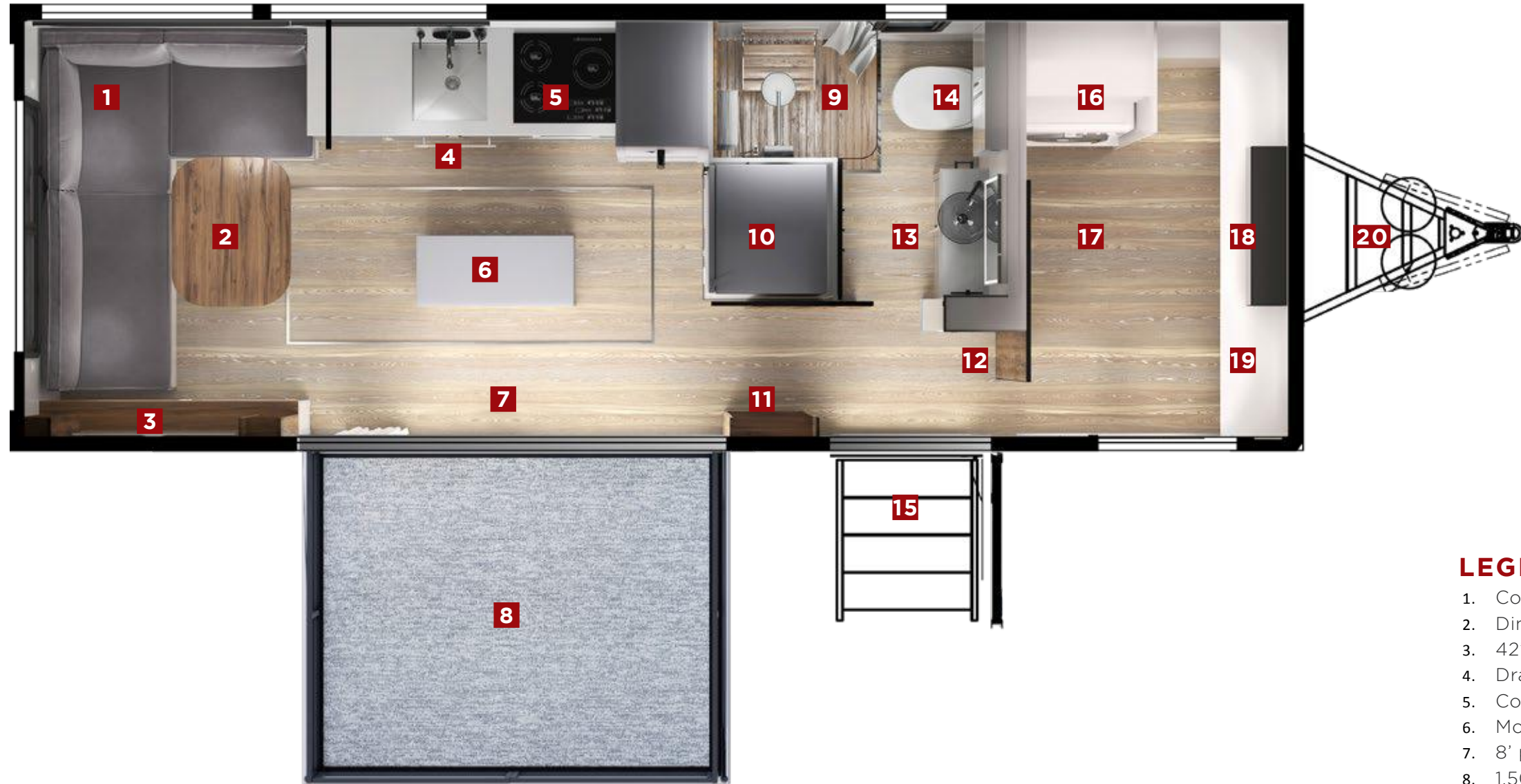

## OFFICE & BUNK ROOM OPTION [opt W/D]



**Sleeping Mode**  
[Bunk Beds Deployed]

**Office Mode**  
[Workstation Deployed]

### LEGEND

- |  |   |  |
|--|---|--|
| 1. Convertible lounge to Queen bed       | 10. 13 CU.FT. solar refrigerator            | 19. Shelf and full-width closet bar      |
| 2. Dining table converts to coffee table | 11. Hallway shelving unit                   | 20. A-frame and hitch, in front          |
| 3. 42" 4K TV with media center shelving  | 12. Monitor panels                          | 21. Wall-to-wall hanging storage         |
| 4. Drawer dishwasher OPT                 | 13. Bathroom                                | 22. Line of desk when stowed             |
| 5. Cooktop                               | 14. Vitreous China toilet                   | 23. OPT stacking Washer/ Dryer           |
| 6. Movable kitchen island                | 15. Entry                                   | 24. Line of bunk beds in stowed position |
| 7. 8' patio slider                       | 16. Shelving and dresser. W/D OPT           | 25. Folding work station                 |
| 8. 1,500 lb. folding patio deck          | 17. 5' x 8' walk-in closet and gear storage | 26. Bunk beds in sleeping position       |
| 9. 32" x 36" shower                      | 18. Mini-split A/C indoor air handler       | 27. 36" hanging closet if W/D installed  |



# HD24 Interior

36

Derived from and inspired by the flagship **HD30** model, Living Vehicle® has conceived the 24-foot **HD24** model with the same amount of power, off-grid capabilities, and luxury. Designed exclusively for 2-4 travellers, the **HD24** features a tremendous amount of storage with a residential-size walk-in closet. The primary sleeping space becomes the euro-loft, with guest sleeping for two. ✓



LIVING VEHICLE®

37



# HD24 Interior

As standard equipment, the Euro Loft is the primary sleeping space that tucks up against the ceiling and is deployed in mere seconds.

Adaptable guest sleeping for two, the **HD24** model sleeps a total of four.



Gear Closet Configuration shown. Optional Configuration available with Bunk Room with Folding Office.

Climate-controlled dedicated zone heat and A/C capable.

5' x 8' walk-in closet and gear storage locker, featuring 8' full height clothes hanging rod with wall-to-wall shelf.

Washer/dryer installed as part of the Luxury Housekeeping option and storage shelving unit.



Rearward of the walk in closet door, the **HD24** model is identical to the **HD30** ←



“Be a yardstick of quality.  
Some people aren’t used to an environment  
where excellence is expected.”  
- Steve Jobs -





# HD30

## PRO MODEL

2024

46

### THE HD30 PRO

Featuring perpetual power from natural resources, the **HD30** is the very definition of *Luxury Unplugged*. The **HD30** inspires ultimate freedom from the grid, and offers the most powerful insurance policy, granting fierce independence for autonomous living and travel. At 30 feet, the vehicle is akin to a luxury motor yacht on the open sea. The **HD30** features all the best luxuries and capabilities Living Vehicle® has to offer. Conceived from the desires of customers who call Living Vehicle home, we welcome a new era of the flagship Living Vehicle® model.

### MINI-SPLIT AIR CONDITIONING

Featuring heat and cool capabilities, the combined 24K BTU conditioning power makes exploration to the hottest and coldest climates an off-grid reality, ultra-efficient and completely electric.

### 4-SEASON PERFORMANCE

From the Mojave Desert sun to the High Sierra snowpack, with the 4-Season package as standard equipment, the **HD30** has a remarkable ability to travel down to -4°

### DUAL SOLAR AWNING

Featuring the most solar ever installed on a travel trailer, the Dual Solar Awning is an engineering marvel. A 48" horizontal knife edge aluminum plane extends out to space on each side of the **HD30**.

### KING BEDROOM SUITE

The innovative HD model comes with new and never-before-seen accommodations for the Living Vehicle®. The king bed is truly luxurious and explicitly designed for those who enjoy the most luxurious sleeping space and unmatched for those who place a high value on gear storage.



# HD30 Exterior

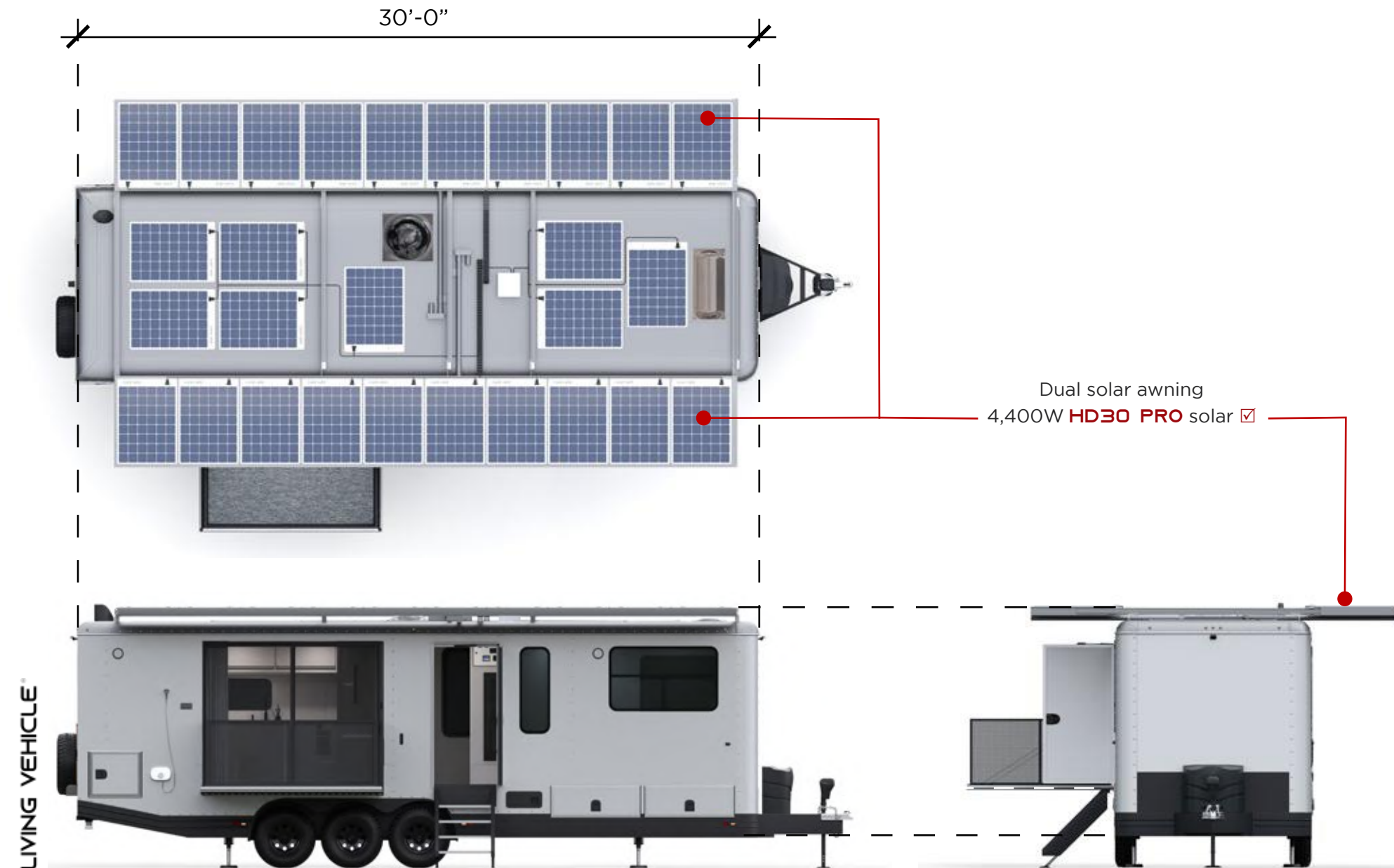

**RIGHT** Street side dual solar awning along the roof line of the **HD30 PRO**. The European-Style Mini-Split A/C is fully integrated into the exterior design. ☑

**BELOW** Triple-axle with all-terrain capability option installed. Goodyear Wrangler M/T tires.



# HD30 Interior Layout

## LEGEND

1. Convertible lounge to queen guest bed
2. Dining table converts to coffee table
3. 42" 4K TV with media center shelving
4. Drawer dishwasher OPT
5. Cooktop
6. Movable kitchen island
7. 8' patio slider
8. 1,500 lb. folding patio deck
9. 32" x 36" shower
10. 13 CU.FT. solar refrigerator
11. Hallway shelving unit
12. Monitor panels
13. Bathroom
14. Vitreous China toilet
15. Entry
16. Shelving and dresser. W/D OPT
17. Full-height closet with shelf
18. Dresser at foot of bed
19. OPT King bed shown. STD Queen
20. A-frame and hitch, in front

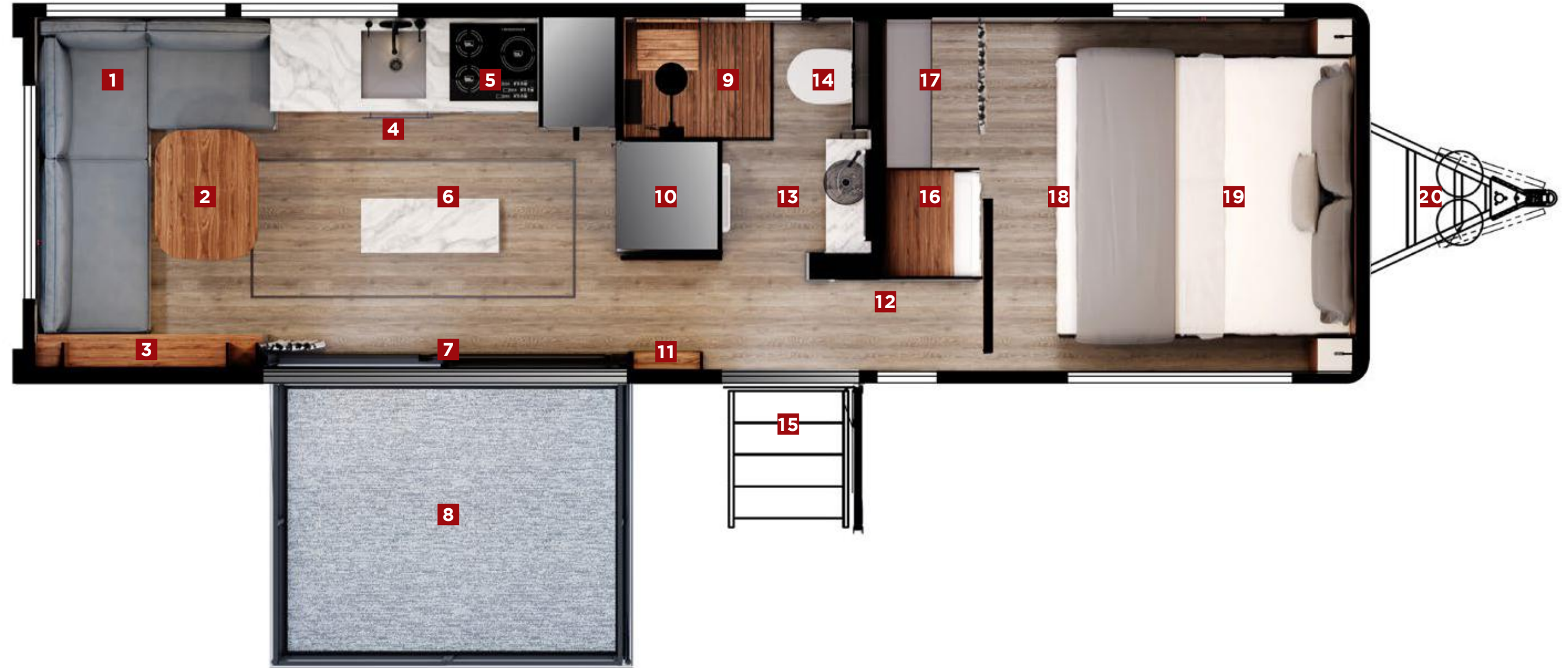

# HD30 Floor Plan Options



## QUEEN BEDROOM SUITE

The standard sleeping arrangement since the inception of Living Vehicle® is the residential-size Queen Bedroom Suite, standard equipment on the HD30 Series. Presenting a true residential-size queen bed at 60" x 80", the arrangement fits perfectly in the bedroom. A charging station anchors a generous-sized nightstand on each side of the bed, an LED reading light, and LVenergy powered outlet. The two-touch operation, dimmable, and flexible neck LED reading lights are centered on each side of the bed.

The Queen Bedroom Suite provides significant storage. A 4-drawer dresser is accessed from the foot of the bed to supplement the 28 cubic foot lift-up storage compartment. An overhead storage compartment is centered over the bed with multiple secure storage lockers. The expanded 6-foot-wide closet houses a full-height hanging clothes rod, upper shelf, and storage module with an optional washer/dryer.

## KING BEDROOM SUITE

The king sized bed is truly luxurious and explicitly designed for those who enjoy the most comfortable sleeping space possible.

The King Bedroom Suite is unmatched for those who place a high value on gear storage. A 6-drawer dresser is accessed from the foot of the bed to supplement the 35 cubic foot lift-up storage compartment.

## TWIN-TWIN BEDROOM SUITE

The Twin-Twin Bedroom Suite is perfect for those who prefer two autonomous sleeping spaces. Two twin beds are installed on the left and right sides of the bedroom suite. Separated by a generous single central night stand, the Twin-Twin Bedroom Suite provides an elegant independent sleeping solution for two adults.

The Twin-Twin Bedroom Suite also provides significant storage. A 2-drawer dresser is accessed from the foot of each Twin bed to supplement the 14 cubic foot lift-up storage compartment under both beds.

## MOBILE OFFICE BEDROOM SUITE

The Living Vehicle® lifestyle is intentionally built for travel, freedom, and adaptability. Purposely designed for work, the dedicated desk component is the cornerstone of the Mobile Office package and is a functional work of art. The bed component of the system is entirely hidden and tucked neatly and discreetly away when not deployed.

With the Mobile Office option, the available Creative Studio makes working anywhere a reality, even in demanding creative industries. The technology foundation of the studio may be fully customized, featuring the highest-end equipment from Apple.®



# HD30 Interior

56

**OPPOSITE** Natural finishes inspired by the great outdoors draw light inside. An unquestionable feeling of openness exudes throughout the timeless modern design of Living Vehicle's® living spaces.

**RIGHT** Integrated storage solutions abound in the chef-designed kitchen. High end appliances are organized to enhance workflow of space for real-world cooking dynamics.



# HD30 Bedroom



58

LIVING VEHICLE®

## RESIDENTIAL WARDROBE

Extensive storage in the 6-foot wide closet, featuring the integrated washer-dryer combo.



## MOBILE OFFICE + CREATIVE STUDIO

Optional mobile office converts to a queen bedroom suite. The 80" wide, dual station office may be fully customized.



59

2024 HD30 INTERIOR

## DUAL SOLAR AWNING

Featuring up to 4,400 Watts of solar on the HD30-PRO





# GT SERIES

# GT SERIES

## GT32

### ECO | COR | MAX | PRO

Length	32'
Width	8'-6"
Base Weight	12 - 13K
GVWR	16K
Axles	2
Energy	21 - 72kWh
Power	6 - 18kW
Solar	1.2kW-3.4kW (5kW OPT)
Sleeping	4 - 6
Temp. Rating	-4°F - 120°F



## GT38

### ECO | COR | MAX | PRO

Length	38'
Width	8'-6"
Base Weight	15 - 17K
GVWR	20K
Axles	3
Energy	21 -72kWh
Power	6 - 18kW
Solar	2kW-4.4kW (6kW OPT)
Sleeping	4 - 8
Temp. Rating	-4°F - 120°F



### LIVING VEHICLE® GT32

Introducing the Living Vehicle® **GT32**: Where Grandeur Meets Exploration. Meticulously crafted over a 32-foot span, this model is the epitome of luxury fused with adventure. Harnessing the stability and strength of a 5th wheel gooseneck hitch, it promises both a seamless drive and an expansive living space. With the advanced power and energy capabilities synonymous with the Living Vehicle® brand, off-grid travel is not just an option, it's a guarantee. The redesigned front bedroom offers an oasis of comfort, featuring the king bed loft. The Living Vehicle® **GT32** awaits – crafted for those who demand nothing but the best in their adventures.

### LIVING VEHICLE® GT38

Unveiling the Living Vehicle® **GT38**: The Pinnacle of Luxurious Exploration. Building on the rich legacy of the **HD30**, the **GT38** extends to a lavish 38-foot floor plan and is firmly grounded with a 5th wheel gooseneck hitch. This model is both an embodiment of luxury and a symbol of relentless innovation.

The **GT38** isn't just about space; it's about the intelligent use of it. The front bedroom is nothing short of monumental. Experience sleep like never before on a loft king bed, designed with nights of unbroken rest in mind. For the modern traveler and digital nomad, the dedicated office suite is a game-changer. During the day, it serves as a robust 2-person workstation, ensuring productivity isn't sacrificed on the road. By night, it effortlessly transforms into an additional sleeping space, offering versatility like never before.

# GT32

## Adventure Travel Unplugged

2024

When it comes to combining the allure of travel with the practicalities of towing, the **GT32** stands in a league of its own.

66

### Built for the Journey

Every feature of the **GT32**, from its aerodynamic design to its robust tires, speaks to its travel-centric ethos. The structure is designed to reduce wind resistance, making it more fuel-efficient and easier to tow even in challenging weather conditions.

Despite its expansive size and luxurious amenities, the **GT32** has been crafted with meticulous attention to weight distribution. The 5th wheel design inherently offers superior stability, making it less susceptible to swaying and ensuring a smoother towing experience.

### Gooseneck Advantage

The gooseneck hitch is not just a design choice; it's a statement of functionality. It offers increased turning radius, allowing for tighter turns and easier maneuverability in challenging terrains. Plus, the weight distribution over the truck's rear axle provides better control and less strain on the towing vehicle.

Recognizing that an excellent towing experience is also a safe one, the **GT32** is equipped with state-of-the-art braking systems, high-quality lighting, and other safety features. These ensure that you and your loved ones remain protected, even on the most adventurous journeys.

### The King Bedroom Suite

The front bedroom area of the **GT32**, featuring a loft bed, is a masterstroke in design. This unique arrangement maximizes vertical space, creating a sense of expansiveness in a compact area. The elevated loft bed offers a cozy retreat, freeing up floor space beneath for storage or relaxation.

This design not only provides an intimate sleeping experience but also ensures that every square foot is utilized efficiently. For those seeking a harmonious blend of comfort and functionality, the loft bed setup in the front bedroom is an exemplary choice.





# GT32 Interior Plan

## LEGEND

1. Convertible lounge to Queen bed
2. Dining table converts to coffee table
3. 42" 4K TV with media center shelving
4. Drawer dishwasher OPT
5. Cooktop
6. Movable kitchen island
7. 8' patio slider
8. 1,500 lb. folding patio deck
9. 32" x 36" shower
10. 13 CU.FT. solar refrigerator
11. Hallway shelving unit
12. Monitor panels
13. Bathroom
14. Vitreous China toilet
15. Entry
16. Shelving and dresser. W/D OPT
17. Hanging Closet
18. Master Bedroom Suite
19. Platform Step & Setee
20. King Bed Sleeping Platform
21. Room Divider Curtain
22. King Bed 76" x 80"

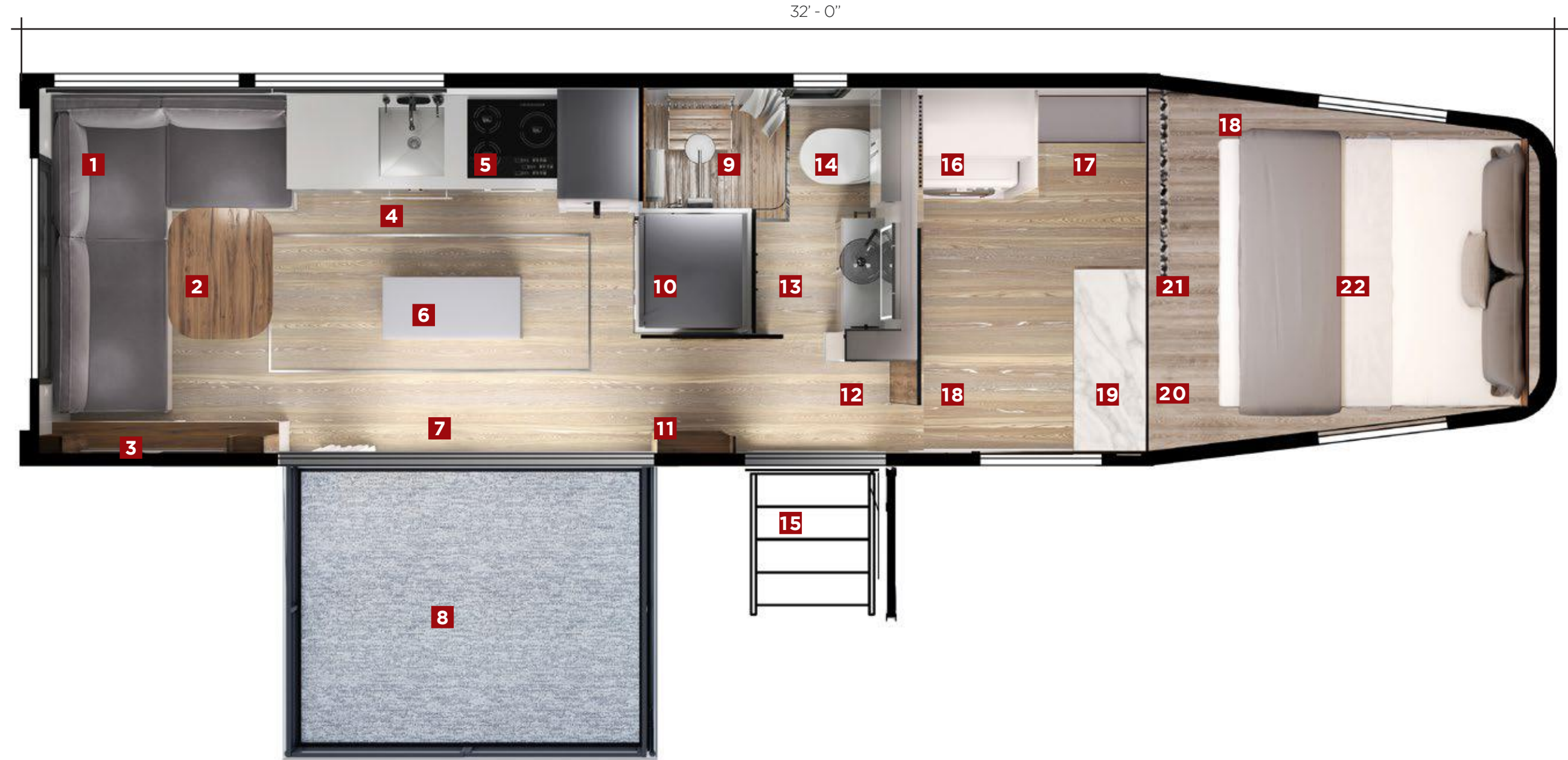

70

71



# GT38

## Elevate Every Journey

2024

Inspired by luxury yachts, the **GT38** redefines terrestrial travel by seamlessly blending unparalleled craftsmanship with advanced functionality in its flagship fifth wheel design.

74

### Luxurious Living

The Living Vehicle® **GT38** is not just a trailer; it's a statement of grandeur. Drawing inspiration from the already renowned **HD30**, this fifth wheel stretches the boundaries of luxury living. The expansive master suite, crowned with a lofted king bed, feels akin to a penthouse suite.

Every square foot has been meticulously designed, reflecting the kind of attention to detail and luxury you'd expect from the finest motor yachts. Yet, here it is, perfectly curated for land based adventures.

### Craftsmanship and Quality

As the flagship offering from Living Vehicle, the **GT38** spares no expense in delivering unmatched quality. Every material, fixture, and feature has been selected with a commitment to longevity and aesthetics.

The result? A space that's not just designed for the present but built to withstand the test of time. It's a testament to craftsmanship where every seam, joint, and surface echoes a dedication to perfection. When you invest in the **GT38**, you're not just acquiring a trailer; you're inheriting a legacy of excellence.

### Unparalleled Travel Experience

Beyond its striking aesthetics and impeccable quality, the **GT38** is, at its heart, a vessel for unparalleled adventures. Akin to a luxury motor yacht designed for the open seas, this fifth wheel is engineered for the open road. Its size, while impressive, never compromises on agility or safety.

Every journey becomes an experience, seamlessly merging the thrill of travel with the comforts of home. Whether nestled in a secluded woodland or stationed at a premium RV park, the **GT38** guarantees a travel experience that's second to none.



# GT38 Interior Plan

## LEGEND

1. Convertible lounge to queen guest bed
2. Dining table converts to coffee table
3. 42" 4K TV with media center shelving
4. Drawer dishwasher OPT
5. Cooktop
6. Movable kitchen island
7. 8' patio slider
8. 1,500 lb. folding patio deck
9. 32" x 36" shower
10. 13 CU.FT. solar refrigerator
11. Hallway shelving unit
12. Monitor panels
13. Bathroom
14. Vitreous China toilet
15. Entry
16. Shelving and dresser. W/D OPT
17. Full-height closet with shelf
18. OPT Mobile Office & Queen Guest Bed
19. OPT 80" Desk, Fixed Queen Bed, or Open
20. Master Bedroom Suite & Office
21. Platform Step & Setee
22. King Bed Sleeping Platform
23. Room Divider Curtain
24. King Bed 76" x 80" OPT Storage Room

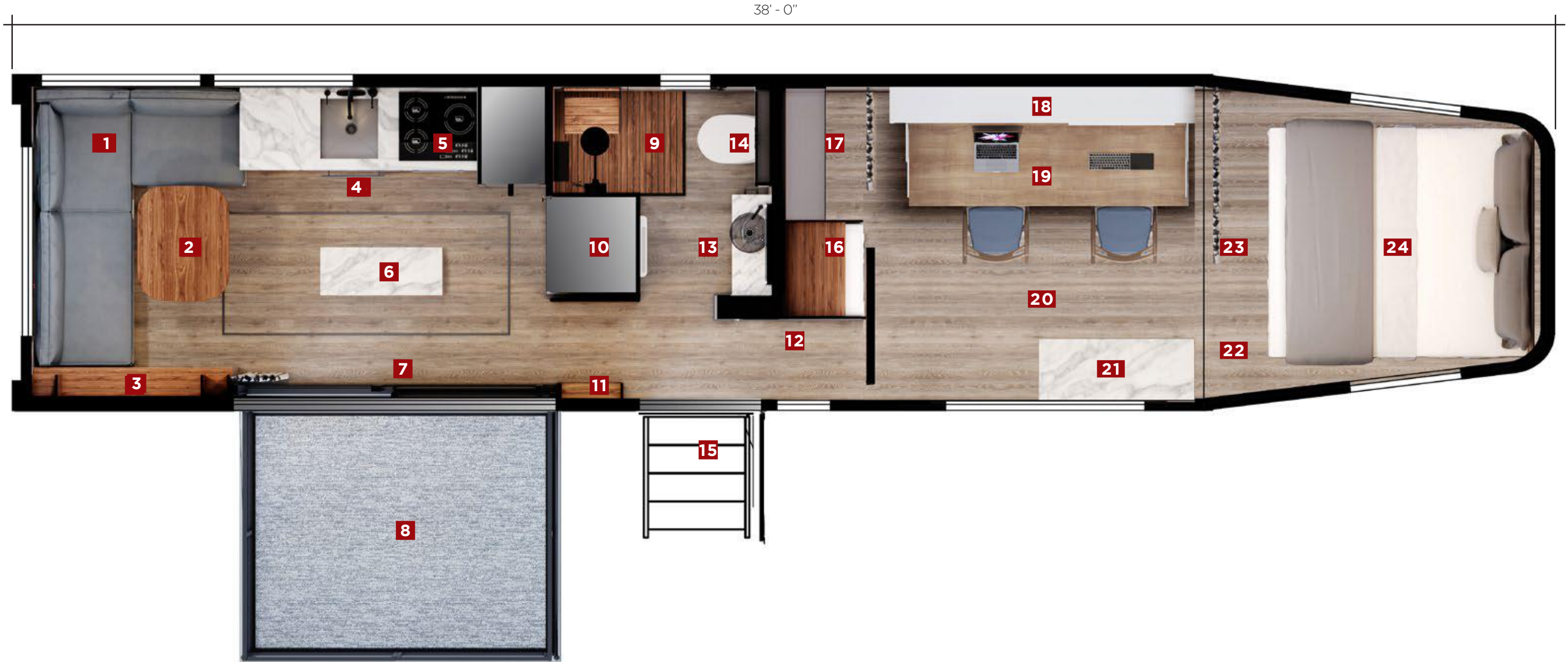

38' - 0"





Energy System	ECO	COR	MAX	PRO		Legend
Solar Base <b>HD</b>	600	2000	3000	4400	W	● LVenery Powered
Solar Base <b>LT</b>	600	1200	2200	3400	W	○ Non LVenery Power
Solar Deployable OPT	1600	1600	1600	1600	W	- Not Available
Inverter Power	2	6	12	18	kW	
Energy Pack Size	4.8	21.6	43.2	72	kWh	
Equipment	ECO	COR	MAX	PRO		
Level-1 EV Charging	○	●	●	●		
Level-2 EV Charging	-	-	-	●		
Mini Split A/C & Heating	○	●	●	●		
Solar Awning	-	-	●	●		
Dual Solar Awning	-	-	-	●		
Interior 120V Outlets	●	●	●	●		
Exterior 120V Outlets	●	●	●	●		
Microwave	●	●	●	●		
Refrigerator	●	●	●	●		
Auto Leveling	●	●	●	●		
4 Season Extreme	-	-	○	●		
Air and Water Quality	○	●	●	●		
Automatic Euro Loft	●	●	●	●		
Backup Power Generation	●	●	●	●		
Creative Studio	○	●	●	●		
Electrified Chef's Kitchen	-	-	-	●		
Hi-Fi Audio	●	●	●	●		
Home Theater	●	●	●	●		
Interior Automation	●	●	●	●		
Luxury Housekeeping	○	○	●	●		
Water Generation	-	●	●	●		
Mobile Connectivity	●	●	●	●		
Performance Towing	●	●	●	●		
Hose & Cord Automation	●	●	●	●		
Remote Security	●	●	●	●		
Spa Bathroom (w/ Bidet)	●	●	●	●		
Spa Bathroom (w/ Compost)	●	●	●	●		
Split Queen Auto-Lounge	●	●	●	●		
Interior Automation	●	●	●	●		
Water Generation	-	●	●	●		
Zero Gravity Lounge	●	●	●	●		

# Materials

## EXTERIOR COLOR

### BACK PANEL

The signature design feature of every Living Vehicle® is expressed in the rear occulus. The 8" anodized aluminum frame is offset from the rear side wall 2", surrounding the back wall of the LV. Available in three distinct and striking colors, the recessed back panel may be personalized with every new Living Vehicle® order.

White establishes a stark contrast between the rear elements, highlighting all features.

Aluminum is the very same demure anodized finish as the remaining exterior, designed to match and unite the exterior design.

The most dramatic, black anchors all elements on the rear elevation. The frameless window visually disappears and unites the design.

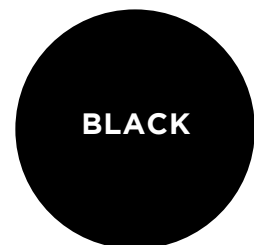
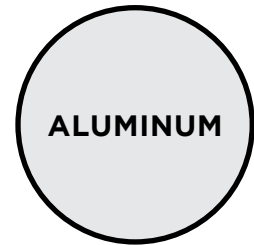
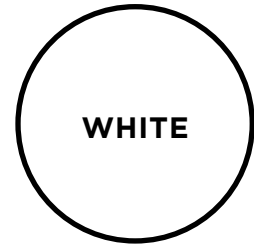

**POWDERCOATING**



**ULTRALEATHER**



**BLACK WALNUT**



**WALNUT DECK**



**LVL**



**MATTE BLACK**

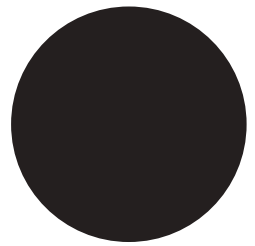

**SOLID SURFACE**



**STAINLESS**





# Trim Levels

All trim levels apply to all models across the Living Vehicle lineup. Slight variations apply from model to model.

## ECO

The entry-level ECO trim in the Living Vehicle lineup is far from basic, offering an impressive array of standard features. Built for up to 7 days off-grid, the ECO Series Energy System includes a 600W rooftop solar setup with Sunpower MAXEON Monocrystalline Panels, a 2kWh inverter, and 4.8 kWh of energy storage. Inside, you'll find a Queen Bedroom Suite Package, a well-equipped kitchen with residential-size solar refrigeration and a gas stove, a luxurious bathroom with a rain shower, and a versatile living and dining area with a pull-out sofa sleeper.

Additional features include a gas heating system, tankless water heater, LED lighting, ample tank capacities, and a robust aluminum chassis. The ECO trim also includes standard packages like the Mini Split 240V Electric Heating & Cooling System, LV Entertainment Suite with SONOS audio and a 42" 4K Smart HDTV, Black Walnut Furnishing Package, LV Designer Finishes Package, Mobile Connectivity Package, and Sun & Stars Skylights Package.

Various optional equipment choices are available for further customization, making the ECO trim an excellent choice for those seeking eco-friendly, well-equipped, and adaptable luxury in their mobile lifestyle.

## COR

The COR trim level in the Living Vehicle lineup is designed for longer off-grid adventures, offering standard features that support stays of 7-14 days or more. It boasts a robust 2,000W rooftop solar system with Sunpower MAXEON Monocrystalline Panels and a 6kWh Dual-Core Victron Hybrid inverter, paired with 28.6V Lithium Phosphate batteries providing 21.6 kWh of storage capacity. This trim level even supports Level 1 EV charging at outdoor outlets.

Inside, you'll find the Queen Bedroom Suite Package, a well-equipped kitchen, luxurious bathroom, and a versatile living and dining area. Standard features include the Mini Split 240V Electric Heating & Cooling System, LV Entertainment Suite with SONOS audio and a 42" 4K Smart HDTV, Black Walnut Furnishing, LV Designer Finishes, Mobile Connectivity, and Sun & Stars Skylights.

Optional equipment allows further customization, making the COR trim perfect for off-grid enthusiasts seeking extended comfort and self-sufficiency.

## MAX

The MAX configuration in the Living Vehicle lineup is designed for extended off-grid living, offering an impressive array of standard features for up to 30 days off-grid. Notably, the MAX trim includes several new features compared to the COR and ECO trims.

The MAX Series Energy System includes a robust 3,000W rooftop solar setup with the single solar awning and an additional 400W deployable solar array. The power system boasts a 12kWh 4-Core Victron Hybrid inverter and 43.2kWh of storage capacity. Level 1 EV charging at outdoor outlets is supported, along with the LV Energy Console & Management System and remote monitoring.

New features in the MAX trim include the King Luxury Bedroom Suite Package with a spacious aluminum king bed, integrated under-bed dresser, and more. The MAX trim also comes with the Air and Water Quality Package featuring mechanical outdoor air intake, a MERV 13 filter system, UV sterilization at the kitchen faucet, and other enhancements.

The MAX trim is the ultimate choice for those seeking an extended off-grid adventure with top-of-the-line features and capabilities.

## PRO

The flagship PRO trim level in the Living Vehicle lineup represents the pinnacle of off-grid luxury living. It offers nearly every available option as standard equipment and is capable of providing energy to every onboard system indefinitely.

The PRO Series Energy System is a powerhouse with a 4,400W rooftop solar setup, Sunpower MAXEON Monocrystalline Panels, and an 800W deployable solar array. It boasts an 18kWh 6-Core Victron Hybrid inverter and an impressive 72kWh of storage capacity. Level 1 and Level 2 EV charging capabilities are included, along with the LV Energy Console & Management System and remote monitoring.

The PRO trim includes a King Luxury Bedroom Suite Package with a spacious aluminum king bed, extensive storage, and a premium Austroflex European Foam Mattress. It also comes with the 4 Season Extreme Package for extreme weather conditions and the Chef's Kitchen Package for culinary enthusiasts.

With features like in-ceiling speakers, a home theater package, water generation technology, and luxury finishes throughout, the PRO trim offers a truly opulent living experience. It's the ideal choice for those seeking the ultimate in off-grid luxury and self-sufficiency.



# Packages

## POWER

### LVenergy Remote Console **ECO COR MAX PRO**

Every Living Vehicle® comes factory equipped with over-the-cloud connectivity so you have complete visibility on the current state of the LVenergy system. With real-time energy flow, battery state of charge, and temperature monitoring, knowledge is power.

go

### MARINE POWER CENTER **ECO COR MAX PRO**

The LVenergy system is built to the highest standard available and constructed on a rock-solid foundation of marine-grade technology.

### LEVEL 1 EV CHARGING **ECO COR MAX PRO**

The energy stored in the LV Energy system may be transferred into an electric vehicle. When depleted, the LV® recharges completely off-grid using solar, Energy Integration, or Backup Generator power. Level 1 120V power provision for all basic electrical charging needs.

### LEVEL 2 EV CHARGING **PRO**

Rapid charging features a 240V power provision for all electrical charging needs. Ultimate flexibility provides an open-source platform that allows simply plugging your favorite Level-2 charger into the outlet provided.



### SOLAR AWNING **MAX PRO**

Standard equipment on the **MAX** and **PRO**, the Solar Awning is a proprietary design by Living Vehicle® that doubles the amount of solar. The top layer of panels exposed to the sun's rays will always be charging, even when towing the vehicle. The solar awning is deployed in seconds with the flip of a switch providing shade for the patio side of the LV®.

### DUAL SOLAR AWNING **PRO**

The Dual Solar Awning features the most potent solar installed on a travel trailer – truly an engineering marvel. A 48" horizontal knife-edge aluminum plane extends to each side of the **PRO** trim levels.

### BACKUP POWER GENERATION

Designed to provide peace of mind during travel in cloudy or winter environments, the generator will provide a vital backup source of power when solar is not available to recharge the energy system and power high-voltage equipment.

### ENERGY INTEGRATION

The proprietary LVenergy alternator is installed into the owner's tow vehicle. Built for high power and rapid charging, the system may be engaged while towing or parked and running the engine idle.

### DEPLOYABLE SOLAR **MAX PRO**

These stowed solar panels are always ready when the Living Vehicle® is parked under shade or in low sun conditions when you simply need the most solar power generation available. The panels are readily stowed in the pass-through compartment in the basement at the front of the Living Vehicle®.



# Packages

## OFF-GRID RESOURCES

### WATER GENERATION PRO

The innovation of LV Water Generation gives owners the independence and freedom to enjoy the most luxurious, mineral-rich water from the comfort of their Living Vehicle® wherever their off-grid journeys take them, even in the most arid and remote locations. Watergen's® patented technology extracts water from the air in a highly efficient manner. Using food-grade materials and a multi-stage cleaning and filtration process, it becomes a safe and delicious source of drinking water without extracting and filtering groundwater.

Watergen® water-air generator is paired with Living Vehicle's® oversized freshwater tank, multiple redundant power sources, energy storage packs, and off-road capabilities. All this allows owners to comfortably extend their freedom on the road and in remote locations longer than ever before.

### INTEGRATED PROPANE TANK COR MAX PRO

When the sun's energy is unavailable due to cloud cover or nightfall, a backup fuel source becomes invaluable. Capable of running the electrical generator or the backup heat supply, the significant expansion of the fuel storage tank will allow even greater peace of mind.

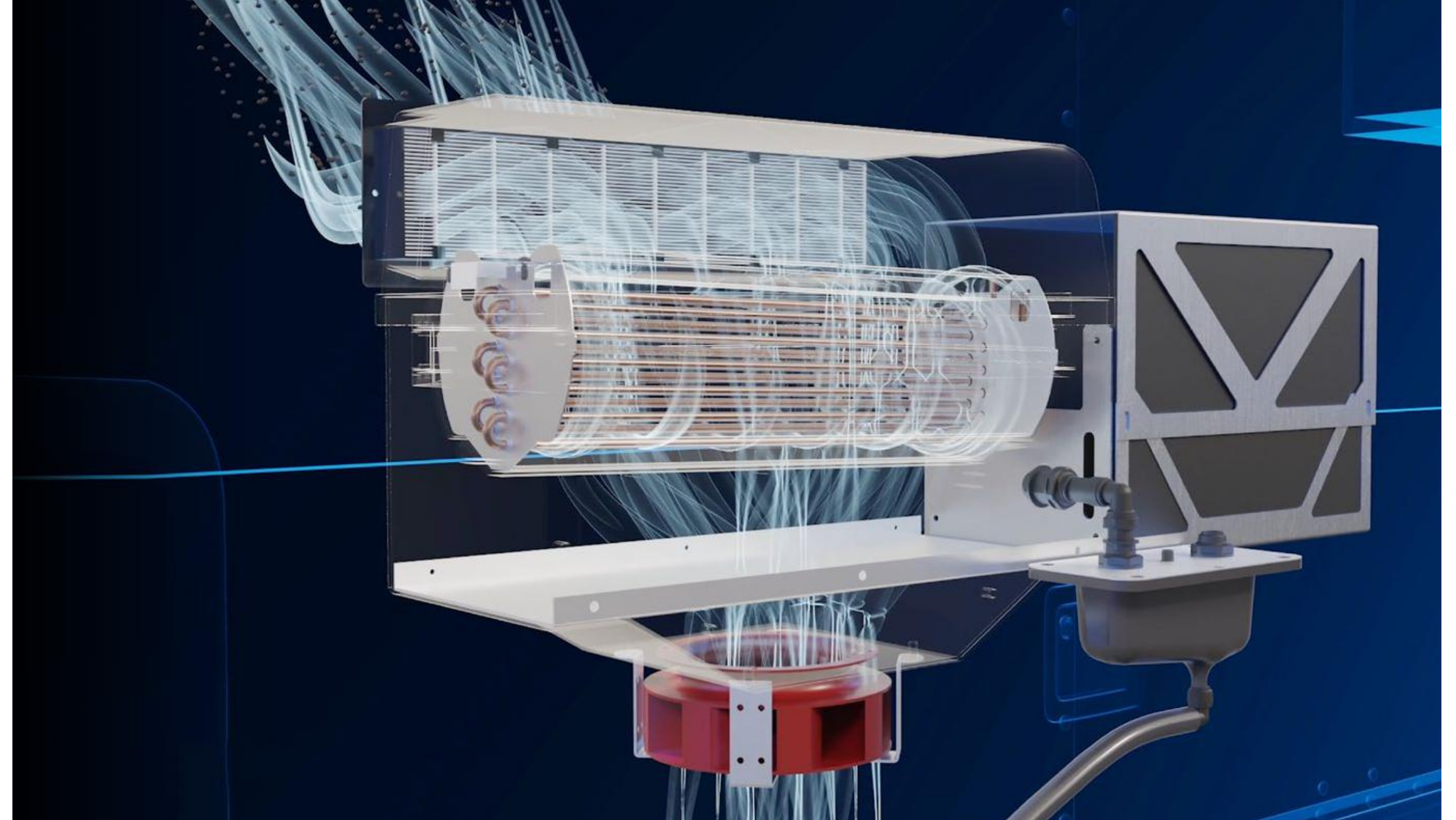

# Packages

## TRAVEL

### HD CHASSIS ECO COR MAX PRO

Living Vehicle® is assembled on top of the fully integrated commercial-grade aluminum chassis. Steel reinforcements are placed at high-stress points for added rigidity and load transfer.

### PATIO DECK AUTOMATION ECO COR MAX PRO

Site setup has never been easier. The proprietary Living Vehicle® patio deck system may be fully deployed in minutes. Install the included power cable with a momentary switch to engage the high-capacity power winch located down in the basement to activate the deck mechanism.

### REAR GEAR STORAGE ECO COR MAX PRO

The Living Vehicle® comes with a universal 2" hitch style receiver for all gear storage solutions that provide ultimate flexibility and capability. With a vertical load capacity of up to 500 lbs., the mount will accommodate all types of off-the-shelf storage racks, including bike racks, gear lockers, SUP storage, and many more.

### 4-SEASON PERFORMANCE ECO COR MAX PRO

The 4-Season Performance package extends the thermal capability of the Living Vehicle® to allow travel to more extreme ranges in both hot and cold climates. Adding the 4-Season Performance package lowers the minimum rating to -4°F and the maximum rating to 120°F.<sup>1</sup>



### NIGHT EDITION PRO

The protective coating is visually and functionally striking as a grounding element on the **PRO** model. Specialized, high-performance spray-on elastomeric coating is engineered for maximum durability, absorption of impacts, and resistance to damage by remaining flexible and robust.

### AUTOMATIC LEVELING COR MAX PRO

Previously reserved for commercial-style coaches and buses, this hydraulic leveling system will automatically deploy 4-point stainless-steel legs and lift the Living Vehicle® in various terrain environments. Simple, one-touch operation for fully automatic leveling of the Living Vehicle®.

### ALL-TERRAIN CAPABILITY PRO

For those who desire the most remote regions of our world, the All-Terrain Capability package will provide the enhanced equipment to get you there - and take Living Vehicle® farther than ever.

### TOWING PERFORMANCE MAX PRO

Designed to move, the Living Vehicle® is built from the ground up for safe and stable towing. A camera system is installed with a rear camera and an in-vehicle monitoring screen for excellent travel visibility. For late-model tow vehicles, the Performance Towing package can integrate directly into the tow-vehicle's in-dash monitor.

### HOSE & CORD AUTOMATION MAX PRO

Zero-effort pull-out technology allows utility connection points to be accessed at a moment's notice. Motorized retraction organizes hose and cord systems in a highly-convenient storage system.





# Packages

## TECHNOLOGY

98



### Coast-to-Coast Connectivity

#### STARLINK® Satellite Internet **ECO COR MAX PRO**

Providing connectivity wherever you travel, the 2024 Living Vehicle® offers satellite connectivity at the fastest speeds and most reliable connection.

With ultra-fast internet available in even the most remote environments.

Offered on the 2024 **HD** and **LT** Living Vehicle®, the Starlink In-Motion RV Flat High-Performance Dish is an option to the Mobile Connectivity package. Starlink® is a registered a trademark of Space Exploration Technologies Corp.

99



### The Connectivity Hub **ECO COR MAX PRO**

A dedicated router is the secure Living Vehicle® network hub and remote management of the LVenergy system.

# Packages

## TECHNOLOGY

### MINI-SPLIT A/C & HEATING **ECO COR MAX PRO**

An absolute innovation in the industry, Living Vehicle® features a dual-zone, fully integrated, European-style mini-split air conditioning system. With tremendous efficiency, the SEER 21 system draws a fraction of the power of comparable traditional RV-style rooftop systems. Featuring heat and cool capabilities, the combined 24K BTU conditioning power makes exploration to the hottest and coldest climates an off-grid reality, ultra-efficient and completely electric. Rated down to -4° and up to 120°.

### HI-FI AUDIO **PRO**

The Hi-Fi Audio package utilizes the most modern audio technology for a supremely elevated audio experience through multiple zones of Living Vehicle®. Powered by SONOS® (1), this becomes the digital entertainment hub of the audio and video system.

### MOBILE CONNECTIVITY **ECO COR MAX PRO**

The Mobile Connectivity package utilizes state-of-the-art technology from industry leaders in cell and WIFI boosting functionality to significantly extend the connectivity and speed of multiple mobile data sources. Compatible with the industry's leading internet technology, the WIFI booster combines outdoor WIFI antennas, an LTE modem, and Starlink®.



### HOME THEATER **PRO**

The Home Theater package transforms the bedroom into a high-end mobile cinema, featuring HD video and a surround sound experience. Centering the private theater room is a 70" pull-down screen with an overhead ceiling-mounted projector at the rear of the room that displays 4K HD video and seamlessly blends into the space's modern design.

### REMOTE SECURITY **MAX PRO**

The Remote Security package provides a series of security upgrades to provide additional safety measures while traveling. A video doorbell provides the owner real-time visibility from the entry side of the Living Vehicle® from virtually anywhere in the world. The onboard safe protects valuables.

### CREATIVE STUDIO

The Living Vehicle® Creative Studio makes working anywhere a reality, even within demanding creative industries. Coupled with Living Vehicle's® technology and sustainable power behind the LVenergy system, editors, producers, animators, architects, developers, and all decentralized creative professions in between can seamlessly work on the road without being restricted for ultimate freedom and creativity. Living Vehicle® is the only off-grid trailer with the power and devices to run a technologically reliant business from the utmost remote locations.



Photo Credit: Apple

# Packages

## LIVING

### LUXURY HOUSEKEEPING **COR MAX PRO**

One of the most lavish luxuries is the freedom to choose how one spends the most valuable resource – time. The Luxury Housekeeping package is about reducing the necessary tasks that occupy much of our daily routine to free up time to do the things we love. The Luxury Housekeeping option features a washer/dryer combo, dishwasher and central-vac system.

### INTERIOR AUTOMATION **PRO**

LV is designed to suit the needs of many uses in one adaptable solution. When converting between functional uses, the ease of conversion from one to the next is dramatically enhanced with the elevated convenience of the Interior Automation package. The interior blinds and dining table base are upgraded to automation system control.

### PATIO DECK AUTOMATION **ECO COR MAX PRO**

Embrace the outdoors with the LV exclusive patio deck living space. Automatic winch control raises and lowers the 1500 lb. rated patio with the simple push of a button.

### LUXURY FINISHES **PRO**

The Luxury Finishes package upgrades the finish quality and luxury appearance of the major design elements in the Living Vehicle®. Featuring the walnut shower back panel, rich black walnut architectural accent surfaces are selectively installed throughout the entire Living Vehicle® interior living space.

### AIR & WATER QUALITY **MAX PRO**

Given the uncertainty of the natural resource quality we travel to, the Air and Water Quality package is designed to improve the air and water quality inside your Living Vehicle®.

### ELECTRIFIED CHEF'S KITCHEN **PRO**

The Chef's Kitchen package elevates the function and luxury of Living Vehicle® cooking and entertaining lifestyle. Fully electric appliances and equipment are exclusive to and only available on the **PRO** trim level. Powered by the LVenergy system, the Electrified Chef's Kitchen leverages the massive onboard energy reserves and provides 240/120V of power.

### ZERO GRAVITY LOUNGE

The dual-zone head and foot may be raised independently for any number of sleeping, reading, or entertainment viewing positions – with the simple push of a remote control. Ultra-high quality, contour-fitting cold foam is purpose-built to be extremely comfortable.

### HD24 WALK-IN CLOSET or BUNK / OFFICE ROOM

#### **ECO COR MAX PRO**

The front room of the **HD24** Living Vehicle® floor plan highlights a massive 5' x 8' walk-in closet, expansive even by residential standards, conceived for the adventurer, explorer, and digital creative with high requirements for gear storage. For no extra charge, the optional configuration is a bunk bed, closet, and folding desk system for ultimate adaptability.

### LIVING & BEDROOM EURO LOFT

In a stroke of adaptable design magic, welcoming visitors to your home is always having a guest bed at the ready. Available in the living or bedroom, the EuroLoft™ adds a conveniently hidden space for two guests to sleep and increases the LV® sleeping capacity from the standard of 4 adults to 6.

### MOBILE OFFICE

Purposely designed for work, the dedicated desk component is the cornerstone of the Mobile Office package and is a functional work of art. The work environment consists of a large walnut desk, suitable for two side-by-side workstations. The bed component of the system is entirely hidden and tucked neatly and discreetly away when not deployed.

### SPA BATH **PRO**

The Spa Bathroom package elevates the comfort, luxury, and convenience in the Living Vehicle® bathroom. The bath is transformed into a suite of highly functional equipment and sublime finishes, allowing for a fresh, peaceful, high-end retreat experience.

### STAR VIEW SKYLIGHTS **ECO COR MAX PRO**

Let there be light! The skylight package installs two carefully placed skylights to bring the outdoors in. One of the best sleep aids conceived is the bedroom skylight; watching shooting stars while perfectly cozy just before slumber is the ultimate relaxation.

### OFF-GRID SPA BATH **PRO**

All of the Spa Bathroom option features are maintained with a compost toilet replacing the standard toilet. The installation of the compost toilet fundamentally redesigns the wastewater management system.

# Towing



## Living Vehicle-LVt

### 350/3500 (1-ton)

Capacity : > 20k GVWR

Payload: > 3,500 lbs.

### 1-TON TOW VEHICLE

Purpose built to pair perfectly with the **HD24** and **GT32** modelw, we recommend a 1 ton full size pickup truck. The lighter and more nimble models are built for adaptability. We recommend a SRW (single rear wheel) or DRW (dual rear wheel) setup with a diesel engine configuration for added torque and fuel efficiency. A 5" lift kit with progressive rear end springs and air suspension maintains factory towing and payload while significantly increasing off-road capability and on-road small bump compliance.

## Living Vehicle-LVt

### 450 or 4500 (1-1/2 ton)

Capacity : > 20K GVWR

Payload: > 7,000 lbs.

### 1.5 TON TOW VEHICLE

The heavy-duty truck emerges from metamorphosis; a wide stance more akin to a Ford Raptor or RAM TRX but sheer presence and stature is unlike anything else on the road. Arguably the most head-turning, off-road capable tow vehicle ever made, the LVt 1-1/2 ton is a beautiful beast. While the stock DRW configuration is perfectly acceptable, it may be modified to a 40-inch Super-Single rear wheel conversion package, commonly found on forest service fire equipment. A custom bed and storage package is installed.





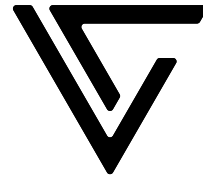

At Living Vehicle®, we understand that the luxury of adventure isn't solely in the journey, but also in the ease of the experience.

While our lineup, featuring both trailers and 5th wheels, is designed for towing, a significant portion of our discerning clientele opts for a hands-free approach.

Mirroring the luxury motor yacht industry, where owners employ a captain and crew for seamless delivery and setup, many of our customers engage specialized companies to handle transportation and deployment.

This offers them the unparalleled advantage of arriving at their destination with their Living Vehicle® impeccably set up and awaiting their arrival, merging convenience with the lavishness of the Living Vehicle experience.



# Certifications

## DESIGNED BY LEED® AP

With multiple company founders holding LEED® Professional Accreditation, Living Vehicle® has collectively experienced decades of professional course work and on-the-ground training in sustainability and environmental design. This commitment is a lifelong pursuit of education and understanding what it takes to build a quality and healthy living space. It is our foremost goal to create highly sustainable and healthy living spaces.



## RVIA® CERTIFIED

The RVIA® (Recreational Vehicle Industry Association) licenses and certifies RV manufacturers and only licensed manufacturers can produce a certified RV. The RVIA® certification means the RV was built and lives up to the National Fire Protection Association (NFPA®) safety standards, and the structure qualifies as an RV.



## DESIGNED BY ARCHITECTS

Living Vehicle® is founded by a licensed architecture professionals in the State of California.

## NADA® LISTED

RVIA® certification provides access to inclusion in NADA®, which stands for the National Automobile Dealers Association. NADA® provides access for MSRP values for new and preowned market valuation. Banks and lending institutions require listing in NADA® for financing.



## NATM® CERTIFICATION

The National Association of Trailer Manufacturers certification ensures manufacturers are producing safe, reliable trailers and trailer parts. NATM gives access to a library of resources offering recommendations and guidelines, which makes it much easier for manufacturers to follow and comply with the regulations



## GREEN RV TRA CERTIFICATION

Living Vehicle, based in Santa Barbara, California, has achieved the Certified Green designation from TRA Certification, earning the highest score ever recorded for any RV certified by TRA. This accomplishment solidifies their position as the leader in sustainable living and green building practices.

Living Vehicle has set a new standard in eco-friendly design and sustainable innovation. They recently attained the prestigious Emerald Off-Grid level of certification, showcasing their unwavering commitment to sustainability. Notably, their units feature up to 6kW of solar power, demonstrating their dedication to harnessing renewable energy sources.



## LOW VOC INDOOR AIR QUALITY

Living Vehicle® meets or exceeds the most stringent indoor air quality requirements of all government and private agencies including OSHA®, the Environmental Protection Agency (EPA®), National Institute for Occupational Safety and Health (NIOSH®), and the American Conference of Governmental Industrial Hygenists (ACGIH®).

Most notably, Living Vehicle® exceeds the IAQ standards for LEED, set by independent sustainability organizations like the USGBC. Reports available at LivingVehicle.com

Tested by JS Held  
Certified Industrial Hygenist



LEED® wordmark, LEED AP logo, and LEED logo are registered trademarks of the U.S. Green Building Council®

NATM® and NATM logo are registered trademarks of The National Association of Trailer Manufacturers®

RVIA® and RVIA logo are trademarks of Recreation Vehicle Industry Association, Inc.

NFPA® and NFPA logo are registered trademarks of the National Fire Protection Association

The NADA Guides logo is a registered service mark of the National Automobile Dealers Association

# Service

## LEVERAGED EXPERIENCE

We believe that an exceptional experience is more than just a quality product. The Living Vehicle® motto, “design by experience” spans all facets and extends to your direct enjoyment. When contacting your Customer Care Team, you will speak with someone who not only understands the product, but has lived the lifestyle.

## INDUSTRY KNOWLEDGE

Far from the status quo of vehicle ownership experience, your LV Care Team provides direct support with technical matters, warranty coordination, and other questions relating to your Living Vehicle®. No automated help lines, just a private number and a person you know by name.

## DEDICATED RESOURCE

Enjoy access to your very own LV® Customer Care Professional. The LV® Care Team is your connection to professionals who are intimately familiar with all aspects of the Living Vehicle® experience. It’s like having a good friend at your side at all times, wherever your adventures take you.



### CHASSIS & FRAME



### CUSTOM COMPONENTS



### 3RD PARTY COMPONENTS

# Warranty

## A PERSONALIZED EXPERIENCE

Stuff happens, we get it. While we strive to produce the best possible quality, there are times when something needs to be replaced or repaired. We believe that service should be easy and fit into your lifestyle. For this reason, we have designed a service program that is inherently flexible, personal and nationwide. We partner with service centers and mobile service technicians across the country to help get you back on the road as quickly and effortlessly as possible. One simple call to your personal LV® Care Team is all it takes.

## WARRANTY SUPPORT

Every new LV® comes standard with a 1-3-10 year factory warranty. Every LV® is backed by the most comprehensive service and warranty offering available in the industry. Living Vehicle® is proud to offer warranty service virtually everywhere in the United States.



Photo Credit: Apple



Photo Credit: Apple



Photo Credit: Apple





Limited Production

**To Reserve your 2024 now:**

[www.LivingVehicle.com/Contact](http://www.LivingVehicle.com/Contact)

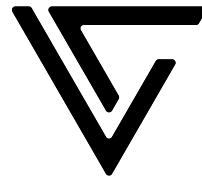

**For inquiries, contact:**

[www.LivingVehicle.com](http://www.LivingVehicle.com)

[hello@LivingVehicle.com](mailto:hello@LivingVehicle.com)

805 . 618 . 2462