

# BAYSIDE

**CHINOOK** *RV*  
The Sports Car of Motorhomes

*The AWD Chinook Bayside combines elegantly-appointed interior design features with state-of-the-art technology – ensuring both high-class function and style. The Bayside fulfills all your dreams to go-anywhere in luxury!*



Learn more  
about our  
luxurious

**AWD**  
**CLASS B**



## BAYSIDE SS

*Powered Front Single Sofa w/ capability to be Full Bed*

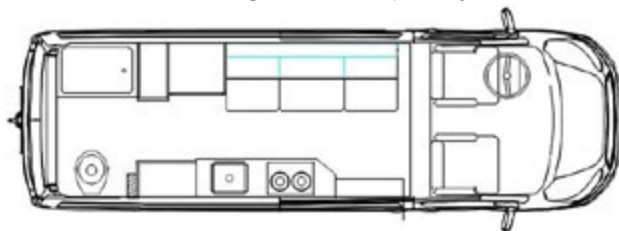

## BAYSIDE TB

*Twin Beds with capability to be one Queen Bed*

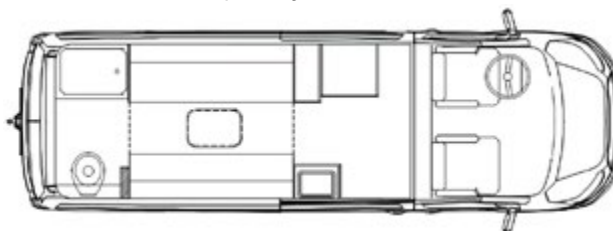

## BAYSIDE RS

*Powered Rear Sofa with capability to be Queen Bed*

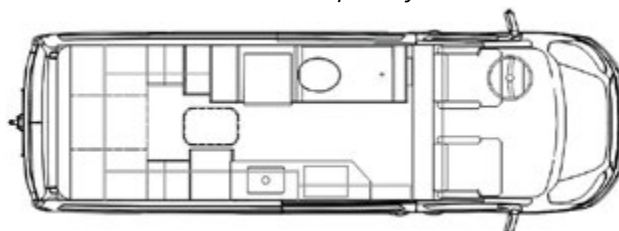

## BAYSIDE RT

*Rear Twin Beds w/ capability to be one Queen Bed*

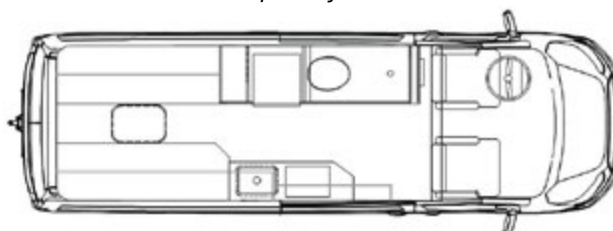

## DIMENSIONS

Exterior Length ..... 21' 11"  
Exterior Body Width ..... 6' 9"  
Exterior Height ..... 10' 2" w/ A/C  
Interior Height ..... 6' 3"

## TANK CAPACITY

	SS & TB	RS & RT
Fuel .....	31 Gallons	31 Gallons
Fresh Water .....	30 Gallons	30 Gallons
Gray Water .....	16 Gallons	16 Gallons (sink) 14 Gallons (shower)
Black Water .....	6 Gallons	6 Gallons

## WEIGHTS

GVWR ..... 11,000 lbs.  
GCWR ..... 13,000 lbs.  
Hitch Rating ..... 5,000 lbs.  
Tongue Weight ..... 500 lbs.  
Average Dry Weight ..... 8,650 lbs.

# BAYSIDE

*Specs are subject to change without notice*

## BAYSIDE 360 STANDARDS

Truma Aventa 13.5 BTU A/C with  
Built-in Dehumidifier

Timberline 1.0 Gas Fired Hydronic Heat &  
On-Demand Hot Water System

Electronic Systems Solution by  
Wellspring Components

Victron 3000-Watt Inverter with Charger &  
Cerbo Touch Screen

300-Watt Solar Panel System with Victron  
Solar Charger

High output 2<sup>nd</sup> alternator with Gen Delete

Expon 360 648 amp/hr. Lithium Battery System  
(7.78KWH)

Thermal Suppression System

Girard 12 ft Awning with Built in Wind Sensor

1 Piece Composite Subfloor

Fully Insulated with Sound Dampening R9 Hushmat

Norcold / Thetford 6.2 cu ft Electric

Double Induction Cooktop (SS, RS, & RT)  
(Single Included with TB)

Convection Microwave

Smart TV

Smart Plug Detachable 30 Amp Power Cord

Solid Surface Countertops & Porcelain Toilet

Premium Soft Touch, Padded Vinyl Finishing

Front & Rear Bug Screens

Two Seatbelts in rear sleeping area

## MOTORHOME WARRANTY

2 Years / 30,000 Miles

## CHASSIS STANDARDS

Ford Transit Van 350HD with AWD, 3.5L  
Eco Boost Twin-Turbo Gas Engine

10 Speed Transmission

Navigation, Apple CarPlay, & Android Auto

360 Degree Back-Up Camera

Safety features including blind spot  
detection, collision warning, lane-keeping  
system & side-wind stabilization

31 Gallon Fuel Tank

Preferred Equipment Package

Upfitter Package

Tow Package

Ford Aluminum Wheels

## OPTIONS

(2) Openable Windows – RS, RT, SS

(1) Openable Window – TB only

Online Package (Starlink Standard System)

Adventure Package (Incl. Roof Rack,  
Side Ladder, Nerf Steps)

Black Out Package (Black Wheels,  
A/T Tires)

Leveling Suspension Kit (2" Aluminum  
Front Lift Spacer)

Altitude Suspension Kit (Fox Rear Shocks,  
2" Front Lift Aluminum Spacer)

Trail Hero Suspension Kit (Lower Control  
Arms, King 2.5 Coil Over Shock Kit &  
King 2.5 Rear Shocks)

Cummins Onan 2.8kw Gas Generator  
(360 Models only)

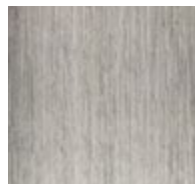

*Soho*

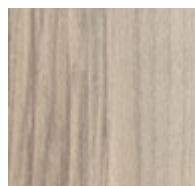

*Walnut Chiffon*



*Nizza*

## INTERIOR COLORS

