

Ahava



297MK

HITCH (LBS.): 2,310 UVW (LBS.): 12,064 CCC (LBS.): 3,746 LENGTH: 34' 5"

EXTERIOR HEIGHT: 13' 1" WIDTH: 102" TANKS (F/G/B): 64 / 88 / 44 AWNING: 10' 9" & 16'



365RL

HITCH (LBS.): 2.315 UVW (LBS.): 12.935 CCC (LBS.): 3.321 LENGTH: 36' 11"

EXTERIOR HEIGHT: 13' 5" WIDTH: 102" TANKS (F/G/B): 64 / 88 / 44 AWNING: 10' 9" & 18'



380FL

HITCH (LBS.): 3,320 UVW (LBS.): 14,760 CCC (LBS.): 4,401 LENGTH: 41' 3"

EXTERIOR HEIGHT: 13' 5" WIDTH: 102" TANKS (F/G/B): 64 / 88 / 88 AWNING: 14' & 16'

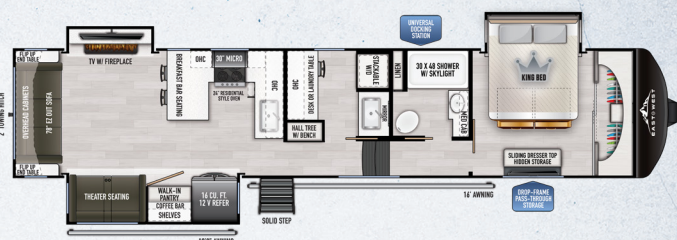

383UR

HITCH (LBS): 2.670 IIVW (LBS): 13.880 CGC (LBS): 2.731 LENGTH: 41' 4"

EXTERIOR HEIGHT: 13' 5" WIDTH: 102" TANKS (F/G/B): 64 / 132 / 44 AWNING: 10' 9" & 16'



385DS

HITCH (LBS.): 2,820 UVW (LBS.): 14,950 CCC (LBS.): 3,811 LENGTH: 43' 9"

EXTERIOR HEIGHT: 13' 5" WIDTH: 102" TANKS (F/G/B): 64 / 132 / 88 AWNING: 10' 9" & 16'

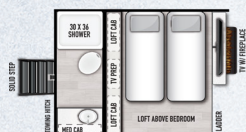

390DS

HITCH (LBS.): 3.115 UVW (LBS.): 15.605 CCC (LBS.): 3.451 LENGTH: 42' 10"

EXTERIOR HEIGHT: 13' 5" WIDTH: 102" TANKS (E/G/B): 64 / 132 / 88 AWNING: 10' 9" & 16'



395FB

HITCH (LBS.): 2,810 UVW (LBS.): 15,735 CCC (LBS.): 3,016 LENGTH: 44' 1"

EXTERIOR HEIGHT: 13' 5" WIDTH: 102" TANKS (F/G/B): 64 / 132 / 88 AWNING: 16' & 18'



TRAVEL TRAILERS



TOY HAULERS



FIFTH WHEELS



MOTORHOMES

EAST TO WEST TAKES PRIDE IN OUR FIVE GUIDING PRINCIPLES AND OUR CORPORATE PHILOSOPHY
which focuses on people working together to create high quality, value-added products that deliver the ultimate RV experience.

Sustainable Manufacturing

An important objective to our strategy and operations is to implement economically sound manufacturing processes to reduce/ recycle waste & conserve energy and natural resources.

Corporate & Social Responsibility

We foster a business environment in which we focus on and practice:

- Ethical Labor Practices
- Teamwork
- Philanthropy
- Volunteering

Culture & Values

We are a forward thinking company committed to fostering a culture of teamwork. By being transparent, we encourage our employees to think outside the box and make a difference!

Quality & Construction

Our team takes pride in each unit we build. Our manufacturing standards and point to point inspections ensure each EAST TO WEST brand is built to the same quality specifications every time.

Our Commitment

We strive to provide the highest quality products at the best possible price to our customers. We invite you to be a part of the EAST TO WEST family and we look forward to exceeding your expectations!

EACH NEW FOREST RIVER PURCHASE PROVIDES:

- ✓ Pre-delivery Inspection.
- ✓ Free Membership to Forest River Owners Group (FROG). Learn more at www.forestriverfrog.com.
- ✓ A Contribution to Care Camps Foundation www.carecamps.org.
- ✓ 1 Year Free Roadside Assistance from Date of Purchase.



LEARN MORE:

Scan this QR code with your mobile device to learn more about Forest River.



A Berkshire Hathaway Company



SPECIFICATION DEFINITIONS:

Scan this barcode using a QR reader on your smartphone to learn RV terminology and more!



YOUR **AHARA** DEALER