



VIPER



## FLOOR PLANS

25V



27V

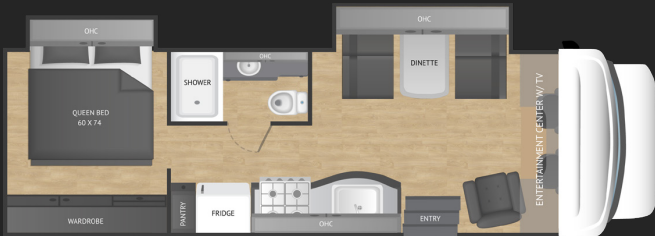

29V



### COMPOSITE SUBSTRATE

Impervious to Water,  
Hypoallergenic



### HSLA STEEL

72% Stronger  
Sidewall/Roof



### FIBERGLASS ROOF

Damage Resistant,  
Walk on Capability



### GALVANIZED BAYS

Crack Resistant in  
Extreme Weather



### RESIDENTIAL HVAC

Serviceable, Mold/  
Mildew Resistant



### HEATED TANKS

Road Protection w/  
Extended Season Capability



# WE BUILD YOUR DREAM!

NEXUSRV.COM

## STANDARD FEATURES

### Exterior

- Seamless Fiberglass Sidewalls
- Azdel Composite Substrate
- Steel Cage Throughout
- Laminated Steel Framed Floor
- Deluxe Heated Remote Mirrors
- Interior Entry Door Handle
- Fiberglass Running Boards
- Seamless Fiberglass Roof
- Side Windows in Bedroom Slide
- Lighted Rubber-lined Trunk Boxes
- Outside Shower
- Ford V8 Gas Engine
- 55 Gallon Fuel Tank
- 7,500 lb. Hitch w/7-Way Plug

### Interior

- Residential Raised Panel Hardwood Cabinetry
- Roller Shades
- Upgraded Flooring
- Laminated Kitchen Countertops
- SS Undermount Bowl in Kitchen
- LED Lighting
- 12V Refrigerator
- LP Gas Tank & Leak Detector
- Carbon Monoxide Detector
- Over-the-Range Microwave
- Stainless 3 Burner Stove Top
- Water Filtration System Throughout
- Enclosed & Forced Heat to Holding Tanks

### Chassis

- Ford V-8 Gas Engine 7.3L
- E450 55 Gallon Fuel Tank (27V, 29V)
- E430 55 Gallon Fuel Tank (25V)
- 7" Touch Screen w/ Phone Mirroring
- Emergency Start Switch
- Cup Holders
- Wheel Inserts & Valve Extenders
- Cross Over Ignition Switch for Batteries
- Soft Touch Driver and Passenger Seats

## Exterior Standard Full Body Paint

### Standard / Decal



### Skirt



### Full Body Paint



## SPECIFICATIONS

### Weights & Measurements

|                       | 25V      | 27V      | 29V      |
|-----------------------|----------|----------|----------|
| Length                | 24'8"    | 28'5"    | 32'2"    |
| Sleeps                | 3-4      | 3-4      | 5-6      |
| Wheelbase             | 158"     | 196"     | 208"     |
| Exterior Height w/ AC | 10'7"    | 10'7"    | 10'7"    |
| Exterior Width        | 8'       | 8'       | 8'       |
| Fresh Water Tank      | 40 GAL   | 40 GAL   | 40 GAL   |
| Grey Tank             | 28 GAL   | 28 GAL   | 28 GAL   |
| Black Tank            | 28 GAL   | 28 GAL   | 28 GAL   |
| LP Gas Tank           | 12.2 GAL | 12.2 GAL | 12.2 GAL |

## INTERIOR PACKAGES



### Slate



CABINETS  
Slate

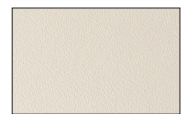

FURNITURE  
Cream



### Adventure

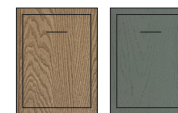

CABINETS  
White Oak, Hunter Green

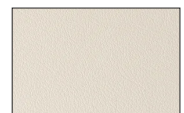

FURNITURE  
Cream



### Coastal



CABINETS  
Driftwood



FURNITURE  
Nordic Blue



### Modern



CABINETS  
White Oak

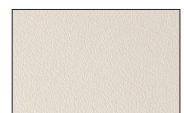

FURNITURE  
Cream



Due to continual research and advances, manufacturer reserves the right to change specifications, design, price and equipment without notice and assumes no responsibility for any errors in the literature. Some items shown are not included as standard or optional equipment.

NEXUS  
RV

NEXUSR.V.COM  
1.855.786.3987

3400 Reedy Dr  
Elkhart, IN 46514

Scan the QR Code  
to Learn More!

VIPER

