

AIRSTREAM

TRAVEL TRAILERS



Adventure, Inspired by Airstream

▼ *Airstream does the slalom course*



INSPIRING ADVENTURE FOR NEARLY 80 YEARS

In 1931 Airstream began with a dream to create lightweight travel trailers that slipped cleanly through the wind. And with it was born another dream, one of new freedoms, new places, new experiences, and new friendships. It was a dream so powerful and so enduring that it did far more than create a new way to travel; it created a new way of life shared by thousands upon thousands of families.

This latest fleet of Airstream Travel Trailers continues the tradition of extraordinary design and hand-crafted quality that has made Airstream world famous. Following our founder Wally Byam's credo, "Let's not make changes, let's make only improvements," this fleet offers the latest technology advancements and conveniences in a way that is distinctly Airstream. With travel trailers perfect for everyone from first-timers to seasoned Airstreamers, you're sure to find one ideal for the adventure that awaits you around the next bend!

Bob Wheeler
President
Airstream, Inc.

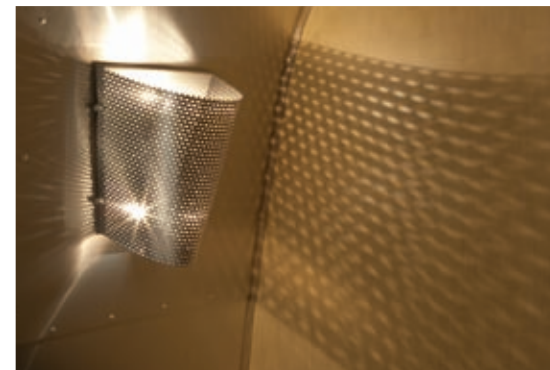
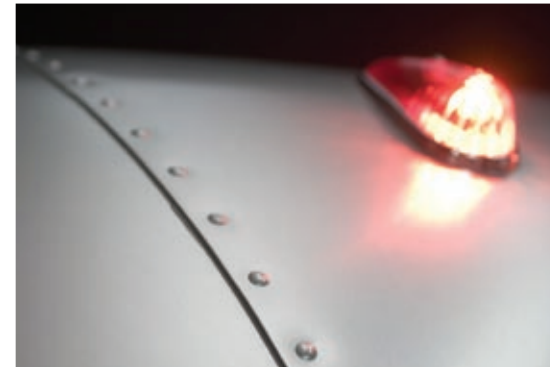



VALUE, STABILITY, DURABILITY...AND BETTER FUEL ECONOMY.
THESE ARE WHAT SET US APART – AND HAVE FOR ALMOST 80 YEARS.

Built by hand by American craftsman, few things in life have proven to be as durable as an Airstream. In fact, nearly 70% of all Airstreams ever built are still in service. This remarkable longevity has resulted in Airstream's equally impressive resale value.

With a fanatical attention to quality and functional design, Airstreams continue to consistently outperform other travel trailers. Designed with exceptional rigidity and a low center of gravity, they offer far better stability and driving safety than their boxy counterparts. Just watch actual test footage on the enclosed DVD where Airstream goes head-to-head through a slalom course and see for yourself.

What's more, the very shape and styling that set Airstream trailers apart also contributes up to a 20% advantage in towing efficiency. This is why the latest renditions of the classic design that moves "like a stream of air" remain so popular today... and ready for your next adventure.



▼ 1936 Airstream Clipper



A TRUE AMERICAN ICON

One look and you know exactly what an Airstream is for. It's meant to be lived in. It's meant to move. It's meant to help people reconnect with their world, without trampling it.

Seven decades after its introduction, art historians and design experts are still extolling the purity and emotional appeal of this "self-contained living accommodation," as Geoff Wardle, chair of the transportation design department at Pasadena's Art Center College of Design, called it. "The Airstream really is a pure object, which is why it has lasted so well," he continued.

"No one has yet to surpass them," said architect Margaret McCurry in *Architectural Digest*.

Perhaps Airstream Chairman Larry Huttle summed it up best when he said "there's a spiritual aspect to owning one. There is a wandering spirit to the people who buy this product. They don't know what's over the next horizon but they want to go see it..."

And that's what adventure – and Airstream – is all about.



AERODYNAMICS



**SUPERIOR CROSSWIND DEFLECTION
AND LOWER CENTER OF GRAVITY
PROMOTE FAR BETTER STABILITY
THAN OTHER TRAVEL TRAILERS.**

**HIGHER
TOWING MPG***

The aerodynamic design of Airstream trailers contributes up to a 20% advantage in towing efficiency over standard travel trailers.



LIGHTWEIGHT. STREAMLINED. FUEL EFFICIENT.

Founder Wally Byam knew that a rounded low-profile shape would make towing easier and more stable. And he knew that aluminum would make his trailers as light as possible. The resulting combination has been a

symbol of adventure, and adventure done right, for almost 80 years.

Today that classic design is more current than ever, requiring less fuel and horsepower on your way to adventure.

*Actual mileage may vary due to load, driving style, driving conditions and tow vehicle.

DURABILITY

SEMI-MONOCOQUE CONSTRUCTION

Inner and outer layers of stretched aluminum skin riveted over extruded aluminum frames provide greater rigidity and durability

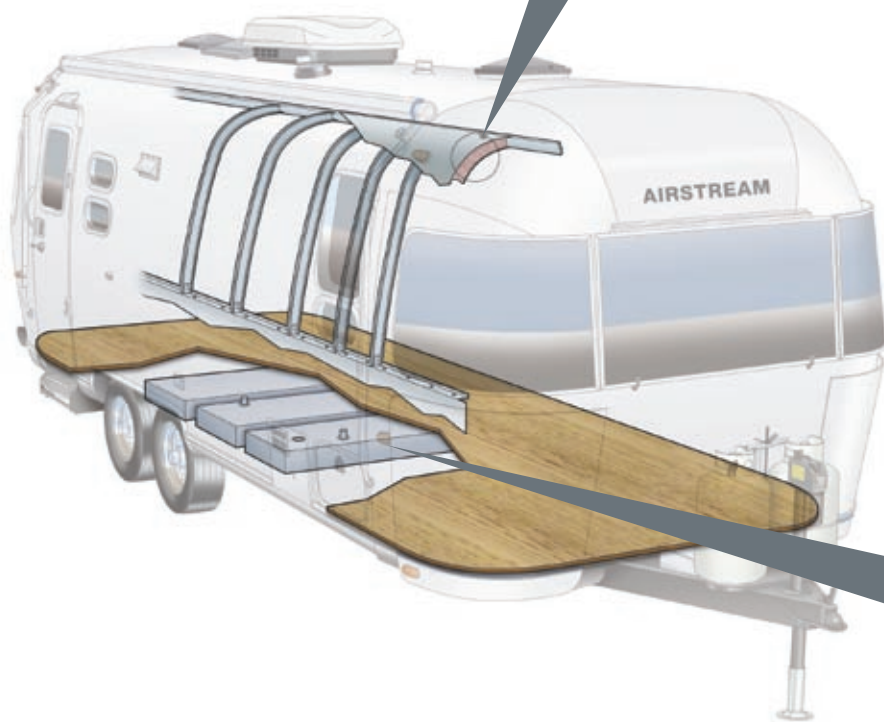

Airstream travel trailers are world-renowned for their superior structural integrity. That's because Airstream employs semi-monocoque construction, consisting of an inner and outer layer of aluminum stretched and riveted to the frame, working as an integral part of the structure. Hand-built with

STABILITY

LOW CENTER OF GRAVITY

Rubber torsion axle and wheels with undermounted holding tanks provide low center of gravity. View the enclosed DVD for a performance demonstration.

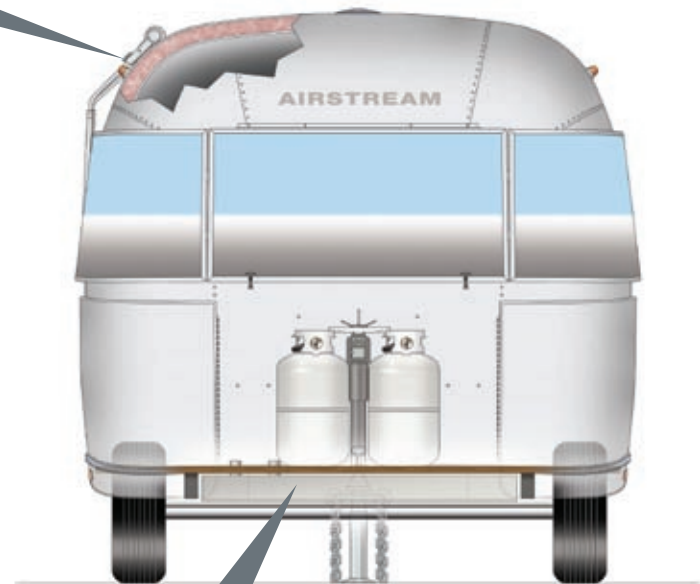

a craftsman's attention to detail, this aluminum skin offers unmatched durability and strength for its weight. Just ask one of the more than 100,000 Airstream owners.



17' SPORT TRAILER



SPORT TRAILERS: 3 FLOORPLANS, 17' AND 22'

Lightweight and nimble, the Airstream Sport line sets a new standard for ease of use – perfect for those who want to just hitch-up and go. Airstream Sport travel trailers are true premium compact trailers that let you live large. Smart floorplans maximize space and minimize waste in two easy-to-handle

lengths. Spacious and airy with its own lights, water, shower and fuel for cooking – plus more creature comforts than some trailers twice their size have – the Airstream Sport offers the best travel trailer investment available.

▼ 17' Sport entryway in Sharks fin interior



▲ 17' Sport front lounge in Sharks fin interior

▲ 17' Sport bathroom sink

When you're towing an Airstream Sport, getting there seems almost effortless. Its ultralight weight allows it to be towed efficiently by most smaller and midsize sport utility vehicles, or even the family car, with outstanding fuel efficiency.

So choose your floorplan, choose the styling, then choose a destination. Whether it's a week of canoeing in Minnesota's Boundary Waters or three nights of music at California's Monterey Jazz Festival, you'll enjoy all the comforts of home no matter how far the road takes you. The Airstream Sport offers nothing less than a personal declaration of independence. So get out there – your adventure awaits!



20' FLYING CLOUD TRAILER



FLYING CLOUD TRAILERS: 11 FLOORPLANS, 19' - 28'

When you're ready to take a break from the great outdoors, the Flying Cloud invites you inside with the flair of modern design. From fabrics to fixtures to cabinetry, the Flying Cloud line reflects your taste in clean, comfortable,

contemporary styling throughout. The rightsized travel trailer for any adventure, the Airstream Flying Cloud travel trailer combines light weight and ruggedness with total practicality. Innovative storage solutions and

▼ 20' Flying Cloud front to back view in Burnt Sienna interior



▲ 20' Flying Cloud galley

▲ 20' Flying Cloud bathroom

multi-function work spaces prevail throughout the living space, like underseat storage or the additional counter space available when the sink cover is in place.

Like all Airstream trailers, every inch of a Flying Cloud has a functional purpose, and not one of those inches was built for planned obsolescence. Count on the Airstream Flying Cloud to last far longer than its boxy competitors, all while enjoying less of an impact at the pump and better stability on the road.

So no matter if you're a first-time Airstreamer or seasoned veteran of the road, the Flying Cloud gets you on your way to your next adventure in contemporary style, luxurious comfort, and long-lasting value.



INTERNATIONAL TRAILERS: 10 FLOORPLANS, 16' – 28'

The Airstream International line redefines upscale and contemporary sleek sophistication. For designer styling as unique as you are, choose from two breathtaking interior decors.

From award winning architect and designer Christopher C. Deam, comes the Signature Series CCD. Inspired by the desire to visually echo the reflective exterior, this design combines a polished aluminum interior with luxurious

Wenge laminate. The effect is to open up the trailer to as much light as possible reflecting off the polished surfaces and creating a high contrast feast for the senses. Intuitive floorplans and spatial design do away with any sense of clutter without sacrificing charm. Modern color options and fabric choices complement the high contrast aluminum and laminate elements, creating a subtle but magical connection between the exterior and interior space.

▼ 25' International FB galley with Signature Series interior



▲ 25' International SS lounge with Ocean Breeze interior

▲ 25' International SS back to front view with Ocean Breeze Interior

For those who crave the oceanside experience, the International is also available in the light and airy Ocean Breeze decor. Offering watery, oceanic colors and a delightfully peaceful aura, you'll swear you can almost hear the sounds of surf every time you step inside.

Both styling packages feature "vista view" and panoramic windows, truly bringing the outside in. At night, strategically-placed recessed halogen lighting sparkles like starlight across the interior aluminum skin. Every color, shape, surface, and texture contribute to an atmosphere of relaxed modernism, with the perfect balance of luxury and streamlined efficiency that give this series its unmatched international flair that follows wherever the road takes you.





L I M I T E D



34' CLASSIC LIMITED TRAILER WITH SLIDE-OUT

CLASSIC LIMITED TRAILERS: 17 FLOORPLANS, 25' – 34'

Forget what you thought or imagined luxury, comfort and practicality could be in a travel trailer. Designed for long-term or full-time use, the Airstream Classic Limited takes it a step farther with traditional styling that never forces you to compromise. The flagship of the travel trailer fleet, the Classic Limited

line offers elegant floorplans with outstanding storage capacity, residential-style galleys, spacious living areas, private sleeping quarters and ingenious slide-out options. Inside you'll find generously appointed interiors with real hickory hardwood cabinetry, Corian® countertops, Moen®

▼ Front to back view of spacious slide-out dining area in Jade interior



▲ Bed of 34' Classic Limited slide-out with hickory cabinets and Jade interior

▲ 34' Classic Limited slide-out with UltraLeather option

fixtures, plush furnishings, cable and/or satellite TV and so much more. The Airstream Classic Limited is classic Airstream – the perfect expression of our commitment to design, innovation and quality. So go ahead and leave home without leaving behind the comforts of home. No corners have been cut and nothing spared in creating a living space that lets you entertain in style, dine in comfort and relax in peace. No other travel trailer comes close to creating this luxurious residential environment. To that we added exterior storage, smartly placed hookups and easy-out awnings that expand living area even further to the great outdoors. So no matter where you pursue your next adventure, Airstream Classic Limited trailers make you feel right at home – which, of course, you are.



TIRED OF COMPANIES TRUMPETING THEIR NEW-FOUND GREEN-NESS? US TOO.

So we're happy to note that we're still taking the same environmentally friendly approach that has sustained us, and our planet, for nearly 80 years. Simply put, Airstream has been green as long as it has been silver.

Airstreams are designed to spend time on the road, not in the landfills. As such, nearly 70% of all Airstream trailers ever produced are still on the road! While other products are designed to wear out, Airstreams are designed to be handed down through the generations.

We also work with nature, not against it. Airstream's founder, Wally Byam, knew that a low profile and a rounded, slippery shape would make for better towing in every respect. As a result, Airstreams enjoy a 20% advantage in

towing efficiency over standard "white box" trailers. And over the life of your Airstream, that's a lot of fuel saved.

And should your Airstream come to the end of its life after many decades of service, its primary components (aluminum, steel, and wood) are easily recycled.

So go ahead and enjoy your Airstream with a sense of global responsibility, and comfort in the fact that you are adventuring in one of the most environmentally friendly travel trailers in the world. And always remember that Airstreamers leave a place better than they found it. *Silver is indeed Green.*

SPORT TECHNICAL SPECIFICATIONS

	17	22	22FB
Exterior Length	16'8"	21'8"	21'8"
Width Exterior	7'3.25"	7'3.25"	7'3.25"
Width Interior	6'11.75"	6'11.75"	6'11.75"
Height Exterior w/A/C	8'11"	8'11"	8'11"
Height Interior w/A/C	75"	75"	75"
Hitch Ball Height	16.50"	17.25"	17.25"
Hitch Weight w/o Options or Variable Weight	300	370	TBD
UBW (Unit Base Weight)	2,800	3,345	TBD
NCC (Net Carrying Capacity) w/o Options Fluids or Cargo	700	1,155	TBD
GVWR (Gross Vehicle Weight Rating) (U.S.)	3,500	4,500	TBD
Water Tank w/Drain Valve	20	20	20
Blackwater Tank (gal)	18	18	18
Graywater Tank (gal)	24	24	24
Water Heater (gal) w/Electronic Ignition	6	6	6
13,500 BTU A/C w/Heat Pump	OPT	OPT	OPT
Furnace w/Electric Ignition (BTU)	12,000	12,000	12,000
LPG (lbs) (2-20# Steel Tanks)	40	40	40
Deep Cycle Group	1	1	1
Sleeping Capacity	2	4	4

DECORS

CINNABAR
MOCHABLUE
OATMEAL

SPORT FLOORPLANS

17' SPORT TRAILER

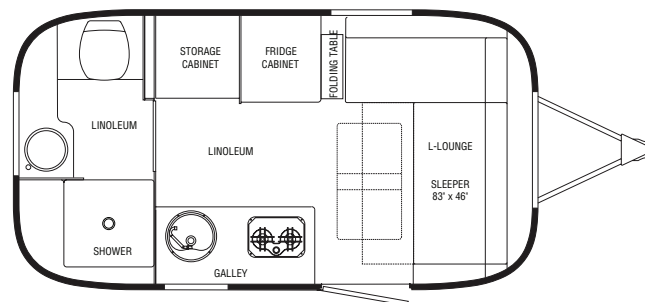

22' SPORT TRAILER

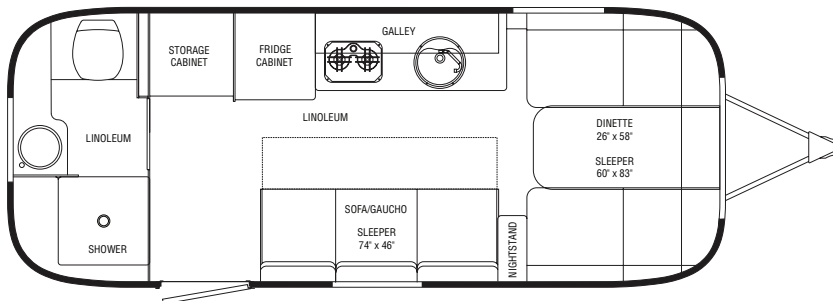

22' FB SPORT TRAILER

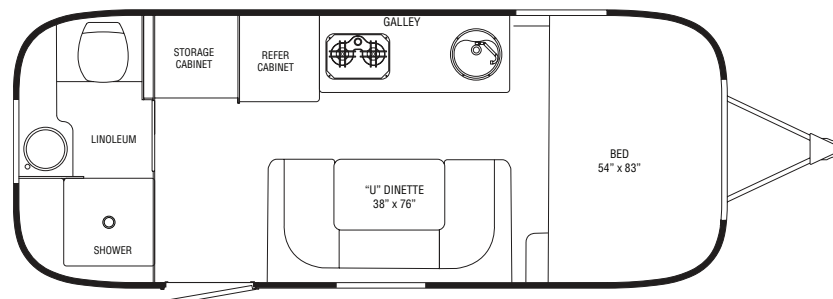

Please visit
www.airstream.com
to see a full set of
model specifications,
floorplans, features
and options, and to
find your nearest
Airstream dealer.

FLYING CLOUD TECHNICAL SPECIFICATIONS

	19	20	23	23FB	25FB	27FB	28
Exterior Length	19'2"	20'10"	23'	23'9"	25'11"	28'	27'11"
Width Exterior	8'	8'	8'	8'	8'-5.5"	8'5.5"	8'5.5"
Width Interior	7'7"	7'7"	7'7"	7'7"	8'1"	8'1"	8'1"
Height Exterior w/A/C	9'5"	9'5"	9'5"	9'5"	9'7"	9'7"	9'7"
Height Interior w/A/C	6'4.5"	6'4.5"	6'5"	6'5"	6'5"	6'5"	6'5"
Hitch Ball Height	17.75"	17.75"	17.75"	17.75"	17.75"	17.75"	17.75"
Hitch Weight w/o Options or Variable Weight	570	640	730	500	760	775	950
UBW (Unit Base Weight)	3,725	4,197	4,707	4,757	5,477	5,600	5,700
NCC (Net Carrying Capacity) w/o Options Fluids or Cargo	775	803	1,293	1,243	1,823	2,000	1,600
GVWR (Gross Vehicle Weight Rating)	4,500	5,000	6,000	6,000	7,300	7,600	7,300
Water Tank w/Drain Valve	23	23	30	39	39	39	39
Blackwater Tank (gal)	18	18	18	18	39	39	35
Graywater Tank (gal)	21	21	21	30	37	37	37
Water Heater (gal) w/Electronic Ignition	6	6	6	6	6	6	6
A/C w/Heat Pump & Electronic Controls	13,500	13,500	13,500	13,500	13,500	13,500	13,500
Furnace w/Electric Ignition (BTU)	16,000	18,000	18,000	18,000	25,000	25,000	30,000
LPG (lbs) (2-30# Steel Tanks)	60	60	60	60	60	60	60
Deep Cycle Group	2	2	2	2	2	2	2
Sleeping Capacity	4	4	5	4	4	4	5

DECORS

STRATUS
MIDNIGHT SUN
BURNT SIENNA
SEA GREEN

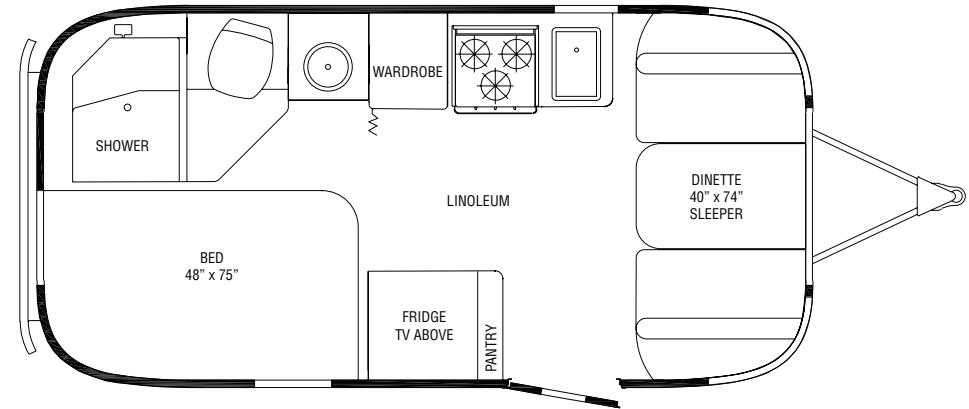
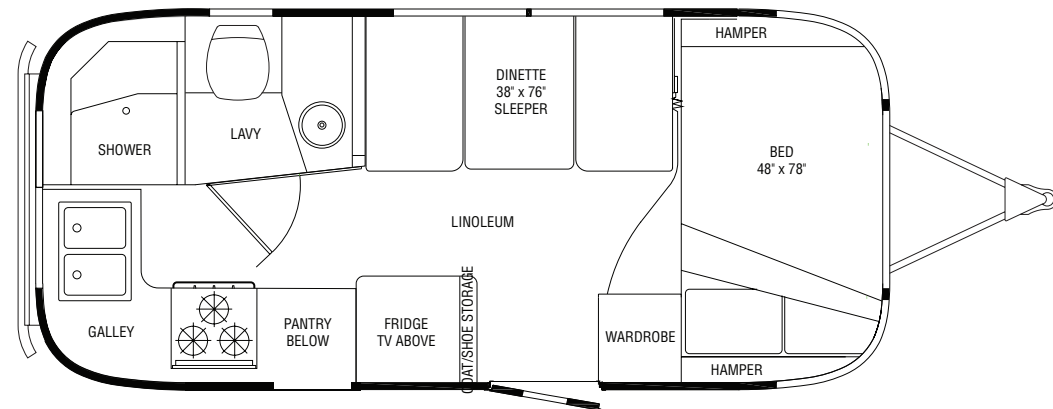
FLYING CLOUD FLOORPLANS
19' FLYING CLOUD BAMBI TRAILER

20' FLYING CLOUD TRAILER

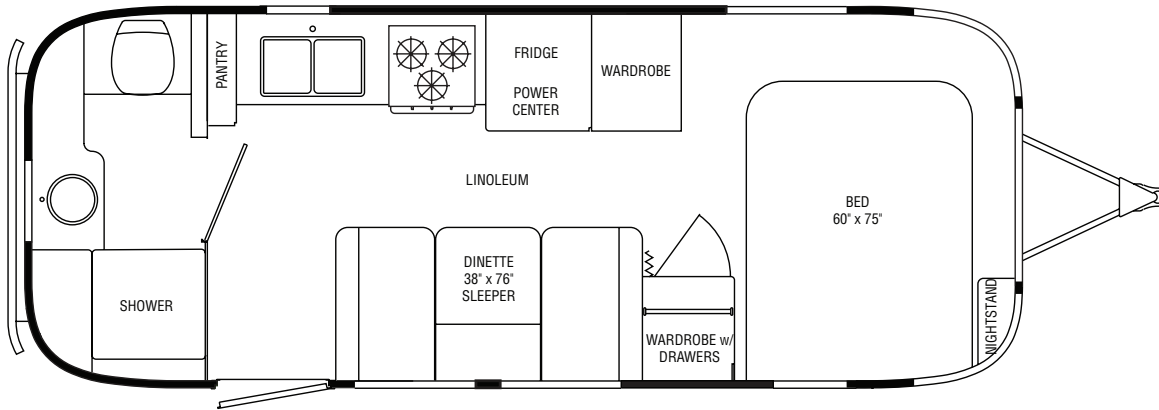
23' FB FLYING CLOUD TRAILER

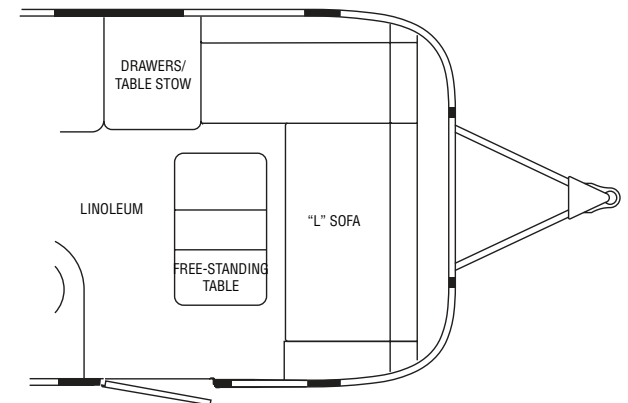
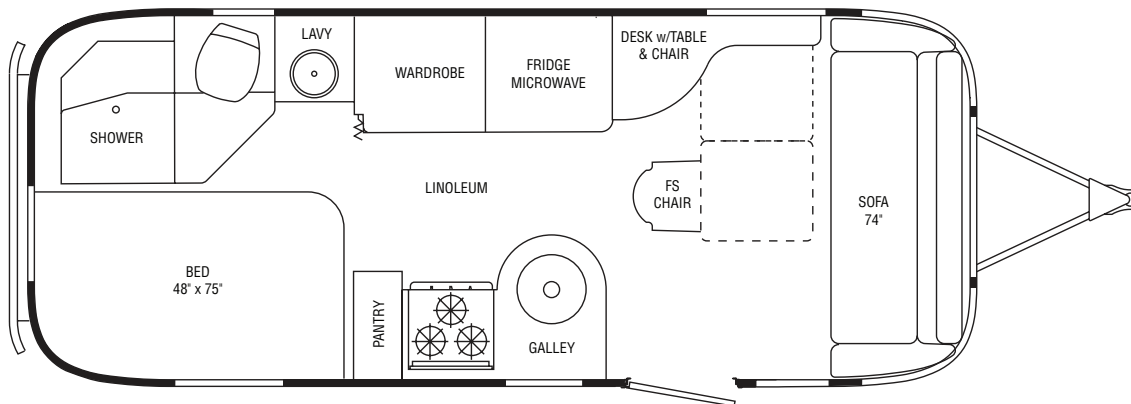

Please visit www.airstream.com to see a full set of model specifications, floorplans, features and options, and to find your nearest Airstream dealer.

23' FLYING CLOUD TRAILER



FLYING CLOUD FLOORPLANS (CONTINUED)

25' FB FLYING CLOUD TRAILER

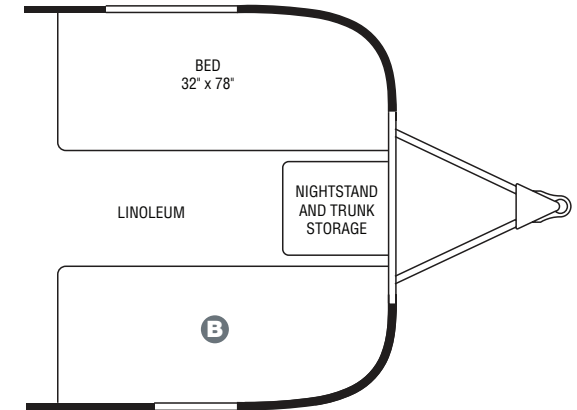
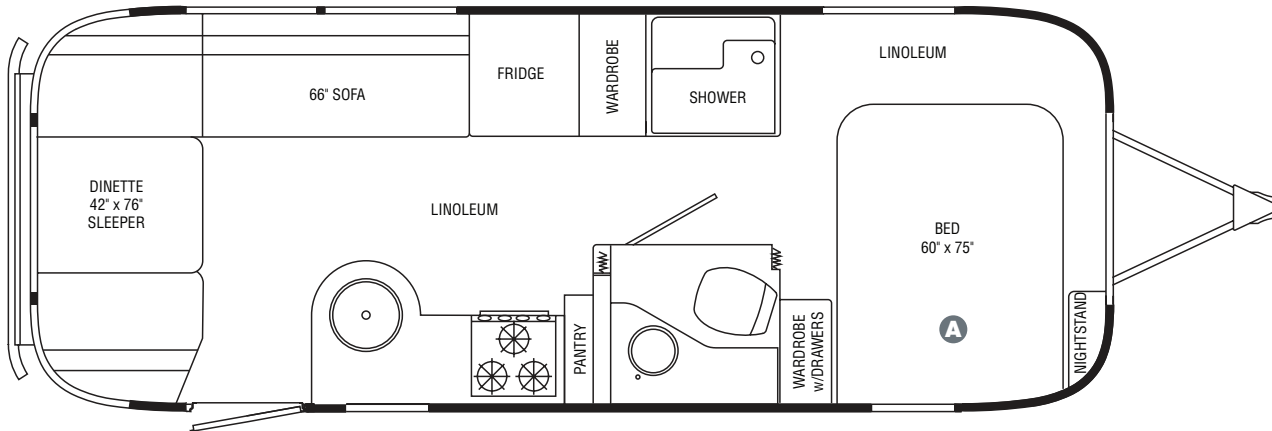

28' FLYING CLOUD TRAILER

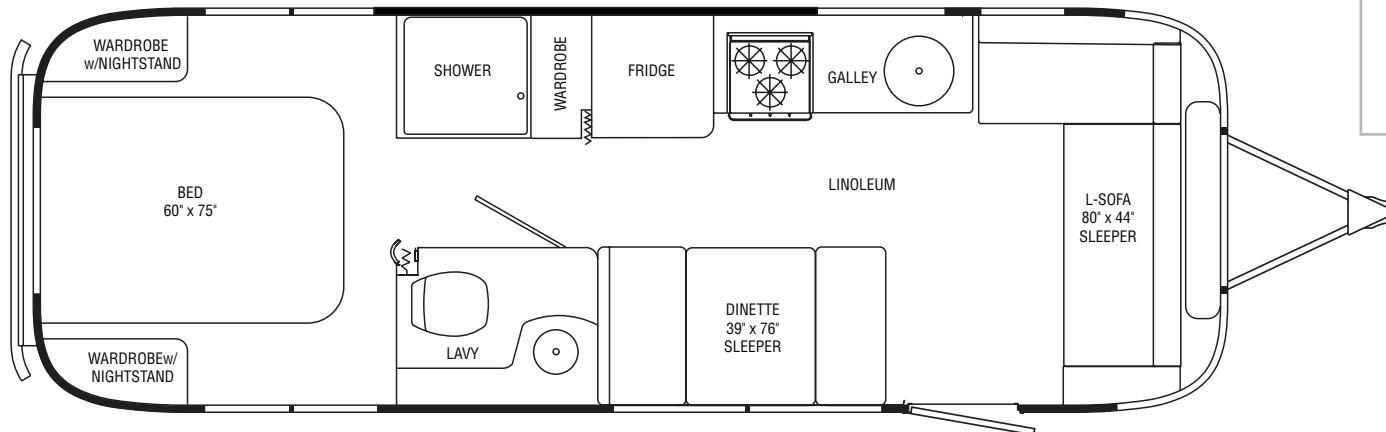

The 25' FB Flying Cloud offers two bedroom floorplan options:

- A** A queen size bed with wardrobe and nightstand
- B** Or two twin size beds with nightstand and trunk storage

27' FB FLYING CLOUD TRAILER

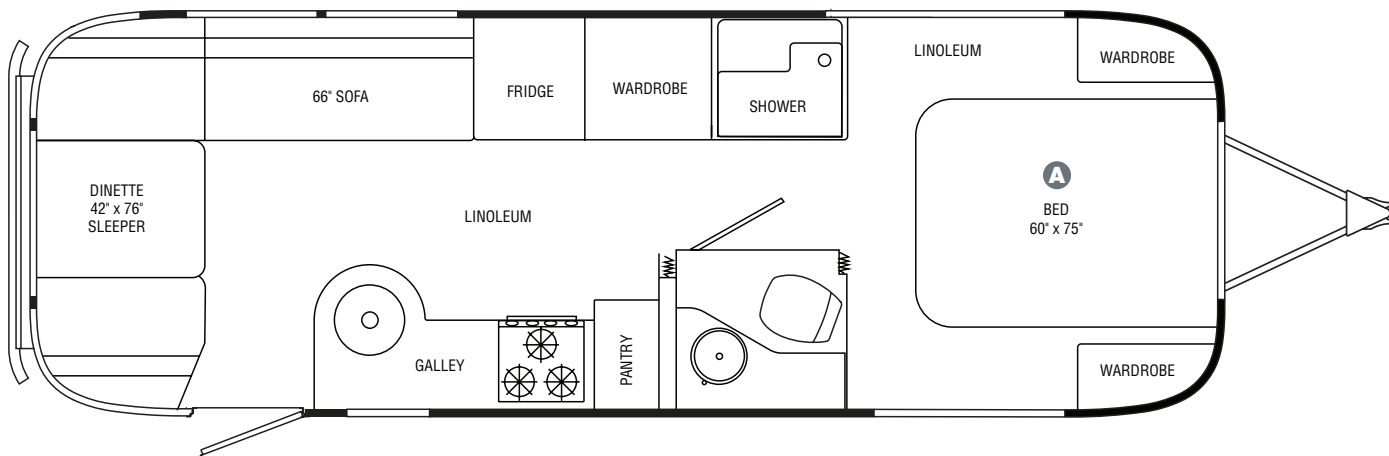

Please visit www.airstream.com to see a full set of model specifications, floorplans, features and options, and to find your nearest Airstream dealer.

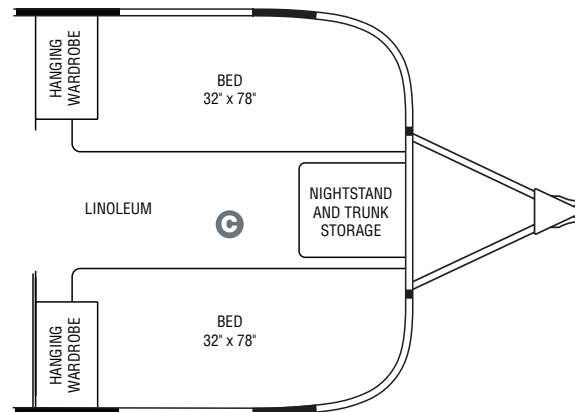
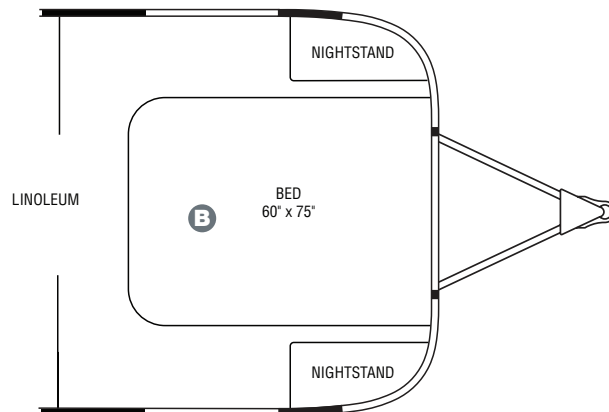

The 27' FB Flying Cloud offers three bedroom floorplan options:

- A** A queen size bed with two wardrobes
- B** A queen size bed with two nightstands, shown with optional panoramic windows
- C** Or two twin size beds with nightstand and trunk storage, shown with optional panoramic windows

INTERNATIONAL TECHNICAL SPECIFICATIONS

	16	19	23	25SS	25FB	27FB	28
Exterior Length	16'7"	19'2"	23'	25'11"	25'11"	28'	27'11"
Width Exterior	8'	8'	8'	8'5.5"	8'5.5"	8'5.5"	8'5.5"
Width Interior	7'7"	7'7"	7'7"	8'1"	8'1"	8'1"	8'1"
Height Exterior w/A/C	8'8"	8'9"	8'9"	8'11"	8'11"	8'11"	8'11"
Height Interior w/A/C	9'4"	9'5"	9'5"	9'7"	9'7"	9'7"	9'7"
Hitch Ball Height	18"	17.25"	17.75"	17.75"	17.75"	17.75"	17.75"
Hitch Weight w/o Options or Variable Weight	430	510	700	740	820	790	880
UBW (Unit Base Weight)	2,825	3,575	4,695	5,145	5,410	5,813	5,440
NCC (Net Carrying Capacity) w/o Options Fluids or Cargo	1,475	925	1,305	1,855	1,890	1,787	1,860
GVWR (Gross Vehicle Weight Rating)	4,300	4,500	6,000	7,000	7,300	7,600	7,300
Water Tank w/Drain Valve	23	23	30	39	39	39	39
Blackwater Tank (gal)	N/A	18	18	18	39	39	35
Graywater Tank (gal)	N/A	21	21	39	37	37	37
Combination Black & Gray Tank	21	N/A	N/A	N/A	N/A	N/A	N/A
Water Heater (gal) w/Electronic Ignition	6	6	6	6	6	6	6
A/C w/Heat	OPT 11,000	13,500	13,500	13,500	13,500	13,500	13,500
Furnace w/Electric Ignition (BTU)	12,000	16,000	25,000	25,000	25,000	25,000	30,000
LPG (lbs) (2 Steel Tanks)	40	60	60	60	60	60	60
Deep Cycle Group	1	2	2	2	2	2	2
Sleeping Capacity	3-4	3-4	4-5	5-6	4	4	5

DECORS

OCEAN BREEZE
CILANTRO
PAPRIKA

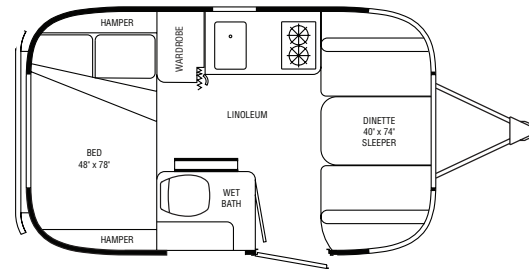
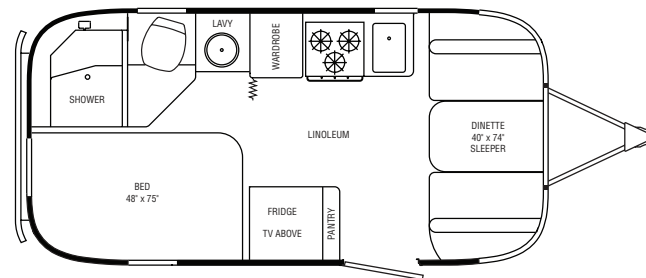
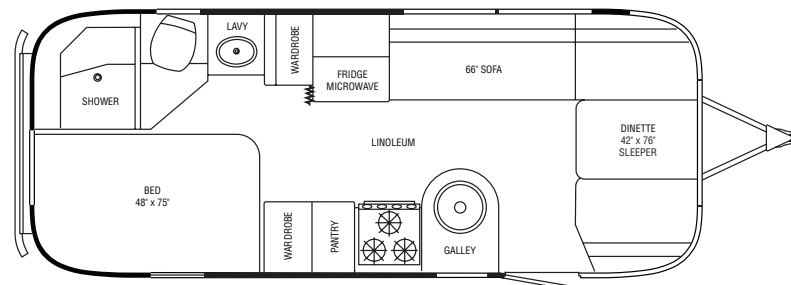
INTERNATIONAL FLOORPLANS
16' INTERNATIONAL TRAILER

19' INTERNATIONAL BAMBI TRAILER

23' INTERNATIONAL TRAILER

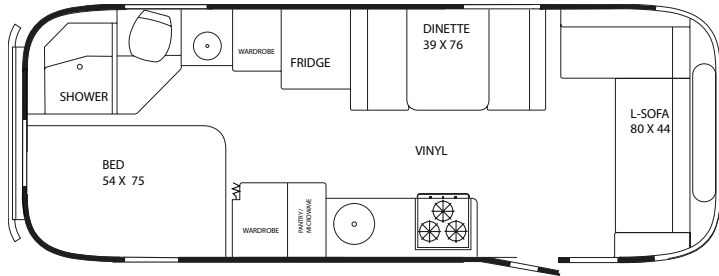
Please visit
www.airstream.com
to see a full set of
model specifications,
floorplans, features
and options, and
to find your nearest
Airstream dealer.

25' SS INTERNATIONAL TRAILER

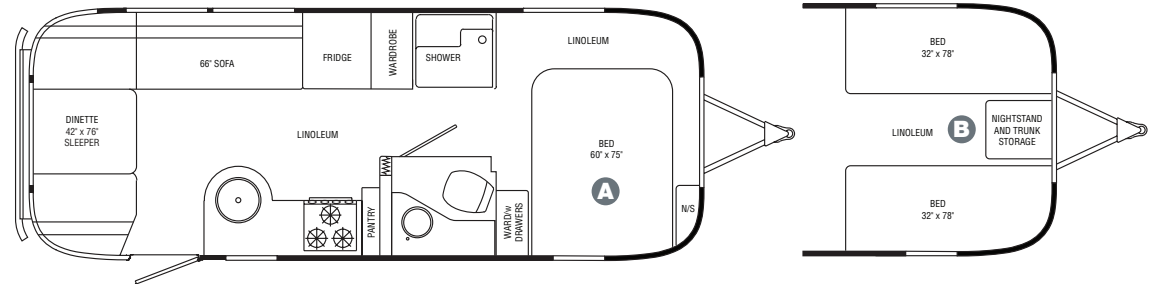

25' FB INTERNATIONAL TRAILER



27' FB INTERNATIONAL TRAILER

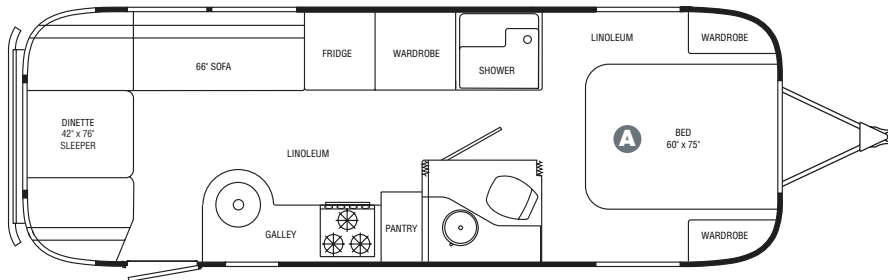

The 27' FB International offers three bedroom floorplan options:

- A** A queen size bed with two wardrobes
- B** A queen size bed with two nightstands, shown with optional panoramic windows
- C** Or two twin size beds with nightstand and trunk storage, shown with optional panoramic windows

The 25' FB International offers two bedroom floorplan options:

- A** A queen size bed with night stand and wardrobe with drawers
- B** Or two twin size beds with nightstand and trunk storage

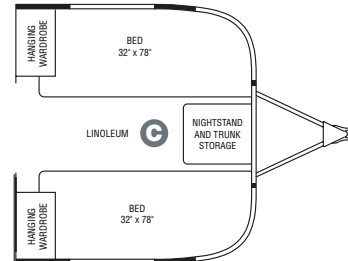
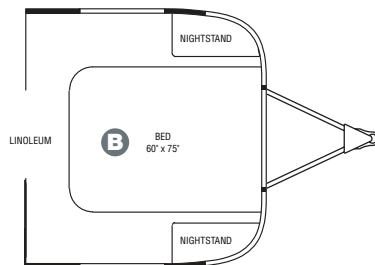

28' INTERNATIONAL TRAILER

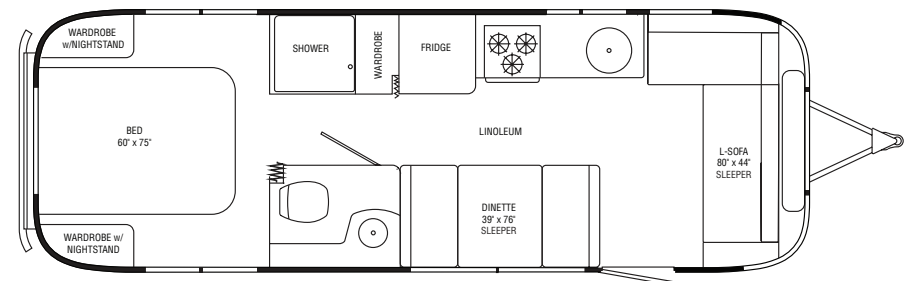

CLASSIC LIMITED TECHNICAL SPECIFICATIONS

	25FB	27FB	30	30 SO	30FB K	31 DIN	34	34 SO
Exterior Length	25'9"	27'9.5"	31'	31'	30'	31'	34'10"	34'10"
Width Exterior	8'5.5"	8'5.5"	8'5.5"	8'5.5"	8'5.5"	8'5.5"	8'5.5"	8'5.5"
Width Interior	8'1"	8'1"	8'1"	8'1"	8'1"	8'1"	8'1"	8'1"
Height Exterior w/A/C	9'7.5"	9'7.5"	9'7.5"	9'7.5"	9'7.5"	9'7.5"	9'7.5"	9'7.5"
Height Interior w/A/C	6'5"	6'5"	6'5"	6'5"	6'5"	6'5"	6'5"	6'5"
Hitch Ball Height	18.75"	18.75"	18.75"	19.75"	18.75"	18.75"	18.75"	19.75"
Hitch Weight w/o Options or Variable Weight	780	790	670	1,050	860	760	770	1,150
UBW (Unit Base Weight)	5,900	6,525	7,095	7,940	6,883	7,050	7,858	8,247
NCC (Net Carrying Capacity) w/o Options Fluids or Cargo	2,100	2,475	2,905	2,360	3,117	2,950	3,642	3,253
GVWR (Gross Vehicle Weight Rating)	8,000	9,000	10,000	10,300	10,000	10,000	11,500	11,500
Water Tank w/Drain Valve	54	54	54	54	54	54	54	54
Blackwater Tank (gal)	39	39	39	39	37	39	39	39
Graywater Tank (gal)	37	37	37	37	39	37	37	37
Water Heater (gal) w/Electronic Ignition	6	6	6	6	6	6	6	6
A/C w/Heat Pump & Electronic Controls	13,500	13,500	13,500	13,500	13,500	13,500	13,500	13,500
Furnace w/Electric Ignition (BTU)	25,000	30,000	34,000	34,000	30,000	34,000	34,000	34,000
LPG (lbs) (2 Aluminum Tanks)	60	60	60	60	60	60	60	60
Deep Cycle Group	2	2	2	2	2	2	2	2
Sleeping Capacity	4-6	4-6	4-6	4-6	4-6	4-6	4-6	4-6

DECORS

COCOA
JADE
PRALINE

CLASSIC LIMITED FLOORPLANS

Please visit www.airstream.com to see a full set of model specifications, floorplans, features and options, and to find your nearest Airstream dealer.

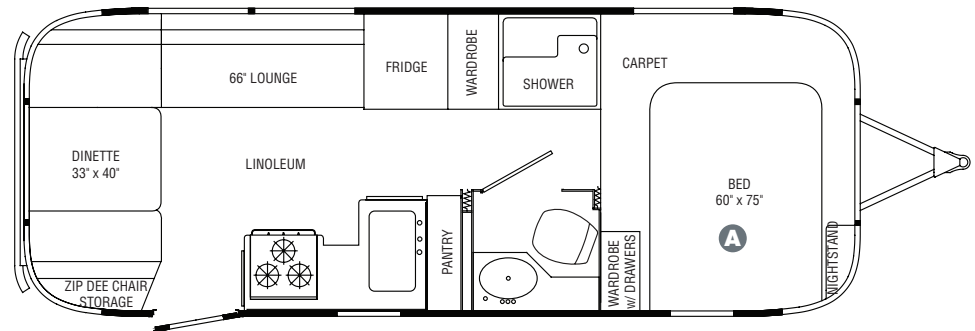
25' FB CLASSIC LIMITED TRAILER

The 25' FB Classic Limited offers two bedroom floorplan options:

- A** A queen size bed with wardrobe and nightstand, shown with optional panoramic windows
- B** Or two twin size beds with nightstand and trunk storage, shown with optional panoramic windows

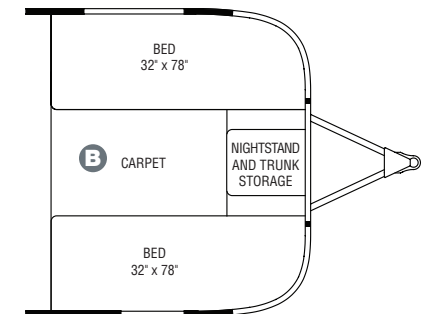

27' FB CLASSIC LIMITED TRAILER

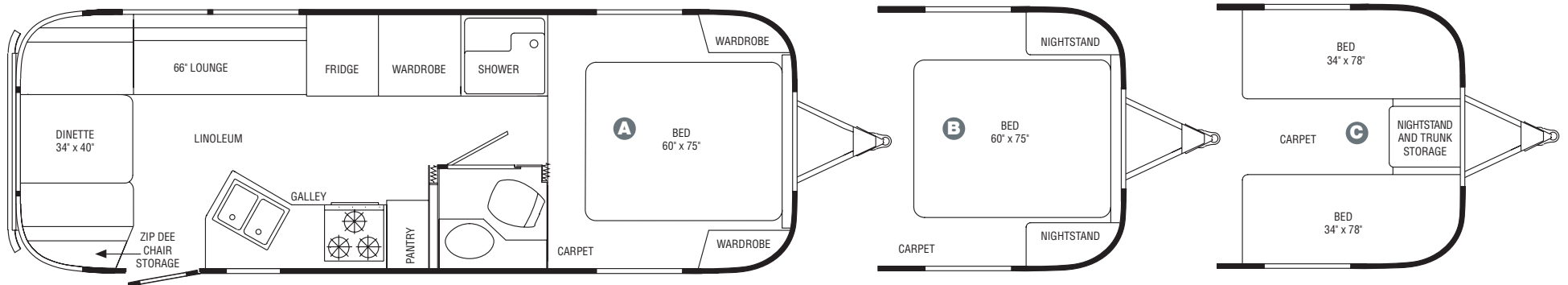

The 27' FB Classic Limited offers three floorplan options:

A A queen size bed with two wardrobes

B A queen size bed with two nightstands

C Or two twin size beds with nightstand and trunk storage

30' CLASSIC LIMITED TRAILER

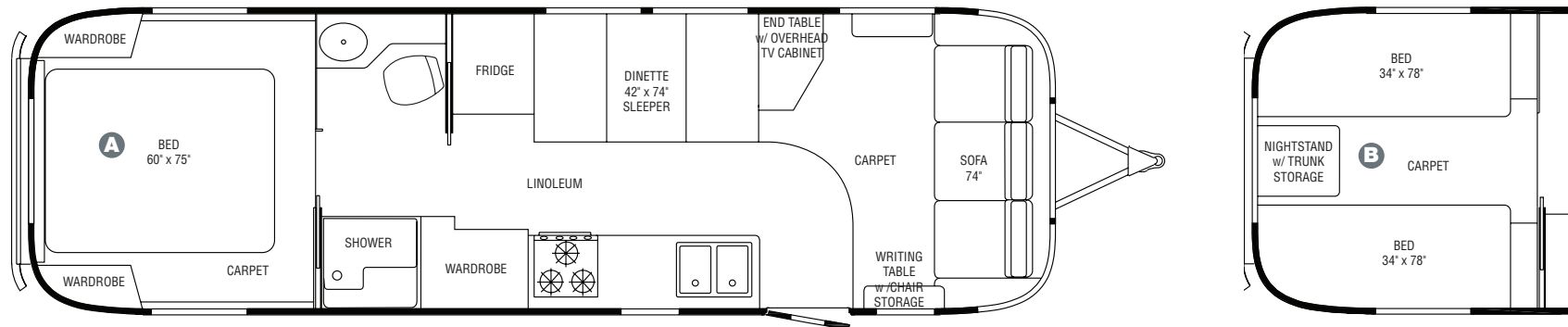

The 30' Classic Limited offers two bedroom floorplan options: **A** A queen size bed with two wardrobes **B** Or two twin size beds with nightstand and trunk storage

CLASSIC LIMITED FLOORPLANS (CONTINUED)

30' SO CLASSIC LIMITED TRAILER

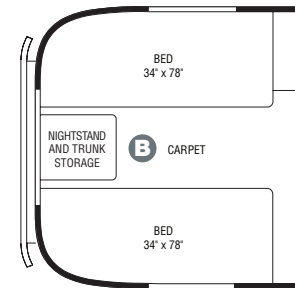
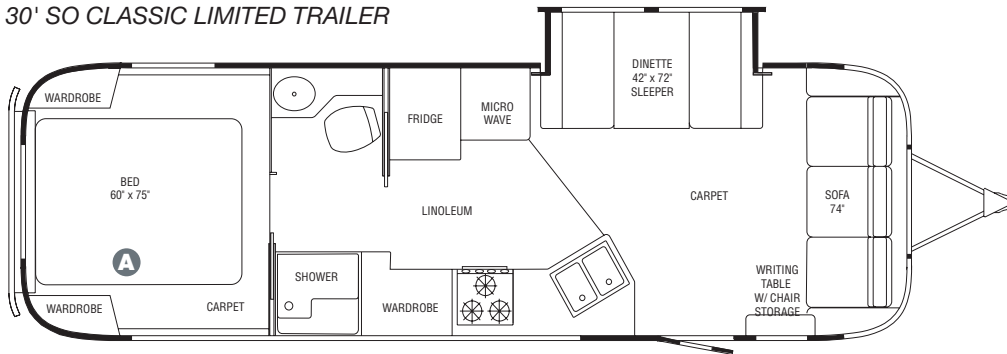

The 30' SO Classic Limited offers two bedroom floorplan options:

- A** A queen size bed with two wardrobes
- B** Or two twin size beds with nightstand and trunk storage

30' FB K CLASSIC LIMITED TRAILER

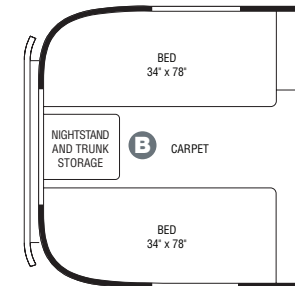
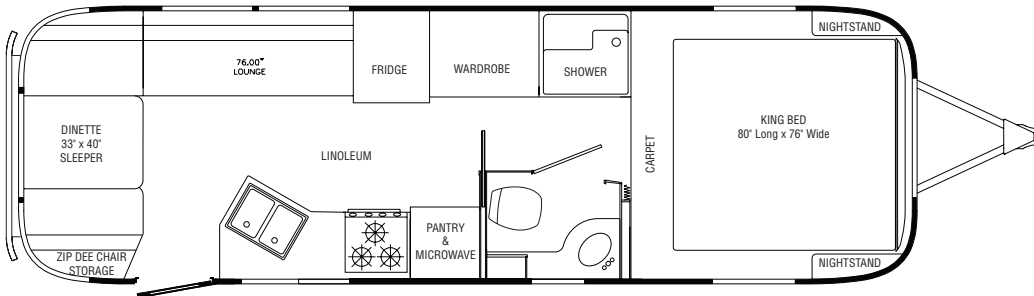

The 31' Dinette Classic Limited offers three bedroom floorplan options:

- A** A queen size bed with two wardrobes
- B** Or two twin size beds with nightstand and trunk storage
- C** Free standing dinette

31' DINETTE CLASSIC LIMITED TRAILER

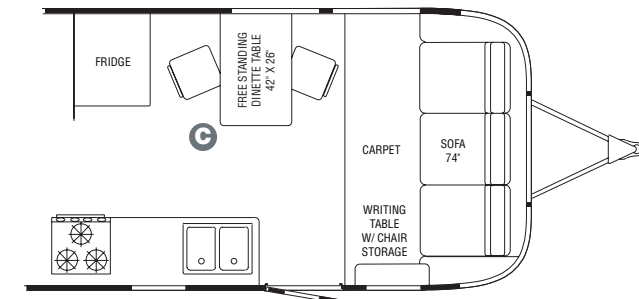
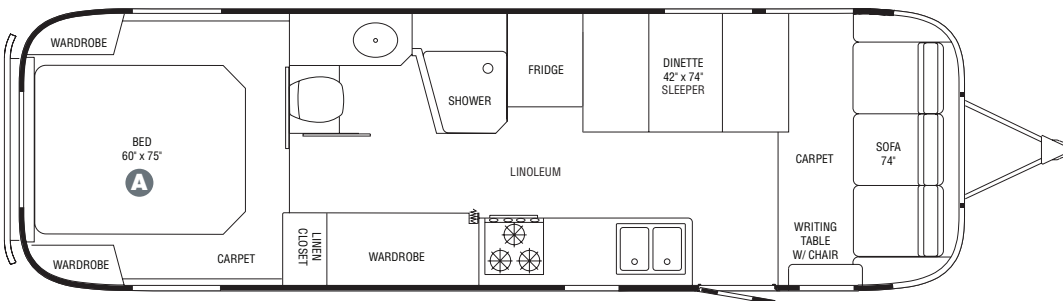

34' CLASSIC LIMITED TRAILER

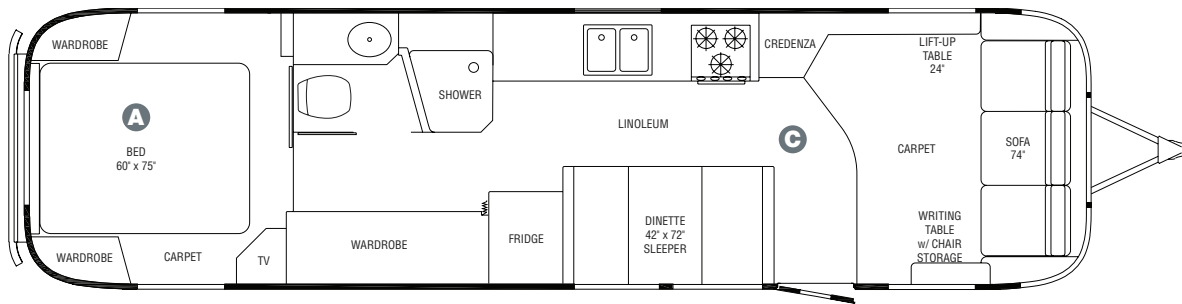

The 34' Classic Limited offers two bedroom and two lounge floorplans:

- A** A queen size bed with two wardrobes
- B** Two twin size beds with nightstand and trunk storage
- C** Sofa with lift-up table and credenza
- D** "L" lounge

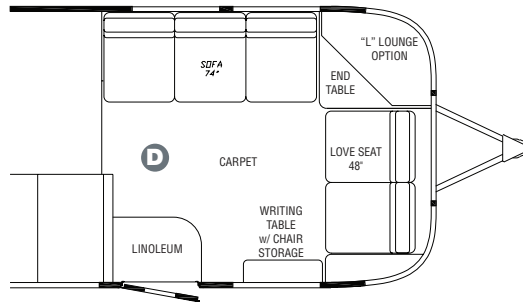
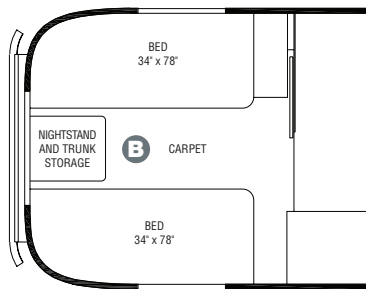

The 34' SO Classic Limited offers two bedroom floorplans:

- A** A queen size bed with two wardrobes
- B** Two twin size beds with nightstand and trunk storage

34' SO CLASSIC LIMITED TRAILER

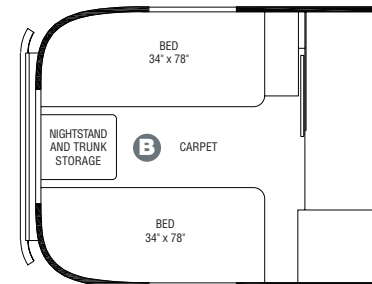
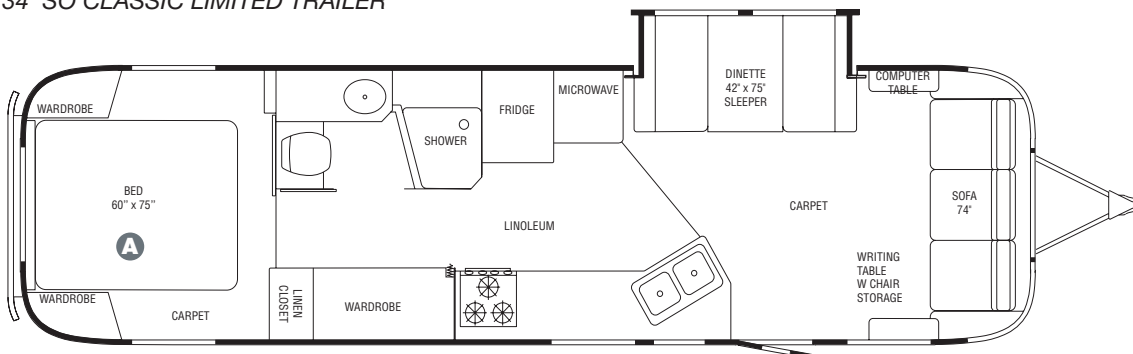

AIRSTREAM

TRAVEL TRAILERS

TO THE RESTLESS SPIRIT

The Airstream Travel Trailer beckons to those driven by an insatiable desire to see more, to do more, to learn more. It calls to those who understand the allure of the open road, and the discovery of what lies beyond the next bend. And it appeals to those who value independence and inspired design, and to those who recognize the quality and craftsmanship that have allowed one brand to stand the toughest test of all – time.

Adventure, Inspired by Airstream

Airstream, Inc.
419 West Pike Street
P.O. Box 629
Jackson Center, OH
45334 USA
937-596-6111
www.airstream.com

THOR
INDUSTRIES, INC.

All content and images © Airstream 2008

Travel Trailers 20k 08/08



Product information, specifications, and photography in this brochure were as accurate as possible at time of printing. Photographs may contain some features that are optional on your vehicle. Since we continually strive to improve our products, actual products may differ. Prices and specifications are subject to change without notice. All capacities are approximate and dimensions are nominal. Some features or options may be different or unavailable in Canada.

Vehicle Loading – Every effort has been made to provide the greatest number of options for the recreation vehicle owner. Along with these choices comes the responsibility to manage the loads that are imposed by the choices so that they remain within the manufacturer's specified chassis weight limits. Do not overload the recreation vehicle.

Dry Weights – Based on standard features; optional equipment not included. Net carrying capacity (NCC) determined by subtracting unloaded vehicle weight (UVW) from gross vehicle weight (GVWR) and includes fluids, options, and cargo. Liquid capacities and weights are approximations only.

Warning – This information is intended as a guide only. Weights of individual vehicles may vary. Consult your owner's manual for complete loading, weighing, and towing instructions.