

Passport

ULTRA LITE
by Keystone



ULTRA LITE



EXPRESS SL



GRAND TOURING



WWW.KEYSTONE-PASSPORT.COM

Passport

ULTRA LITE
by Keystone



MORE CAMPING FOR LESS

Welcome to Passport Ultra Lite by Keystone. Developed by the industry leader in travel trailers and fifth wheels, Keystone set out to develop a true, full line, ultra lite product that brings best in class features and value to the market. Once again, Keystone delivers with the Passport Ultra Lite!

With customer demand for lightweight fuel efficient travel trailers at an all time high, the Passport from Keystone is sure to be the pick of families who want to maximize fuel efficiency, but still maintain all the conveniences of a well appointed, feature packed RV. Passport identified the four most important priorities for our customers: floor plan, weight, eye appeal, and price; then designed the Passport to be the perfect combination of all four. Creative engineering has enabled Passport to include high-end amenities without adding pointless weight. Its sleek aerodynamic front-end design and enclosed underbelly reduce wind resistance and increase fuel efficiency. In addition, the "Load Equalization", spread-axle system assists in lowering hitch weight and makes towing easier. The Passport family can be easily towed with a half-ton pickup or SUV and the Passport Express can be towed by some smaller SUVs or crossovers.

Sure, towability led you to the Passport, but when you need a travel trailer for those fun weekends or the extended cross country excursion you realize Passport has a full array of features and conveniences built into every model! You know you have arrived at the pinnacle of lite weights when you roll in with a Passport.

GO ANYWHERE.



0716001454
Ultra Lite

The classic that started it all, the Passport Ultra Lite. When you need a Travel Trailer that has everything (except the weight), the Passport Ultra Lite is your blue ribbon winner. From the ground up the Passport Ultra Lite is the lite weight and easy to tow travel trailer that makes camping fun.



0716001454
Express Super Lite

What looks small but packs a big punch when it comes to living space? The Passport Express Super Lite! Whether it's the feel of sleeping in the open air with our expandable models or the need for a trailer that can be towed by most small SUV's, the Passport Express Super Lite is the Passport way of making camping easy.



0716001454
Grand Touring

One word describes the Passport Grand Touring. Amazing! The Passport Grand Touring didn't get the memo it was supposed to act like the other lite weights. With size and features of a full size camper, this Passport is still made for today's SUV's and half ton vehicles. So go ahead live large and go lite, and get more with a Passport Grand Touring.



PAGE 4



PAGE 5



PAGE 6



Double Door Fridge
and Pantry



Pantry Can Also Be
Used As Wardrobe



Charging Station



Control Panel

PASSPORT ULTRA LITE

No other ultra lite travel trailer gives you the features, space, storage and amenities as the Passport Ultra Lite. Take the Passport 195RB that has a full walk around bed, neo angle glass shower, and still plenty of storage for the long haul. Or even the 290BH that gives you the added countertop space, unique shoe storage, and more overhead cabinets than you will know what to do with. The Passport Ultra Lite is your trailer that makes towing and camping easy. From top to bottom the Passport Ultra Lite is stylish, functional and made for you and your tow vehicle.





Portable Outside Grill

Double Compression
Locking System

Secure Track

PASSPORT EXPRESS SUPER LITE



Let's say you need a camper that is easy to tow, has models under 3500 lbs. and has everything from a large kitchen sink to outside speakers. Look no further, you have arrived at the Passport Express Super Lite. With floorplans starting around 2900 lbs. and including every feature the experienced camper needs this is the Passport you want. Expandables to small bunkhouses means you won't be sitting at home on the weekends because you can go anywhere in a Passport Express Super Lite.

Passport
ULTRA LITE
by Keystone

3220BH SHOWN IN PARSLEY DECOR



Passport Playhouse



Outdoor Kitchen with Awning



Swivel LCD TV

PASSPORT GRAND TOURING

PASSPORT GRAND TOURING



Live large and go light with the Passport Grand Touring. The long standing myth of not being able to have a full 36" deep slide and still be an ultra lite has been solved. The first and only true ultra lite weight travel trailer with a deep slide that gives you all the room you want but doesn't have the unnecessary weight like the others. The spectacular Grand Touring 3220BH gives you sleeping for up to 10, an outside kitchen with water, a fridge, and cooktop all under it's own awning is a flagship in its self. Want something made for two? Then step into a 2510RB that rolls in under 4900 lbs, has room to roam inside, and 2 full wardrobes or pantry's to fill for a fun weekend or a cross country outing. From 2 to 10 we have you covered in the Passport Grand Touring.

GO ANYWHERE  WWW.KEYSTONE-PASSPORT.COM

ULTRA LITE
EXPRESS SL
ULTRA LITE GT

CHASSIS

Engineered specifically for each floor plan	●	●	●
Tube style bumper w/ sewer hose storage	●	●	●
Fully welded outriggers	●	●	●
100% "E" coated Paco frame	●	●	●
Cambered for added structural support	●	●	●
Extra support cross members	●	●	●
Electric slide out system	●	●	●
Enclosed and heated underbelly (N/A 195RB)	●	●	●

CONSTRUCTION

Welded aluminum framed sidewalls	●	●	●
Laminated gel-coated filon exterior walls	●	●	●
High density bead foam insulation in sidewalls (R-7 insulation)	●	●	●
Laminated aluminum framed floor 2" thick	●	●	●
One piece breathable Darco protective wrap	●	●	●
R-11 floor insulation	●	●	●
Stamped galvanized 5" thick crowned rafters	●	●	●
One piece seamless Rubber roof	●	●	●
R-11 ceiling insulation	●	●	●

EXTERIOR FEATURES

Insulated lockable radius baggage doors with hold backs	●	●	●
Insulated radius entrance door with screen door	●	●	●
Double entry steps at main door	●	●	●
Triple entry steps at main door	●	●	●
Heavy duty front mechanical jack	●	●	●
4 scissor style stabilizer jacks	●	●	●
2-20lb. Propane bottles with flip top cover	●	●	●
Dual battery rack over A-frame	●	●	●
Rain gutters with extended downspouts	●	●	●
Electric adjustable awning	●	●	●
Lighted exterior pass thru storage compartment	●	●	●
Portable Outside Grill	●	●	●
Patio entrance light	●	●	●
Exterior shower w/ hot & cold	●	●	●
Fold away exterior grab handle	●	●	●
Front diamond plate	●	●	●
Load Equalization (spread axle design)	●	●	●
EZ lube axles	●	●	●
Exterior speakers	●	●	●
Exterior light at dump valves	●	●	●

INTERIOR FEATURES

Residential style furniture with high grade fabric	●	●	●
Convenience center with slide, lights, awning and water system controls	●	●	●
13.5 BTU ducted A/C (not ducted on Express SL)	●	●	●
Forced air furnace	●	●	●
Ducted in floor heating	●	●	●
6 gallon gas/electric DSI water heater	●	●	●
Water system winterization ready	●	●	●
Residential durable Beauflor® linoleum	●	●	●

ULTRA LITE
EXPRESS SL
ULTRA LITE GT

Digital TV system	●	●	●
12 volt DVD/CD/AM/FM stereo with aux input & quality sound speakers	●	●	●
LCD flat screen HD TV	●	●	●
2 tone wood accents	●	●	●
Residential light fixtures in slide room	●	●	●
King u-shaped dinette with adjustable table	●	●	●

KITCHEN

Extra large double door refrigerator	●	●	●
Oversized 60/40 residential sink	●	●	●
Metal high-rise faucet	●	●	●
Microwave with carousel	●	●	●
3-burner high output range	●	●	●
Range hood with 12-volt exhaust fan and light	●	●	●
Residential hardwood cabinet doors	●	●	●
Coordinated wall paper border	●	●	●
Gas Oven	●	●	●

BATHROOM

Solid wood custom built medicine cabinet with mirror	●	●	●
Tub surround with built-in shelves	●	●	●
Radius shower curtain	●	●	●
Pedestal foot flush toilet	●	●	●
Skylight over tub (most floorplans)	●	●	●
12 volt power exhaust fan	●	●	●

BEDROOM (MAIN)

60"x80" Queen Size Mattress	●	●	●
Quilted bedspread	●	●	●
Decorative headboard	●	●	●
Oversized wardrobes	●	●	●
Nighttime reading lights	●	●	●

SAFETY PACKAGE

4 wheel electric brakes	●	●	●
Break-away switch	●	●	●
Heavy duty safety chains with clasp	●	●	●
Tinted safety glass windows	●	●	●
Multiple emergency egress windows	●	●	●
GFI receipts	●	●	●
Carbon monoxide detector	●	●	●
Smoke alarm	●	●	●
Fire extinguisher	●	●	●
Propane gas leak detector	●	●	●
Dead-bolt lock on entrance doors	●	●	●
Manual override on slide system	●	●	●
Spare tire kit	●	●	●

DECOR OPTIONS: **P** Parsley **T** Tuscany **H** Harvest





- | | | |
|--|------------------------------------|----------------------------|
| 1 Gel Coated Filon Exterior | 10 Aluminum Floor Studs | 20 Diamond Plate |
| 2 Luan Layer | 11 3rd Layer Floor Decking | 21 Dual Battery Tray |
| 3 Hi-Density Block Foam Insulation | 12 Moisture Barrier Wrap | 22 Sloped Slide Roof |
| 4 Interior Wallboard | 13 Enclosed Underbelly | 23 Wiper Seals |
| 5 Total Aluminum Frame | 14 PACO I-Beam Frame | 24 Bulb Seal in T-Track |
| 6 Residential Grade Linoleum | 15 One Piece Rubber Roof | 25 Aerodynamic Front Wall |
| 7 1st Layer Floor Decking | 16 Roof Decking | 26 Easy Lube Axles |
| 8 2nd Layer Floor Decking with Staggered Seams | 17 R-11 Insulation | 27 Load Equalization Axles |
| 9 Hi-Density Block Foam Insulation | 18 5" Crowned/Stamped Roof Trusses | 28 Radial Tires |
| | 19 Hurricane Straps | 29 Radius Entry Steps |

CONSTRUCTION AND FEATURES



Foot Flush Toilet



HD LCD Television



LP Tank Cover



Opens for Easy Access



Outside Speakers and Power Awning

GO ANYWHERE.



KEY
FEATURES
VIDEO

Want to know more about
Passport features? Go to
www.keystone-passport.com
and look for the video symbol!

Folding
Entry
Assist
Handle



Stabilizer Jacks



Load Equalization Axles



Lighted Pass-Thru
Storage



Outside Shower



Deep Sink with
High-Rise Faucet

CONSTRUCTION AND FEATURES

195RB

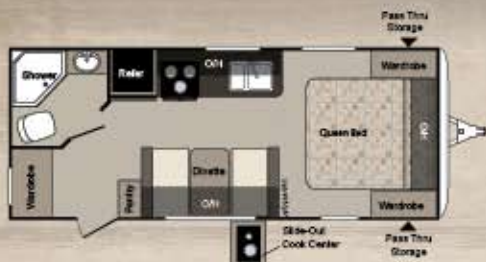

245RB



250BH

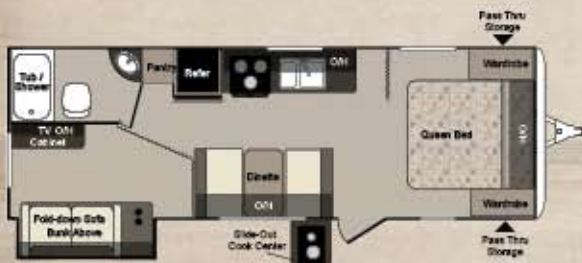

280BH

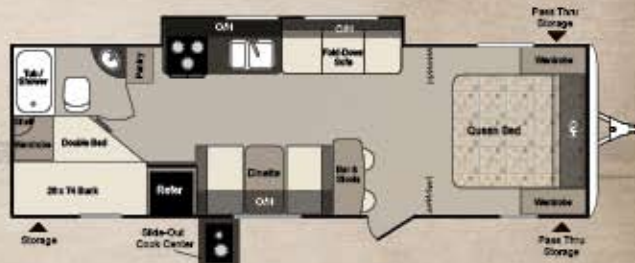

285RL



286RB

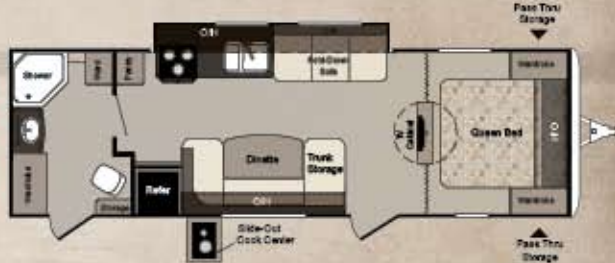

290BH

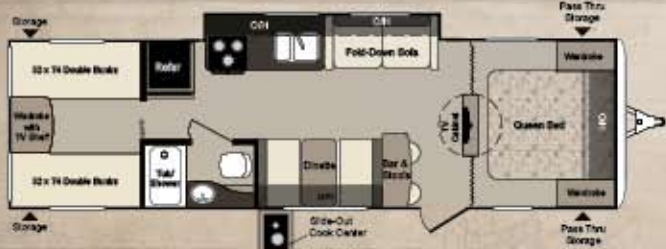

300BH

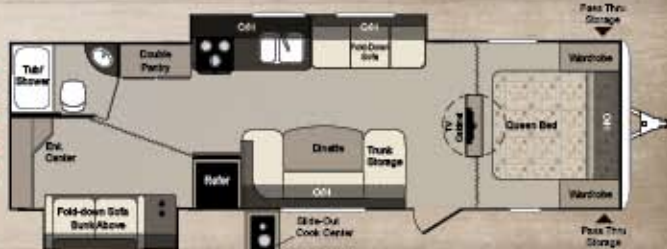

	Floorplan	Shipping Weight	Carrying Capacity	Hitch	Length	Height	Fresh Water	Waste Water	Gray Water	LPG
ULTRA LITE	195RB	3820	2110	330	24' 5"	10' 1"	30	30	30	40
	245RB	4550	1850	400	27' 9"	10' 2"	30	30	30	40
	250BH	4377	2063	440	27' 10"	10' 2"	30	30	30	40
	280BH	4808	1637	445	31' 2"	10' 2"	30	30	30	40
	285RL	4977	1628	605	31' 2"	10' 2"	30	30	30	40
	286RB	4958	1490	448	31' 2"	10' 2"	30	30	30	40
EXPRESS SL	290BH	5177	2398	575	33' 3"	10' 2"	30	30	30	40
	300BH	5496	2042	535	33' 6"	10' 4"	30	30	30	40
	160EXP	2940	3800	310	17' 5"	10' 1"	30	30	30	40
	190EXP	3460	1740	385	20' 7"	10' 1"	30	30	30	40
ULTRA LITE GT	199ML	3556	2366	322	21' 9"	10' 1"	30	30	30	40
	235EXP	4277	1723	395	24' 2"	10' 2"	30	30	30	40
	238ML	3740	1660	495	24' 11"	10' 2"	30	30	30	40
	2510RB	4810	2190	495	28' 10"	10' 7"	30	30	30	40
	2590BH	4893	2307	590	28' 10"	10' 7"	30	30	30	40
	2850RL	5085	2115	650	30' 4"	10' 7"	30	30	30	40
	2910BH	5452	1748	725	32' 10"	10' 9"	30	30	30	40
	3050BH	5706	1694	605	32' 8"	10' 9"	30	30	30	40
3220BH	6275	1225	515	35' 5"	10' 9"	30	30	40	40	



ONLINE SNAPSHOTS ARE AVAILABLE!

Want to know more about these floorplans? Go to www.keystone-passport.com, click on the floorplans page and look for the camera symbol to see interior snapshots.

Passport ULTRA LITE

by Keystone



EXPRESS SL FLOORPLANS

160EXP



190EXP

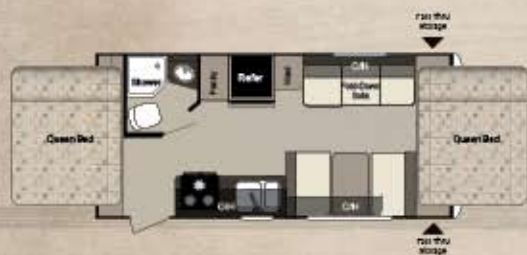

199ML

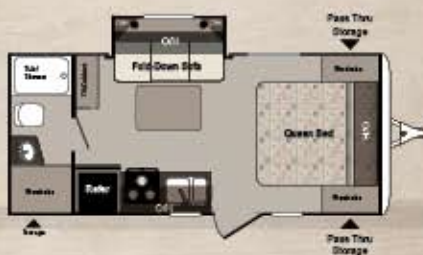

235EXP

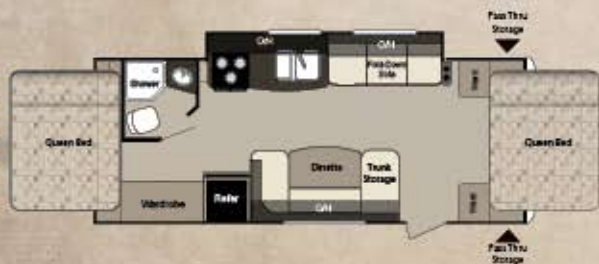

238ML



2510RB



2590BH



2850RL



2910BH



3050BH



3220BH



GRAND TOURING FLOORPLANS

Passport

ULTRA LITE
by Keystone



WE THANK YOU

With Passport offering more features for the money than any other brand in the ultra lite market, experienced RV owners have recognized the full array of conveniences that have been built into each and every model. It's truly exciting for Passport to have rewarded it's customers needs in such an ideal way.

GO ANYWHERE WITH PASSPORT



Want to know more about Passport features? Go to www.keystone-passport.com and look for the video symbol!



ONLINE SNAPSHOTS ARE AVAILABLE!

Want to know more about these floorplans? Go to www.keystone-passport.com, click on the floorplans page and look for the camera symbol to see interior snapshots.



GO ANYWHERE | WWW.KEYSTONE-PASSPORT.COM

YOUR LOCAL DEALER IS:

November 2010

Product information is as accurate as possible at the date of publication of this brochure. Features, floor plans, and specific rights are subject to change without notice. Please also consult Keystone's web site at www.keystone.com for more current product information and specifications. Tow Vehicle Disclaimer: CAUTION: Owners of Keystone recreational vehicles are solely responsible for the selection and proper use of tow vehicles. All customers should consult with a motor vehicle manufacturer or their dealer concerning the purchase and use of suitable tow vehicles for Keystone products. Keystone disclaims any liability or damages suffered as a result of the selection, operation, use or misuse of a tow vehicle. KEYSTONE'S LIMITED WARRANTY DOES NOT COVER DAMAGE TO THE RECREATIONAL VEHICLE OR THE TOW VEHICLE AS A RESULT OF THE SELECTION, OPERATION, USE OR MISUSE OF THE TOW VEHICLE - 11/2010

Go RVing
Life's A Trip

MEMBER
RVIA
RECREATIONAL VEHICLE
INDUSTRY ASSOCIATION

2642 Hackberry Drive | PO Box 2000
Goshen, IN 46527-2000
(574) 535-2100

 **Keystone RV
Camping**

www.kestonerv.com